

STATE OF ILLINOIS
DEPARTMENT OF TRANSPORTATION

ROUTE NO.	SECTION	COUNTY	TOTAL SHEETS	SHEET NO.
FAP 697	17BR	FORD	40	22
STA.	TO STA.		ILLINOIS PROJECT	
FED. ROAD DIST. NO.	FED. AID PROJECT		DWG. NO. 9 OF 15	

CONTRACT NO. 66604

* Epoxy grout bars in 8" min. depth drilled holes according to section 584 of the Standard Specifications.

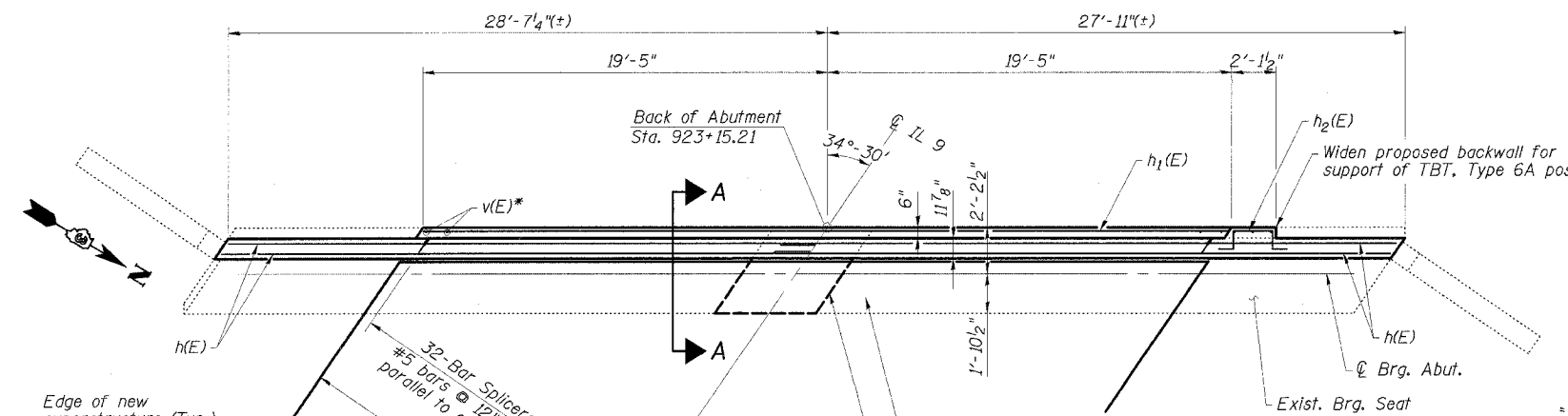
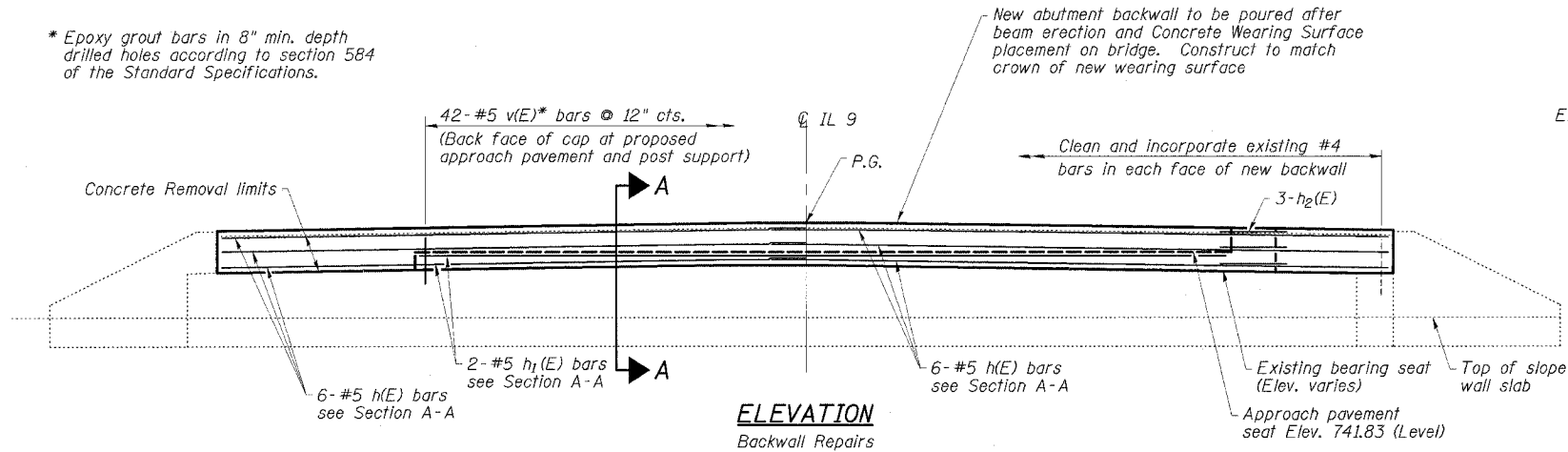

MIN. BAR LAP
#5 bar = 2'-5"

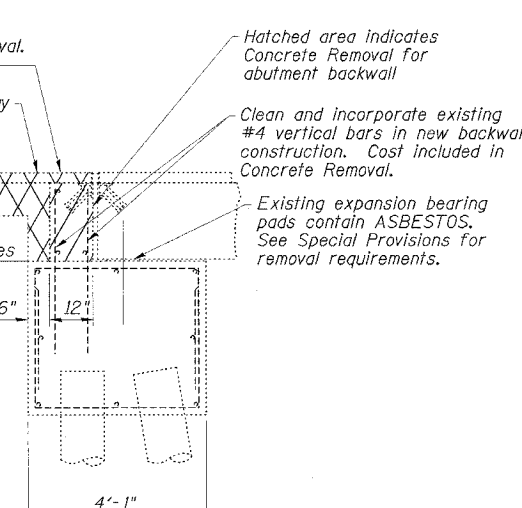
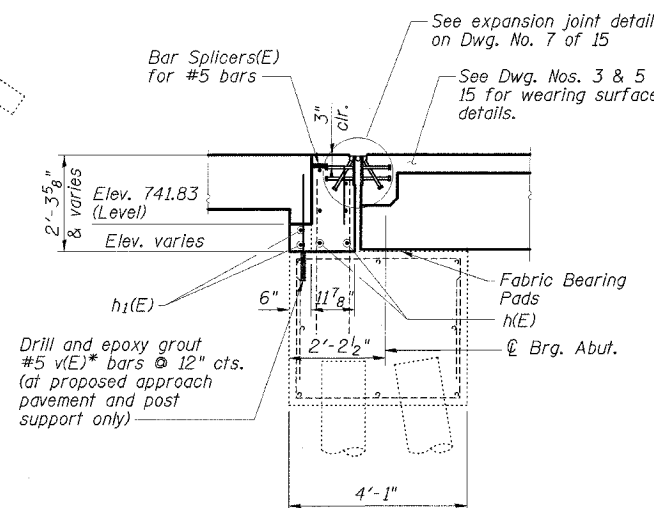
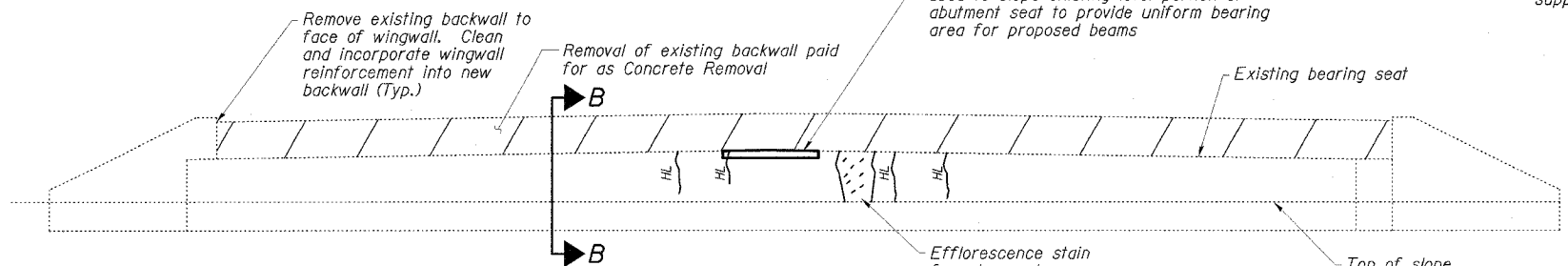

WEST ABUTMENT
BILL OF MATERIAL

Bar	No.	Size	Length	Shape
h (E)	12	#5	29'-3"	—
h ₁ (E)	2	#5	38'-6"	—
h ₂ (E)	3	#5	4'-10"	┌┐
v (E)	42	#5	2'-6"	—
Concrete Removal			Cu. Yd.	3.8
Concrete Structures			Cu. Yd.	5.6
Reinforcement Bars, Epoxy Coated			Pound	580
Structure Excavation			Cu. Yd.	71
Asbestos Bearing Pad Removal			Each	30
Bridge Seat Sealer			Sq. Ft.	28
Epoxy Crack Sealing			Foot	20
Formed Concrete Repair (Depth Equal to or Less Than 5")			Sq. Ft.	27.6
Bar Splicers			Each	32

REPAIR LEGEND

- Inspection Date: 5-24-05
- Rust Stained Area
 - Moisture Stained or Leached Area
 - Hairline Crack - Not to be Sealed
 - Crack (> 1/16" Width)
 - Leached Crack (> 1/16" Width)
 - Delaminated Area
 - Spalled Area (Depth ≤ 5")
- EPOXY CRACK SEALING**
- FORMED CONC. REPAIR**

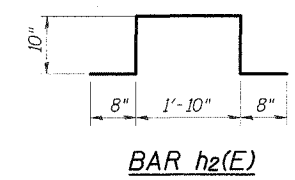

NOTE: ABUTMENT CRACK REPAIR LENGTHS AND FORMED CONCRETE REPAIR AREAS ARE ESTIMATED FROM 5-24-05 SURVEY WORK. ACTUAL LOCATIONS AND QUANTITIES OF REPAIRS SHALL BE SHOWN BY THE ENGINEER ON THE AS-BUILT PLANS FOR THIS SECTION.

ESCA
CONSULTANTS, INC.

DESIGNED BY:	ELH	6/05
DRAWN BY:	DWH	6/05
CHECKED BY:	ELH	10/05
APPROVED BY:	RDP	10/05

WEST ABUTMENT
IL 9 OVER BIG FOUR DITCH
FAP ROUTE 697 - SECTION 17BR
FORD COUNTY
STATION 923+87.00
STRUCTURE NO. 027-0068