

STATE OF ILLINOIS
DEPARTMENT OF TRANSPORTATION

| | | | | |
|---------------------|-------------|--------|------------------|-----------|
| ROUTE NO. | SECTION | COUNTY | TOTAL SHEETS | SHEET NO. |
| FAP 697 | 17BR | FORD | 40 | 26 |
| STA. | TO STA. | | | |
| FED. ROAD DIST. NO. | ILLINOIS | | FED. AID PROJECT | |
| | DWG. NO. 13 | | OF 15 | |

CONTRACT NO. 66604

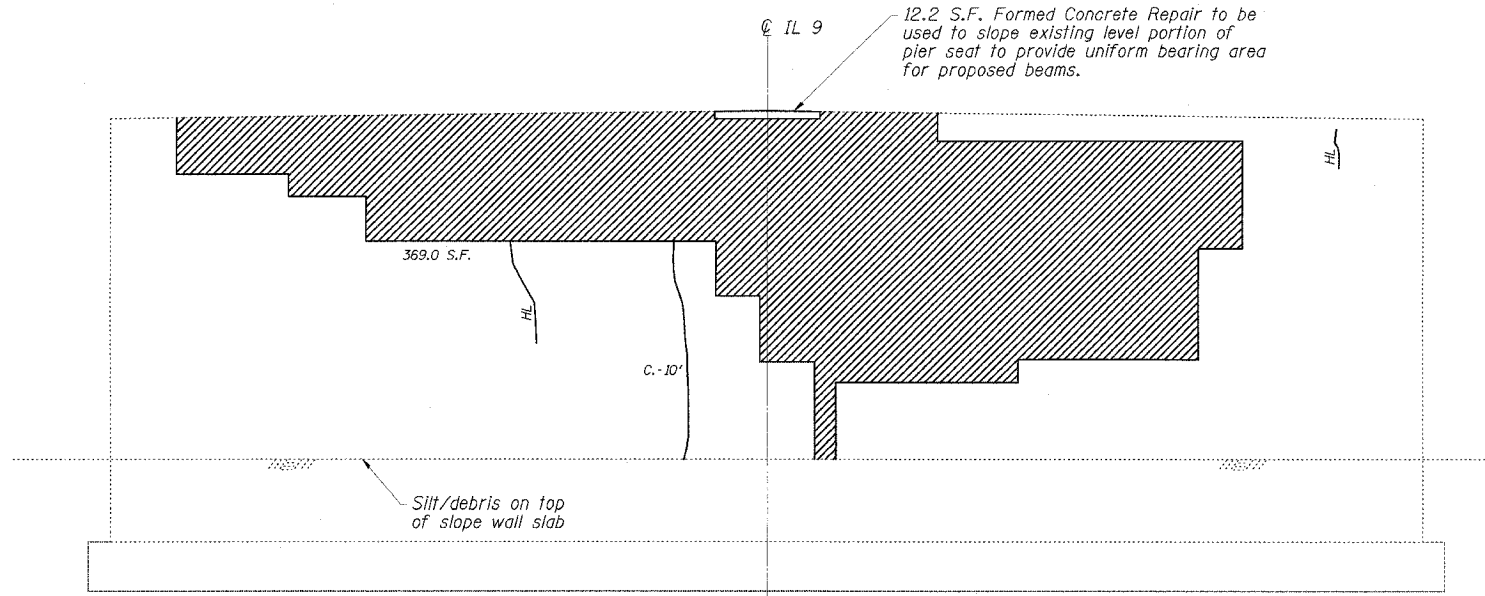

EAST ELEVATION

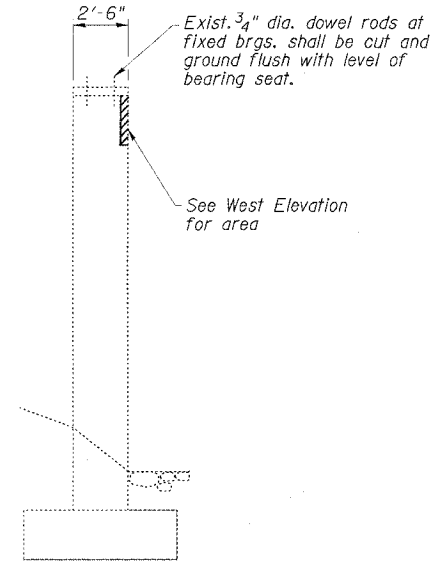

NORTH END

**PIER 2
BILL OF MATERIAL**

| ITEM | UNIT | TOTAL |
|---|---------|-------|
| Epoxy Crack Sealing | Foot | 51 |
| Formed Concrete Repair (Depth Equal to or Less Than 5") | Sq. Ft. | 878.2 |
| | | |

EXISTING BEARING SEAT TO BE INSPECTED BY THE ENGINEER AFTER DECK BEAM REMOVAL. DETERIORATED CONCRETE AREAS SHALL BE REPAIRED (ESTIMATED 15 S.F. ADDITIONAL FORMED CONCRETE REPAIR DEPTH ≤ 5") AND CRACKS SHALL BE SEALED (ESTIMATED 20' ADDITIONAL EPOXY CRACK SEALING) IF FOUND.

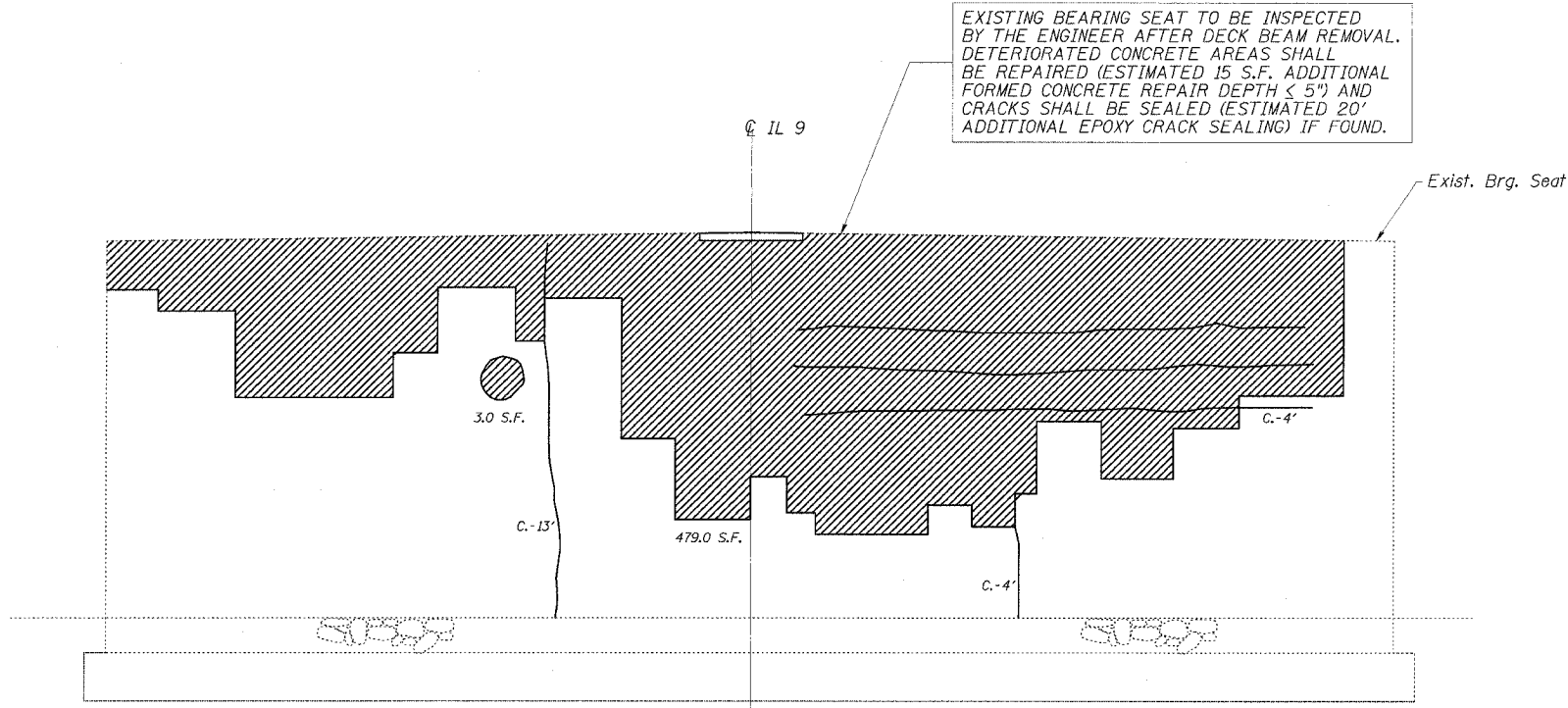

WEST ELEVATION

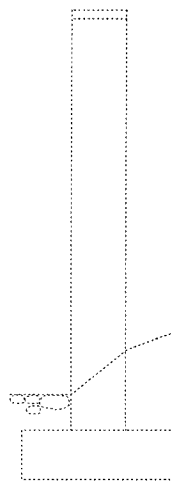

SOUTH END

REPAIR LEGEND
Inspection Date: 5-24-05

- Rust Stained Area
- Moisture Stained or Leached Area
- Hairline Crack - Not to be Sealed
- Crack (> 1/16" Width) — EPOXY CRACK SEALING
- Leached Crack (> 1/16" Width) — EPOXY CRACK SEALING
- Delaminated Area — FORMED CONG. REPAIR
- Spalled Area (Depth ≤ 5") — FORMED CONG. REPAIR

**PIER 2
IL 9 OVER BIG FOUR DITCH
FAP ROUTE 697 - SECTION 17BR
FORD COUNTY
STATION 923+87.00
STRUCTURE NO. 027-0068**

ESCA
CONSULTANTS, INC.

| | | |
|--------------|-----|------|
| DESIGNED BY: | ELH | 6/05 |
| DRAWN BY: | DWH | 6/05 |
| CHECKED BY: | ELH | 9/05 |
| APPROVED BY: | RDP | 9/05 |

NOTE: PIER CRACK REPAIR LENGTHS AND FORMED CONCRETE REPAIR AREAS ARE ESTIMATED FROM 5-24-05 SURVEY WORK. ACTUAL LOCATIONS AND QUANTITIES OF REPAIRS SHALL BE SHOWN BY THE ENGINEER ON THE AS-BUILT PLANS FOR THIS SECTION.