

ROUTE NO.	SECTION	COUNTY	TOTAL SHEETS	SHEET NO.
FAP 697	17BR	FORD	40	36
STA 921+00	TO STA 922+50			
FED. ROAD DIST. NO.	ILLINOIS	FED. AID PROJECT-		

FINAL SURVEY	SURVEYED	BY	DATE
NOTE BOOK NO.	PLOTTED		
	TEMP. DATE		
	AREAS CHECKED		

ORIGINAL SURVEY	SURVEYED	BY	DATE
NOTE BOOK NO.	PLOTTED		
	TEMP. DATE		
	AREAS CHECKED		

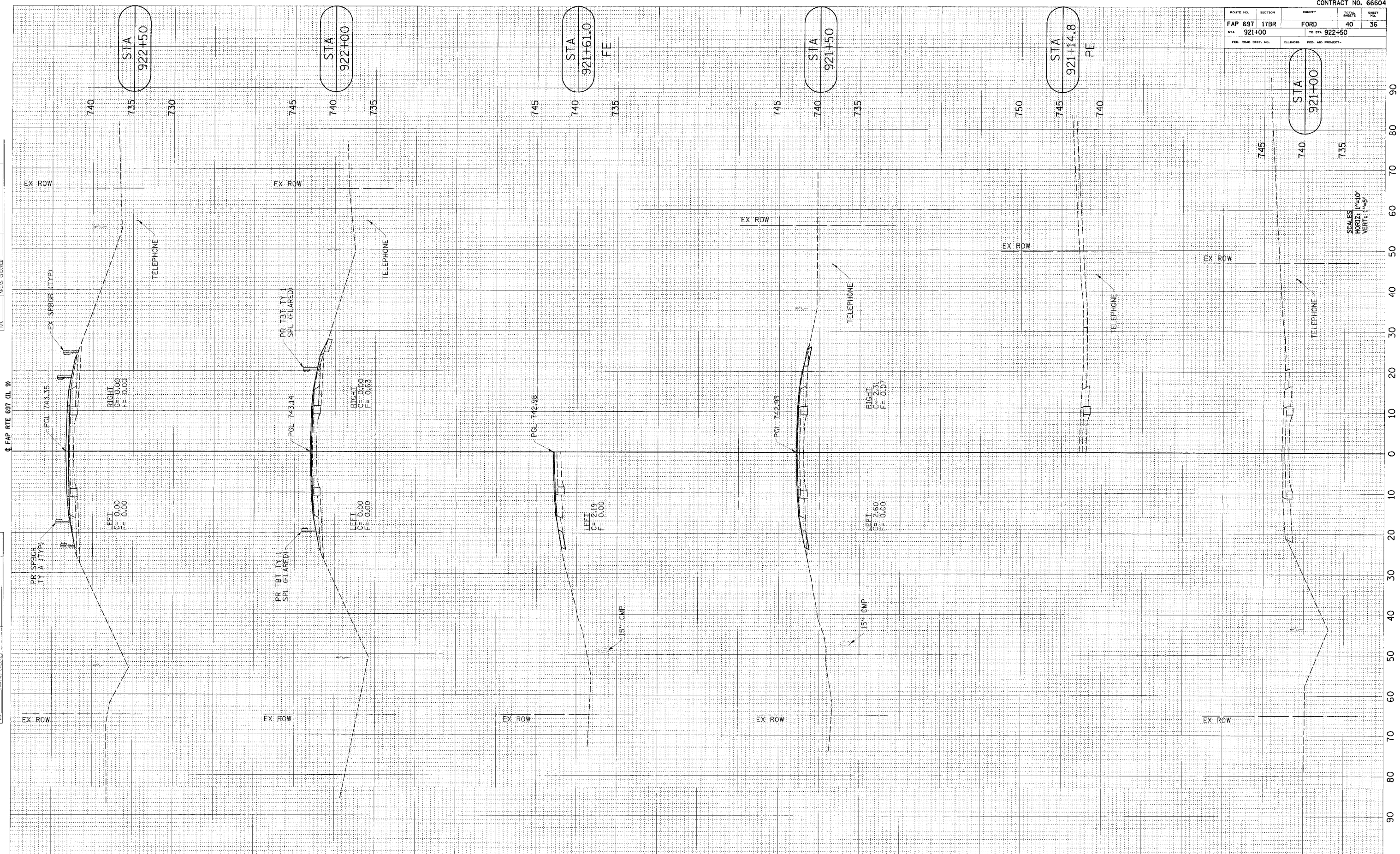

**FAP RTE 697 (IL 9) CROSS SECTIONS
STA 921+00 TO STA 922+50**