

DESIGNER: CLARK JONES
PHONE: (309)671-3452

PROJECT ENGINEER: JIM MILLER
PHONE: (309)671-3451

F.A. RTE.	SECTION	COUNTY	TOTAL SHEETS	SHEET NO.
VAR	*	PEO/TAZ	27	1

* D4 Joint Repair 2006

STATE OF ILLINOIS
DEPARTMENT OF TRANSPORTATION
DIVISION OF HIGHWAYS

**PROPOSED
HIGHWAY PLANS**

FAP 317/FAI 155 (US 24)/(I-155)
SECTION D4 JOINT REPAIR 2006
PEORIA / TAZEWELL COUNTY
C-94-023-05

INDEX OF SHEETS:

- 1. COVER SHEET
- 2. GENERAL NOTES
- 3. SUMMARY OF QUANTITIES
- 4. SCHEDULE OF QUANTITIES
- 5~9. PLAN SHEETS & DETAILS(072-0012/0133)
- 10~17. PLAN SHEETS & DETAILS(090-0130)
- 18~22. PLAN SHEETS & DETAILS(090-0095)
- 23~27. PLAN SHEETS & DETAILS(090-0093)

STANDARDS:

- 701101-01 701601-04
- 701201-02 702001-05
- 701406-04 701400-02

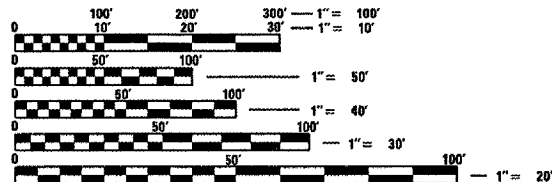

FULL SIZE PLANS HAVE BEEN PREPARED USING STANDARD ENGINEERING SCALES. REDUCED SIZED PLANS WILL NOT CONFORM TO STANDARD SCALES. IN MAKING MEASUREMENTS ON REDUCED PLANS, THE ABOVE SCALES MAY BE USED.

J.U.L.I.E.
JOINT UTILITY LOCATION INFORMATION FOR EXCAVATION
1-800-892-0123

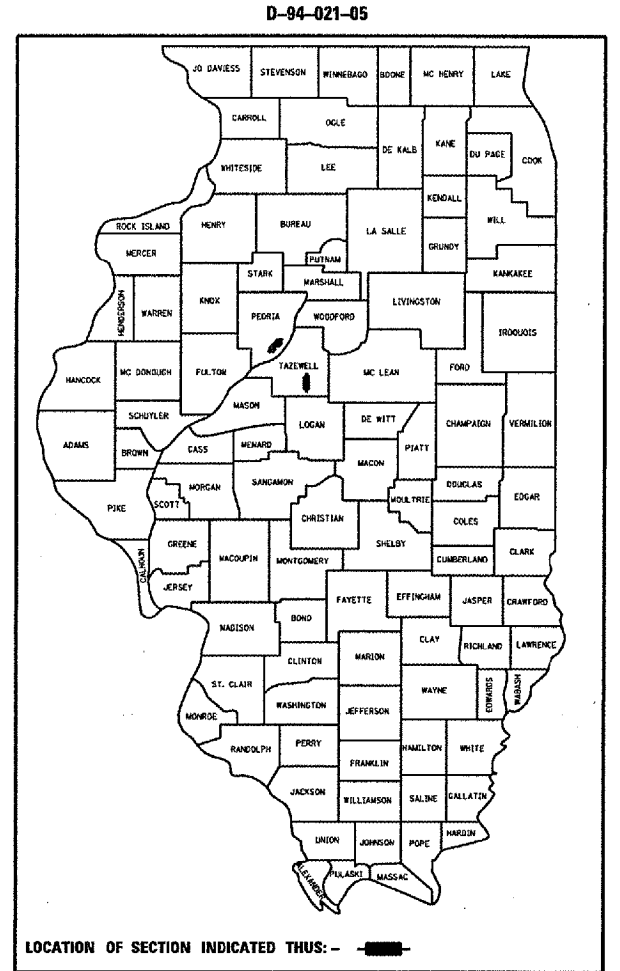
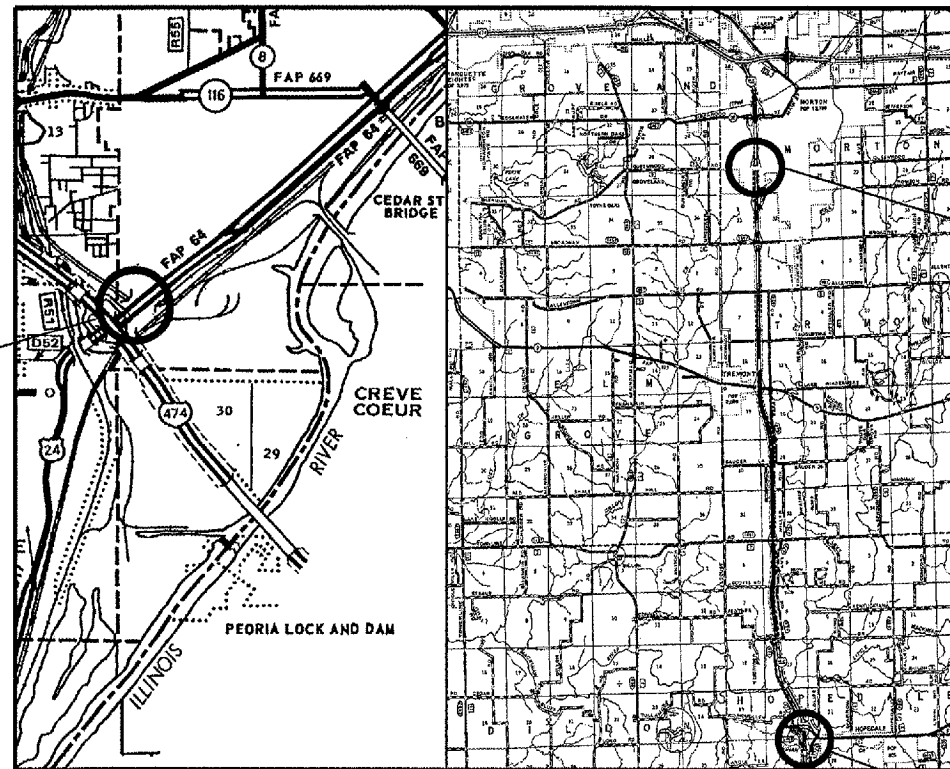

PROJECT CONSISTS OF JOINT REMOVAL/REPLACEMENT OF EXPANSION JOINT SEALS WITH POURABLE SEALANTS ON 5 STRUCTURES: (SN 072-0012 AND 072-0133), CARRYING US 24 OVER BU&CNW RR, (SN 090-0130), QUEENWOOD RD. OVER I-155, (SN 090-0095), IL.122E OVER I-155 TWO MILES WEST OF HOPEDALE, AND (SN 090-0093), I-155 SB OVER INDIAN CRK. STRUCTURE 090-0093 ALSO INCLUDES METALING PPC BEAM ENDS.

STATE OF ILLINOIS
DEPARTMENT OF TRANSPORTATION
DIVISION OF HIGHWAYS

SUBMITTED *October 20, 2005*
John [Signature]
DEPUTY DIRECTOR OF HIGHWAYS, REGION ENGINEER

December 9, 2005
Mike [Signature]
ENGINEER OF DESIGN AND ENVIRONMENT

December 9, 2005
Eric [Signature]
DEPUTY DIRECTOR OF HIGHWAYS, CHIEF ENGINEER

**PRINTED BY THE AUTHORITY
OF THE STATE OF ILLINOIS**

F.A.P. RTE.	SECTION	COUNTY	TOTAL SHEETS	SHEET NO.
317	*	PEORIA	27	2
STA. 211+60.95		TO STA. 219+27.65		
FED. ROAD DIST. NO. 4		ILLINOIS FED. AID PROJECT		

* 04 Joint Repair 2006

COMMITMENTS

NO COMMITMENTS HAVE BEEN MADE FOR THIS PROJECT.

GENERAL NOTES

ALL EXISTING PJS EXPANSION JOINT SEALS FOR THESE STRUCTURES SHALL BE REMOVED AS INCIDENTAL TO "BLAST CLEANING BRIDGE JOINT STEEL".

THERE SHALL BE NO WORK DONE UNDERNEATH THE BRIDGE DECK ON SN.072-0012 AND 072-0133 OVER, ON, OR NEAR THE RAILROAD. THE STATE HOLDS NO LIABILITY RESPONSIBILITY FOR ANY CLAIMS MADE BY THE RAILROAD FOR ANY ISSUES RESULTING FROM OR PERTAINING TO THE PROPOSED WORK IN THIS CONTRACT.

PLOT DATE * DATE
FILE NAME * FILED
JOB NO. * SHEET
REFERENCE * PAGE

REVISIONS	
NAME	DATE

ILLINOIS DEPARTMENT OF TRANSPORTATION

GENERAL NOTES

SCALE: VERT.
HORIZ.
DATE 06-14-2005

DRAWN BY CEJ
CHECKED BY

U.S. 24 I-155
URBAN RURAL

F.A.P. RTE.	SECTION	COUNTY	TOTAL SHEET NO.
317		PEORIA	27 3
STA. 211+60.95		TO STA. 219+27.65	
FED. ROAD DIST. NO. 4		ILLINOIS	FED. AID PROJECT
04 Joint Repair 2006			

SUMMARY OF QUANTITIES

100% STATE SAFETY - 2A
PEORIA/TAZEWELL

CODE NO.	ITEM	UNIT	PEO	TAZ	TOTAL
67100100	MOBILIZATION	LSUM	0.5	0.5	1
70100450	TRAFFIC CONTROL AND PROTECTION, STANDARD 701201	LSUM		1	1
70100700	TRAFFIC CONTROL AND PROTECTION, STANDARD 701406	LSUM		1	1
70102630	TRAFFIC CONTROL AND PROTECTION, STANDARD 701601	LSUM	0.5	0.5	1
X0301424	SILICONE JOINT SEALER	FOOT	687	391	1078
X4409905	BITUMINOUS REMOVAL (MISCELLANEOUS)	SQ. YD.		8	8
Z0004800	BITUMINOUS MIXTURE FOR PATCHING	TON		1	1
X0325215	THERMAL SPRAYING (METALIZING) BRIDGE JOINT STEEL	FOOT	643	329	972
X0325216	THERMAL SPRAYING (METALIZING) PPC BEAM ENDS	SQ. FT.		279	279
X0325217	BLAST CLEANING BRIDGE JOINT STEEL	FOOT	687	391	1078
X0325218	BLAST CLEANING PPC BEAM ENDS	FOOT		48	48
X0325219	BRIDGE MEDIAN EPDM SPECIAL	FOOT	890		890

• PLOT DATE
• DATE
• SCALE
• REFERENCE

REVISIONS	
NAME	DATE
Clark Jones	10-31-05

ILLINOIS DEPARTMENT OF TRANSPORTATION
SUMMARY OF QUANTITIES
SCALE: VERT. _____
HORIZ. _____
DATE 05-18-2005
DRAWN BY CEJ
CHECKED BY _____

F.A.R. RTE.	SECTION	COUNTY	TOTAL SHEETS	SHEET NO.
317		PEORIA	27	5
STA. 211+60.95 TO STA. 219+27.65				
FED. ROAD DIST. NO. 4 ILLINOIS FED. AID PROJECT				
© 04 Joint Rep'r 2006				

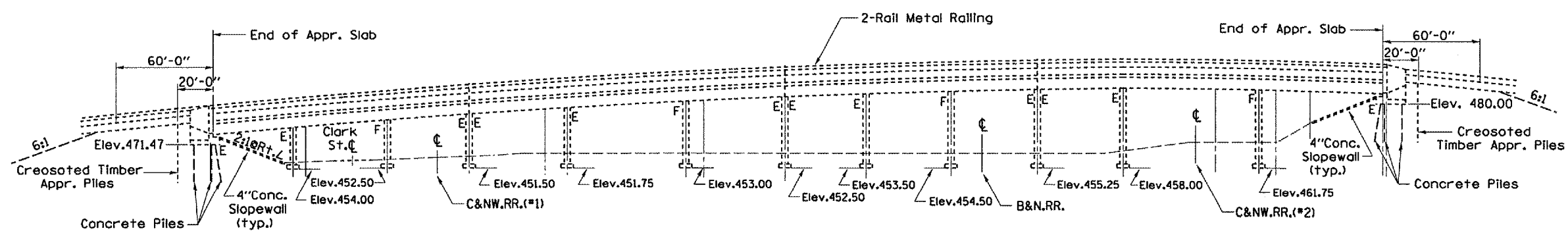

ELEVATION

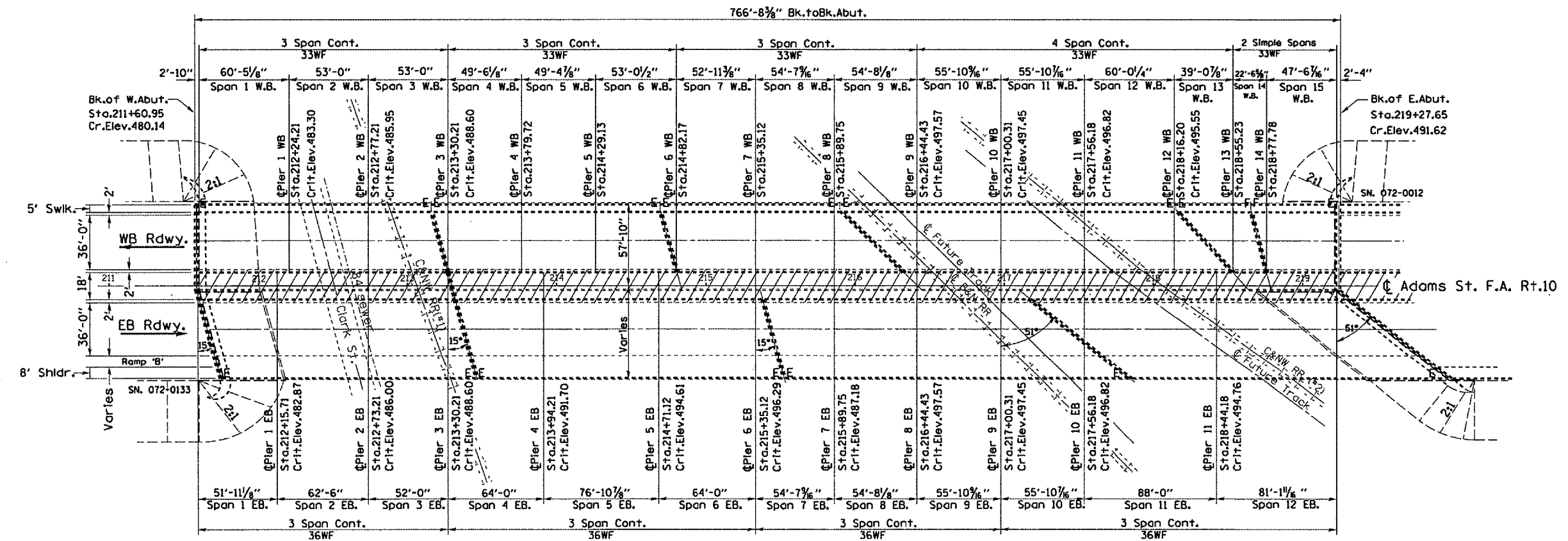

PLAN VIEW

GENERAL NOTES

PLAN DIMENSIONS AND DETAILS RELATIVE TO EXISTING STRUCTURE HAVE BEEN TAKEN FROM EXISTING PLANS AND ARE SUBJECT TO NOMINAL CONSTRUCTION VARIATIONS. IT SHALL BE THE CONTRACTOR'S RESPONSIBILITY TO VERIFY SUCH DIMENSIONS AND DETAILS IN THE FIELD AND MAKE NECESSARY APPROVED ADJUSTMENTS PRIOR TO WORK OR THE ORDERING OF MATERIALS. SUCH VARIATIONS SHALL NOT BE CAUSE FOR ADDITIONAL COMPENSATION FOR A CHANGE IN THE SCOPE OF THE WORK. HOWEVER, THE CONTRACTOR WILL BE PAID FOR THE QUANTITY ACTUALLY FURNISHED AT THE UNIT PRICE BID FOR THE PROJECT.

- USE 2-PART RAPID-CURE 100% SILICONE SEALER ONLY - NO OPTION. SEE SPECIAL PROVISIONS.

FOR INFORMATION ONLY

REVISIONS	
NAME	DATE

SN 072-0012 / 072-0133
Adams St. over Clark St. & B.N.R.R.

ILLINOIS DEPARTMENT OF TRANSPORTATION
PLAN AND ELEVATION
SCALE: VERT. DATE 06-06-2005
DRAWN BY CEJ
CHECKED BY

PLT DATE * CONTS * REFLES * FILE NAME * PLOT SCALE * NSCALE * REFERENCE * REF#

F.A.P. RTE.	SECTION	COUNTY	TOTAL SHEETS	SHEET NO.
317		PEORIA	27	6
STA. 211+60.95 TO STA. 219+27.65				
FED. ROAD DIST. NO. 4 ILLINOIS FED. AID PROJECT				
• D4 Joint Repair 2006				

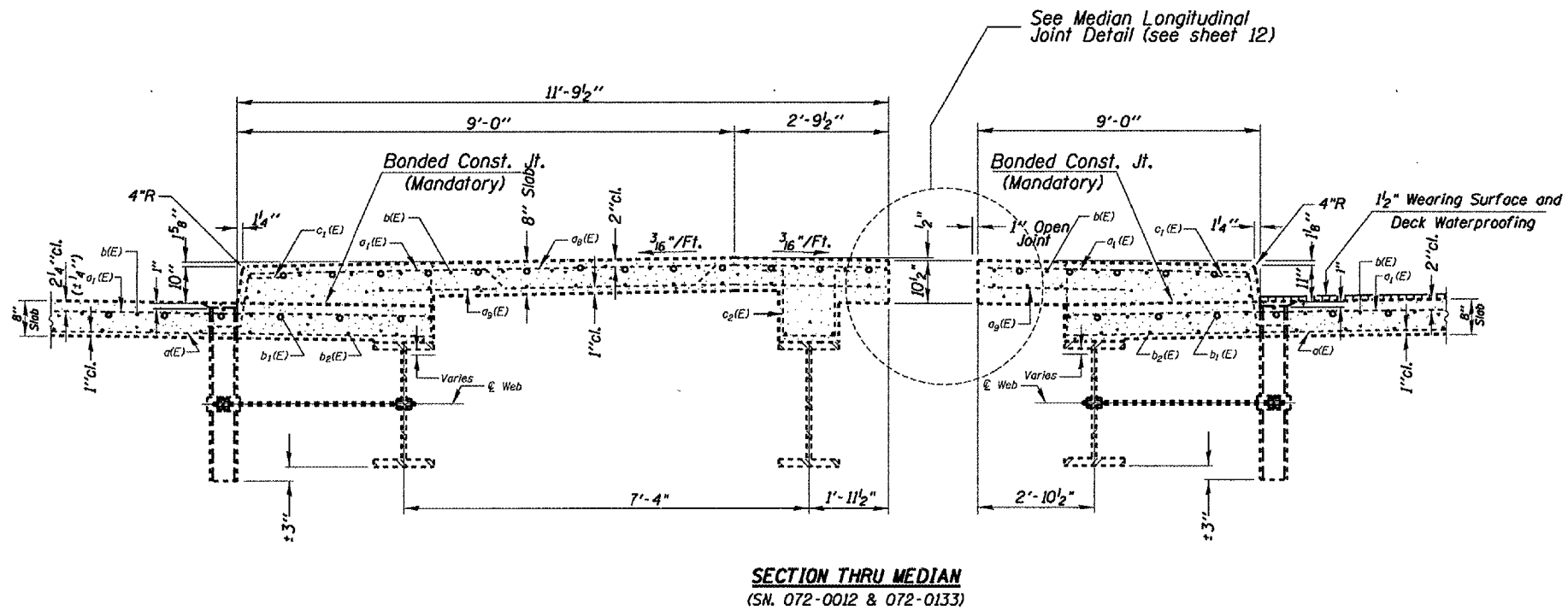
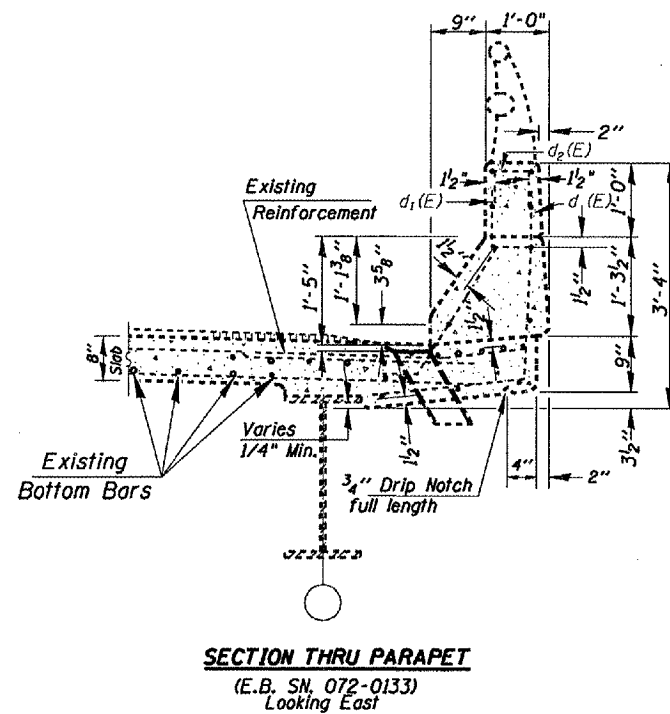
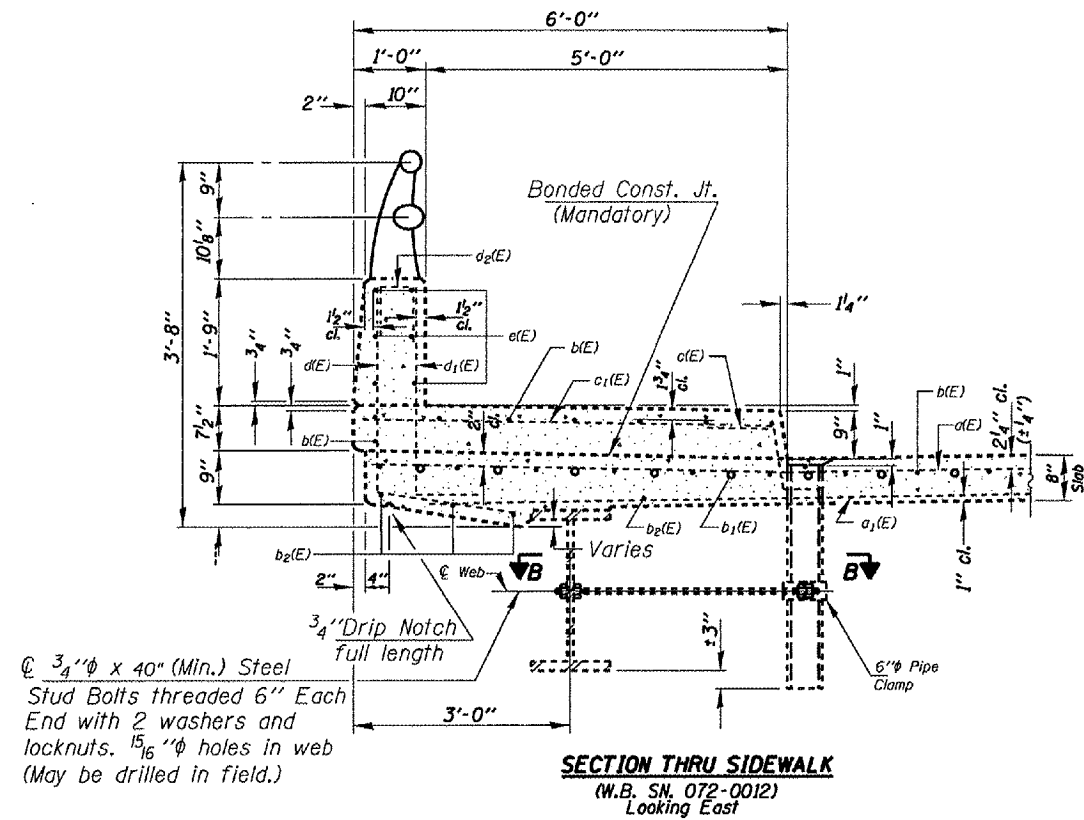

FOR INFORMATION ONLY

REVISIONS	
NAME	DATE

SN 072-0012 / 072-0133
Adams St. over Clark St. & B.N.R.R.

ILLINOIS DEPARTMENT OF TRANSPORTATION

SUPERSTRUCTURE DETAILS

SCALE: VERT. DRAWN BY CEJ
 HORIZ. CHECKED BY
 DATE 06-16-2005

DATE DATE
 FILE NAME FILE NAME
 PLOT SCALE PLOT SCALE
 REFERENCE REFERENCE

F.A.P. RTE.	SECTION	COUNTY	TOTAL SHEETS	SHEET NO.
317		PEORIA	27	7
STA. 211+60.95		TO STA. 219+27.65		
FED. ROAD DIST. NO. 4 ILLINOIS FED. AID PROJECT				
• 04 Joint Repol r 2006				

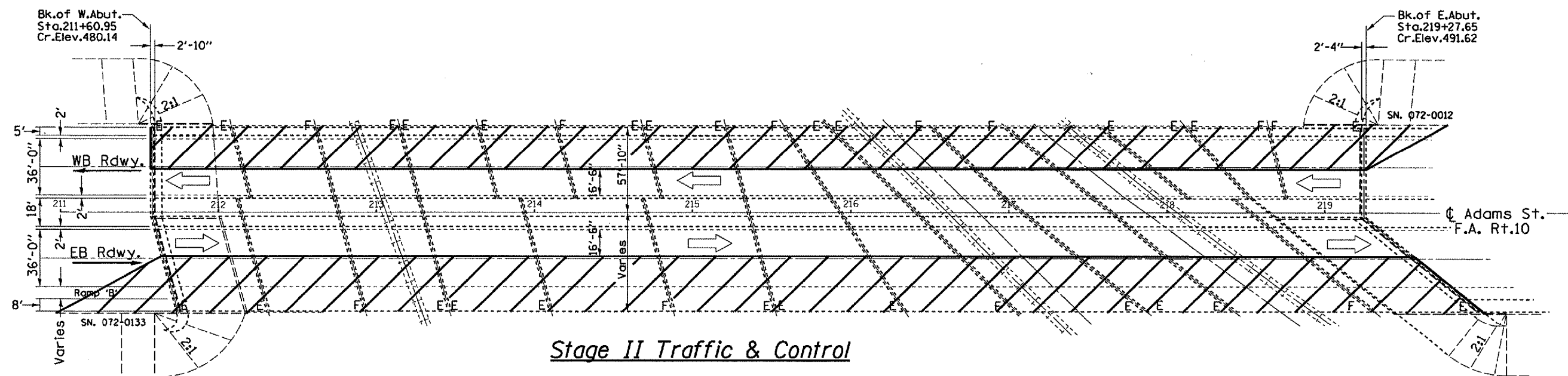
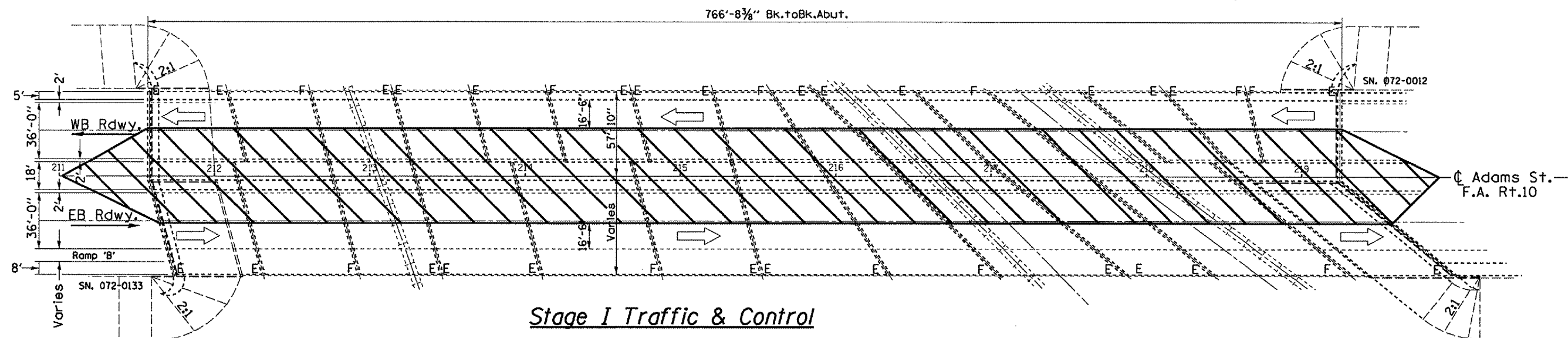

	Type III Barricade w/ flashing light		Work Area
	Barricade or Drum with flashing lights		Sign
	Cone, Drum, or Barricade		Arrow Board
	Flagger w/traffic control sign		

NOTE
Refer to Highway Standard 701601 for exact placement of traffic management devices and other clarifications as construction staging symbols and dimensioning were duplicated off of this standard.

REVISIONS	
NAME	DATE

SN 072-0012 / 072-0133
Adams St. over Clark St. & B.N.R.R.

ILLINOIS DEPARTMENT OF TRANSPORTATION

TRAFFIC STAGING PLAN

SCALE: VERT. _____
HORIZ. _____
DATE: 06-07-2005

DRAWN BY: CEJ
CHECKED BY: _____

PLOT DATE * WORKER
 FILE NAME * FILES
 PLOT SCALE * SCALES
 REFERENCE * REF'S

F.A.R. RTE.	SECTION	COUNTY	TOTAL SHEETS	SHEET NO.
317		PEORIA	27	8
STA. 211+60.95		TO STA. 219+27.65		
FED. ROAD DIST. NO. 4 ILLINOIS FED. AID PROJECT				
• 04 Joint Repd r 2006				

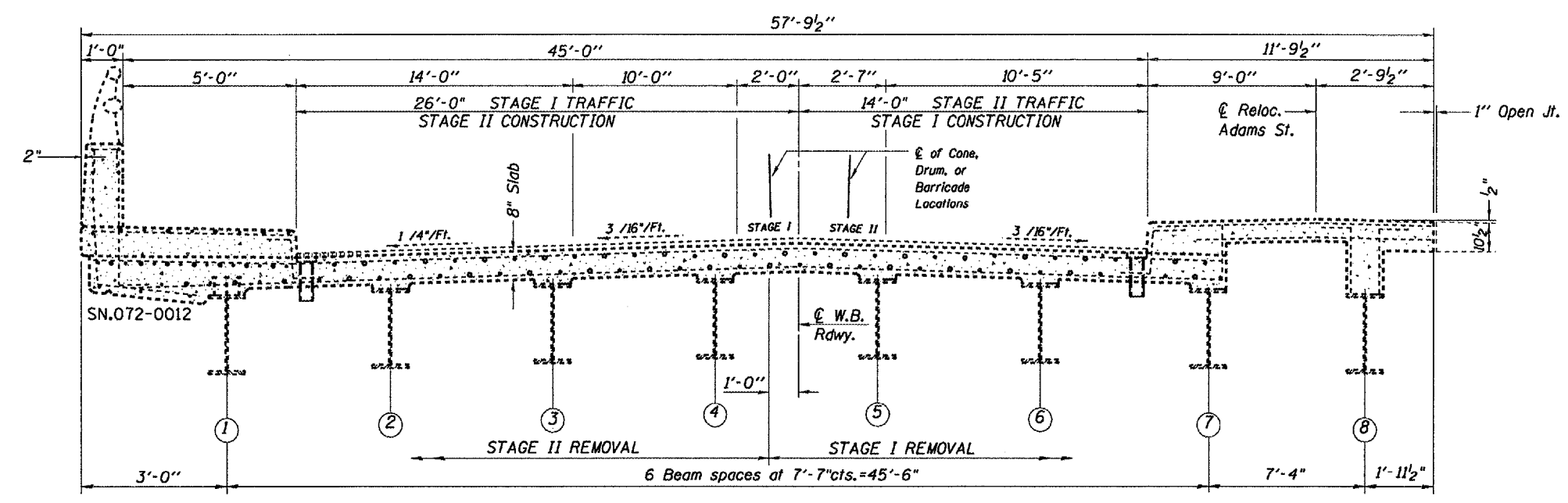

CROSS SECTION
(WestBound Deck)

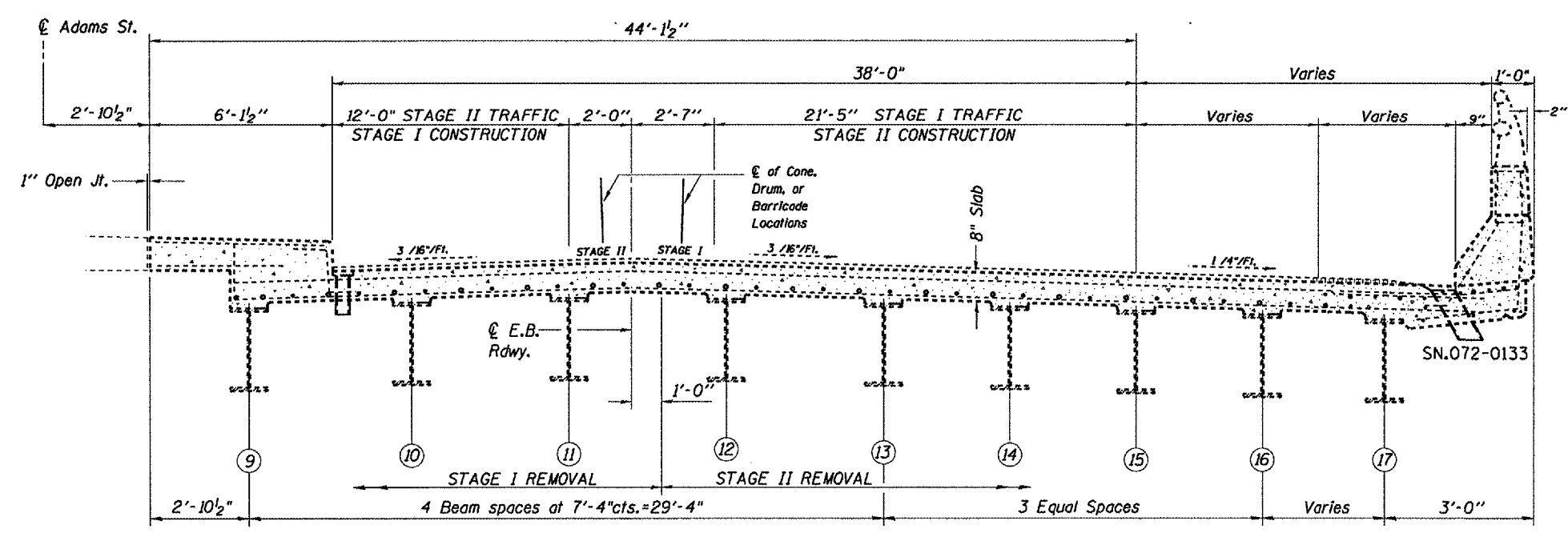

CROSS SECTION
(EastBound Deck)

REVISIONS	
NAME	DATE

SN 072-0012 / 072-0133
Adams St. over Clark St. & B.N. R.R.

ILLINOIS DEPARTMENT OF TRANSPORTATION
STAGE REMOVAL AND CONSTRUCTION

SCALE: VERT. _____
HORIZ. _____
DATE 06-14-2005
DRAWN BY CEJ
CHECKED BY _____

PLT DATE = DATE
FILE NAME = FILE
PLOT SCALE = SCALES
REFERENCE = REF

F.A.B. RTE.	SECTION	COUNTY	TOTAL SHEETS	SHEET NO.
317		PEORIA	27	9
STA. 211+60.95		TO STA. 219+27.65		
FED. ROAD DIST. NO. 4 ILLINOIS FED. AID PROJECT				
• 04 Joint Repair 2006				

Two-Part, Rapid-Cure 100% Silicone Jt. Sealer

All exposed and accessible (from the top) steel surfaces shall be blasted to near white condition, then metalized. In sidewalk and parapet wall areas w/o steel, the concrete shall be cleaned by blasting and blowing clean until dust-free and dry prior to sealant application; metalizing of concrete is not required.

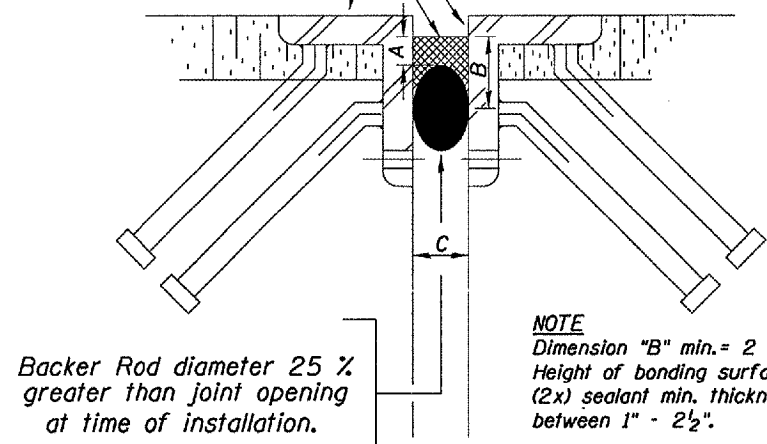

NOTE
Dimension "B" min. = 2 x "A" (where "A" = 3/8" to 5/8"). Height of bonding surface should be approximately (2x) sealant min. thickness. Dimension "C" varies between 1" - 2 1/2".

PROPOSED BRIDGE JOINT SEALER DETAIL

12"w. x .060"th. EPDM. All Transverse & Longitudinal Median Joints only

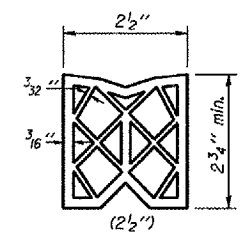

EXISTING PREFORMED JOINT SEAL

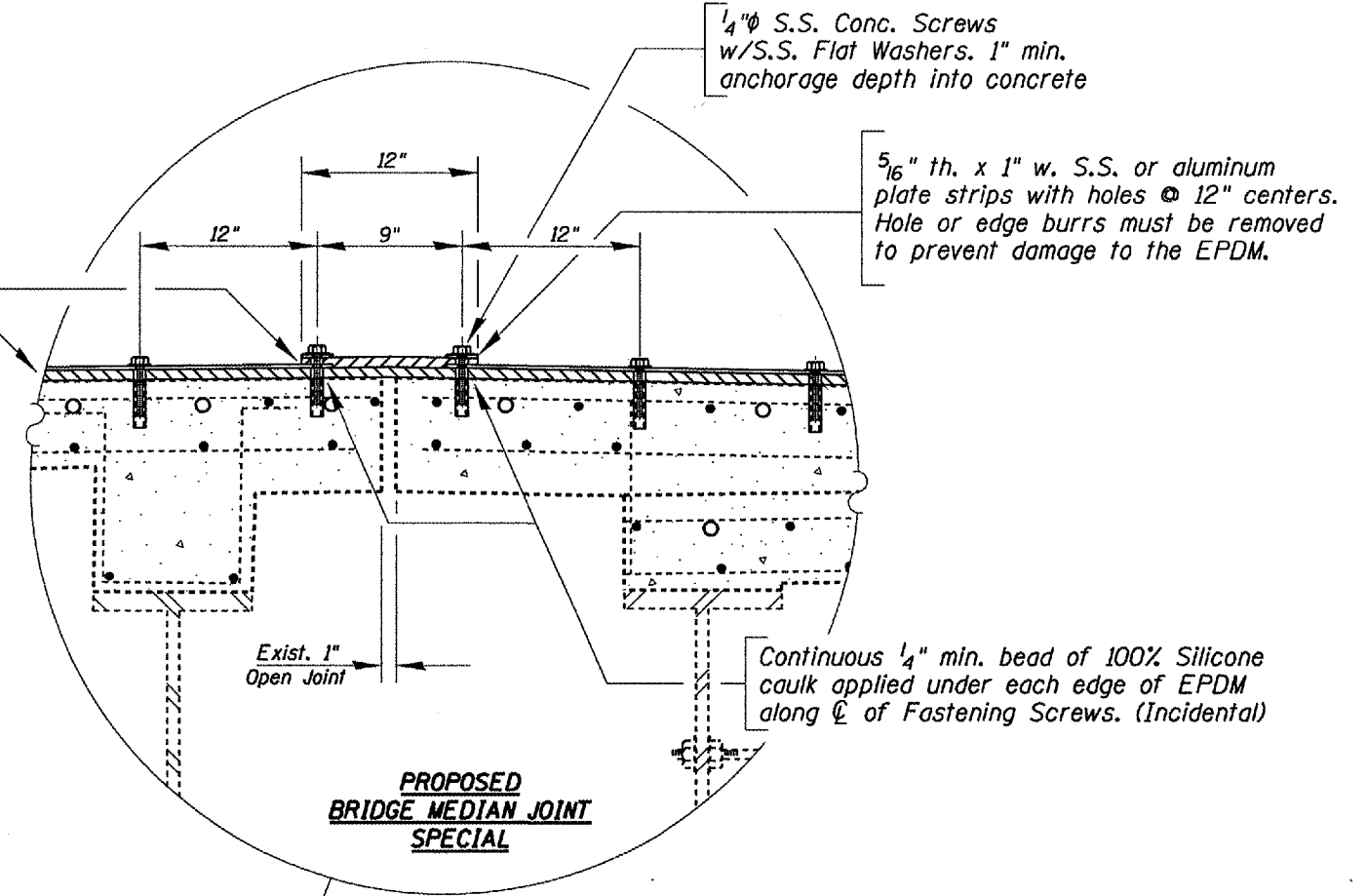

PROPOSED BRIDGE MEDIAN JOINT SPECIAL

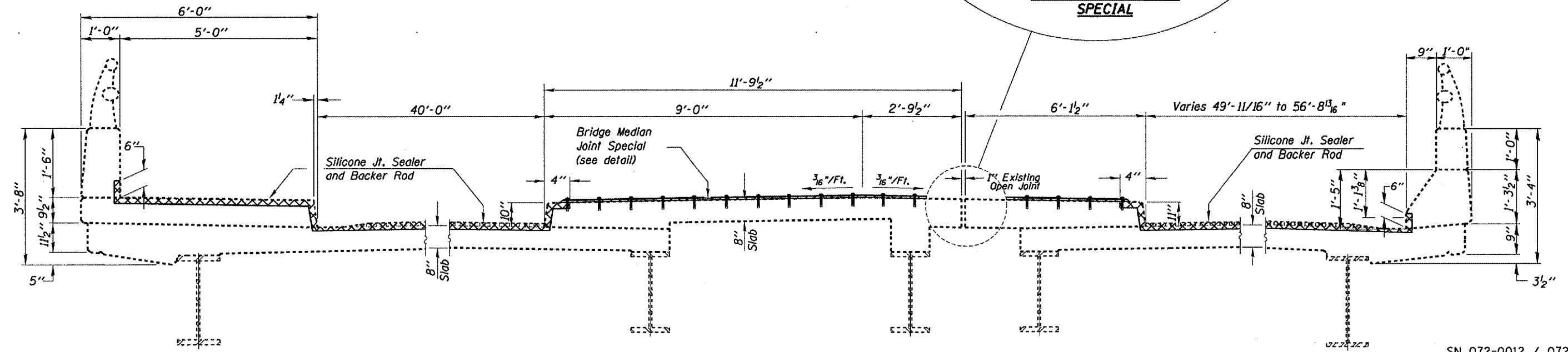

EXISTING BRIDGE DECK CROSS SECTION
(SN. 072-0012 & 072-0133) Looking East

BILL OF MATERIAL

ITEM	UNIT	QUANTITY
BLAST CLEANING BRIDGE JOINT STEEL	FOOT	687
THERMAL SPRAY (METALIZING) BRIDGE JOINT STEEL	FOOT	643
SILICONE JOINT SEALER	FOOT	687
BRIDGE MEDIAN EPDM SPECIAL	FOOT	890

PLT DATE
FILE NAME
PLOT SCALE
REFERENCE

REVISIONS	
NAME	DATE

ILLINOIS DEPARTMENT OF TRANSPORTATION

DECK & JOINT DETAILS

SCALE: VERT. HORIZ. DATE 08-16-2005

DRAWN BY CEJ CHECKED BY

NOTE
ALL DIMENSIONS TAKEN AT RIGHT ANGLE TO ROADWAY CENTERLINE.

SN 072-0012 / 072-0133
Adams St. over Clark St.

F.A.I. RTE.	SECTION	COUNTY	TOTAL SHEETS	SHEET NO.
155		TAZEWELL	27	10
STA. 18+89.42 TO STA. 21+10.58				
FED. ROAD DIST. NO. 4 ILLINOIS FED. AID PROJECT				
• 04 Joint Report 2006				

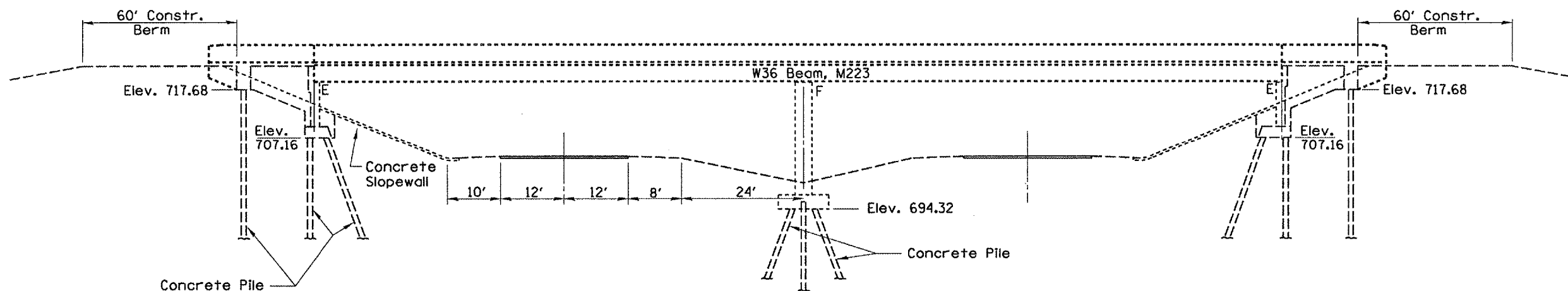

ELEVATION

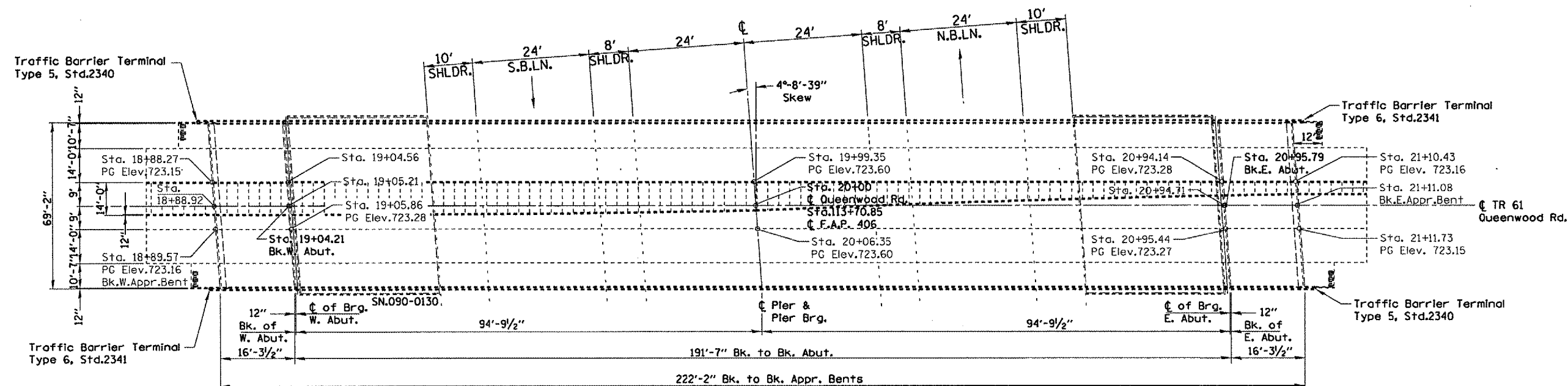

PLAN VIEW

GENERAL NOTES

PLAN DIMENSIONS AND DETAILS RELATIVE TO EXISTING STRUCTURE HAVE BEEN TAKEN FROM EXISTING PLANS AND ARE SUBJECT TO NOMINAL CONSTRUCTION VARIATIONS. IT SHALL BE THE CONTRACTOR'S RESPONSIBILITY TO VERIFY SUCH DIMENSIONS AND DETAILS IN THE FIELD AND MAKE NECESSARY APPROVED ADJUSTMENTS PRIOR TO WORK OR THE ORDERING OF MATERIALS. SUCH VARIATIONS SHALL NOT BE CAUSE FOR ADDITIONAL COMPENSATION FOR A CHANGE IN THE SCOPE OF THE WORK. HOWEVER, THE CONTRACTOR WILL BE PAID FOR THE QUANTITY ACTUALLY FURNISHED AT THE UNIT PRICE BID FOR THE PROJECT.

• USE 2-PART RAPID-CURE 100% SILICONE SEALER ONLY - NO OPTION. SEE SPECIAL PROVISIONS.

S.N. 090-0130
Queenwood Rd.
over I-155

REVISIONS	
NAME	DATE

ILLINOIS DEPARTMENT OF TRANSPORTATION

GENERAL PLAN AND ELEVATION

SCALE: VERT. 1"=10'
HORIZ. 1"=40'
DATE 08-30-2004

DRAWN BY CEJ
CHECKED BY

FOR INFORMATION ONLY

PLT DATE * DATE
FILE NAME * SHEET
PLT SCALE * SCALES
REFERENCE * SHEET

F.A.I. RTE.	SECTION	COUNTY	TOTAL SHEETS	SHEET NO.
155		TAZEWELL	27	12
STA. 18+89.42 TO STA. 21+10.58				
FED. ROAD DIST. NO. 4 ILLINOIS FED. AID PROJECT				
• 04 Joint Report 2006				

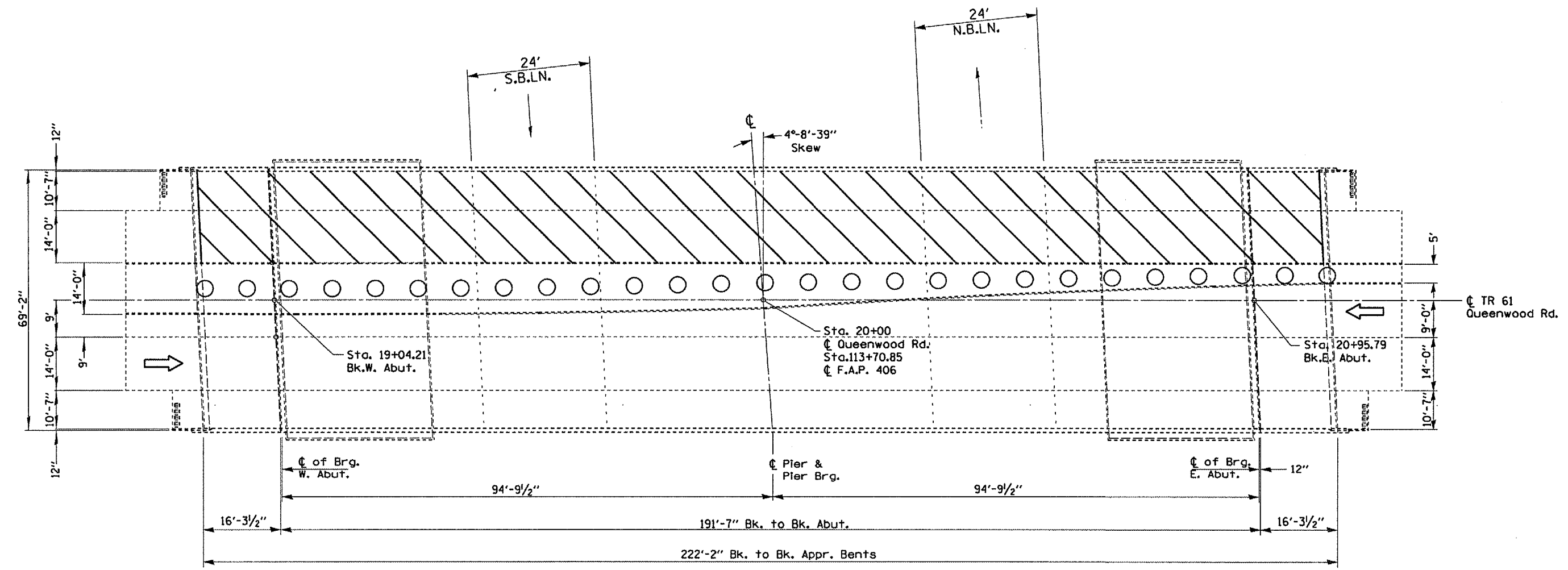

Symbols

	Work Area
	Drum w/steady burning light
	Sign
	Type III barricade with flashing lights

Stage I Traffic & Control

NOTE

Refer to Highway Standard 701201 for exact placement of traffic management devices and other clarifications as construction staging symbols and dimensioning were duplicated off of this standard. Additional Type III barricades shall also be placed at each end of the lane closure during work hours.

S.N. 090-0130
Queenwood Rd.
over I-155

REVISIONS	
NAME	DATE

ILLINOIS DEPARTMENT OF TRANSPORTATION

TRAFFIC STAGING PLAN

SCALE: VERT. _____
HORIZ. _____
DATE 01-28-2004

DRAWN BY CEJ
CHECKED BY _____

DATE _____
 DRAWN BY _____
 CHECKED BY _____
 PLOT SCALE _____
 REFERENCE _____

F.A.I. RTE.	SECTION	COUNTY	TOTAL SHEETS	SHEET NO.
155		TAZEWELL	27	13
STA. 18+89.42		TO STA. 21+10.58		
FED. ROAD DIST. NO. 4 ILLINOIS FED. AID PROJECT				
• 04 Joint Repair 2005				

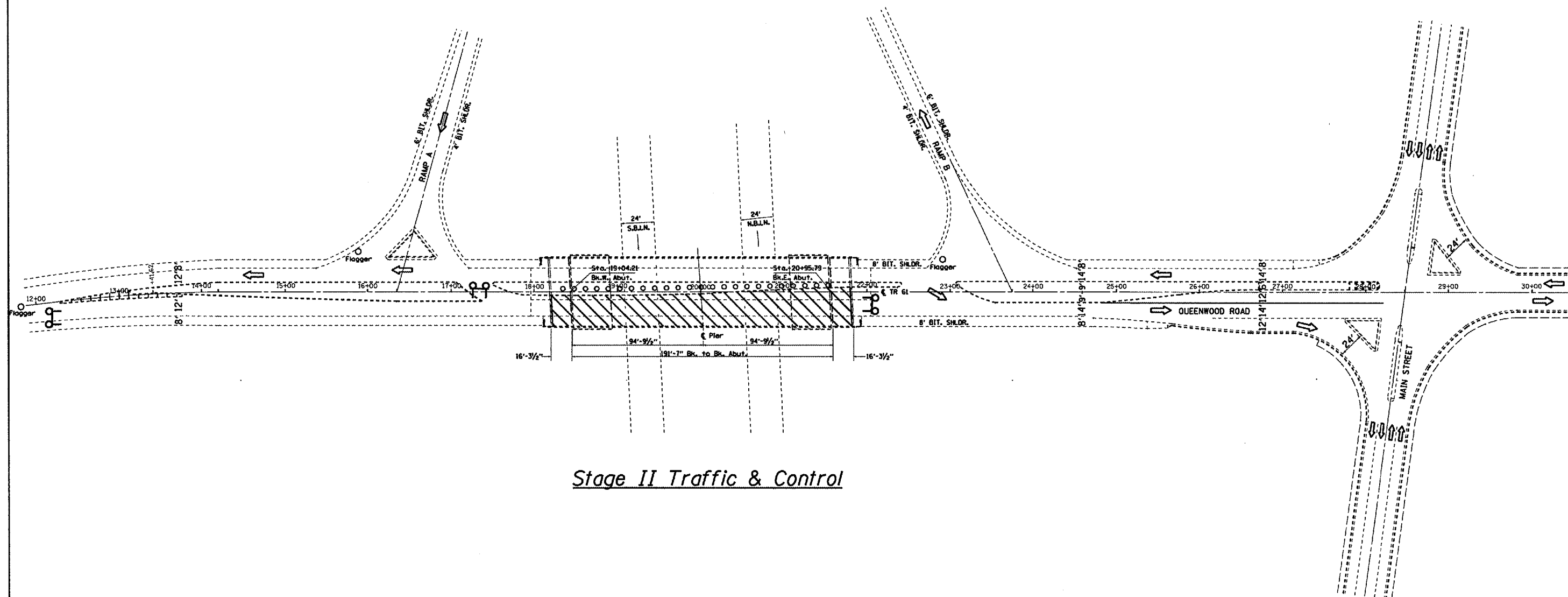

Stage II Traffic & Control

	Work Area
	Drum w/steady burning light
	Sign
	Type III barricade with flashing lights

NOTE

Refer to Highway Standard 701201 for exact placement of traffic management devices and other clarifications as construction staging symbols and dimensioning were duplicated off of this standard. Additional Type III barricades shall also be placed at each end of the lane closure during work hours.

S.N. 090-0130
Queenwood Rd.
over I-155

REVISIONS	
NAME	DATE

ILLINOIS DEPARTMENT OF TRANSPORTATION

TRAFFIC STAGING PLAN

SCALE: VERT.
HORIZ.
DATE 01-28-2004

DRAWN BY CEJ
CHECKED BY

PLOT DATE • DWG#
SCALE • SHEET#
REFERENCE • REF#

F.A.I. RTE.	SECTION	COUNTY	TOTAL SHEETS	SHEET NO.
155		TAZEWELL	27	14
STA. 18+89.42		TO STA. 21+10.58		
FED. ROAD DIST. NO. 4 ILLINOIS FED. AID PROJECT				
• 04 Joint Rep'd r 2006				

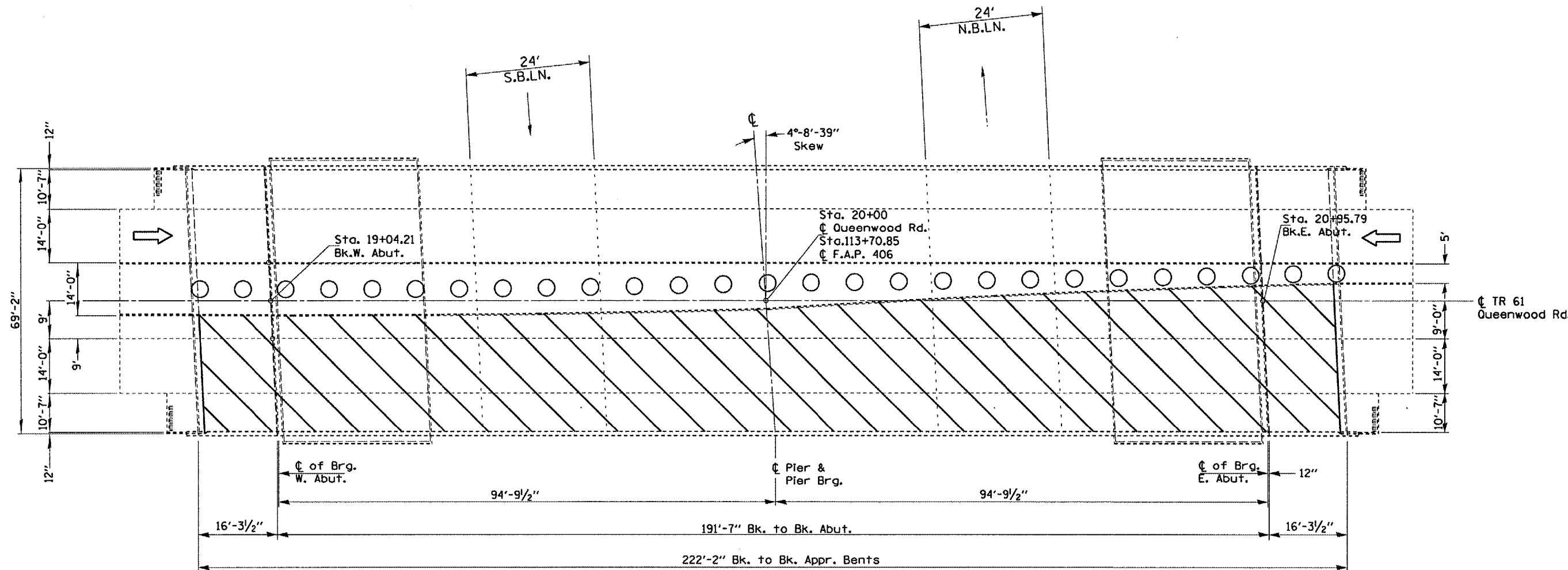

Stage II Traffic & Control

Symbols

	Work Area
	Drum w/steady burning light
	Sign
	Type III barricade with flashing lights

NOTES

Refer to Highway Standard 701201 for exact placement of traffic management devices and other clarifications as construction staging symbols and dimensioning were duplicated off of this standard. Additional Type III barricades shall also be placed at each end of the lane closure during work hours.

S.N. 090-0130
Queenwood Rd.
over I-155

REVISIONS	
NAME	DATE

ILLINOIS DEPARTMENT OF TRANSPORTATION

TRAFFIC STAGING PLAN

SCALE: VERT.
HORIZ.
DATE 01-28-2004

DRAWN BY CEJ
CHECKED BY

F.A.I. RTE.	SECTION	COUNTY	TOTAL SHEETS	SHEET NO.
155		TAZEWELL	27	17
STA. 18+89.42		TO STA. 21+10.58		
FED. ROAD DIST. NO. 4 ILLINOIS FED. AID PROJECT				
• 04 Joint Repair 2006				

All exposed and accessible steel surfaces shall be blasted to near white condition, then metalized. In sidewalk, median, and parapet wall areas w/o steel, the concrete shall be cleaned by blasting and blowing clean until dust-free and dry prior to sealant application. Metalizing of concrete is not required.

Two-Part, Rapid-Cure 100% Silicone Jt. Sealer

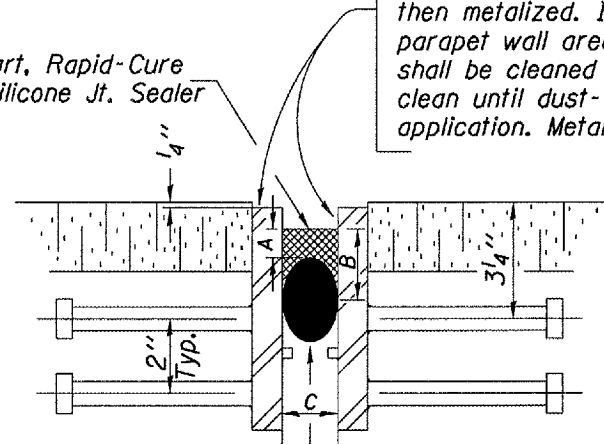

Backer Rod diameter 25% greater than joint opening at time of installation.

NOTE
 Dimension "B" min. = 2 x "A" (where "A" = 3/8" to 5/8")
 Height of bonding surface should be twice the sealant min. thickness.
 Dimension "C" varies between 2"-2 1/2".

PROPOSED BRIDGE JOINT SEALER DETAIL

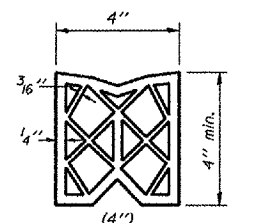

EXISTING PREFORMED JOINT SEAL

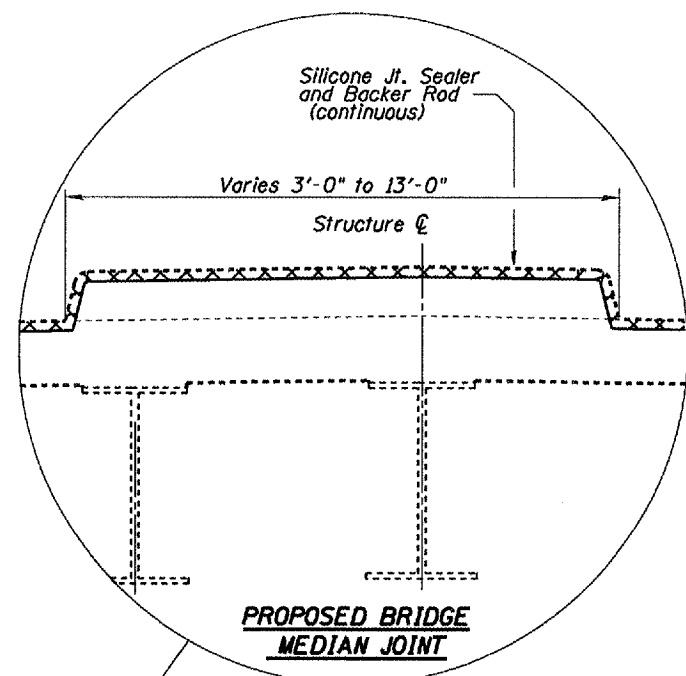

PROPOSED BRIDGE MEDIAN JOINT

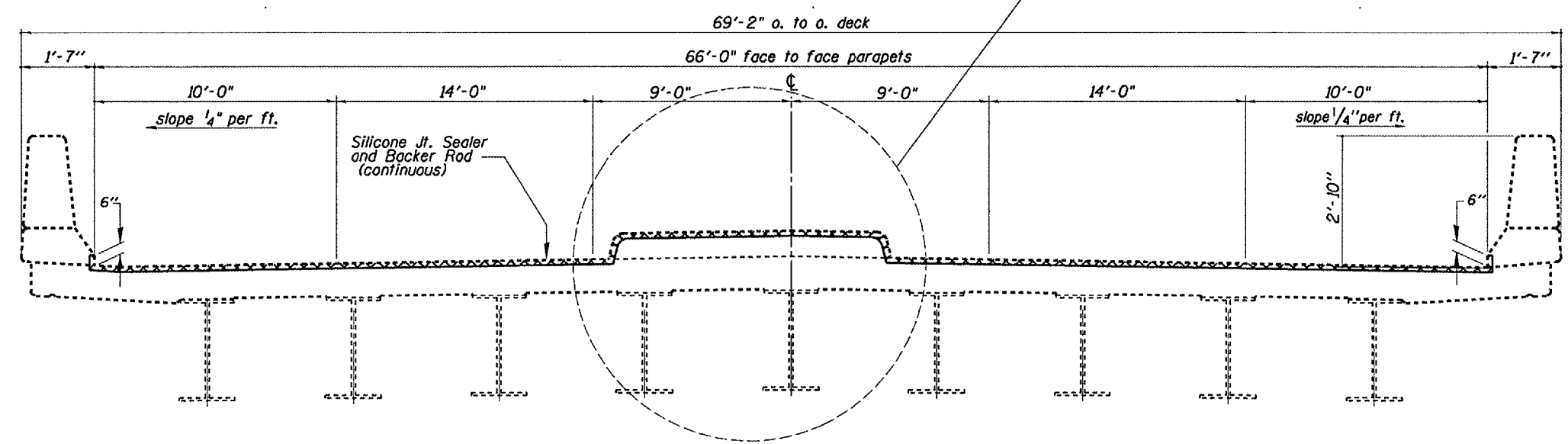

EXISTING BRIDGE DECK CROSS SECTION
 SN. 090-0130 (Looking East near Abutment)

BILL OF MATERIAL

ITEM	UNIT	QUANTITY
BLAST CLEANING BRIDGE JOINT STEEL	FOOT	141
THERMAL SPRAYING (METALIZING) BRIDGE JOINT STEEL	FOOT	132
SILICONE JOINT SEALER	FOOT	141

PLOT DATE * NOTES * FILES * FILE NAME * PLOT SCALE * SCALES * REFERENCE * DRP'S

REVISIONS	
NAME	DATE

ILLINOIS DEPARTMENT OF TRANSPORTATION
DECK & JOINT DETAILS
 SCALE: VERT. DRAWN BY CEJ
 HORIZ. CHECKED BY
 DATE 08-16-2005

NOTE
 ALL DIMENSIONS TAKEN AT RIGHT ANGLE TO ROADWAY CENTERLINE.

S.N. 090-0130
 Queenwood Rd.
 over I-155

F.A.I. RTE.	SECTION	COUNTY	TOTAL SHEETS	SHEET NO.
155		TAZEWELL	27	18
STA. 28+18.38 TO STA. 31+04.76				
FED. ROAD DIST. NO. 4 ILLINOIS FED. AID PROJECT				
• 04 Joint Repair 2006				

B.M. #29A Sta. 716+10
 Chiseled "□" in S. end of
 W. headwall A.R.C.
 Elev. 616.43

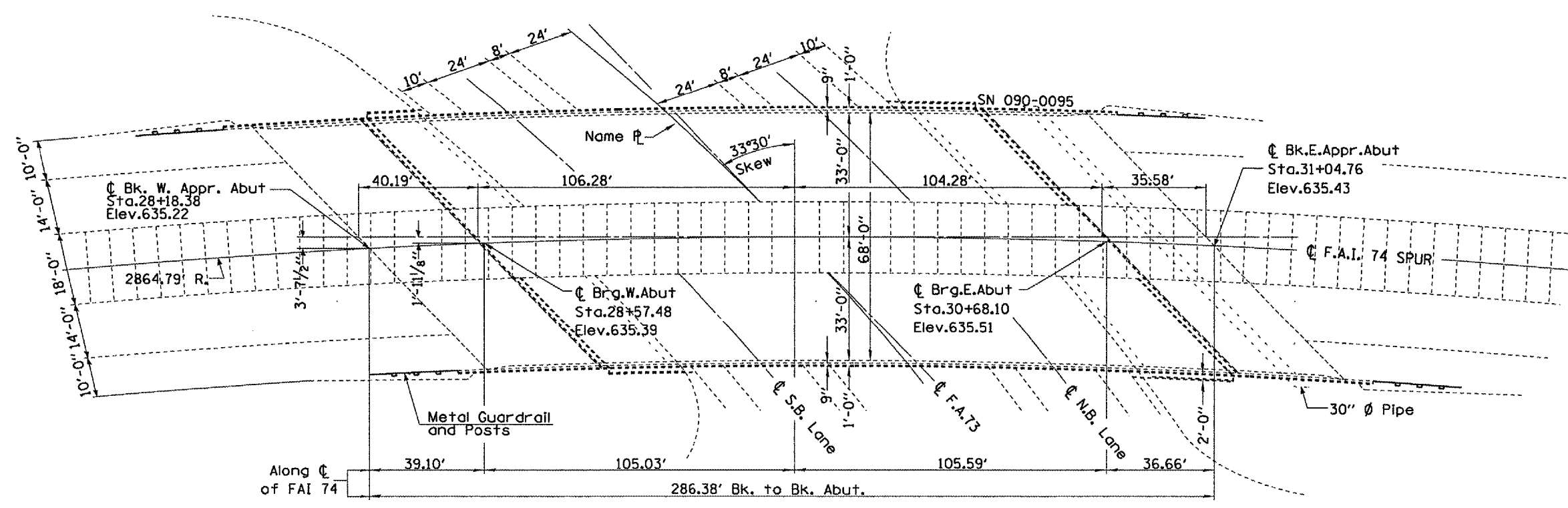
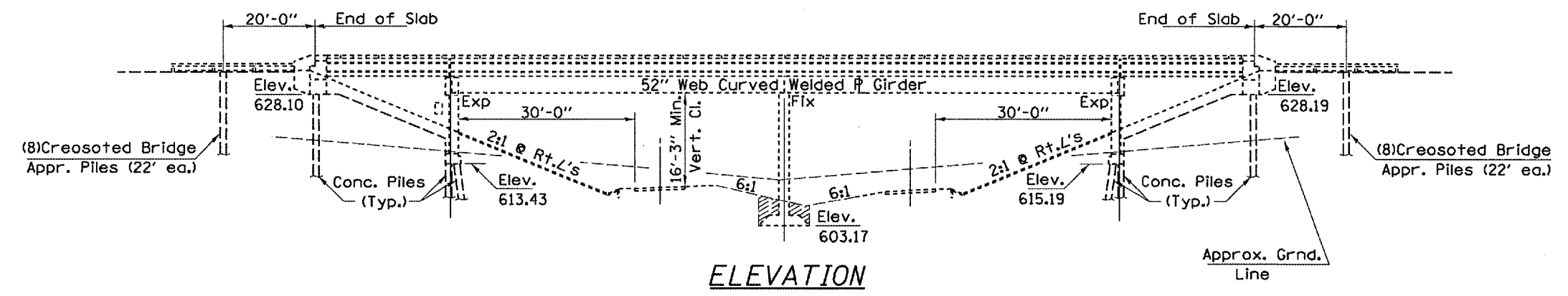

GENERAL NOTES

PLAN DIMENSIONS AND DETAILS RELATIVE TO EXISTING STRUCTURE HAVE BEEN TAKEN FROM EXISTING PLANS AND ARE SUBJECT TO NOMINAL CONSTRUCTION VARIATIONS. IT SHALL BE THE CONTRACTOR'S RESPONSIBILITY TO VERIFY SUCH DIMENSIONS AND DETAILS IN THE FIELD AND MAKE NECESSARY APPROVED ADJUSTMENTS PRIOR TO WORK OR THE ORDERING OF MATERIALS. SUCH VARIATIONS SHALL NOT BE CAUSE FOR ADDITIONAL COMPENSATION FOR A CHANGE IN THE SCOPE OF THE WORK. HOWEVER, THE CONTRACTOR WILL BE PAID FOR THE QUANTITY ACTUALLY FURNISHED AT THE UNIT PRICE BID FOR THE PROJECT.

• USE 2-PART RAPID-CURE 100% SILICONE SEALER ONLY - NO OPTION. SEE SPECIAL PROVISIONS.

FOR INFORMATION ONLY

PLT DATE * SHEETS
 FILE NAME * SHEETS
 PLOT SCALE * SHEETS
 REFERENCE * SHEETS

REVISIONS	
NAME	DATE

ILLINOIS DEPARTMENT OF TRANSPORTATION

PLAN AND ELEVATION

SCALE: VERT. _____
 HORIZ. _____
 DATE 06-22-2005

DRAWN BY CEJ
 CHECKED BY _____

SN 090-0095
 Il. 122E over I-155

F.A.I. RTE.	SECTION	COUNTY	TOTAL SHEETS	SHEET NO.
155		TAZEWELL	27	19
STA. 28+18.38		TO STA. 31+04.76		
FED. ROAD DIST. NO. 4 ILLINOIS FED. AID PROJECT				
• 04 Joint Repair 2006				

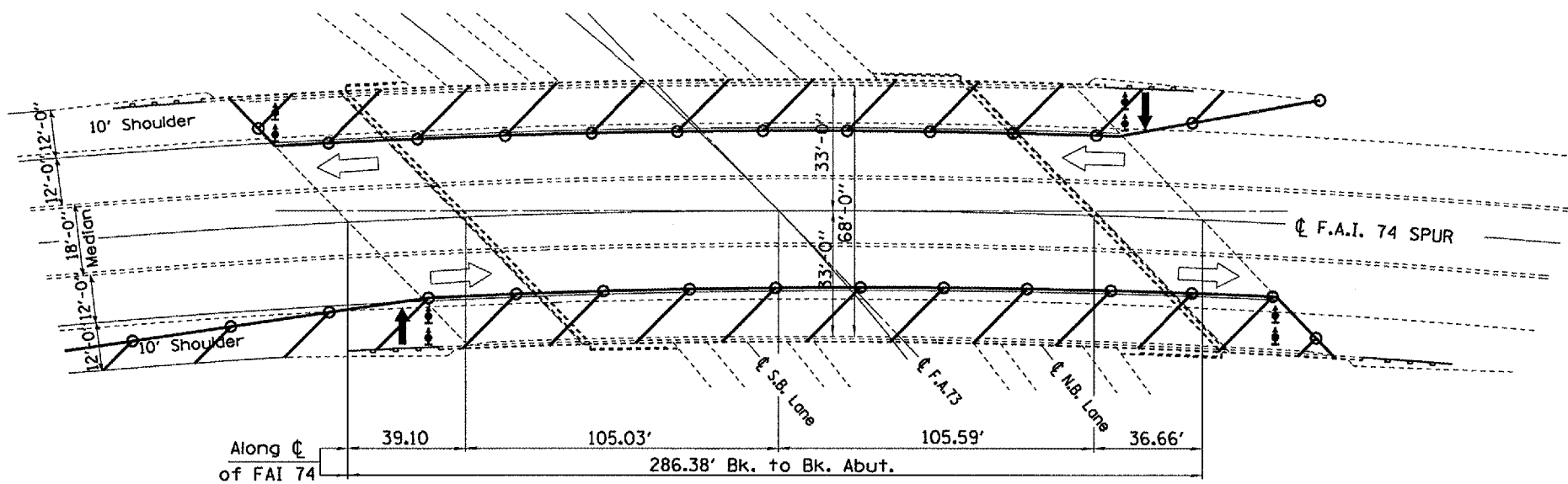

Stage I
Traffic & Control

	Arrow Board
	Work Area
	Sign
	Direction Indicator barricade with steady burn monodirectional light
	Cone, Drum, or Barricade
	Flagger w/traffic control sign
	Type III barricade w/flashing lights

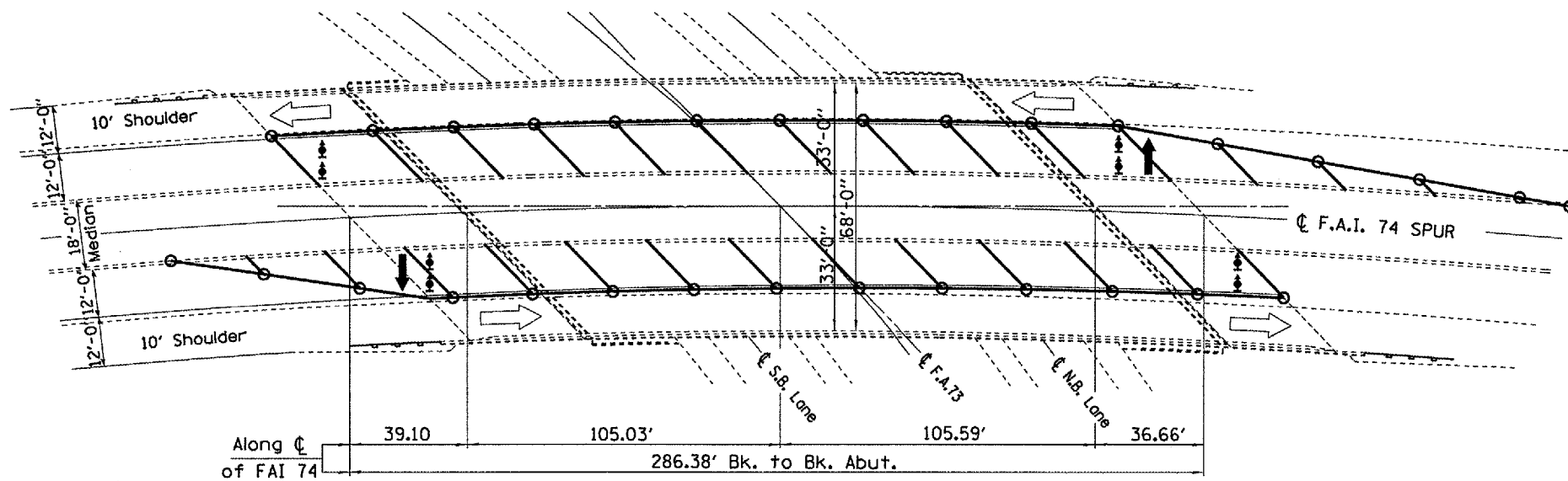

Stage II
Traffic & Control

NOTE

Refer to Highway Standard 701601 for exact placement of traffic management devices and other clarifications as construction staging symbols and dimensioning were duplicated off of this standard.

SN 090-0095
Il. 122E over I-155

REVISIONS	
NAME	DATE

ILLINOIS DEPARTMENT OF TRANSPORTATION

TRAFFIC
STAGING PLAN

SCALE: VERT.
HORIZ.
DATE 06-24-2005

DRAWN BY CEJ
CHECKED BY

F.A.I. RTE.	SECTION	COUNTY	TOTAL SHEETS	SHEET NO.
155		TAZEWELL	27	20
STA. 28+18.38		TO STA. 31+04.76		
FED. ROAD DIST. NO. 4		ILLINOIS FED. AID PROJECT		
• 04 Joint Repair 2006				

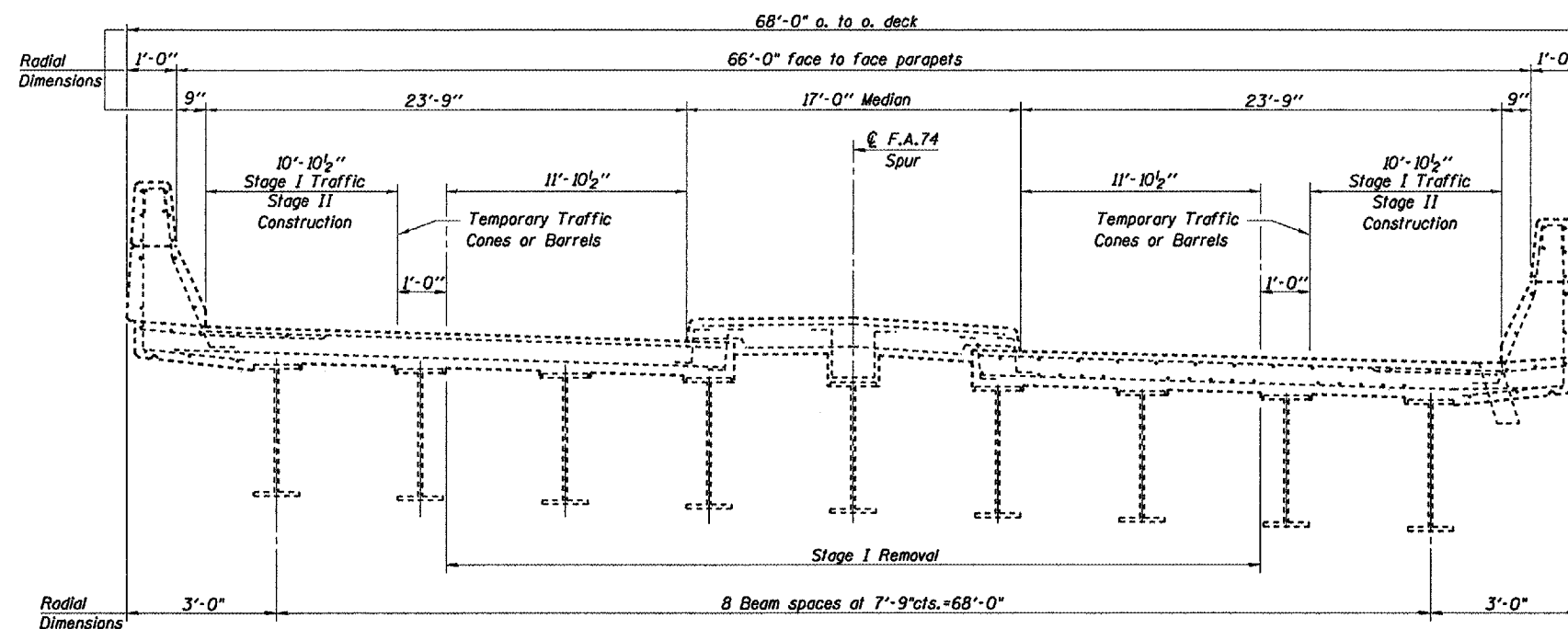

CROSS SECTION
(Stage I)

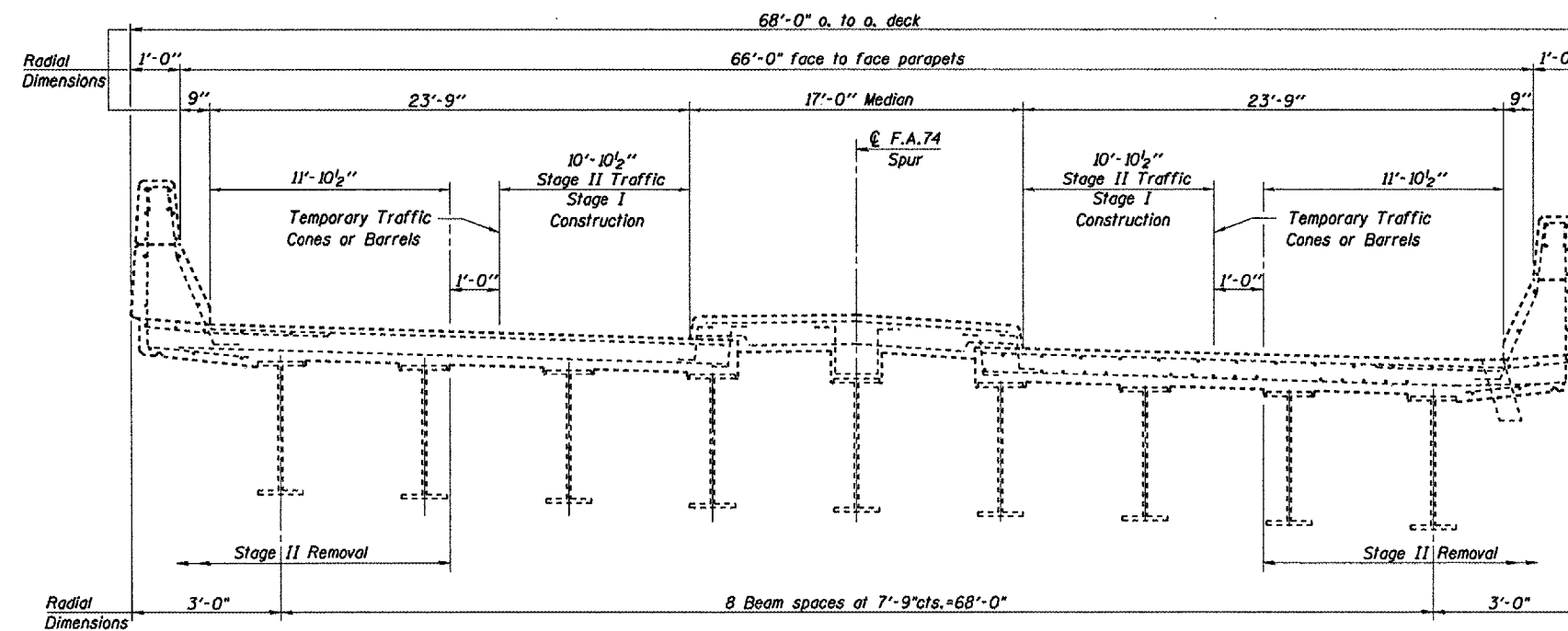

CROSS SECTION
(Stage II)

SN 090-0095
IL 122E over I-155

REVISIONS	
NAME	DATE

ILLINOIS DEPARTMENT OF TRANSPORTATION
STAGE REMOVAL AND CONSTRUCTION

SCALE: VERT.
HORIZ.
DATE 06-29-2005

DRAWN BY CEJ
CHECKED BY

PLOT DATE * DATE *
PLOT SCALE * SCALE *
PLOT REFERENCE * REF *

F.A.I. RTE.	SECTION	COUNTY	TOTAL SHEETS	SHEET NO.
155		TAZEWELL	27	21
STA. 28+18.38		TO STA. 31+04.76		
FED. ROAD DIST. NO. 4		ILLINOIS FED. AID PROJECT		
• 04 Joint Repair 2006				

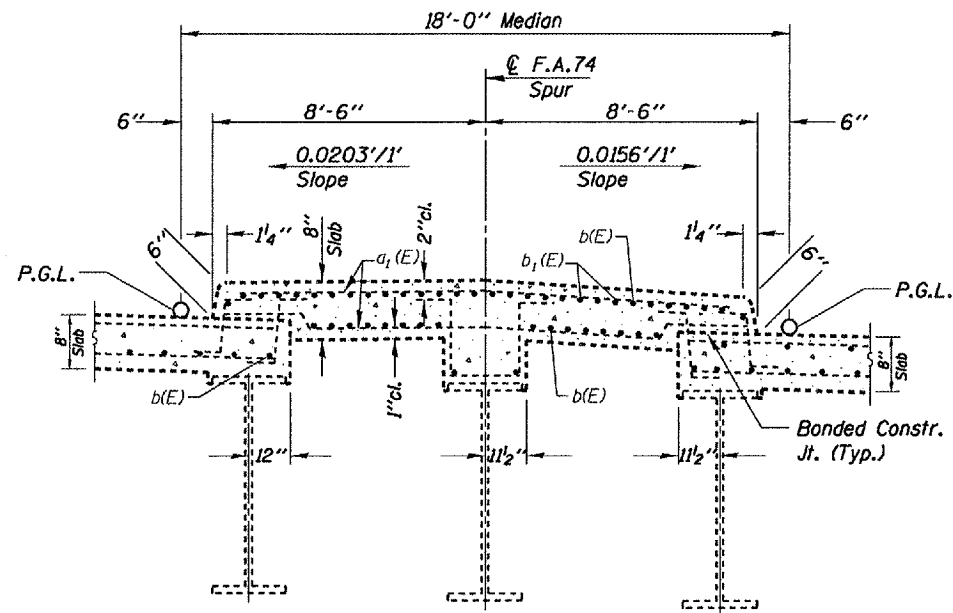

SECTION THRU MEDIAN
(Looking East)

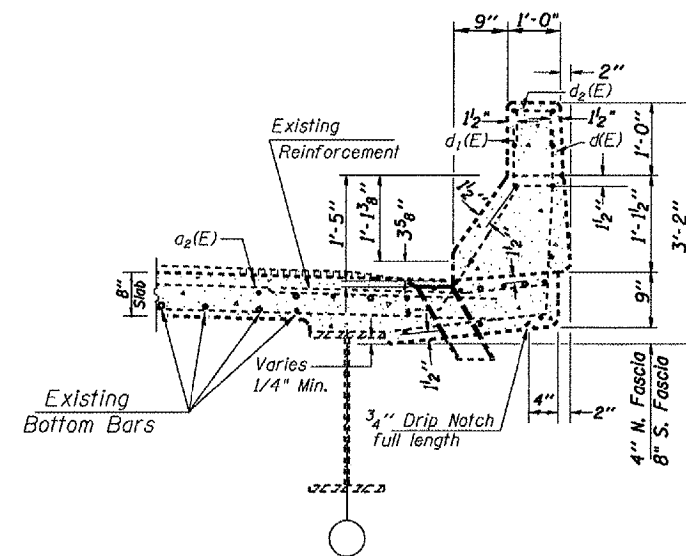

SECTION THRU PARAPET

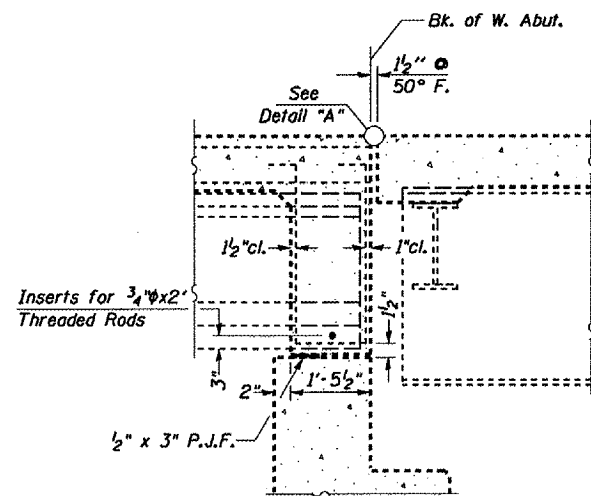

SECTION A-A

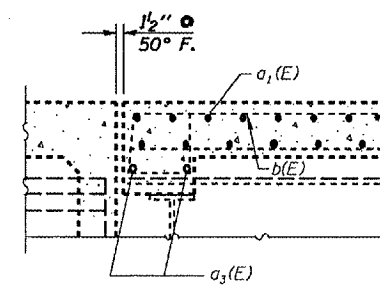

SECTION C-C

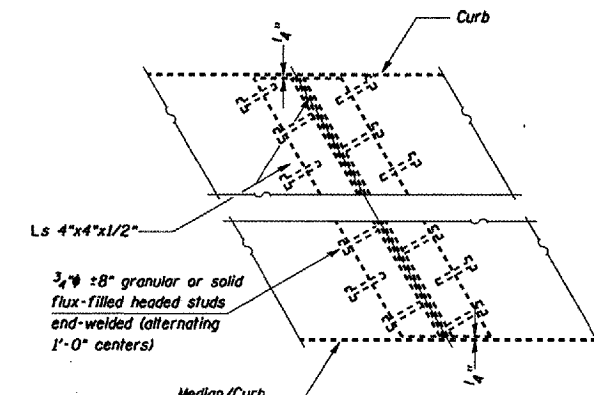

Plan of Expansion Angles

FOR INFORMATION ONLY

PLT DATE
PLT SCALE
REFERENCE
REVISED
SCALE
DATE

REVISIONS	
NAME	DATE

SN 090-0095
IL 122E over I-155

ILLINOIS DEPARTMENT OF TRANSPORTATION

**SUPERSTRUCTURE
DETAILS**

SCALE: VERT.
HORIZ.
DATE 06-30-2005

DRAWN BY CEJ
CHECKED BY

F.A.I. RTE.	SECTION	COUNTY	TOTAL SHEETS	SHEET NO.
155	*	TAZEWELL	27	22
STA. 18+89.42		TO STA. 21+10.58		
FED. ROAD DIST. NO. 4 ILLINOIS FED. AID PROJECT				
* 04 Joint Repair 2006				

Two-Part, Rapid-Cure 100% Silicone Jt. Sealer

All exposed and accessible steel surfaces shall be blasted to near white condition, then metalized. In sidewalk, median, and parapet wall areas w/o steel, the concrete shall be cleaned by blasting and blowing clean until dust-free and dry prior to sealant application. Metalizing of concrete is not required.

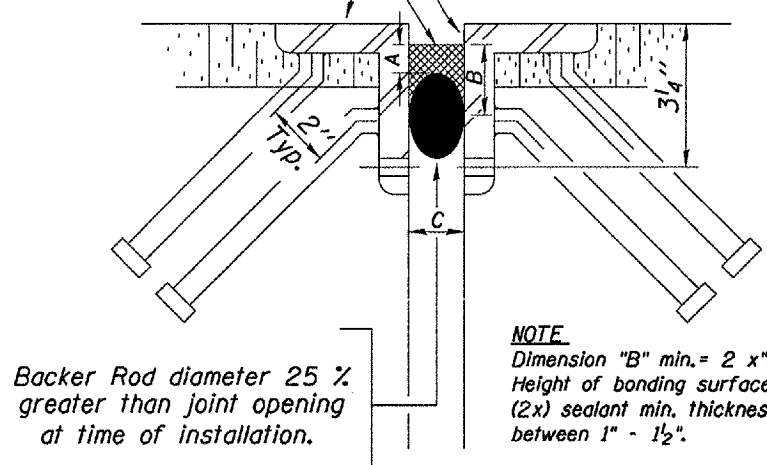

Backer Rod diameter 25 % greater than joint opening at time of installation.

NOTE.
Dimension "B" min. = 2 x "A" (where "A" = 3/8" to 5/8").
Height of bonding surface should be approximately (2x) sealant min. thickness. Dimension "C" varies between 1" - 1 1/2".

PROPOSED BRIDGE JOINT SEALER DETAIL

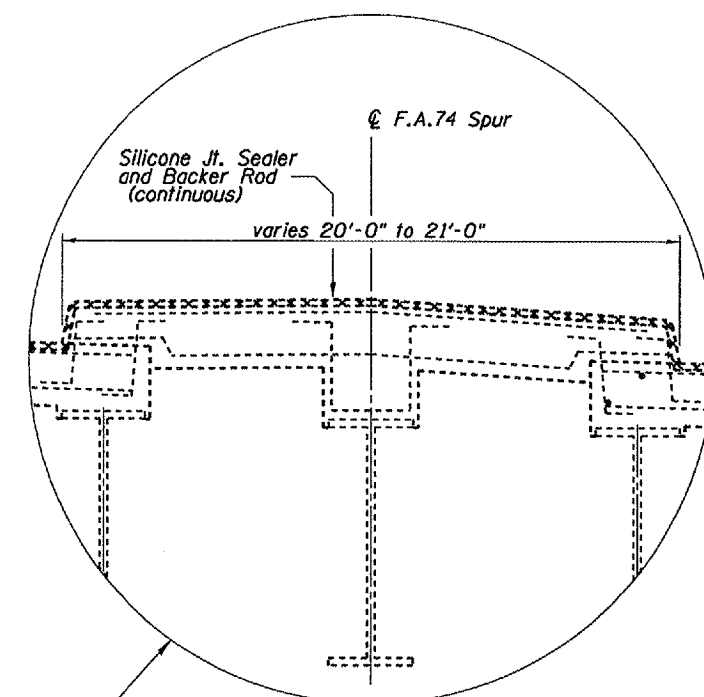

PROPOSED MEDIAN JOINT DETAIL

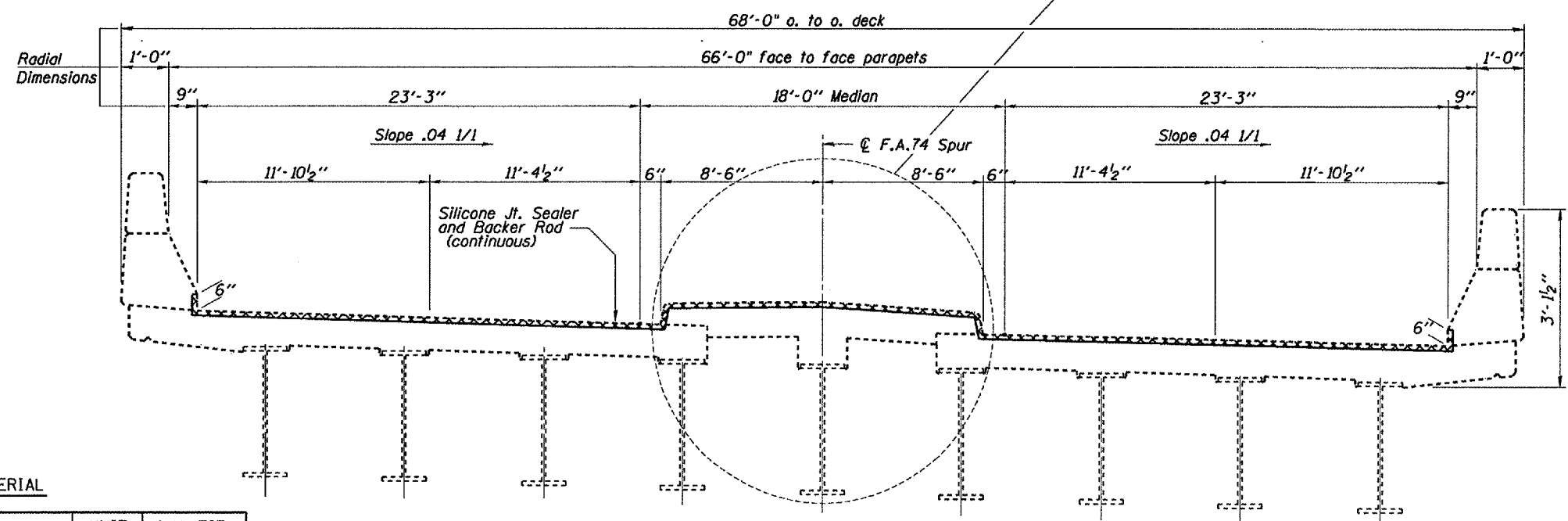

EXISTING BRIDGE DECK CROSS SECTION
SN. 090-0095 (Looking East near Abutment)

BILL OF MATERIAL

ITEM	UNIT	QUANTITY
BLAST CLEANING BRIDGE JOINT STEEL	FOOT	165
THERMAL SPRAYING (METALIZING) BRIDGE JOINT STEEL	FOOT	115
SILICONE JOINT SEALER	FOOT	165
BITUMINOUS REMOVAL (MISCELLANEOUS)	SO.YD.	8.0
BITUMINOUS MIXTURE FOR PATCHING	TON	1.0

REVISIONS	
NAME	DATE

ILLINOIS DEPARTMENT OF TRANSPORTATION

DECK & JOINT DETAILS

SCALE: VERT. _____
HORIZ. _____
DATE: 08-16-2005

DRAWN BY: CEJ
CHECKED BY: _____

NOTE
ALL DIMENSIONS TAKEN AT RIGHT ANGLE TO ROADWAY CENTERLINE.

PLOT DATE: _____
FILE NAME: _____
PLOT SCALE: _____
REFERENCE: _____

SN 090-0095
II. 122E over I-155

F.A.I. RTE.	SECTION	COUNTY	TOTAL SHEETS	SHEET NO.
155	-	TAZEWELL	27	23
STA. 744+80.17 TO STA. 746+58.00				
FED. ROAD DIST. NO. 4 ILLINOIS FED. AID PROJECT				
• 04 Joint Repair 2006				

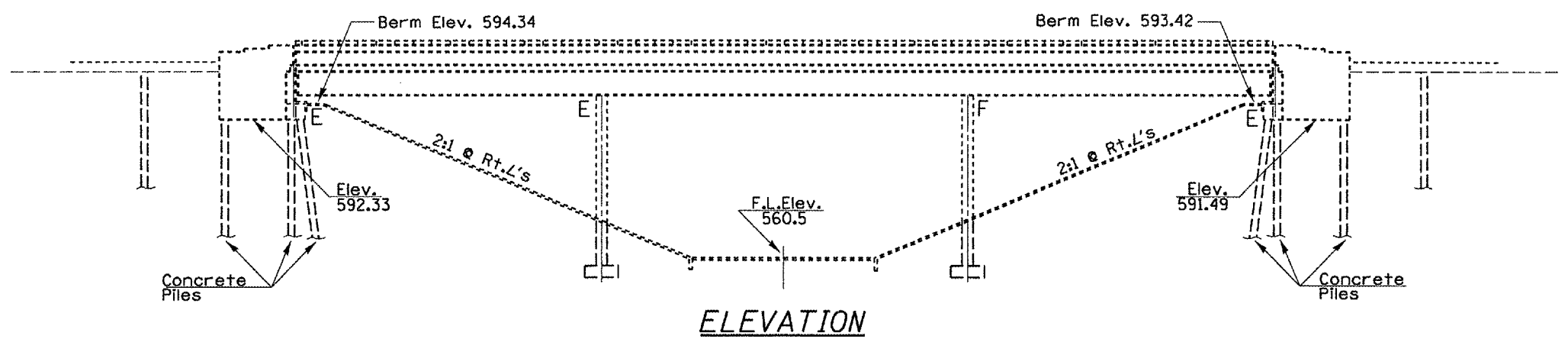

ELEVATION

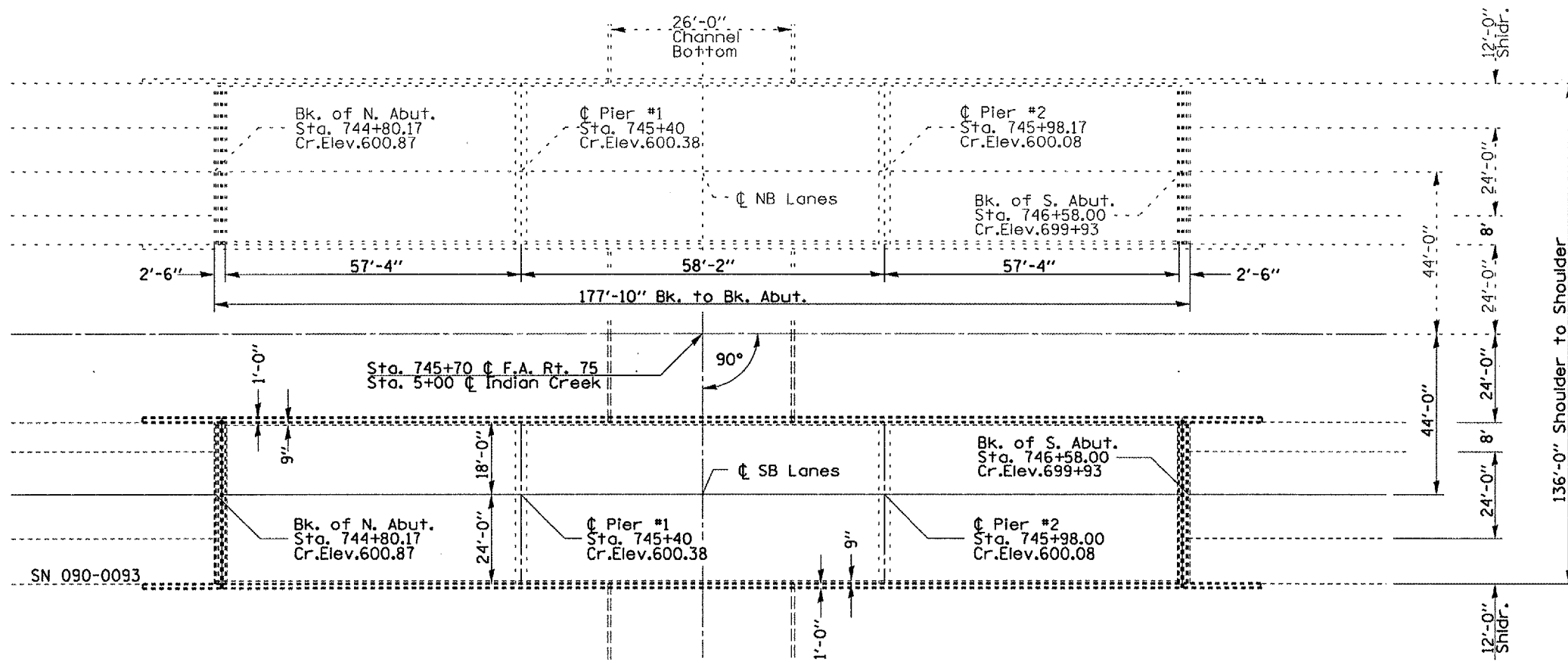

PLAN VIEW

GENERAL NOTES

PLAN DIMENSIONS AND DETAILS RELATIVE TO EXISTING STRUCTURE HAVE BEEN TAKEN FROM EXISTING PLANS AND ARE SUBJECT TO NOMINAL CONSTRUCTION VARIATIONS. IT SHALL BE THE CONTRACTOR'S RESPONSIBILITY TO VERIFY SUCH DIMENSIONS AND DETAILS IN THE FIELD AND MAKE NECESSARY APPROVED ADJUSTMENTS PRIOR TO WORK OR THE ORDERING OF MATERIALS. SUCH VARIATIONS SHALL NOT BE CAUSE FOR ADDITIONAL COMPENSATION FOR A CHANGE IN THE SCOPE OF THE WORK. HOWEVER, THE CONTRACTOR WILL BE PAID FOR THE QUANTITY ACTUALLY FURNISHED AT THE UNIT PRICE BID FOR THE PROJECT.

- USE 2-PART RAPID-CURE 100% SILICONE SEALER ONLY - NO OPTION. SEE SPECIAL PROVISIONS.

FOR INFORMATION ONLY

PLT DATE * STATES
FILE NAME * FILEL
PLT SCALE * SSCALE
REFERENCE * #REF

REVISIONS	
NAME	DATE

ILLINOIS DEPARTMENT OF TRANSPORTATION

SN 090-0093
I-155 SB over
Indian Crk.

PLAN AND ELEVATION

SCALE: VERT.
HORIZ.
DATE 07-14-2005

DRAWN BY CEJ
CHECKED BY

F.A.I. RTE.	SECTION	COUNTY	TOTAL SHEETS	SHEET NO.
155		TAZEWELL	27	24
STA. 744+80.17 TO STA. 746+58.00				
FED. ROAD DIST. NO. 4 ILLINOIS FED. AID PROJECT				
• 04 Joint Repair 2006				

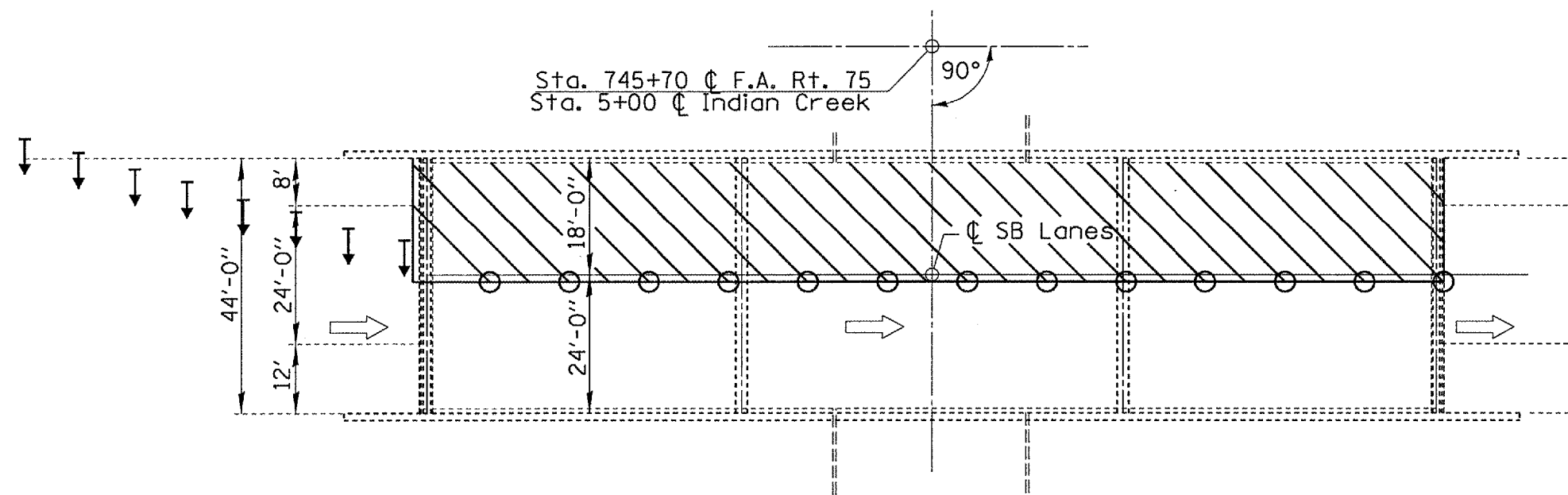

Stage I
Traffic & Control

- Arrow Board
- Work Area
- Sign
- Direction Indicator Barrier
- Cone, Drum, or Barricade
- Flagger w/Traffic Control Sign

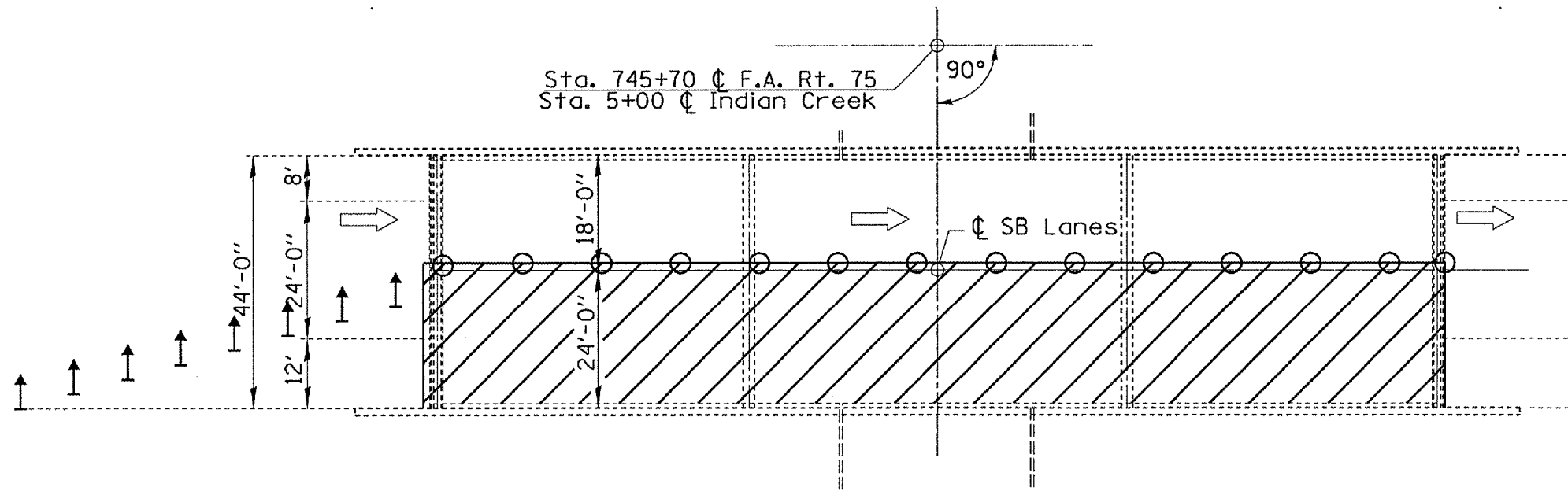

Stage II
Traffic & Control

NOTE:
Refer to Highway Standard 701101 for exact placement of traffic management devices and other clarifications as construction staging symbols and dimensioning were duplicated off of this standard. Reference Highway Standard 701406 for joint removal and replacement.

SN 090-0093
I-155 SB over
Indian Crk.

DATE * * *
FILE NAME * * *
PLOT SCALE * * *
REFERENCE * * *

REVISIONS	
NAME	DATE

ILLINOIS DEPARTMENT OF TRANSPORTATION

TRAFFIC
STAGING PLAN

SCALE: VERT.
HORIZ.
DATE 06-24-2005

DRAWN BY CEJ
CHECKED BY

F.A.I. RTE.	SECTION	COUNTY	TOTAL SHEETS	SHEET NO.
155		TAZEWELL	27	25
STA. 744+80.17 TO STA. 746+58.00				
FED. ROAD DIST. NO. 4 ILLINOIS FED. AID PROJECT				
• 04 Joint Repair 2006				

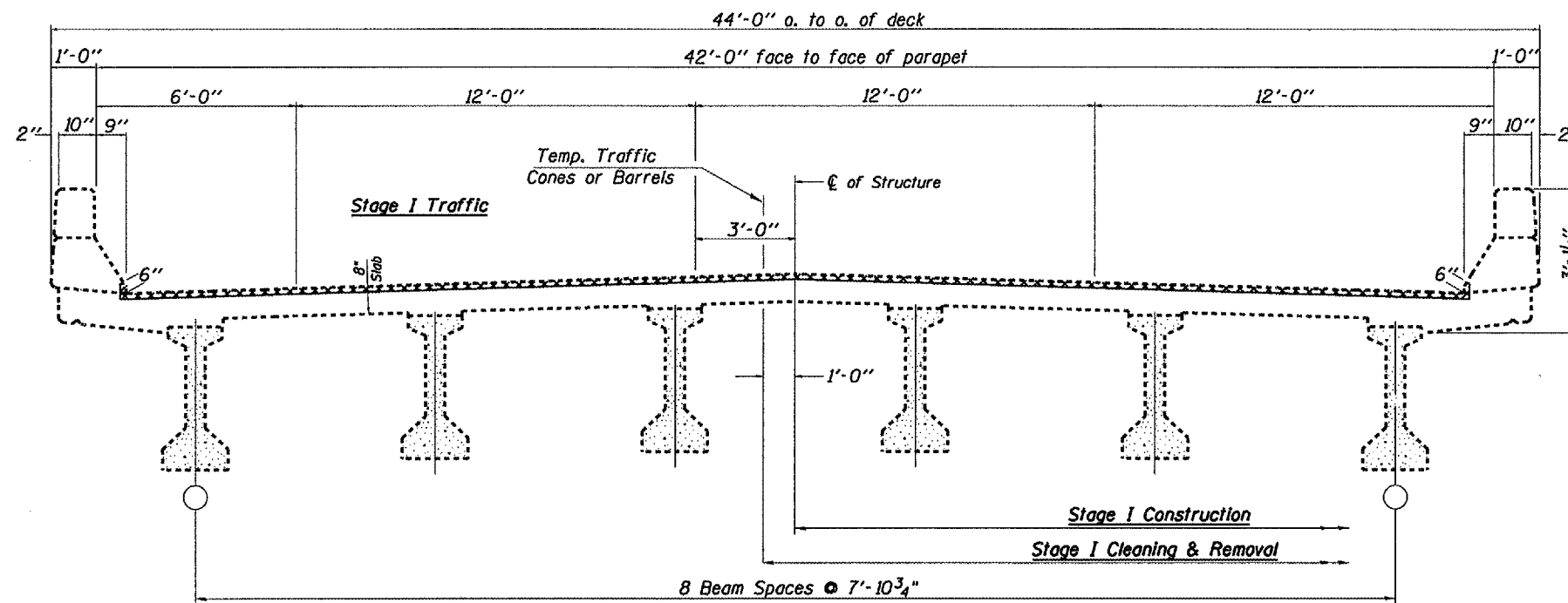

CROSS SECTION
(Looking S.B. in the direction of traffic)

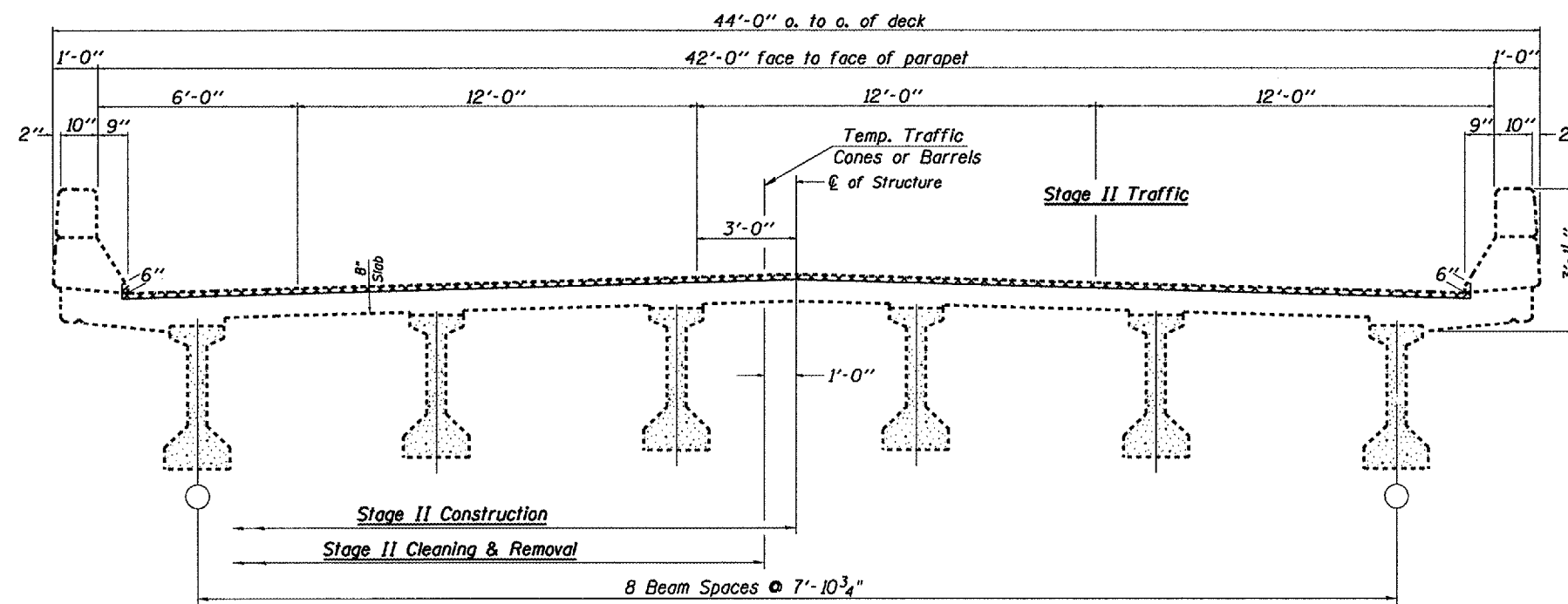

CROSS SECTION
(Looking S.B. in the direction of traffic)

DATE: 06-29-2005
 FILE NAME: I-155 SB over Indian Crk.dwg
 PLOT SCALE: 1/8" = 1'-0"
 REFERENCE: 04 Joint Repair 2006

SN 090-0093
 I-155 SB over
 Indian Crk.

REVISIONS	
NAME	DATE

ILLINOIS DEPARTMENT OF TRANSPORTATION

TRAFFIC STAGING PLAN

SCALE: VERT. 1/8" = 1'-0"
 HORIZ. 1/8" = 1'-0"
 DATE: 06-29-2005

DRAWN BY: CEJ
 CHECKED BY:

F.A.I. RTE.	SECTION	COUNTY	TOTAL SHEETS	SHEET NO.
155		TAZEWELL	27	26
STA. 744+80.17 TO STA. 746+58.00				
FED. ROAD DIST. NO. 4 ILLINOIS FED. AID PROJECT				
• 04 Joint Repair 2006				

All exposed and accessible steel surfaces shall be blasted to near white condition, then metalized. In sidewalk, median, and parapet wall areas w/o steel, the concrete shall be cleaned by blasting and blowing clean until dust-free and dry prior to sealant application. Metalizing of concrete is not required.

Two-Part, Rapid-Cure 100% Silicone Jt. Sealer

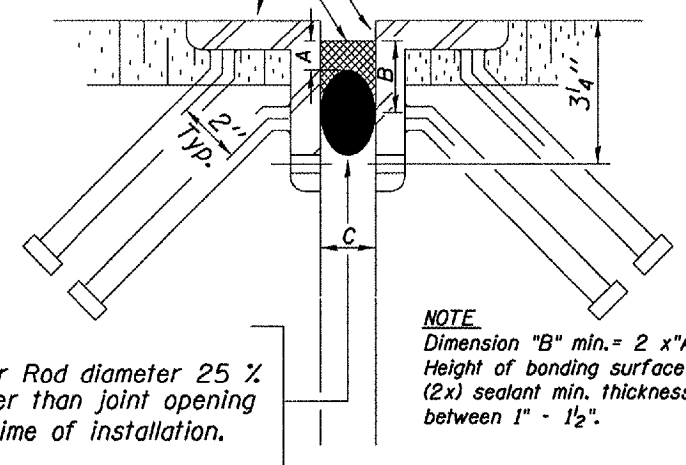

Backer Rod diameter 25 % greater than joint opening at time of installation.

NOTE
Dimension "B" min. = 2 x "A" (where "A" = 3/8" to 5/8"). Height of bonding surface should be approximately (2x) sealant min. thickness. Dimension "C" varies between 1" - 1 1/2".

PROPOSED BRIDGE JOINT SEALER DETAIL

Silicone Jt. Sealer and Backer Rod (continuous)

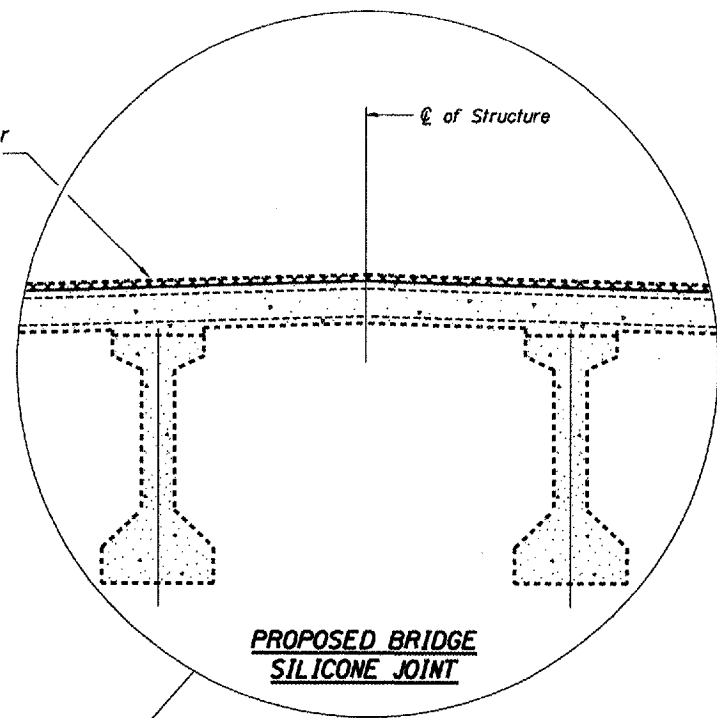

PROPOSED BRIDGE SILICONE JOINT

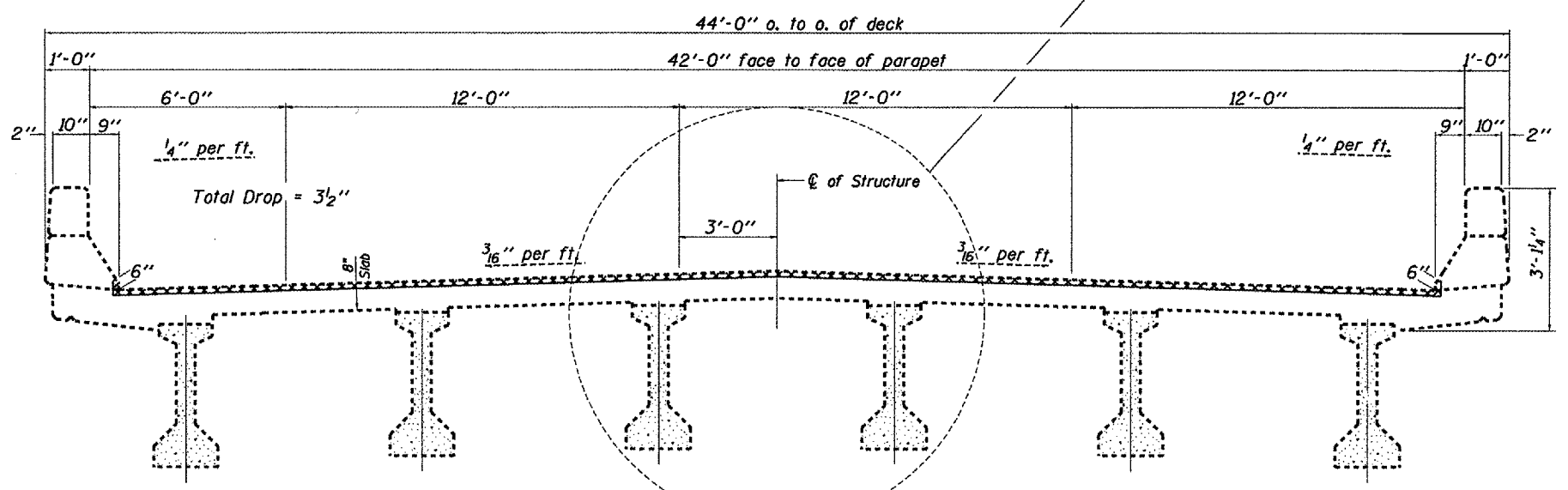

NEAR PIER

NEAR MIDSPAN

CROSS SECTION

(Looking S.B. in the direction of traffic)

BILL OF MATERIAL

ITEM	UNIT	QUANTITY
BLAST CLEANING BRIDGE JOINT STEEL	FOOT	85
BLAST CLEANING PPC BEAM ENDS	FOOT	48
THERMAL SPRAYING (METALIZING) BRIDGE JOINT STEEL	FOOT	82
SILICONE JOINT SEALER	FOOT	85
THERMAL SPRAYING (METALIZING) PPC BEAM ENDS	SO.FT.	279

PLOT DATE * OWNER * SCALE * REFERENCE * SHEET NO.

REVISIONS	
NAME	DATE

ILLINOIS DEPARTMENT OF TRANSPORTATION

DECK AND JOINT DETAILS

SCALE: VERT. HORIZ. DATE 07-21-2005

SN 090-0093 I-155 SB over Indian Crk.

DRAWN BY CEJ CHECKED BY

F.A.I. RTE.	SECTION	COUNTY	TOTAL SHEETS	SHEET NO.
155		TAZEWELL	27	27
STA. 744+80.17 TO STA. 746+58.00				
FED. ROAD DIST. NO. 4 ILLINOIS FED. AID PROJECT				
• 04 Joint Rep'd r 2006				

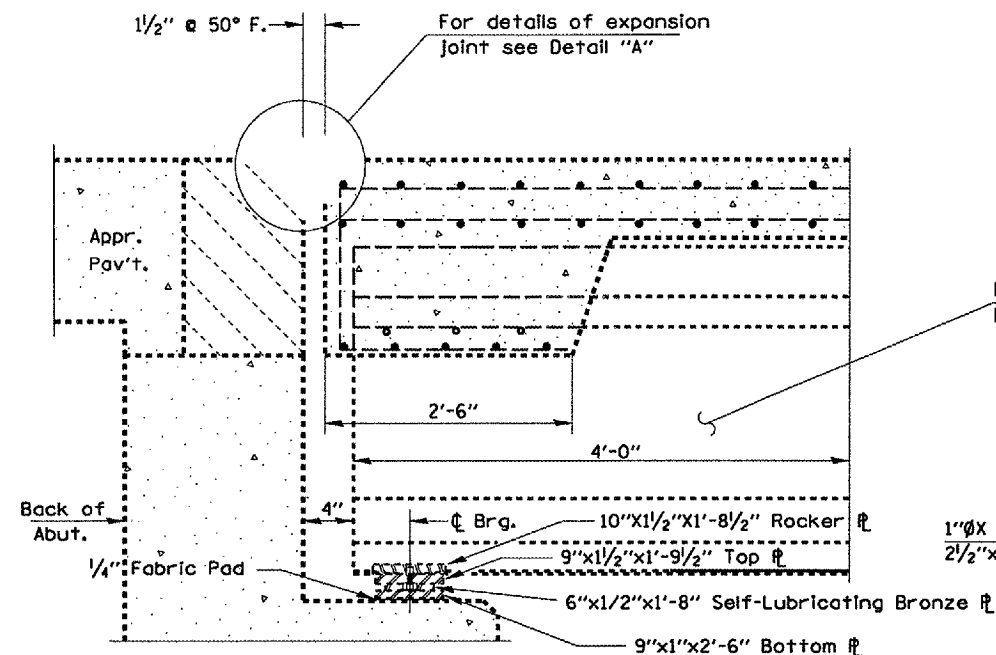

ABUTMENT/I-BEAM END SECTION

(North Abutment)

PPC I-Beam Surfaces for Blasting, and Metalizing

1"ØX 12" Anchor Bolt (Typ.) with 2 1/2"x2 1/2"x5/16" Flat Washers

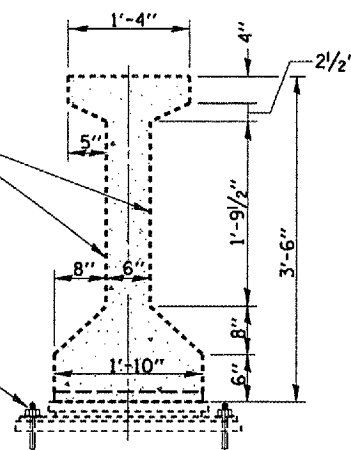

PPC I-BEAM CROSS-SECTION

(6 I-Beams/12 Beam Ends)

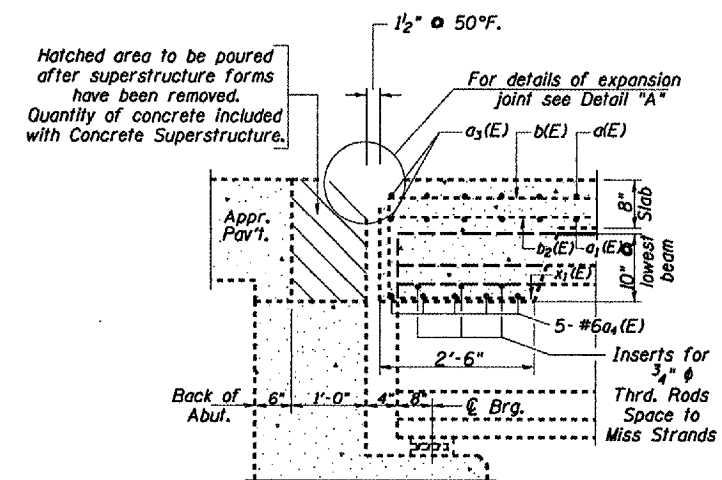

SECTION THRU ABUTMENT

Note
All horizontal dimensions are at right angles to beam ends.

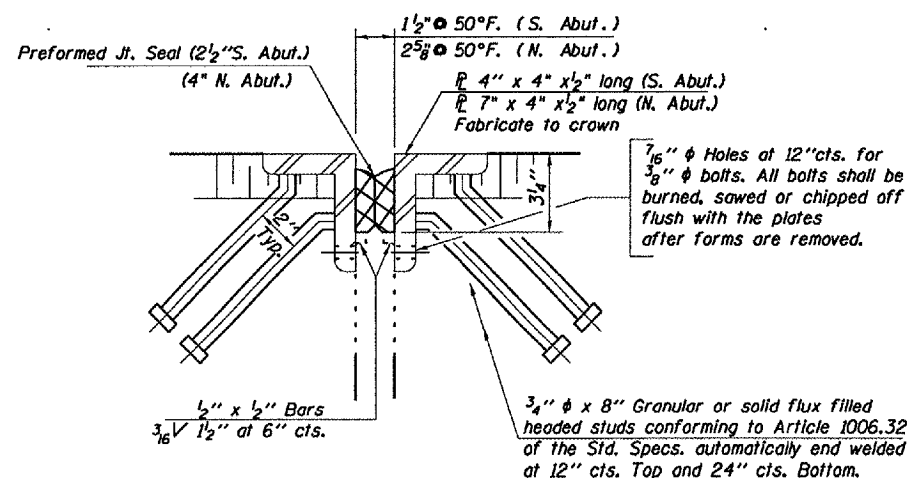

DETAIL A

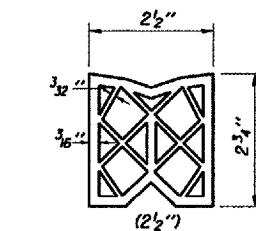

EXISTING PREFORMED JOINT SEAL

(S. Abut. only)

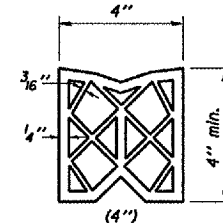

EXISTING PREFORMED JOINT SEAL

(N. Abut. only)

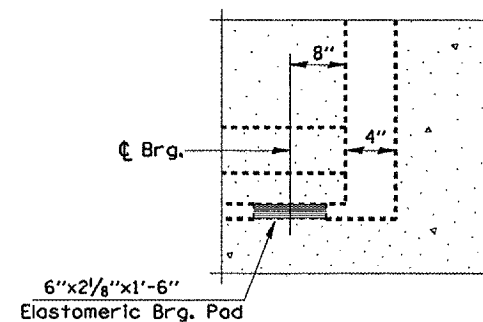

SOUTH ABUTMENT SECTION

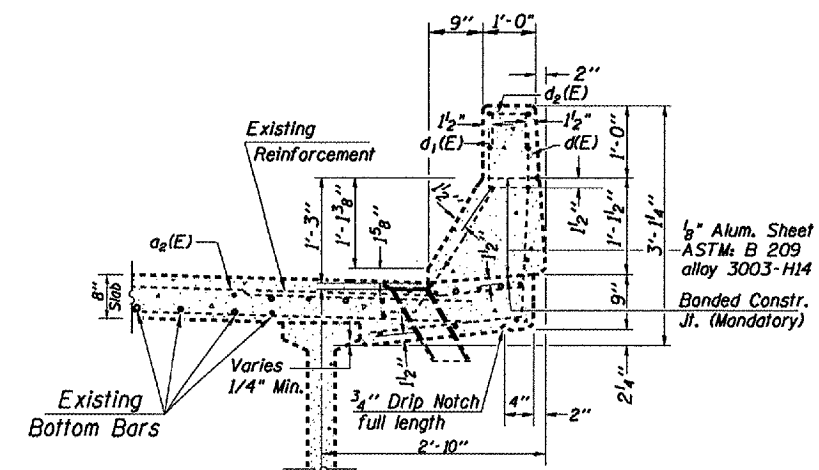

SECTION THRU PARAPET

Note:
All horizontal dimensions are at right angles to beam ends. Beam length for metalizing shall be measured 4 feet from end and cover all visible side surfaces. Surface area of I-Beam is 5.8 sq.ft. per lineal beam foot.
All bearings and plates shall have pack rust sand blasted clean prior to being metalized as beam ends are processed. Cost to be included in "THERMAL SPRAYING (METALIZING) PPC BEAM ENDS".

PLOT DATE * HOURS
PLOT SCALE * SCALES
REFERENCE * REF*

REVISIONS	
NAME	DATE

ILLINOIS DEPARTMENT OF TRANSPORTATION
SUPERSTRUCTURE DETAILS
SCALE: VERT. DATE 07-22-2005
DRAWN BY CEJ
CHECKED BY

SN 090-0093
I-155 SB over
Indian Crk.