

F.A.I. RTE.	SECTION	COUNTY	TOTAL SHEETS	SHEET NO.
74	*	CHAMPAIGN	115	51
STA. 1165+00		TO STA. 1195+00		
FED. ROAD DIST. NO.		ILLINOIS FED. AID PROJECT		
* 10(5-1-RS-1,14-1(R)RS & 6RS-3)				

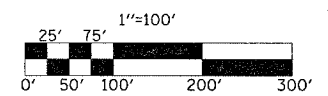
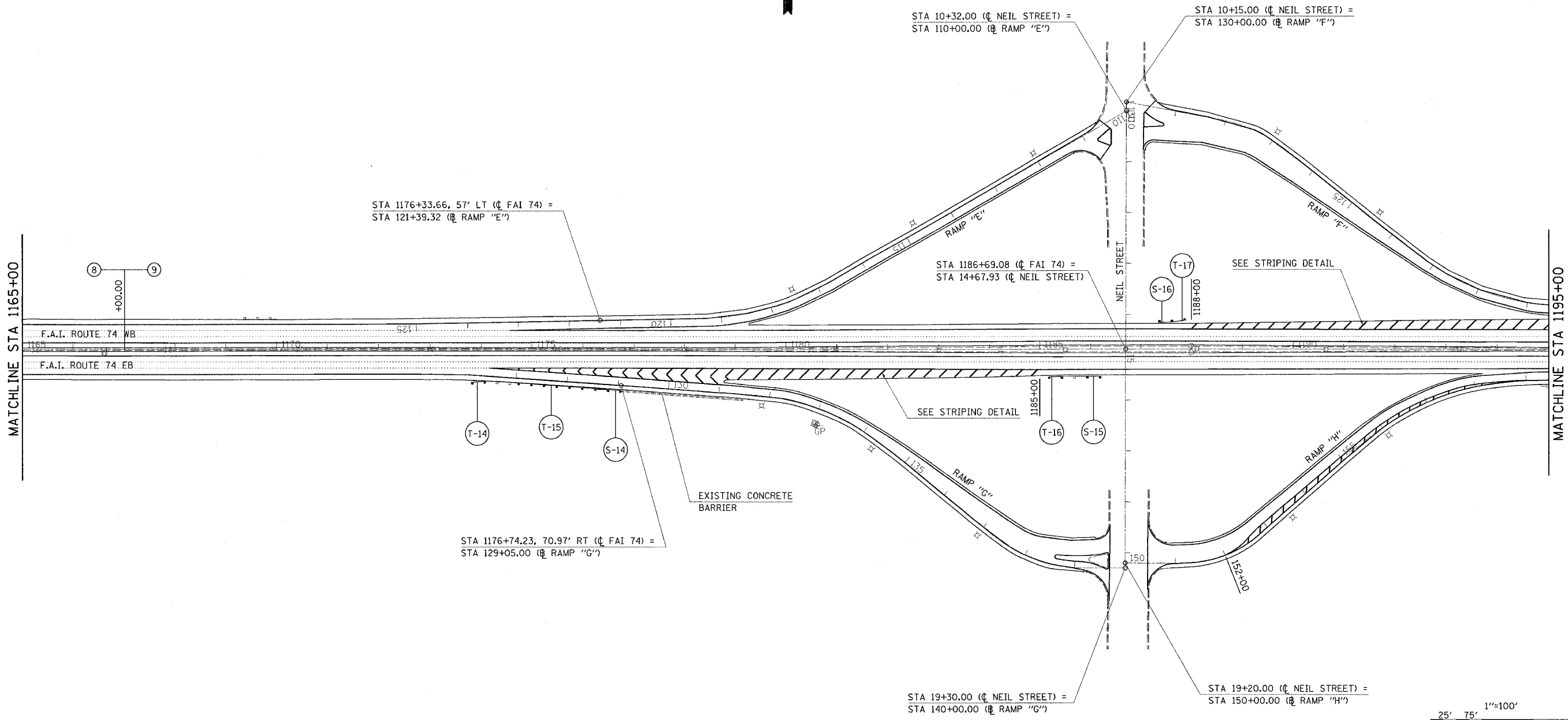

SEC 1, T19N, R8E, 3rd PM

ILLINOIS DEPARTMENT OF TRANSPORTATION
PLAN VIEW
 F.A.I. ROUTE 74
 SECTION 10(5-1-RS-1,14-1(R)RS & 6RS-3)
 CHAMPAIGN COUNTY

SCALE: 1" = 100'
 DATE: 06/13/05

DRAWN BY: CADD
 CHECKED BY:

PLOT DATE = 10/29/2005
 FILE NAME = c:\p\projects\20070606\10(5-1-RS-1,14-1(R)RS & 6RS-3)\plan100.dgn
 USER NAME = phillips