

CONTRACT NO. 70141

F.A.I. RTE.	SECTION	COUNTY	TOTAL SHEETS	SHEET NO.
74	*	CHAMPAIGN	115	58
STA. 1375+00		TO STA. 1403+00		
FED. ROAD DIST. NO.		ILLINOIS	FED. AID PROJECT	
* 105-1-RS-1,14-1(R)RS & 6RS-3)				

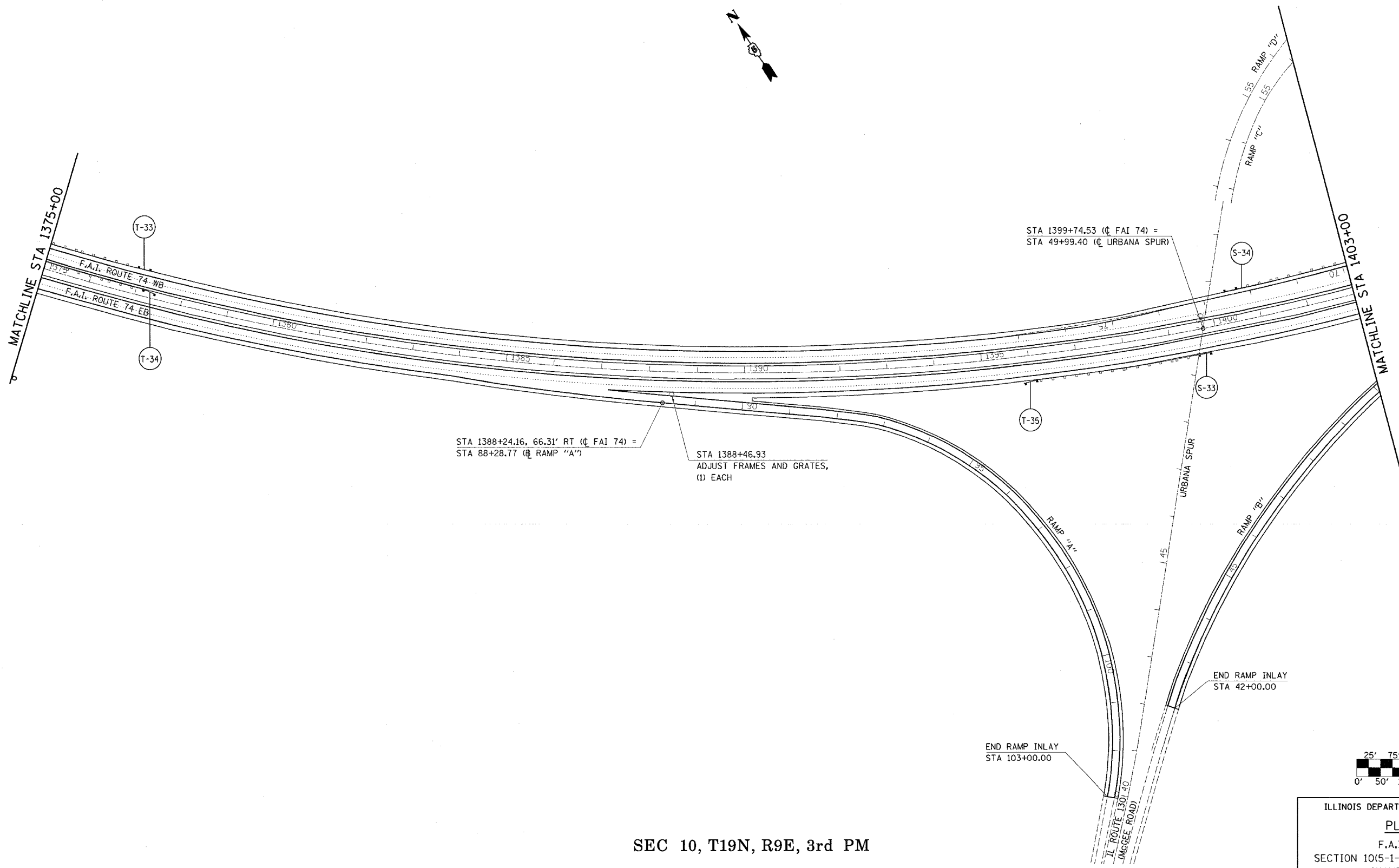
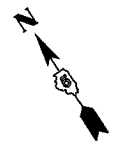

STA 1388+24.16, 66.31' RT (C FAI 74) =
STA 88+28.77 (RAMP "A")

STA 1388+46.93
ADJUST FRAMES AND GRATES,
(1) EACH

STA 1399+74.53 (C FAI 74) =
STA 49+99.40 (C URBANA SPUR)

END RAMP INLAY
STA 42+00.00

END RAMP INLAY
STA 103+00.00

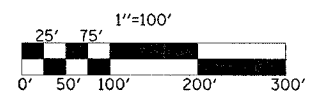

SEC 10, T19N, R9E, 3rd PM

ILLINOIS DEPARTMENT OF TRANSPORTATION
PLAN VIEW
 F.A.I. ROUTE 74
 SECTION 10(5-1-RS-1,14-1(R)RS & 6RS-3)
 CHAMPAIGN COUNTY
 SCALE: 1" = 100'
 DATE: 06/13/05
 DRAWN BY: CADD
 CHECKED BY:

PLOT DATE = 11/15/2005
 FILE NAME = c:\pwworkspace\10570800\10570800.dwg
 PLOT SCALE = 100.0000 / IN.
 USER NAME = philippej