

80 70 60 50 40 30 20 10 0 10 20 30 40 50 60 70

CONTRACT NO. 70141

LINCOLN AVE. EASTBOUND OFF-RAMP

RAMP "C"

F.A.I. RTE.	SECTION	COUNTY	TOTAL SHEETS	SHEET NO.
74	*	CHAMPAIGN	115	102
STA. 252+00.00		TO STA. 252+00.00		
FED. ROAD DIST. NO.		ILLINOIS FED. AID PROJECT		
*1015-1-RS-1,14-1(RIRS&RS-3)				

FINAL SURVEY	DATE

ORIGINAL SURVEY	DATE

PLOT DATE = 10/24/2005
 PLOT SCALE = 5.0000 / IN.
 USER NAME = phillips, jr

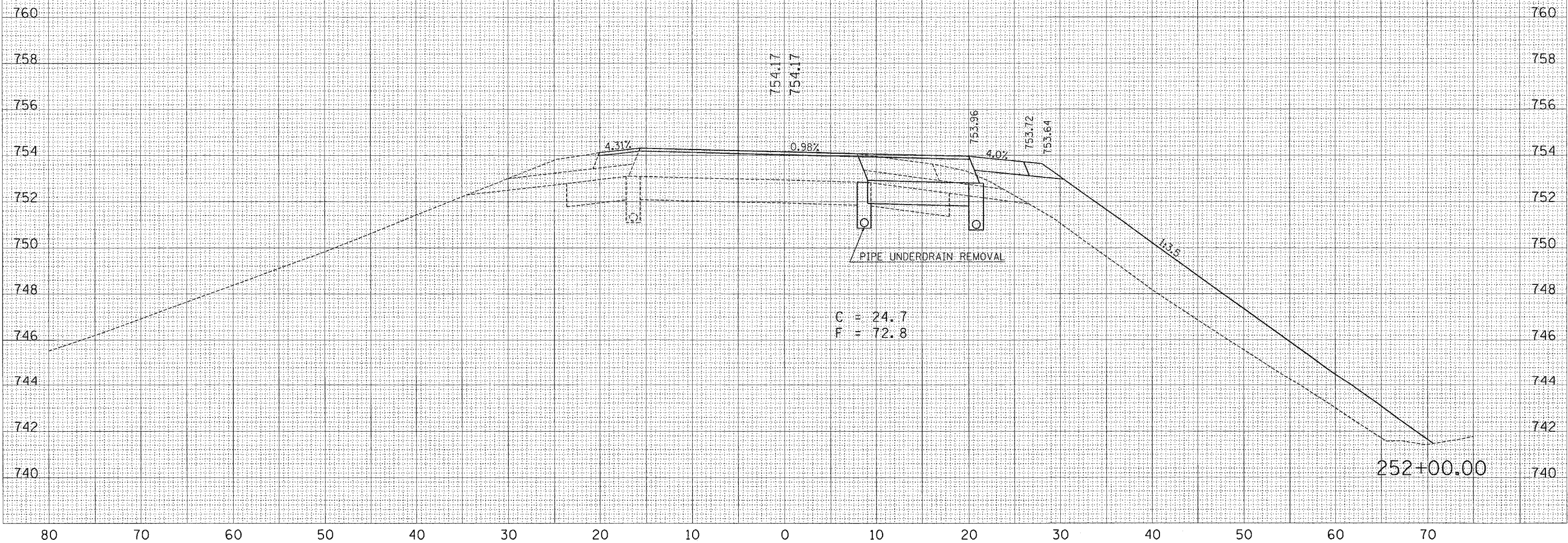

C = 24.7
 F = 72.8