

F.A.P. RTE.	SECTION	COUNTY	TOTAL SHEETS	SHEET NO.
840	(122BR)BR	VERMILION	25	14
FED. ROAD DIST. NO.	ILLINOIS	FED. AID PROJECT		

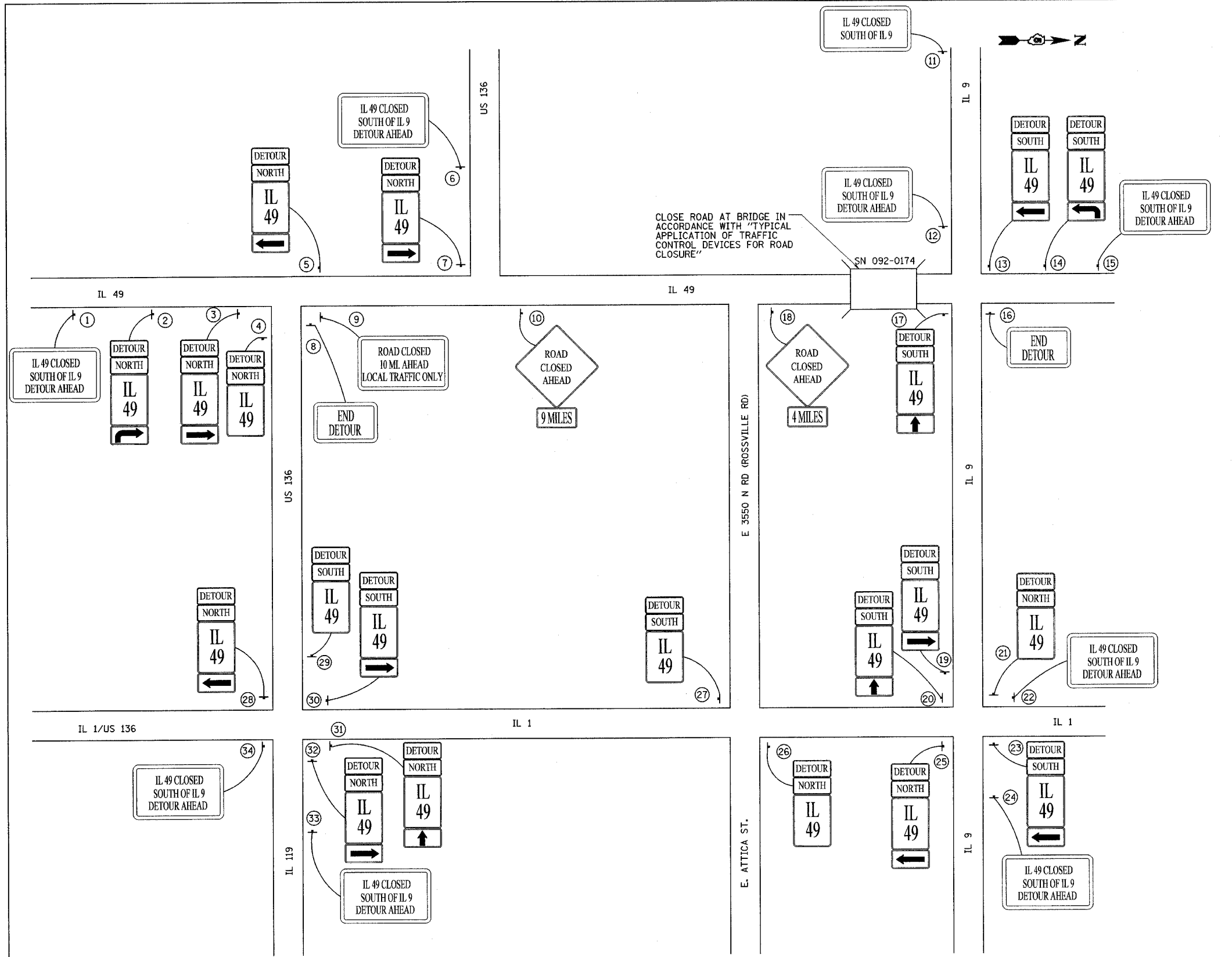

- SIGN NO. LOCATION**
1. ERECT OFF SHOULDER, EVEN WITH "JCT US 136" SIGN
  2. ERECT BESIDE "KANKAKEE/DANVILLE" SIGN
  3. ERECT BESIDE US 136, NORTH IL 49 SIGNS
  4. ERECT BESIDE "EAST US 136" SIGN
  5. ERECT 50'± NORTH OF IL 49/US 136 INTERSECTION
  6. ERECT 200'± WEST OF US 136/IL 49 INTERSECTION
  7. ERECT 50'± WEST OF US 136/IL 49 INTERSECTION
  8. ERECT 100'± EAST OF IL 49
  9. ERECT 75'± SOUTH OF "WEST US 136, NORTH IL 49" SIGNS
  10. ERECT BESIDE "NORTH IL 49" SIGN
  11. ERECT AT EAST SIDE OF US 45 & IL 19 IN PAXTON
  12. ERECT BESIDE "JCT IL 49" SIGNS
  13. ERECT 50'± SOUTH OF "IL 49, IL 9" SIGNS
  14. ERECT 100'± NORTH OF SIGN 13
  15. ERECT BESIDE "JCT IL 9" SIGN
  16. ERECT JUST EAST OF INTERSECTION
  17. ERECT BESIDE "EAST IL 9" SIGN
  18. ERECT BESIDE "NORTH IL 49" SIGN
  19. ERECT 75'± WEST OF HOSPITAL SIGN
  20. ERECT BESIDE "SOUTH IL 1" SIGN
  21. ERECT 50'± EAST OF "WEST IL 9" SIGN
  22. ERECT 75'± NORTH OF IL 9
  23. ERECT 50'± EAST OF IL 9/IL 1 INTERSECTION
  24. ERECT 200'± EAST OF IL 9/IL 1 INTERSECTION
  25. ERECT BESIDE HOSPITAL SIGN
  26. ERECT 250'± NORTH OF ATTICA RD IN ROSSVILLE
  27. ERECT 250'± SOUTH OF ATTICA RD IN ROSSVILLE
  28. ERECT 150'± WEST OF IL 1 INTERSECTION
  29. ERECT BESIDE "WEST US 136" SIGN
  30. ERECT 50'± SOUTH OF "ALVIN, RANTOUL" SIGN
  31. ERECT BESIDE "NORTH IL 1" SIGN
  32. ERECT 50'± EAST OF IL 1/US 136 INTERSECTION
  33. ERECT 200'± EAST OF IL 1/US 136 INTERSECTION
  34. ERECT 75'± SOUTH OF IL 1/US 136 INTERSECTION

- LOCATION**
1. EXISTING SIGNS WHICH CONFLICT WITH THE MARKED DETOUR SHALL BE COVERED.
  2. SEE SPECIAL PROVISION "TRAFFIC CONTROL AND PROTECTION (SPECIAL)" FOR MORE DETAILS.

REVISIONS	
NAME	DATE

ILLINOIS DEPARTMENT OF TRANSPORTATION

**DETOUR SIGNING DETAIL**

SCALE: NONE  
DATE: 9/05

DRAWN BY: MLO  
CHECKED BY: RJC

•DGN-SPEC•  
•DATE•