

F.A.P. RTE.	SECTION	COUNTY	TOTAL SHEETS	SHEET NO.
314	111BR-I	MADISON	123	90
STA. 161+00		TO STA. 167+00		
FED. ROAD DIST. NO.	ILLINOIS	FED. AID PROJECT		

STA 162+23 TO STA 166+75

THERMOPLASTIC PAVEMENT MARKING LINES
 4" YELLOW 505 FT
 4" WHITE 904 FT

RAISED REFLECTIVE PAVEMENT MARKERS
 DOUBLE AMBER 6 EACH

STA 161+00 TO STA 162+23

POLYUREA PAVEMENT MARKING LINES
 4" YELLOW 30 FT
 4" WHITE 246 FT

RAISED REFLECTIVE PAVEMENT MARKERS (BRIDGE)
 DOUBLE AMBER 2 EACH

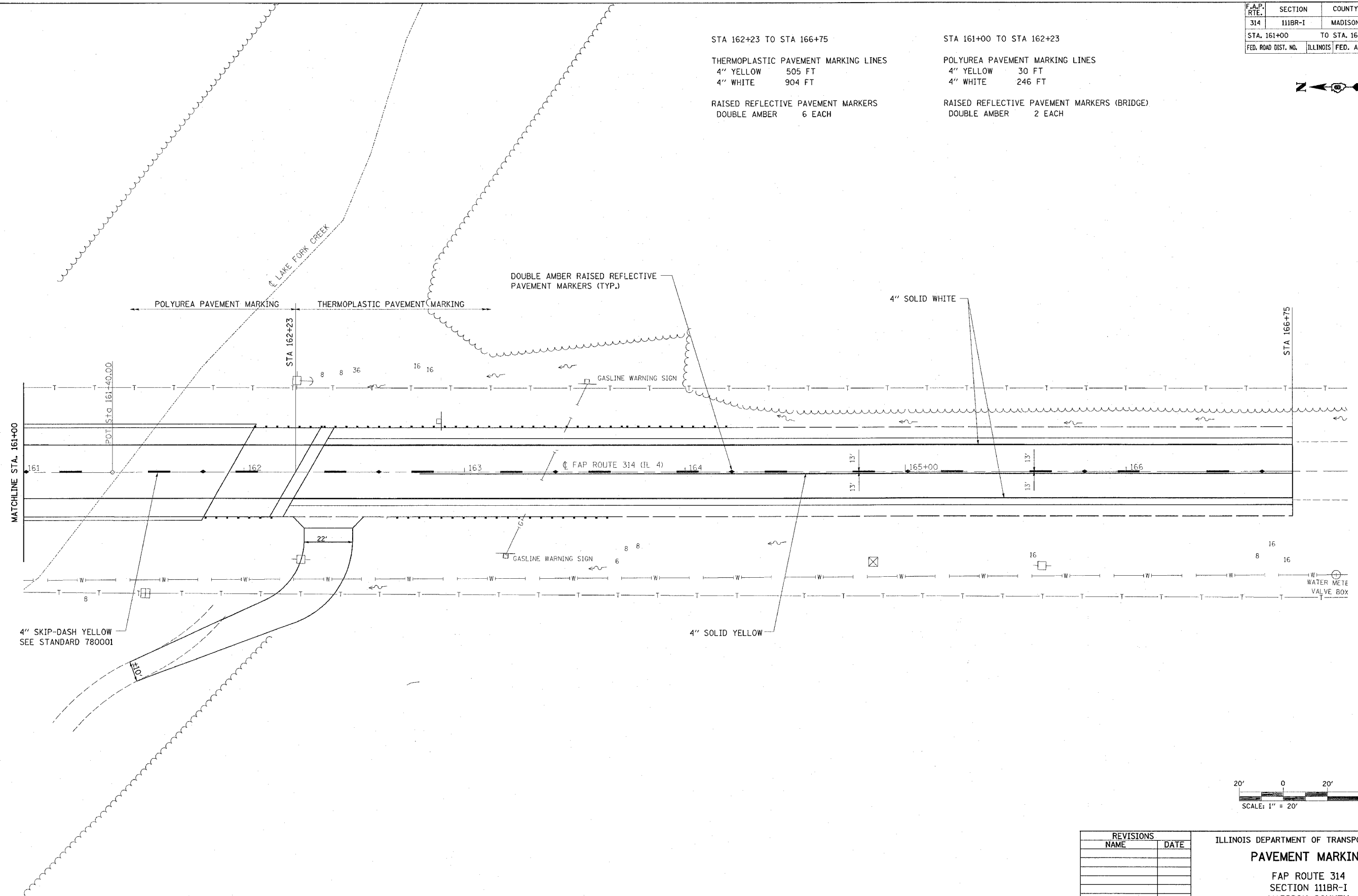

PLOT DATE = 10/26/2005
 FILE NAME = c:\pwork\pava\102781\pava\102781a06.dgn
 PLOT SCALE = 20,000 / IN.
 REFERENCE = #REF#

REVISIONS	
NAME	DATE

ILLINOIS DEPARTMENT OF TRANSPORTATION
PAVEMENT MARKING
 FAP ROUTE 314
 SECTION 111BR-I
 MADISON COUNTY
 SN 060-0112(E) 0339(P)