

Bench Mark: Headwall of box culvert, Rt., Sta. 114+76, Sec. 111B-I, F.A. 670, ±566 ft. south of intersection of Il. 4 and U.S. 40 on Il. 4.

Existing Structure: S.N. 060-0112 Built 1928 as S.B.I. Rte. 150 Sec. 111-B at Station 161+40 as two simple spans 77'-3" Bk.-Bk. abutments, supported on timber pile footings. Bridge widening and superstructure replacement with PPC deck beams in 1971. Existing bridge to be removed and replaced. Traffic to be maintained utilizing stage construction.

No salvage

STATE OF ILLINOIS  
DEPARTMENT OF TRANSPORTATION

ROUTE NO.	SECTION	COUNTY	SHEET NO.	SHEET NO.
FAP 314	111B-I	MADISON	123	91
FED. ROAD DIST. NO. 7		ILLINOIS	FED. AID PROJECT	
Contract No. 76454				

INDEX OF SHEETS

1. General Plan
2. General Data & Stage Const. Details
3. Temporary Sheet Piling
4. Temporary Concrete Barrier for Stage Construction
- 5.-6. Top of Slab Elevations
7. Superstructure
8. Superstructure Details
9. Diaphragm Details
10. Structural Steel Details
11. Structural Steel & Bearing Details
12. Anchor Bolt Details
13. North Abutment
14. South Abutment
15. Bar Splicer Assembly Details
- 16.-17. Soil Boring Details

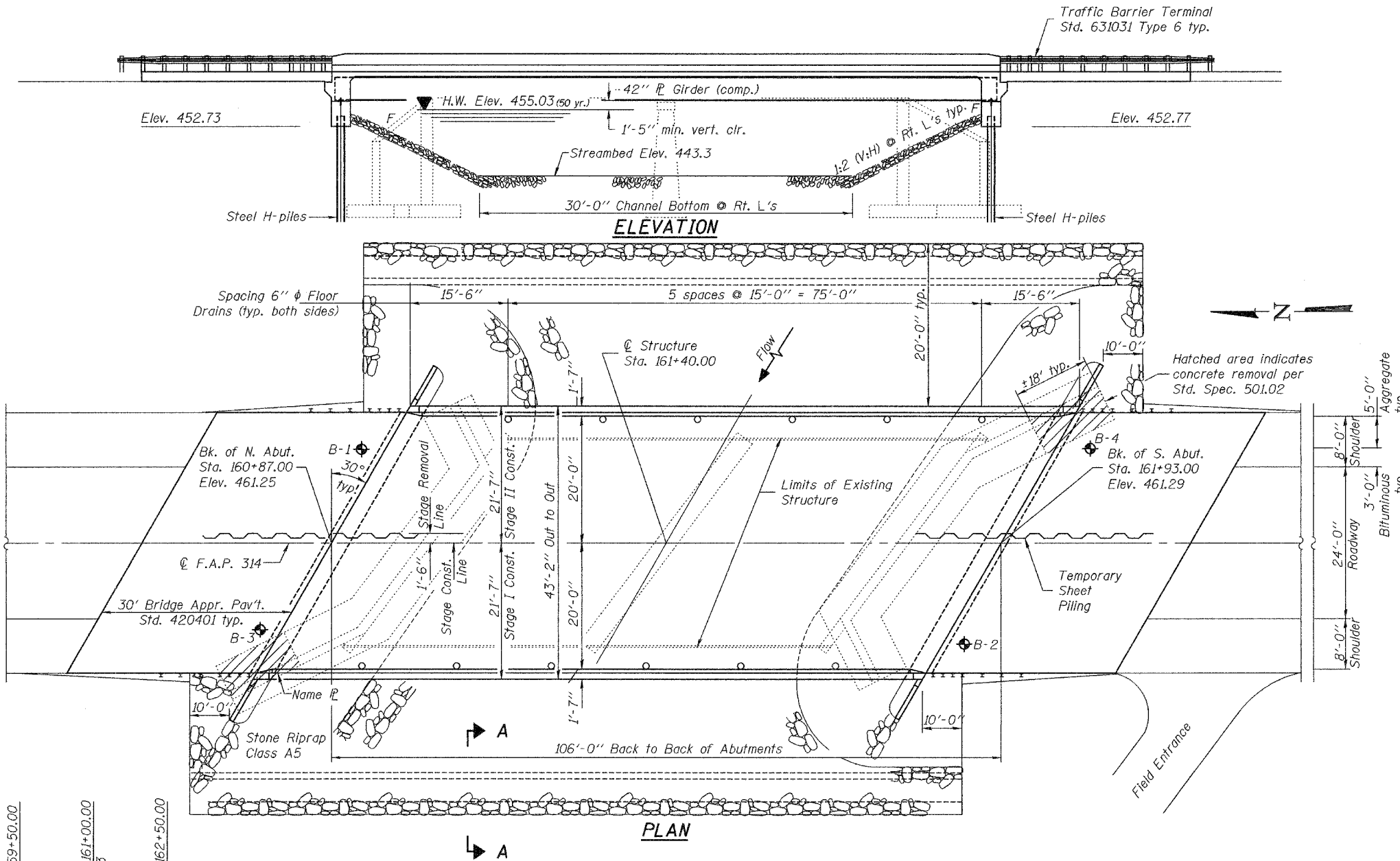

STATION 161+40.00  
BUILT 200 BY  
STATE OF ILLINOIS  
FAP RT. 314 - SEC. 111B-I  
LOADING HL-93  
STR. NO. 060-0339

NAME PLATE  
See Std. 515001

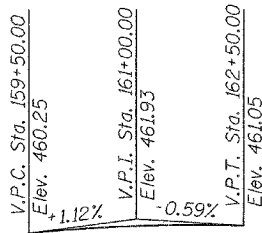
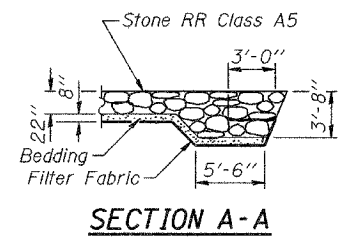

Note: Hatching indicates portion of existing wingwall footing to be removed prior to driving new abutment piles. (Northwest & Southeast wingwall only)

PROFILE GRADE  
(along roadway)

DESIGNED	W.E. Hill
CHECKED	Dwight H. Coelster
DRAWN	BECKY M. LEACH
CHECKED	CEH

EXAMINED  
November 10, 2005  
PASSED  
Ruth E. Adams  
ENGINEER OF BRIDGES AND STRUCTURES



EXPIRES 11-30-2006

WATERWAY INFORMATION

Drainage Area=9.2 sq. mi. Low Grade Elev. 458.61/459.36\* @ Sta. 161+00/159+00\*

Flood	Freq. Yr.	Q C.F.S.	Opening Sq. Ft.		Head - Ft.			Headwater E.L.	
			Exist.	Prop.	H.W.E. Exist.	Prop.	Exist.	Prop.	
Design	50	3115	373	532	455.03	2.90	2.45	457.93	457.48
Base	100	3592	387	550	455.28	3.40	2.81	458.68	458.09
Overtopping	93	385*	386	587	455.28	3.35	3.58	458.61	459.36
Scour	10	2002	334	485	454.33	1.76	1.56	456.09	455.89

LOADING HL-93

Allow 50#/sq. ft. for future wearing surface.

DESIGN SPECIFICATIONS

AASHTO LRFD Bridge Design Specifications, US, 3rd Edition - 2004

DESIGN STRESSES

FIELD UNITS

$f_c = 3,500$  psi  
 $f_y = 50,000$  psi (structural steel M270, Gr. 50)  
 $f_y = 60,000$  psi (reinforcement)

SEISMIC DATA

Seismic Performance Zone (SPZ) = 2  
Bedrock Acceleration Coefficient (A) = 0.10g  
Site Coefficient (S) = 1.0

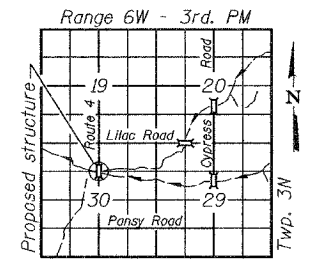

LOCATION SKETCH

GENERAL PLAN  
ILLINOIS ROUTE 4 OVER  
LAKE FORK CREEK  
F.A.P. ROUTE 314 - SECTION 111B-I  
MADISON COUNTY  
STATION 161+40.00  
STRUCTURE NO. 060-0339