

F.A.P. RTE.	SECTION	COUNTY	TOTAL SHEETS	SHEET NO.
355	258-I	JERSEY	30	7

STA. 406+17.00 TO STA. 412+00.00  
 FED. ROAD DIST. NO. ILLINOIS FED. AID PROJECT

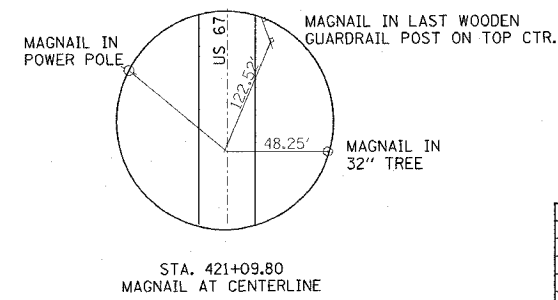
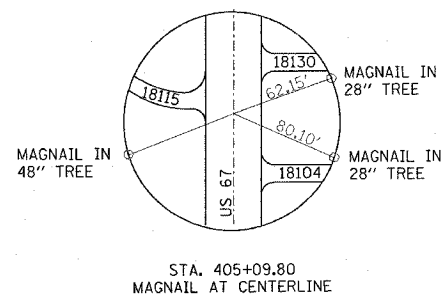
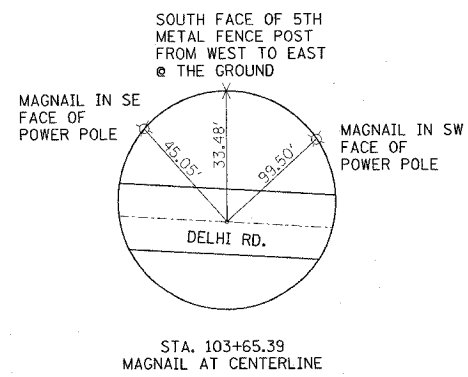
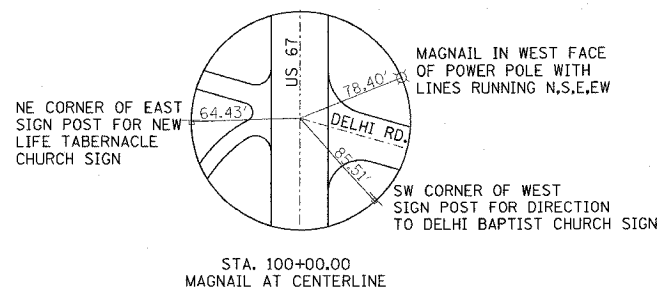
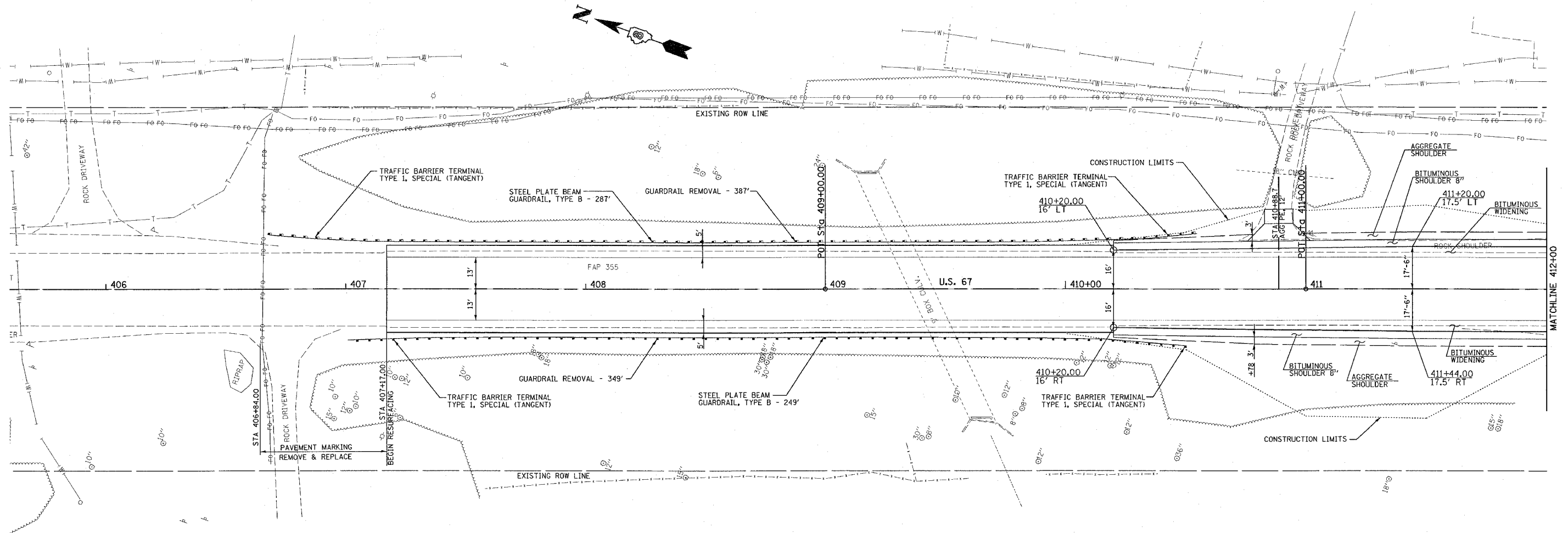

TIE POINTS

REVISIONS	
NAME	DATE

ILLINOIS DEPARTMENT OF TRANSPORTATION

**PLAN SHEETS**

FAP ROUTE 355  
SECTION 258-I  
JERSEY COUNTY

SCALE: \_\_\_\_\_  
DATE: \_\_\_\_\_

DRAWN BY \_\_\_\_\_  
CHECKED BY \_\_\_\_\_

PLOT DATE = 10/27/2005  
 FILE NAME = c:\pwworkspace\mva\ard\91985\plan\p1098105.dgn  
 PLOT NO. = 1098105 / 1  
 REFERENCE = REF#