

CONTRACT NO. 83816

F.A.U. RTE.	SECTION	COUNTY	TOTAL SHEETS	SHEET NO.
3573	05-00053-00-RS	DUPAGE	18	8
STA.		TO STA.		
FED. ROAD DIST. NO. 7		ILLINOIS FED. AID PROJECT		

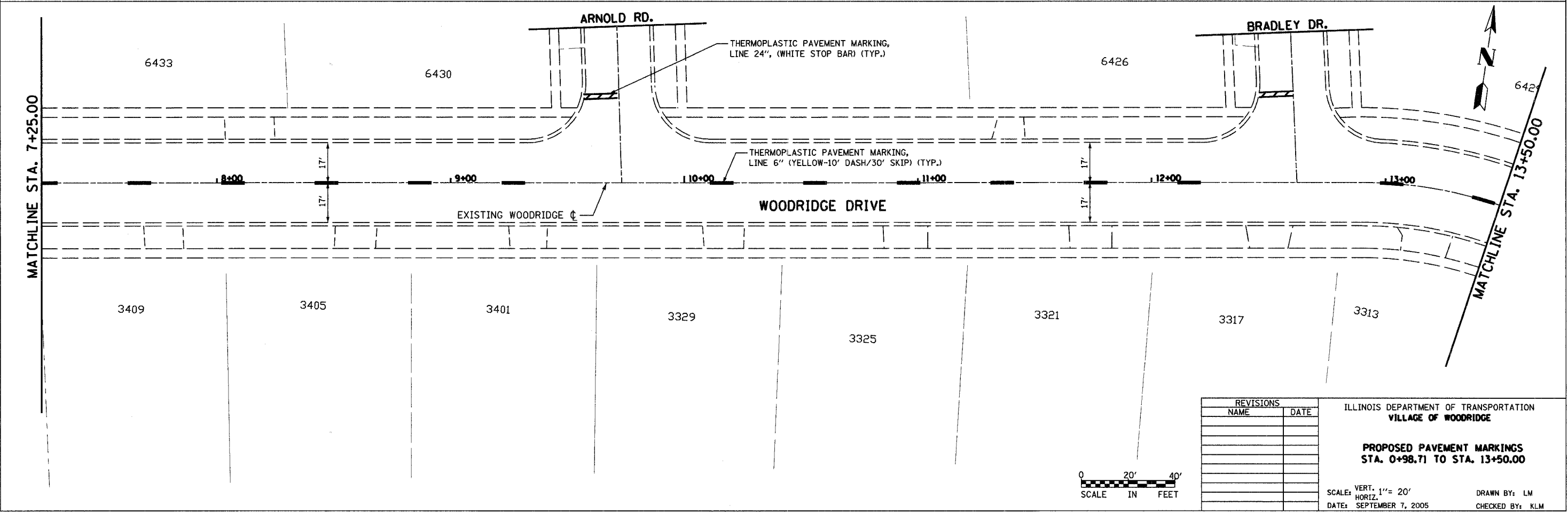

PLOT DATE = #DATE\*  
 FILE NAME = #FILEL\*  
 PLOT SCALE = #SCALE\*  
 USER NAME = #USER\*

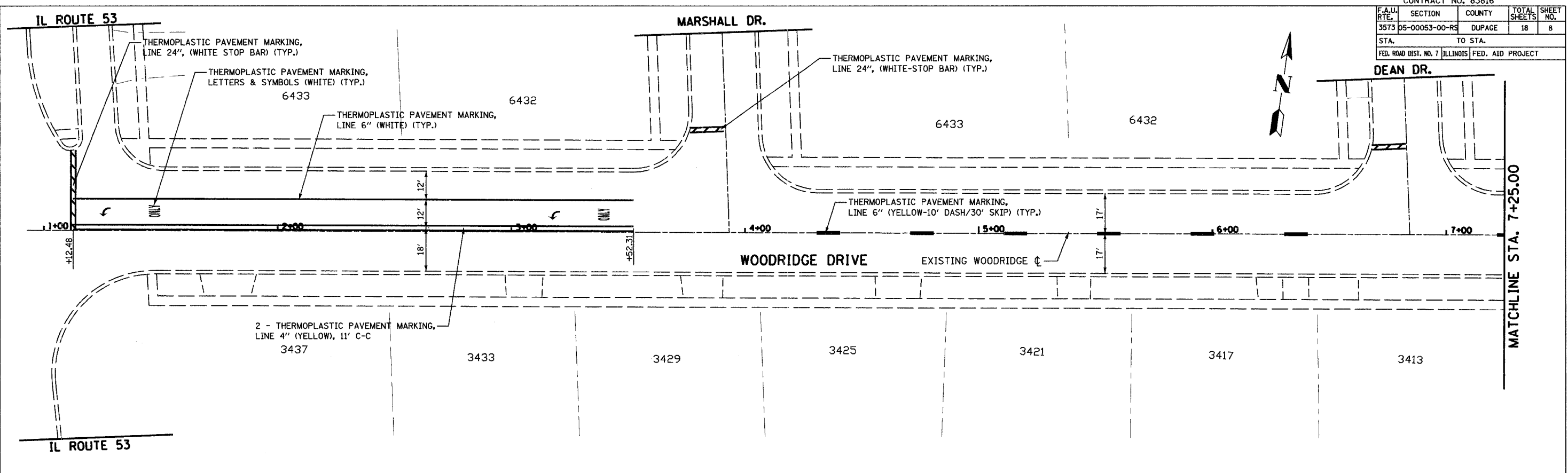
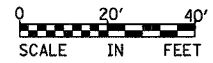

REVISIONS	
NAME	DATE

ILLINOIS DEPARTMENT OF TRANSPORTATION  
 VILLAGE OF WOODRIDGE

PROPOSED PAVEMENT MARKINGS  
 STA. 0+98.71 TO STA. 13+50.00

SCALE: VERT. 1" = 20'  
 HORIZ. DATE: SEPTEMBER 7, 2005

DRAWN BY: LM  
 CHECKED BY: KLM