

CONTRACT NO. 83816

F.A.U. RTE.	SECTION	COUNTY	TOTAL SHEETS	SHEET NO.
3573	05-00053-00-RS	DUPAGE	18	10
STA.		TO STA.		
FED. ROAD DIST. NO. 7		ILLINOIS		FED. AID PROJECT

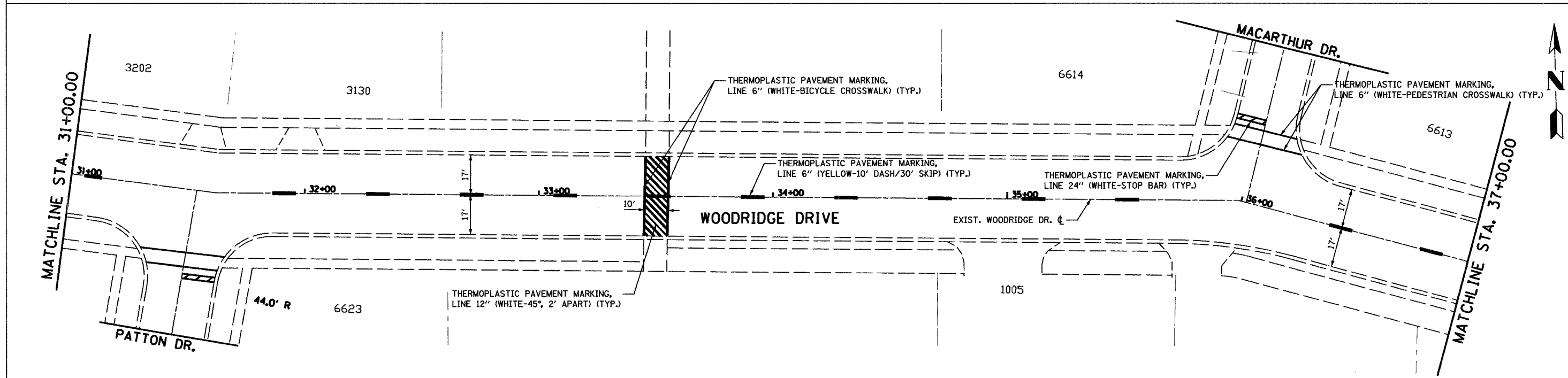

DATE = 09/07/05
 FILE NAME = 05-00053-00-RS
 PLOT SCALE = 1"=20'
 USER NAME = KLM

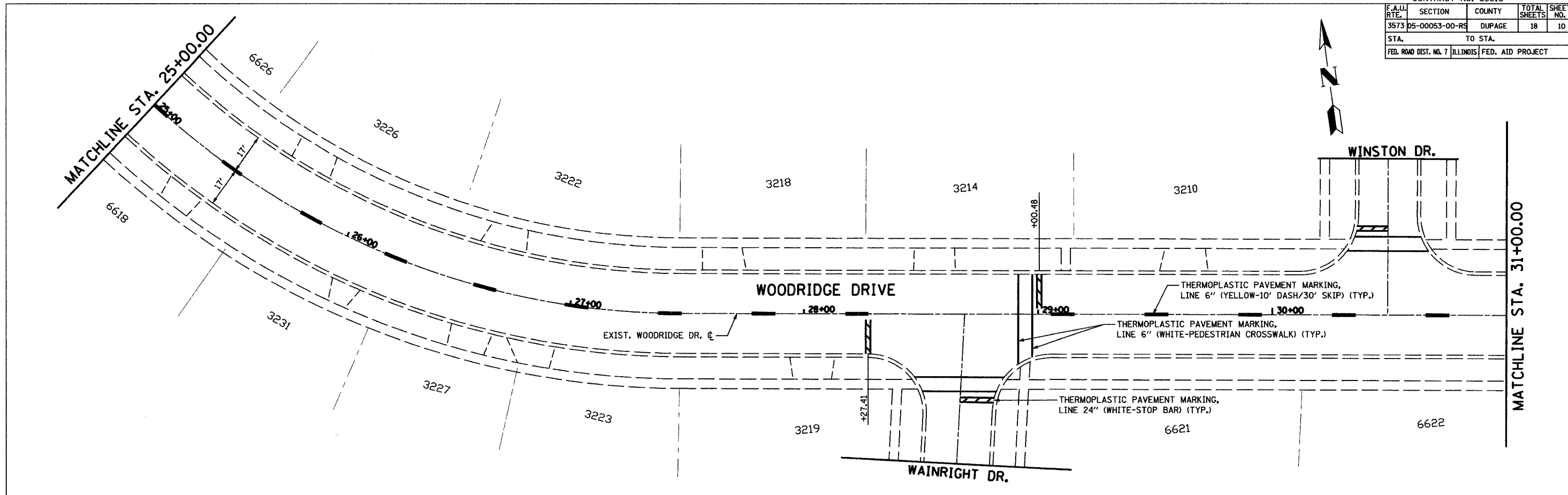
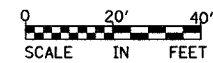

REVISIONS	
NAME	DATE

ILLINOIS DEPARTMENT OF TRANSPORTATION
 VILLAGE OF WOODRIDGE

PROPOSED PAVEMENT MARKINGS
 STA. 25+00.00 TO STA. 37+00.00

SCALE: VERT. 1"= 20'
 HORIZ. 1"= 40'
 DATE: SEPTEMBER 7, 2005

DRAWN BY: LM
 CHECKED BY: KLM