

F.A. RTE. 6708
SECTION 03-00170-00-TL
COUNTY: TAZEWELL
CONTRACT NO. 89353
CAT NO. 032923-00

REVISIONS

NUMBER	BY	DATE

0 1 2
THIS BAR IS EQUAL TO 2"
AT FULL SCALE (34X22).

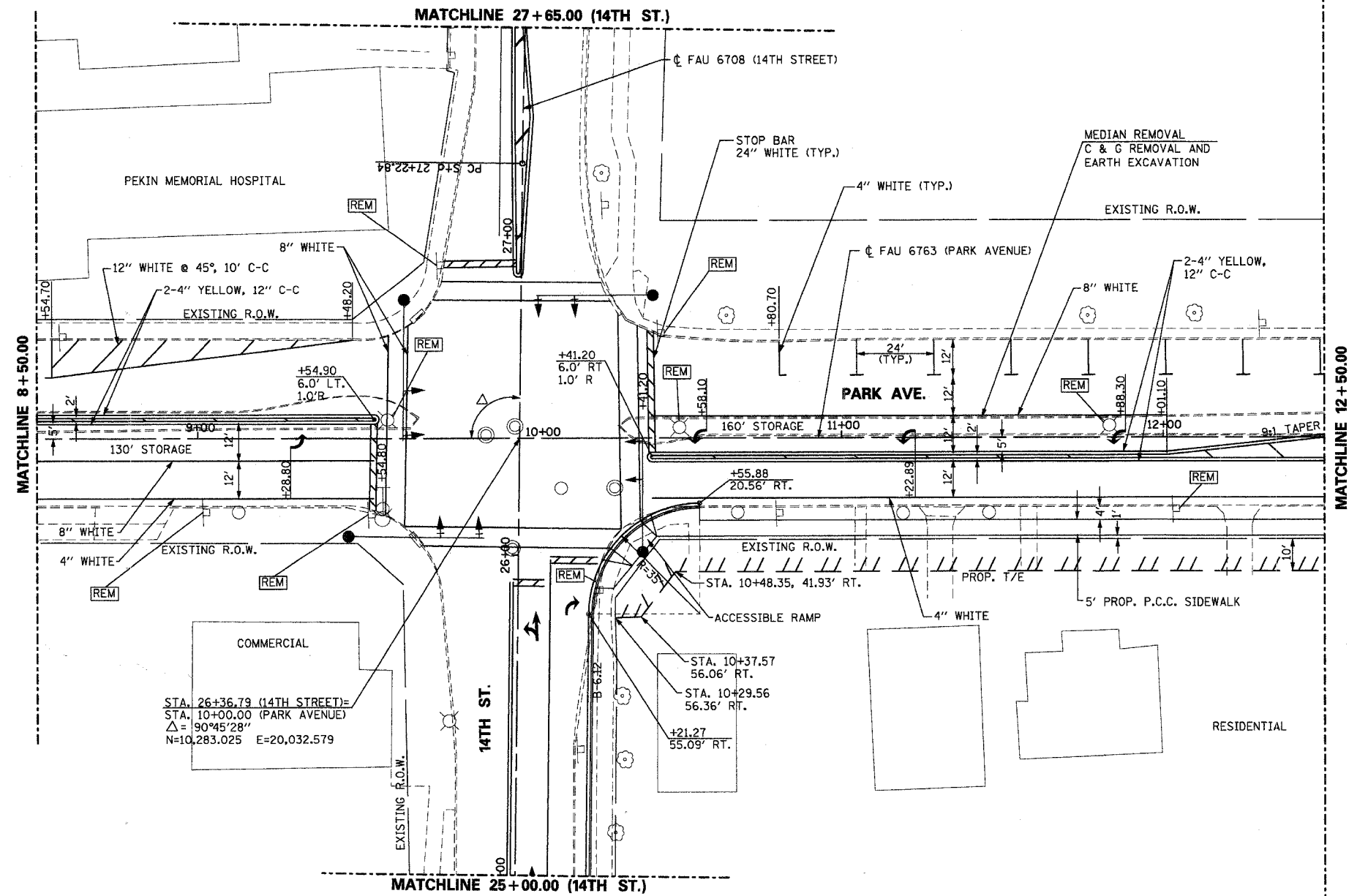
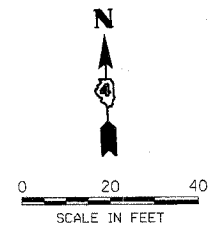

CITY OF PEKIN, IL
INTERSECTION RECONSTRUCTION
14TH ST. & PARK AVE.
PARK AVENUE
STA. 8 + 50.00 TO STA. 12 + 50.00

© copyright CMT, Inc.
CMT
CRAWFORD, MURPHY & TILLY, INC.
CONSULTING ENGINEERS
License No. 184-000613

DESIGN BY: R.M.M.
DRAWN BY: N.D.S.
CHECKED BY: E.J.H.
APPROVED BY:
DATE: 10/12/05
JOB No: 05069-02-00