

INDEX OF SHEETS

- 1 COVER SHEET
- 2 GENERAL NOTES/SUMMARY OF QUANTITIES
- 3-4 TYPICAL SECTION
- 5-6 SCHEDULE OF QUANTITIES
- 7-11 PLAN SHEETS
- 12 INTERSECTION DETAIL
- 13 EROSION CONTROL
- 14 CONSTRUCTION DETAILS
- 15-17 TRAFFIC SIGNAL SHEETS

CITY OF PEKIN
TAZEWELL COUNTY, ILLINOIS

PLANS FOR PROPOSED 14TH ST. & PARK AVE. SIGNALIZATION

STANDARDS

- 000001-04 STANDARD SYMBOLS, ABBREVIATIONS AND PATTERNS
- 424001-04 CURB RAMPS FOR SIDEWALKS
- 606001-02 CURB TYPE B AND COMBINATION CURB AND GUTTER, CONCRETE
- 606301-02 ISLANDS, CONCRETE
- 701101-01 OFF-ROAD OPERATIONS, MULTILANE, 15' TO 24" FROM PAVEMENT EDGE
- 701601-04 URBAN LANE CLOSURE, MULTILANE, 1W OR 2W WITH NONTRAVERSABLE MEDIAN
- 701701-04 URBAN LANE CLOSURE, MULTILANE INTERSECTION
- 702001-05 TRAFFIC CONTROL DEVICES
- 720016-01 MAST ARM MOUNTED STREET NAME SIGNS
- 780001-01 PAVEMENT MARKINGS
- 814001 HANDHOLES, CONCRETE, SINGLE
- 814006 HANDHOLES, CONCRETE, DOUBLE
- 857001 PHASE SEQUENCES
- 877001-02 MAST ARM ASSEMBLY AND POLE, STEEL
- 877011-02 MAST ARM ASSEMBLY AND POLE, STEEL COMBINATION
- 878001-03 FOUNDATIONS, DETAILS, CONCRETE
- 880006 TRAFFIC SIGNAL MOUNTING DETAILS, POST AND BRACKET MOUNTED

STANDARD SYMBOLS

- EXISTING MAILBOX
- EXISTING MANHOLE
- VALVES TO BE ADJUSTED
- EXISTING INLET
- EXISTING WATER VALVE
- FIRE HYDRANT
- UTILITY POLE
- STREET LIGHT
- TREE
- EXISTING STORM SEWER
- EXISTING SANITARY SEWER
- EXISTING GAS MAIN
- EXISTING WATER MAIN
- EXISTING TELEPHONE CABLE
- STRUCTURE TO BE ADJUSTED
- ITEM TO BE REMOVED

DESCRIPTION OF WORK

THIS PROJECT CONSISTS OF THE INSTALLATION OF TRAFFIC SIGNALS AT THE INTERSECTION OF 14TH ST. AND PARK AVE. IN PEKIN, IL, MEDIAN REMOVAL AND RESURFACING OF PARK AVE, AND WIDENING OF THE SOUTH LEG OF THE INTERSECTION IN ACCORDANCE WITH THE PLANS & SPECIFICATIONS.

UTILITIES

ELECTRIC
CENTRAL ILLINOIS LIGHT COMPANY
300 LIBERTY STREET
PHONE: (309) 693-4731
DAN URBANIAK

CABLE TELEVISION
INSIGHT COMMUNICATIONS
1617 VALLE VISTA BOULEVARD
PEKIN, ILLINOIS 61554
PHONE: (309) 347-5866 X230
DAN DIETRICH

WATER
ILLINOIS AMERICAN WATER COMPANY
328 BROADWAY
PEKIN, ILLINOIS 61554
PHONE: (309) 346-4212
RANDY WEST

TELEPHONE
GALLATIN RIVER COMMUNICATIONS
200 ENTERPRISE DRIVE
PEKIN, ILLINOIS 61554
PHONE: (309) 477-0361
JIM RICHERSON

NATURAL GAS
AMERN CILCO
300 LIBERTY STREET
PEORIA ILLINOIS 61602
PHONE: (309) 444-7915
REED COOLING

SANITARY SEWER
CITY OF PEKIN
111 SOUTH CAPITOL STREET
PEKIN, ILLINOIS 61554
PHONE: (309) 477-2300
JOE WUELLNER

STATE ROUTES
ILLINOIS DEPARTMENT OF TRANSPORTATION
DIVISION OF HIGHWAYS DISTRICT 4
401 NORTH MAIN STREET
PEORIA, ILLINOIS 61602
PHONE: (309) 671-3333
W. SHANE LARSON, OPERATIONS ENGINEER

CITY STREETS
111 SOUTH CAPITOL STREET
PEKIN, ILLINOIS 61554
PHONE: (309) 477-2300
JOE WUELLNER, CITY ENGINEER

DBE = 6%
NO. OF TRAINEES = 0

CONTRACT #89353
CAT #032923-00
CMT JOB NO. 05069-02-00
CALL J.U.L.I.E. BEFORE
YOU DIG, 800-892-0123

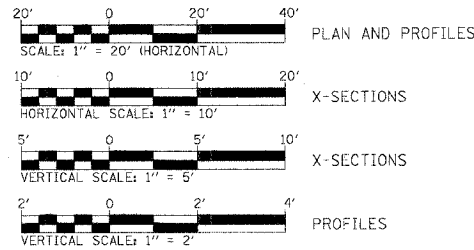

SECTION 03-00170-00-TL
FED. PROJ. #M-5093(114)
C-94-064-04

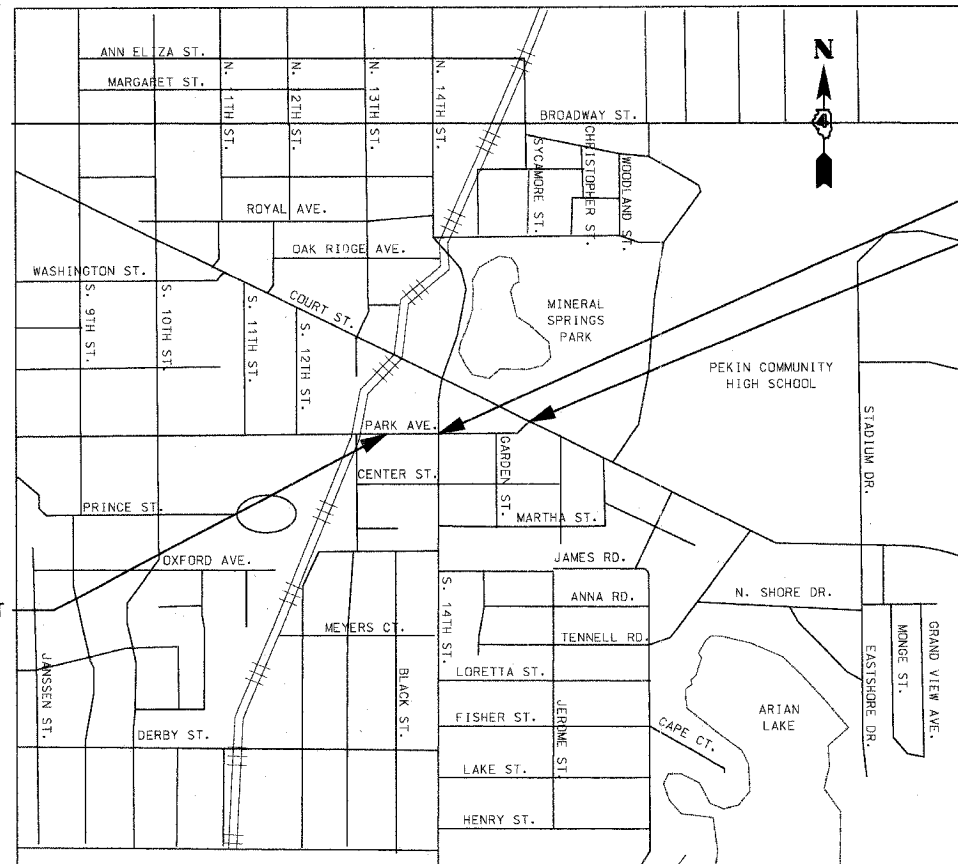

LOCATION MAP

LENGTH = 1700.0 L.F. (0.32 MILES)
FUNCTIONAL CLASSIFICATION (14TH ST.) = MINOR ARTERIAL, ADT = 11,700
(PARK AVE.) = COLLECTOR, ADT = 8000

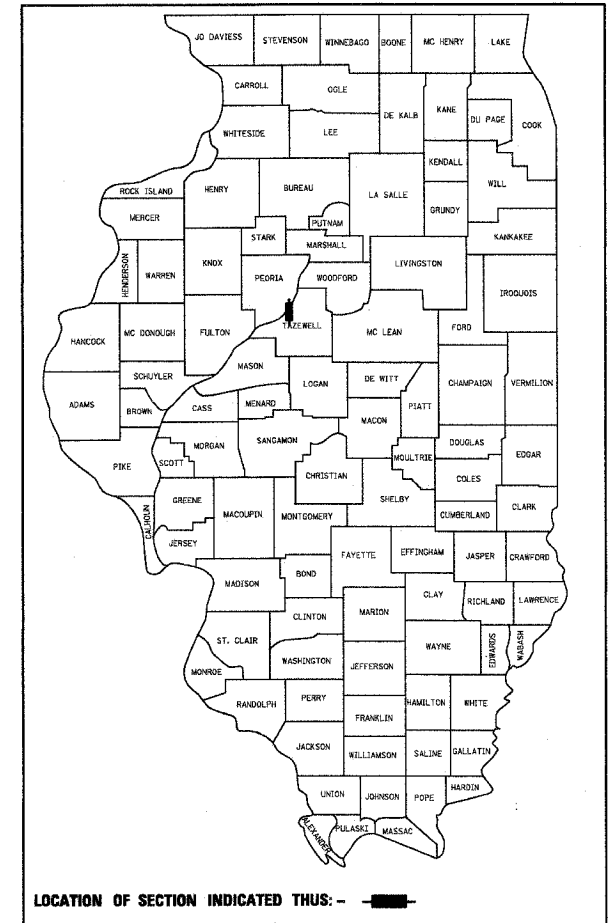
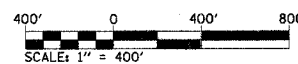

14TH ST. & PARK AVE.
PROJECT ENDS AT STA. 17+77.79

APPROVED November 14 2005
James E. Jones
MAYOR, CITY OF PEKIN

QC/QA BITUMINOUS
SUPERPAVE PROJECT

APPROVED	20
COUNTY ENGINEER	
APPROVED	20
ROAD COMMISSIONER	
PASSED	20
<u>11-15</u>	<u>05</u>
<i>Robert M. Markunas</i>	
DISTRICT FOUR ENGINEER OF LOCAL ROADS & STREETS	
Receiving For Bid Based on Limited Review	
<u>NOV 17</u>	<u>20</u>
<i>James E. Jones</i>	
DEPUTY DIRECTOR OF HIGHWAYS, REGION THREE ENGINEER	
STATE OF ILLINOIS DEPARTMENT OF TRANSPORTATION	



Robert M. Markunas
ROBERT M. MARKUNAS
DATE 11/14/05
ILLINOIS REGISTERED PROFESSIONAL ENGINEER NO. 062-053696



CRAWFORD MURPHY & TILLY, INC.
CONSULTING ENGINEERS
SPRINGFIELD, IL ■ AURORA, IL ■ PEORIA, IL
ROCKFORD, IL ■ ST. LOUIS, MO ■ CHICAGO, IL
EDWARDSVILLE, IL ■ EAST ALTON, IL

F.A. RTE. 6708
SECTION 03-0070-00-TL
COUNTY: TAZEWELL
CONTRACT NO. 89353
CAT NO. 032923-00

GENERAL NOTES

- ALL CONSTRUCTION IMPROVEMENTS SHALL BE IN ACCORDANCE WITH THE LATEST EDITIONS OF THE ILLINOIS DEPARTMENT OF TRANSPORTATION'S "STANDARD SPECIFICATIONS FOR ROAD AND BRIDGE CONSTRUCTION," "SUPPLEMENTAL SPECIFICATIONS AND RECURRING SPECIAL PROVISIONS," "HIGHWAY STANDARDS," AND THE "MANUAL ON UNIFORM TRAFFIC CONTROL DEVICES," AND THE "SPECIAL PROVISIONS" INCLUDED IN THE BID DOCUMENTS.
- THE EXISTING RIGHT OF WAY SHOWN ON THE PLANS WAS TAKEN FROM RECORD DRAWINGS AND IS SHOWN FOR INFORMATIONAL PURPOSES ONLY.
- THE CONTRACTOR SHALL FIELD LOCATE ALL UTILITIES THAT INTERFERE WITH CONSTRUCTION AND COORDINATE THEIR RELOCATION, IF NECESSARY, WITH THE RESPECTIVE UTILITY OWNER.
- THE CITY OF PEKIN RESERVES THE RIGHT TO WAIVE ANY TECHNICALITIES, REDUCE ANY QUANTITY OR DELETE PAY ITEMS FROM THIS CONTRACT.
- ALL AREAS DISTURBED BY THE CONTRACTOR SHALL BE RESTORED TO A CONDITION EQUAL TO OR BETTER THAN THEIR CONDITION PRIOR TO CONSTRUCTION ACTIVITIES.
- ALL PAVEMENT MARKING SHALL BE THERMOPLASTIC.
- ALL AREAS DISTURBED BY CONSTRUCTION OPERATIONS SHALL BE SEEDED, FERTILIZED, AND MULCHED. ALL AREAS SHALL RECEIVE CLASS 1A SEED.
- ALL REMOVED STREET LIGHTING EQUIPMENT AND SIGNS SHALL BE RETURNED TO THE CITY OF PEKIN.
- THE CONTRACTOR IS TO REMOVE ALL EXISTING PAVEMENT MARKING OUTSIDE OF THE LIMITS OF MILLING AND RESURFACING THAT CONFLICTS WITH THE PROPOSED PAVEMENT MARKING.
- ALL HANDICAPPED ACCESSIBLE SIDEWALK RAMPS SHALL COMPLY WITH ADA REQUIREMENTS.

REVISIONS		
NUMBER	BY	DATE

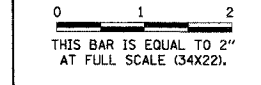

BITUMINOUS MIX REQUIREMENTS

	BINDER 2-1/4"	SURFACE 1-1/2"
PG	SBS 76-22	SBS 76-22
RAP	0%	0%
DESIGN AIR VOIDS	4.2% @ N=70	4.2% @ N=70
MIXTURE COMP.	IL 19.0	IL 9.5 OR 12.5
FRICTION AGG.	N.A.	MIX E

CITY OF PEKIN, IL
INTERSECTION RECONSTRUCTION
14TH ST. & PARK AVE.

SUMMARY OF QUANTITIES AND GENERAL NOTES

© Copyright CMT, Inc.
CMT
 CRAWFORD, MURPHY & TILLY, INC.
 CONSULTING ENGINEERS
 License No. 184-000613

DESIGN BY:	R.M.M.
DRAWN BY:	N.D.S.
CHECKED BY:	E.J.H.
APPROVED BY:	
DATE:	10/12/05
JOB No:	05069-02-00
SHEET 2 OF 17 SHEET	

SUMMARY OF QUANTITIES

Y031-1F

ITEM NO.	ITEM	UNIT	TOTAL QUANTITY	CITY QUANTITY	STATE QUANTITY
20200100	EARTH EXCAVATION	CU YD	358		
25000110	SEEDING, CLASS 1A	ACRE	0.09		
25000400	NITROGEN FERTILIZER NUTRIENT	LB	8		
25000500	PHOSPHORUS FERTILIZER NUTRIENT	LB	8		
25000600	POTASSIUM FERTILIZER NUTRIENT	LB	8		
25100115	MULCH, METHOD 1	ACRE	0.09		
28000500	INLET AND PIPE PROTECTION	EACH	5		
35300100	PCC BASE COURSE 6"	SQ YD	765		
35400100	PCC BASE COURSE WIDENING 6"	SQ YD	43		
40600100	BITUMINOUS MATERIALS PRIME COAT	GAL	2250		
42300200	PCC DRIVEWAY PAVEMENT 6"	SQ YD	15		
42400100	PCC SIDEWALK 4"	SQ FT	1669		
44000006	BITUMINOUS SURFACE REMOVAL, 1 1/2"	SQ YD	6422		
44000200	DRIVEWAY PAVEMENT REMOVAL	SQ YD	47		
44000500	COMBINATION CURB AND GUTTER REMOVAL	FOOT	2124		
44000600	SIDEWALK REMOVAL	SQ FT	473		
44300200	STRIP REFLECTIVE CRACK CONTROL TREATMENT, (2' WIDE)	FOOT	2124		
60300305	FRAMES AND LIDS TO BE ADJUSTED	EACH	5		
60603800	COMBINATION CURB AND GUTTER, TYPE B-6.12	FOOT	329		
60618300	CONCRETE MEDIAN SURFACE, 4 INCH	SQ FT	954		
70102670	TRAFFIC CONTROL AND PROTECTION, STANDARD 701601, SPECIAL	L SUM	1		
70102675	TRAFFIC CONTROL AND PROTECTION, STANDARD 701701, SPECIAL	L SUM	1		
72000100	SIGN PANEL-TYPE 1	SQ FT	4		
72400100	REMOVE SIGN PANEL ASSEMBLY, TYPE A	EACH	13		
78000100	THERMOPLASTIC PAVEMENT MARKING -LETTERS & SYMBOLS	SQ FT	130		
78000200	THERMOPLASTIC PAVEMENT MARKING, LINE 4"	FOOT	5426		
78000500	THERMOPLASTIC PAVEMENT MARKING, LINE 8"	FOOT	1253		
78000600	THERMOPLASTIC PAVEMENT MARKING, LINE 12"	FOOT	761		
78000650	THERMOPLASTIC PAVEMENT MARKING, LINE 24"	FOOT	173		
78300100	PAVEMENT MARKING REMOVAL	SQ FT	600		
81012600	CONDUIT IN TRENCH, 2" DIA., PVC	FOOT	220		
81012700	CONDUIT IN TRENCH, 2 1/2" DIA., PVC	FOOT	21		
81012800	CONDUIT IN TRENCH, 3" DIA., PVC	FOOT	9		
81013000	CONDUIT IN TRENCH, 4" DIA., PVC	FOOT	10		
81021330	CONDUIT PUSHED, 2" DIA., PVC	FOOT	31		
81021340	CONDUIT PUSHED, 2 1/2" DIA., PVC	FOOT	72		
81021350	CONDUIT PUSHED, 3" DIA., PVC	FOOT	61		
81021360	CONDUIT PUSHED, 3 1/2" DIA., PVC	FOOT	102		
81400400	CONCRETE HANDHOLE	EACH	3		
81400600	CONCRETE DOUBLE HANDHOLE	EACH	1		
81500200	TRENCH AND BACKFILL FOR ELECTRICAL WORK	FOOT	255		
81702130	ELECTRIC CABLE IN CONDUIT, SIGNAL, NO. 14 3C	FOOT	843.5		
82102400	LUMINAIRE, SODIUM VAPOR, HORIZONTAL MOUNT, 400 WATT	EACH	2		
84200500	REMOVAL OF EXISTING LIGHTING UNIT, SALVAGE	EACH	7		
85700205	FULL-ACTUATED CONTROLLER AND TYPE IV CABINET, SPECIAL	EACH	1		
85900100	TRANSCEIVER	EACH	1		
87301225	ELECTRIC CABLE IN CONDUIT, SIGNAL, NO. 14 3C	FOOT	249.5		
87301245	ELECTRIC CABLE IN CONDUIT, SIGNAL, NO. 14 5C	FOOT	1288		
87301255	ELECTRIC CABLE IN CONDUIT, SIGNAL, NO. 14 7C	FOOT	541		
87301515	ELECTRIC CABLE IN CONDUIT, LEAD-IN, NO. 18 3 PAIR	FOOT	555		
87700220	STEEL MAST ARM ASSEMBLY AND POLE, 36 FT.	EACH	1		
87700260	STEEL MAST ARM ASSEMBLY AND POLE, 44 FT.	EACH	1		
87702910	STEEL COMBINATION MAST ARM ASSEMBLY AND POLE 36 FT.	EACH	1		
87702940	STEEL COMBINATION MAST ARM ASSEMBLY AND POLE 42 FT.	EACH	1		
87800200	CONCRETE FOUNDATION, TYPE D	FOOT	3.5		
87800415	CONCRETE FOUNDATION, TYPE E 36-INCH DIAMETER	FOOT	48		
87900200	DRILL EXISTING HANDHOLE	EACH	1		
88200110	TRAFFIC SIGNAL BACKPLATE, LOUVERED, PLASTIC	EACH	8		
88700200	LIGHT DETECTOR	EACH	2		
88700300	LIGHT DETECTOR AMPLIFIER	EACH	1		
88800100	PEDESTRIAN PUSH-BUTTON	EACH	8		
X0323481	VIDEO VEHICLE DETECTION, 4 CAMERAS	EACH	1		
X4066436	BITUMINOUS CONCRETE SURFACE COURSE, SUPERPAVE, MIX 'E', N70	TON	622		
X4066616	BITUMINOUS CONCRETE BINDER COURSE, SUPERPAVE, IL-19.0, N70	TON	205		
X4409423	BITUMINOUS SURFACE REMOVAL, 3 3/4"	SQ YD	1446		
X8800020	SIGNAL HEAD, LED, 1-FACE, 3-SECTION, MAST-ARM MOUNTED	EACH	8		
X8810620	PEDESTRIAN SIGNAL HEAD, LED, 2-FACE, BRACKET MOUNTED	EACH	4		
XX002179	ELECTRIC CABLE IN CONDUIT, COMMUNICATION, NO. 20 3/C	FOOT	249.5		
XX003941	30 AMP, 1 POLE CIRCUIT BREAKER	EACH	1		
67100100	MOBILIZATION	L SUM	1		
42400800	DETECTABLE WARNINGS	SQ FT	126		

△ SPECIALTY ITEMS

F.A. RTE. 6708
SECTION 03-00170-00-TL
COUNTY: TAZEWELL
CONTRACT NO. 89353
CAT NO. 032923-00

REVISIONS		
NUMBER	BY	DATE

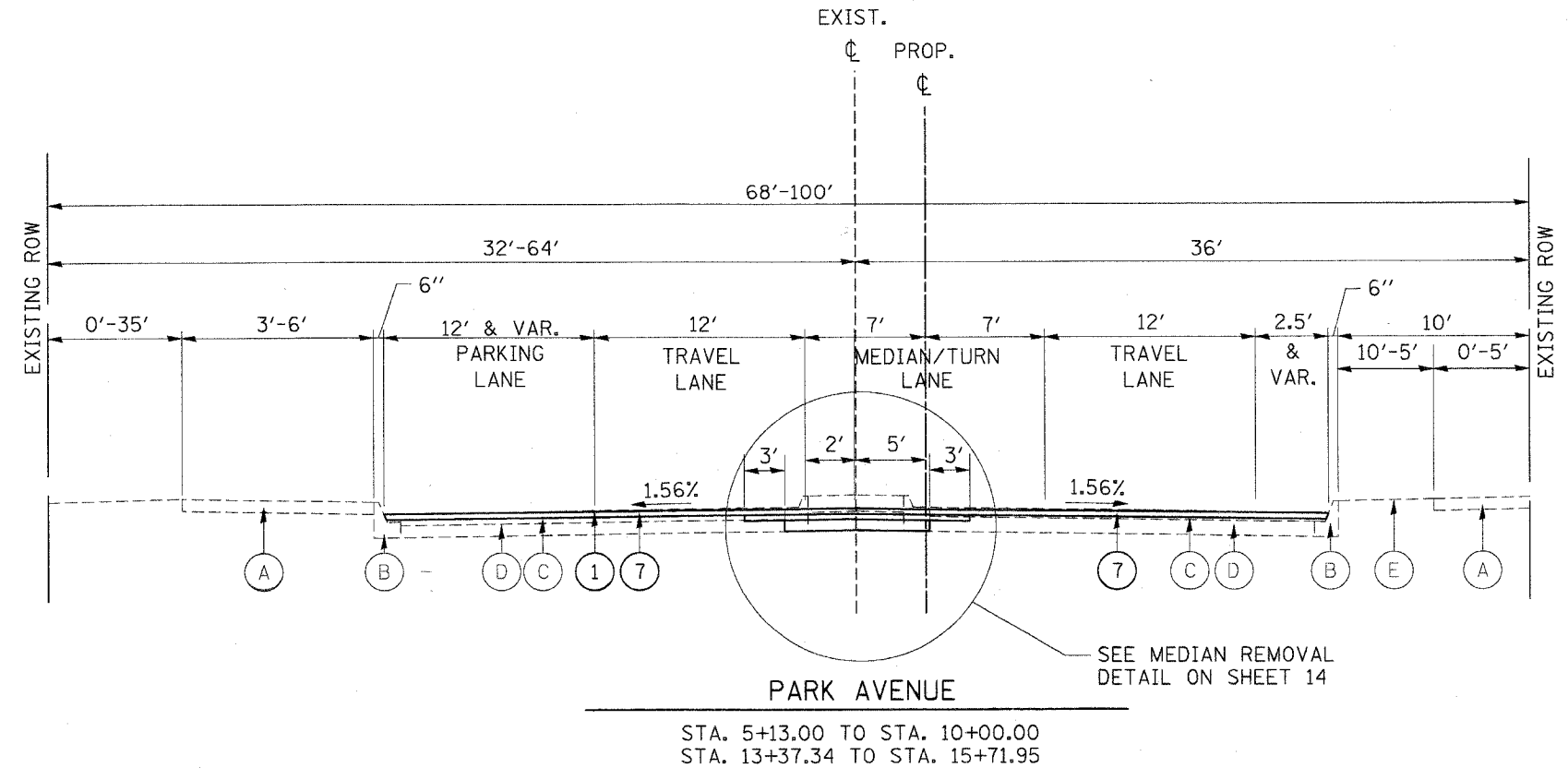
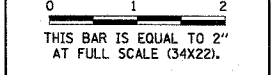

PARK AVENUE
STA. 5+13.00 TO STA. 10+00.00
STA. 13+37.34 TO STA. 15+71.95

- EXISTING**
- (A) P.C.C. SIDEWALK
 - (B) TYPE B-6.12 C&G (APPROXIMATELY 3" OF BIT. OVERLAY IN GUTTER FLAG)
 - (C) BITUMINOUS SURFACE, 6" (+/-)
 - (D) BITUMINOUS AGGREGATE MIXTURE, 6"
 - (E) GRASS PARKWAY

- PROPOSED**
- (1) BITUMINOUS SURFACE REMOVAL, 1-1/2"
 - (2) BITUMINOUS SURFACE REMOVAL, 3-3/4"
 - (3) COMBINATION CURB & GUTTER REMOVAL
 - (4) STRIP REFLECTIVE CRACK CONTROL, 2' WIDE
 - (5) PCC BASE COURSE, 6"
 - (6) BITUMINOUS CONCRETE BINDER COURSE, SUPERPAVE, IL-19.0, N70, 2-1/4"
 - (7) BITUMINOUS CONCRETE SURFACE COURSE, SUPERPAVE, MIX "E", N70, 1-1/2"
 - (8) 4" P.C.C. SIDEWALK

CITY OF PEKIN, IL
INTERSECTION RECONSTRUCTION
14TH ST. & PARK AVE.

PROPOSED TYPICAL SECTIONS
PARK AVENUE

CMT
CRAWFORD, MURPHY & TILLY, INC.
CONSULTING ENGINEERS
License No. 184-000813

DESIGN BY:	R.M.M.
DRAWN BY:	N.D.S.
CHECKED BY:	E.J.H.
APPROVED BY:	
DATE:	10/12/05
JOB No:	05069-02-00

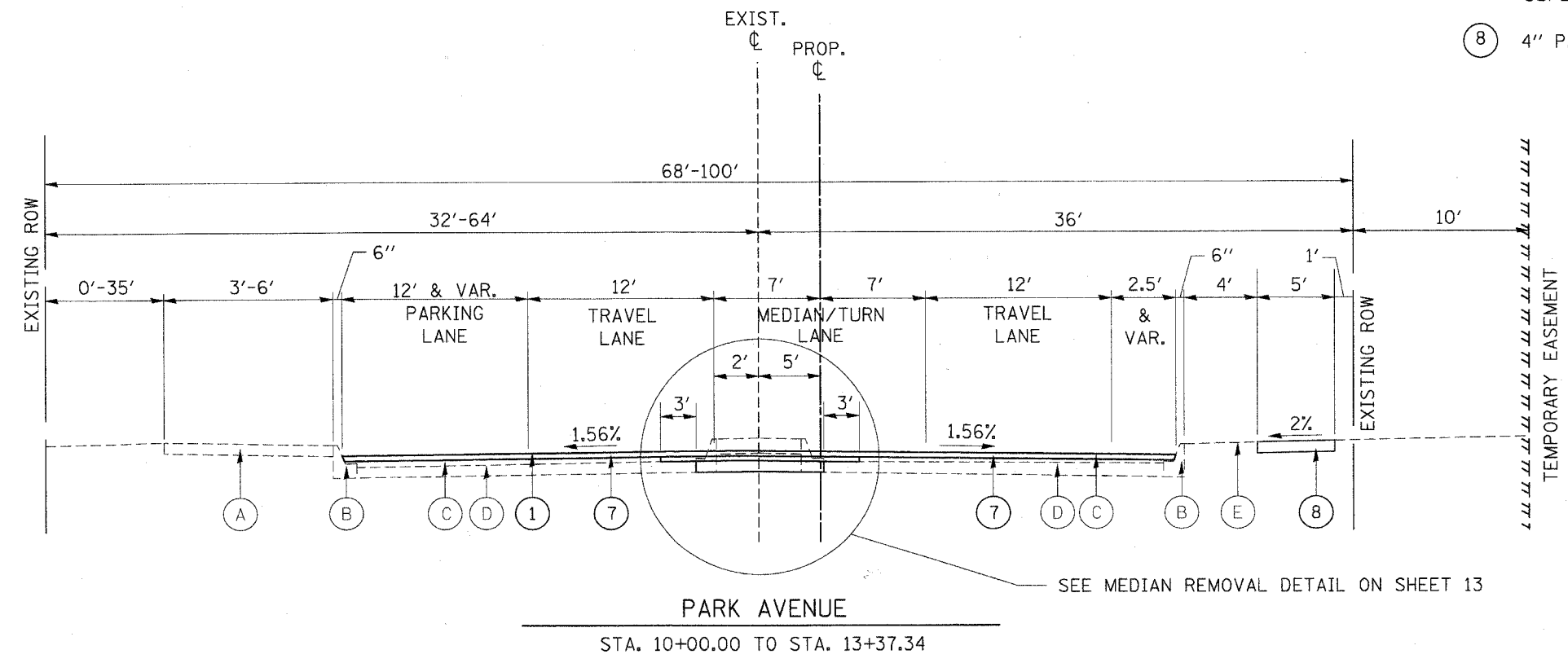

PARK AVENUE
STA. 10+00.00 TO STA. 13+37.34

- NOTES:**
- BITUMINOUS MILLING & OVERLAY TO EXTEND TO FACE OF EXISTING CURB
 - SEE PLAN SHEETS FOR PAVEMENT MARKING DETAILS ON PARK AVENUE

TEMPORARY EASEMENT

F.A. RTE. 6708
SECTION 03-00170-00-TL
COUNTY: TAZEWELL
CONTRACT NO. 89353
CAT NO. 032923-00

REVISIONS		
NUMBER	BY	DATE

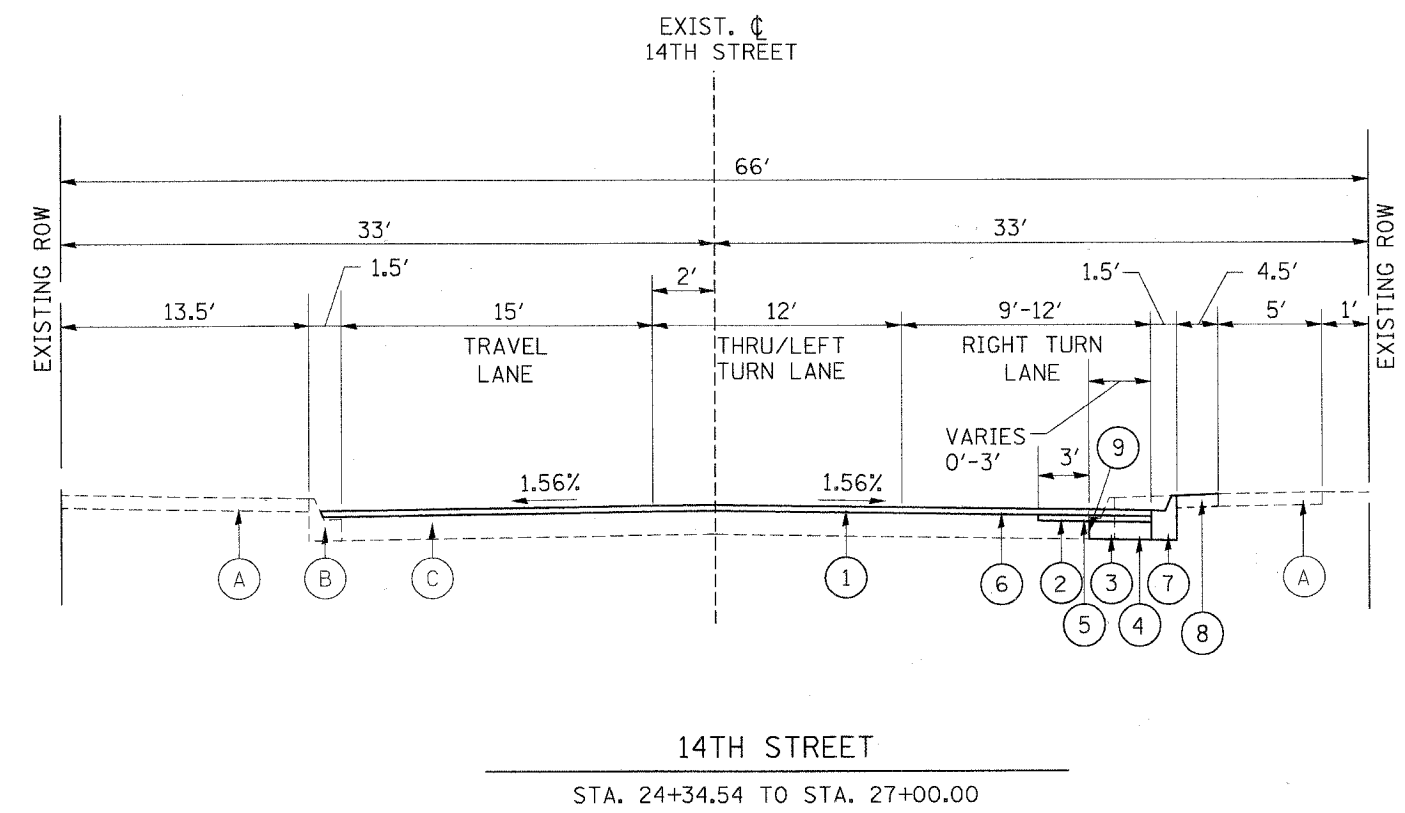
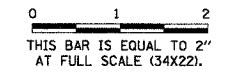

EXISTING

- (A) P.C.C SIDEWALK
- (B) TYPE B-6.12 C&G (APPROXIMATELY 3" OF BIT. OVERLAY IN GUTTER FLAG)
- (C) BITUMINOUS PAVEMENT

PROPOSED

- (1) BITUMINOUS SURFACE REMOVAL, 1-1/2"
- (2) BITUMINOUS SURFACE REMOVAL, 3-3/4"
- (3) COMBINATION CURB & GUTTER REMOVAL
- (4) PCC BASE COURSE WIDENING, 6"
- (5) BITUMINOUS CONCRETE BINDER COURSE, SUPERPAVE, IL-19.0, N70, 2-1/4"
- (6) BITUMINOUS CONCRETE SURFACE COURSE, SUPERPAVE, MIX "E", N70, 1-1/2"
- (7) TYPE B-6.12 COMBINATION CURB AND GUTTER
- (8) SEEDING, CLASS 2
- (9) STRIP REFLECTIVE CRACK CONTROL, 2' WIDE

NOTES:

1. LIMITS SHOWN ARE THE LIMITS OF BITUMINOUS MILLING AND OVERLAY FOR 14TH STREET
2. SEE PLAN SHEETS FOR PAVEMENT MARKING DETAILS ON 14TH STREET

CITY OF PEKIN, IL
INTERSECTION RECONSTRUCTION
14TH ST. & PARK AVE.

PROPOSED TYPICAL SECTIONS
14TH STREET

© Copyright CMT, Inc.
CMT
CRAWFORD, MURPHY & TILLY, INC.
CONSULTING ENGINEERS
License No. 184-000613

DESIGN BY:	R.M.M.
DRAWN BY:	N.D.S.
CHECKED BY:	E.J.H.
APPROVED BY:	
DATE:	10/12/05
JOB No:	05069-02-00
SHEET 4 OF 17 SHEET	

F.A. RTE. 6708
SECTION 03-0010-00-TL
COUNTY: TAZEWELL
CONTRACT NO. 89353
CAT NO. 032923-00

EARTH EXCAVATION SCHEDULE	
STATION	QUANTITY (CU YD)
PARK AVE.	
STA. 5+13.00 TO STA. 7+3.35	91
STA. 7+55.95 TO STA. 9+68.73	78
STA. 10+30.63 TO STA. 13+27.07	97
STA. 13+74.98 TO STA. 15+51.24	54
STA. 15+22.24 TO STA. 15+58.26	19
14TH ST.	
STA. 24+34.54 TO STA. 26+36.79 RT.	19
TOTAL =	358

SEEDING, CLASS 1A SCHEDULE	
STATION	QUANTITY (ACRE)
14TH ST.	
STA. 24+35 RT TO STA. 24+54 RT	0.002
STA. 24+66 RT TO STA. 25+90 RT	0.005
PARK AVE.	
STA. 10+28 RT TO STA. 13+38 RT	0.08
TOTAL =	0.09

PCC BASE COURSE 6" SCHEDULE	
STATION	QUANTITY (SQ YD)
PARK AVE.	
STA. 5+13.00 TO STA. 7+3.35	205
STA. 7+55.95 TO STA. 9+68.73	177
STA. 10+30.63 TO STA. 13+27.07	218
STA. 13+74.98 TO STA. 15+51.24	122
STA. 15+22.24 TO STA. 15+58.26	43
TOTAL =	765

BITUMINOUS CONCRETE BINDER COURSE SCHEDULE	
STATION	QUANTITY (TON)
STA. 5+13.00 TO STA. 7+03.35	42
STA. 7+55.95 TO STA. 9+68.73	47
STA. 10+30.63 TO STA. 13+27.07	66
STA. 13+74.98 TO STA. 15+51.24	39
RIGHT TURN LANE	11
TOTAL =	205

BITUMINOUS CONCRETE SURFACE COURSE SCHEDULE	
LOCATION	QUANTITY (TON)
PARK AVENUE	554
14TH STREET	60
INTERSECTION	78
MEDIANS (SUBTRACTED)	70
TOTAL =	622

PCC SIDEWALK 4" SCHEDULE	
STATION	QUANTITY (SQ FT)
PARK AVE.	
STA. 10+21.27 TO STA. 13+37.33 RT.	1669
TOTAL =	1669

BITUMINOUS SURFACE REMOVAL, 1.5" SCHEDULE	
LOCATION	QUANTITY (SQ YD)
PARK AVENUE	5666
14TH STREET	655
INTERSECTION OF PARK AND 14TH	909
MEDIANS (SUBTRACTED)	808
TOTAL =	6422

BITUMINOUS SURFACE REMOVAL, 3.5" SCHEDULE	
STATION	QUANTITY (SQ YD)
PARK AVE.	
STA. 5+13.00 TO STA. 7+3.35	340
STA. 7+55.95 TO STA. 9+68.73	325
STA. 10+30.63 TO STA. 13+27.07	422
STA. 13+74.98 TO STA. 15+51.24	232
STA. 15+51.22 TO STA. 15+71.95	16
14TH ST.	
STA. 24+34.54 TO STA. 26+36.79	111
TOTAL =	1446

COMB. CURB & GUTTER REMOVAL SCHEDULE	
STATION RANGE	QUANTITY (FT.)
PARK AVE.	
STA. 5+13.00 TO STA. 7+3.35	391
STA. 7+55.95 TO STA. 9+68.73	433
STA. 10+30.63 TO STA. 13+27.07	600
STA. 13+74.98 TO STA. 15+51.24	357
STA. 15+51.22 TO STA. 15+71.95	84
STA. 10+21.27 TO STA. 10+55.88	57
14TH ST.	
STA. 24+34.54 TO STA. 26+15.97	202
TOTAL =	2124

SIDEWALK REMOVAL SCHEDULE	
STATION	QUANTITY (SQ FT)
PARK AVE.	
STA. 10+21.27 TO STA. 10+55.88 RT.	220
11+4.47 RT.	63
11+55.56 RT.	93
12+54.54 RT.	58
13+2.66 RT.	39
TOTAL =	473

STRIP REFLECTIVE CRACK CONTROL TREATMENT, 2'(WIDE) SCHEDULE	
STATION RANGE	QUANTITY (FT.)
PARK AVE.	
STA. 5+13.00 TO STA. 7+3.35	391
STA. 7+55.95 TO STA. 9+68.73	433
STA. 10+30.63 TO STA. 13+27.07	600
STA. 13+74.98 TO STA. 15+51.24	357
STA. 15+51.22 TO STA. 15+71.95	84
STA. 10+21.27 TO STA. 10+55.88	57
14TH ST.	
STA. 24+34.54 TO STA. 26+15.97	202
TOTAL =	2124

COMB. CURB & GUTTER B-6.12 SCHEDULE	
STATION RANGE	QUANTITY (FT.)
PARK AVE.	
STA. 15+22.24 TO STA. 15+58.26	128
14TH ST.	
STA. 24+34.54 TO STA. 26+15.97	201
TOTAL =	329

CONCRETE MEDIAN SURFACE 4" SCHEDULE	
STATION	QUANTITY (SQ FT)
PARK AVE.	
STA. 15+22.24 TO STA. 15+58.26	954
TOTAL =	954

SIGN PANEL SCHEDULE		
STATION	TYPE	QUANTITY (SQ. FT.)
PARK AVE.		
15+66.00, 28.00' RT.	NO LEFT TURN (R3-2)	4
TOTAL =		4

THERMOPLASTIC PAVE. MARKING, 4" SCHEDULE	
STATION RANGE	QUANTITY (FT.)
PARK AVE.	
STA. 5+51.10 TO STA. 8+50.00	124
STA. 5+20.88 TO STA. 9+54.56	434
STA. 5+31.10 TO STA. 9+54.85	1696
STA. 10+80.88 TO STA. 13+68.69	194
STA. 10+41.16 TO STA. 13+28.62	288
STA. 10+41.16 TO STA. 13+22.67	1174
STA. 13+92.69 TO STA. 14+72.77	168
STA. 13+80.07 TO STA. 14+60.96	87
14TH ST.	
STA. 23+47.32 TO STA. 25+91.49	488
STA. 23+49.84 TO STA. 24+34.54	86
STA. 26+88.83 TO STA. 29+21.74	687
TOTAL =	5426

REVISIONS		
NUMBER	BY	DATE

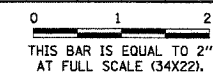

CITY OF PEKIN, IL
INTERSECTION RECONSTRUCTION
14TH ST. & PARK AVE.

SCHEDULE OF QUANTITIES

© Copyright 2011, Inc.

CMT
CRAWFORD, MURPHY & TILLY, INC.
CONSULTING ENGINEERS
License No. 184-000613



DESIGN BY:	R.M.M.
DRAWN BY:	N.D.S.
CHECKED BY:	E.J.H.
APPROVED BY:	
DATE:	10/12/05
JOB No:	05069-02-00

F.A. RTE. 6708
SECTION 03-0070-00-TL
COUNTY: TAZEWELL
CONTRACT NO. 89353
CAT NO. 032923-00

REVISIONS		
NUMBER	BY	DATE

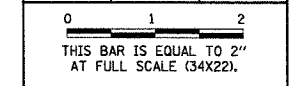

**CITY OF PEKIN, IL
INTERSECTION RECONSTRUCTION
14TH ST. & PARK AVE.**

SCHEDULE OF QUANTITIES

© Copyright CMT, Inc.
CMT
CRAWFORD, MURPHY & TILLY, INC.
CONSULTING ENGINEERS
License No. 184-000613

DESIGN BY:	R.M.M.
DRAWN BY:	N.D.S.
CHECKED BY:	E.J.H.
APPROVED BY:	
DATE:	10/12/05
JOB No:	05069-02-00

THERMOPLASTIC PAVEMENT MARKING, 8" SCHEDULE		
STATION	QUANTITY (FT.)	
PARK AVE.		
STA. 8+24.60 TO STA. 9+54.60	130	
9+59.33	119	
10+30.04	129	
STA. 10+41.16 TO STA. 12+01.07	160	
15+35.28	49	
15+58.33	37	
14TH ST.		
STA. 24+83.54 TO STA. 25+98.57	115	
26+02.65	125	
26+79.66	105	
STA. 28+07.04 TO STA. 29+35.29	128	
29+46.43	156	
TOTAL =	1253	

THERMOPLASTIC PAVEMENT MARKING, 12" SCHEDULE		
STATION RANGE	DETAILS	
PARK AVE.		
STA. 5+31.10 TO STA. 9+54.85	45% EVERY 15'	
STA. 7+40.97 TO STA. 7+70.67	45% EVERY 5'	
STA. 8+54.69 TO STA. 9+48.17	45% EVERY 10'	
STA. 10+41.16 TO STA. 13+22.67	45% EVERY 15'	
STA. 13+89.23 TO STA. 15+64.58	45% EVERY 15'	
14TH ST.		
STA. 23+49.84 TO STA. 24+34.54	45% EVERY 15'	
STA. 26+88.83 TO STA. 29+21.74	45% EVERY 20'	
TOTAL =	761 FT.	

THERMOPLASTIC PAVEMENT MARKING, 24" SCHEDULE		
STATION	QUANTITY (FT.)	
PARK AVE.		
9+54.56	27	
10+41.16	38	
15+54.80	18	
14TH ST.		
25+91.49	11.5	
25+98.57	16.5	
26+91.46	22.5	
29+21.74	10.5	
29+35.29	29	
TOTAL =	173	

LETTERS & SYMBOLS (SMALL SIZE) SCHEDULE			
STATION	TYPE	QUANTITY (SQ. FT.)	
PARK AVE.			
8+41.82	L. ARROW	8.8	
9+28.80	L. ARROW	8.8	
10+58.12	L. ARROW	8.8	
11+22.89	L. ARROW	8.8	
11+88.26	L. ARROW	8.8	
15+36.39	R. ARROW	8.8	
BEFORE 15+36.39	ONLY	12	
14TH ST.			
24+94.19	R. ARROW	8.8	
24+94.19	L. & TH. ARROW	14.7	
25+73.45	L. & TH. ARROW	14.7	
25+81.64	R. ARROW	8.8	
28+38.60	L. ARROW	8.8	
29+02.65	L. ARROW	8.8	
TOTAL =		130	

REMOVE SIGN PANEL ASSEMBLY, TYPE A				
STATION	OFFSET	QUANTITY (EACH)	TYPE	
PARK AVE.				
7+69.77	3.19' LT.	1	PED. CROSSING	
7+79.75	5.78' LT.	1	PED. CROSSING	
5+39.79	24.22' RT.	1	NO PARKING HERE TO CORNER	
6+58.05	22.48' RT.	1	2 HR. PARKING 9AM-5PM	
7+47.41	22.71' RT.	1	NO PARKING HERE ANYTIME/DR. PARKING	
7+63.51	22.54' RT.	1	PATIENT PARKING	
9+01.55	23.39' RT.	1	NO PARKING HERE TO CORNER	
9+52.94	24.11' RT.	1	4-WAY STOP, PARK & 14TH	
10+23.69	47.79' RT.	1	STOP, RT. LANE MUST TURN RT.	
12+02.85	22.75' RT.	1	2 HR. PARKING 9AM-5PM, BUS ROUTE	
9+74.38	53.97' LT.	1	STOP	
10+42.91	32.66' LT.	1	STOP	
14TH ST.				
25+39.58	18.96' RT.	1	NO PARKING ANYTIME & TRUCK ROUTE	
TOTAL =		13		

REMOVAL OF EXISTING LIGHTING UNIT, SALVAGE			
STATION	OFFSET	QUANTITY (EACH)	
PARK AVE.			
5+23.76	5.03' LT.	1	
8+07.92	4.98' LT.	1	
9+58.95	5.87' LT.	1	
10+49.65	3.35' LT.	1	
11+83.23	3.83' LT.	1	
13+16.99	4.49' LT.	1	
15+49.61	1.69' LT.	1	
TOTAL =		7	

FRAMES AND LIDS TO BE ADJUSTED SCHEDULE			
STATION	OFFSET	QUANTITY (EACH)	
PARK AVE.			
5+14.77	4.63' LT.	1	
5+19.53	1.89' LT.	1	
7+68.19	4.27' LT.	1	
7+96.01	6.61' LT.	1	
12+67.68	3.23' LT.	1	
TOTAL =		5	

PCC BASE COURSE WIDENING, 6' SCHEDULE		
STATION	QUANTITY (SQ YD)	
14TH ST.		
STA. 24+44.22 TO STA. 26+36.79 RT.	43	
TOTAL =	43	

DRIVEWAY PAVEMENT REMOVAL SCHEDULE		
STATION	QUANTITY (SQ YD)	
PARK AVE.		
11+26.62 RT.	27	
12+19.65 RT.	20	
TOTAL =	47	

PCC DRIVEWAY PAVEMENT 6' SCHEDULE		
STATION	QUANTITY (SQ YD)	
14TH ST.		
24+55.29 RT.	15	
TOTAL =	15	

MULCH SCHEDULE		
STATION	QUANTITY (ACRE)	
14TH ST.		
STA. 24+35 RT TO STA. 24+54 RT	0.002	
STA. 24+66 RT TO STA. 25+90 RT	0.005	
PARK AVE.		
STA. 10+28 RT TO STA. 13+38 RT	0.08	
TOTAL =	0.09	

INLET & PIPE PROTECTION SCHEDULE		
STATION	QUANTITY (EACH)	
PARK AVE.		
STA. 9+67 RT	1	
STA. 9+68 LT	1	
STA. 12+69 RT	1	
STA. 15+41 LT	1	
STA. 15+65 RT	1	
TOTAL =	5.0	

NITROGEN, PHOSPHORUS, & POTASSIUM FERTILIZER NUTRIENT		
STATION	QUANTITY (LB)	
PARK AVE.		
STA. 10+28 RT TO STA. 13+38 RT	7.3	
14TH ST.		
STA. 24+35 RT TO STA. 24+54 RT	0.2	
STA. 24+66 RT TO STA. 25+90 RT	0.5	
TOTAL =	8.0	

F.A. RTE. 6708
 SECTION 03-0010-00-TL
 COUNTY: TAZEWELL
 CONTRACT NO. 89353
 CAT NO. 032923-00

REVISIONS		
NUMBER	BY	DATE

0 1 2
 THIS BAR IS EQUAL TO 2"
 AT FULL SCALE (34X22).

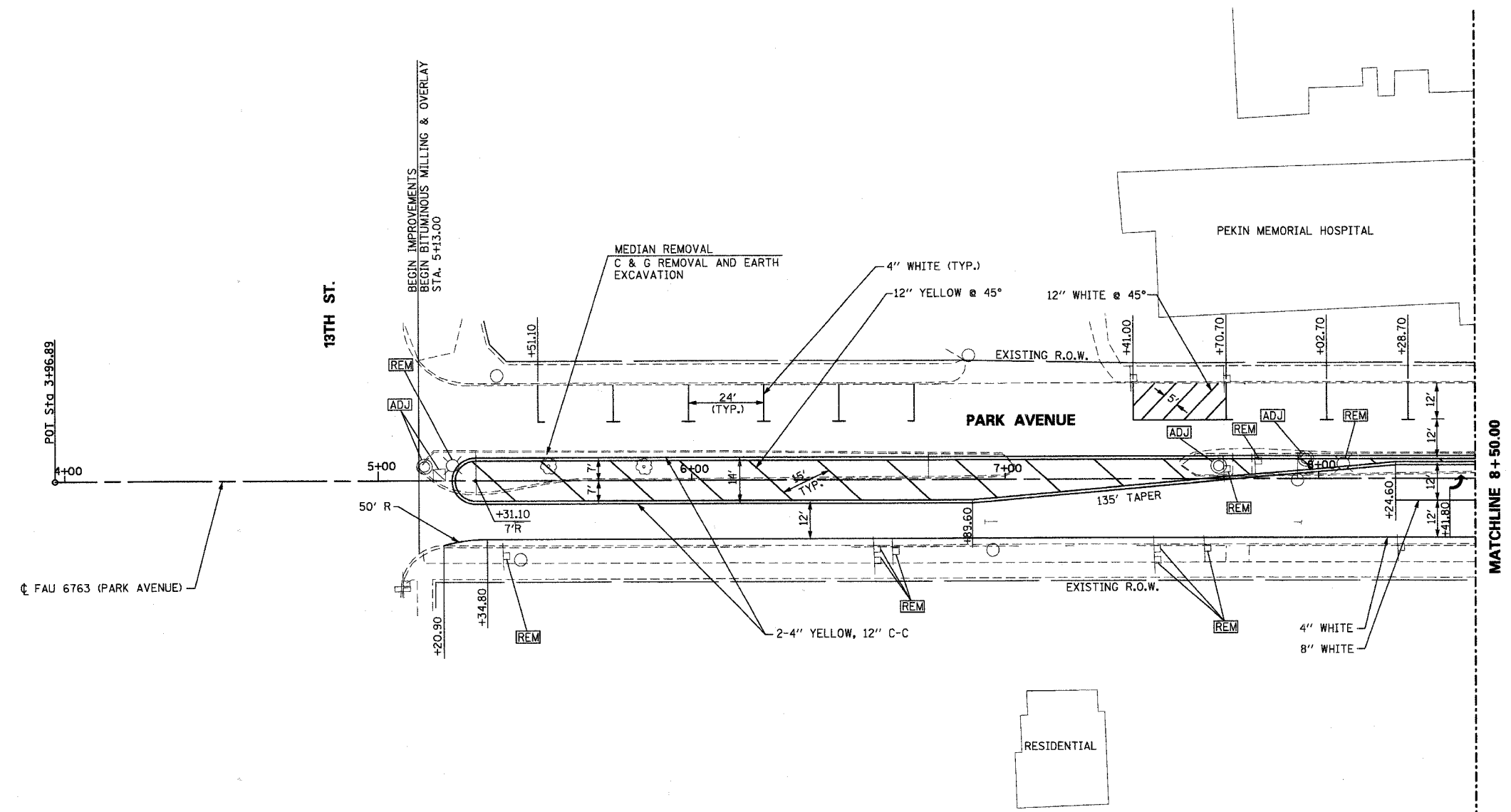
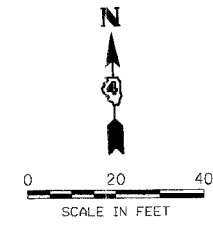

HORIZONTAL CONTROL POINTS (THIS SHEET)		
POINT	NORTHING	EASTING
POT STA. 3+96.89	10,305.646	19,429.893

© Copyright CMT, Inc.

CMT
 CRAWFORD, MURPHY & TILLY, INC.
 CONSULTING ENGINEERS
 License No. 084-000613

DESIGN BY:	R.M.M.
DRAWN BY:	N.D.S.
CHECKED BY:	E.J.H.
APPROVED BY:	
DATE:	10/12/05
JOB No:	05069-02-00

F.A. RTE. 6708
SECTION 03-00170-00-TL
COUNTY: TAZEWELL
CONTRACT NO. 89353
CAT NO. 032923-00

REVISIONS		
NUMBER	BY	DATE

0 1 2
THIS BAR IS EQUAL TO 2"
AT FULL SCALE (34X22).

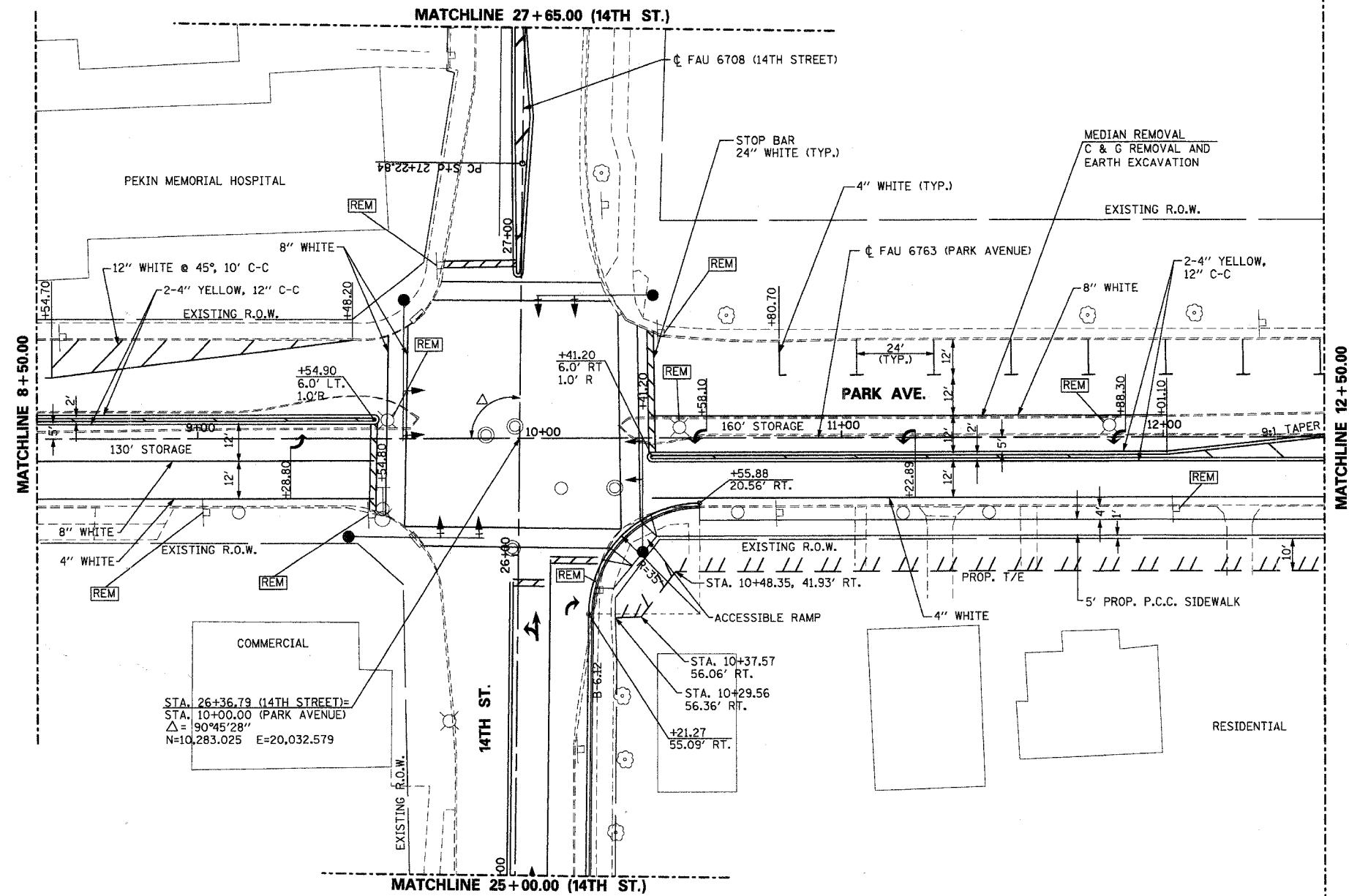
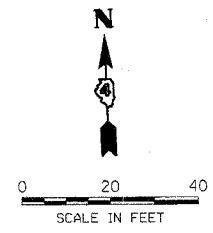

**CITY OF PEKIN, IL
INTERSECTION RECONSTRUCTION
14TH ST. & PARK AVE.
PARK AVENUE
STA. 8 + 50.00 TO STA. 12 + 50.00**

© copyright CMT, Inc.
CMT
CRAWFORD, MURPHY & TILLY, INC.
CONSULTING ENGINEERS
License No. 184-000613

DESIGN BY: R.M.M.
DRAWN BY: N.D.S.
CHECKED BY: E.J.H.
APPROVED BY:
DATE: 10/12/05
JOB No: 05069-02-00

F.A. RTE. 6708
SECTION 03-00170-00-TL
COUNTY: TAZEWELL
CONTRACT NO. 89353
CAT NO. 032923-00

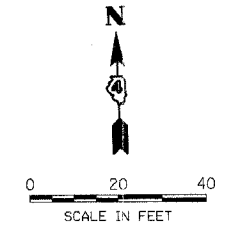

REVISIONS		
NUMBER	BY	DATE

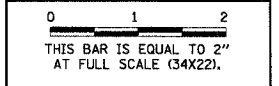

PROP. CURVE PARK_A
PI STA. = 14+94.29
 $\Delta = 47^\circ 31' 38''$ (LT)
D = 38° 11' 50"
R = 150.00'
T = 66.04'
L = 124.43'
E = 13.90'
P.C. STA = 14+28.24
P.T. STA = 15+52.67

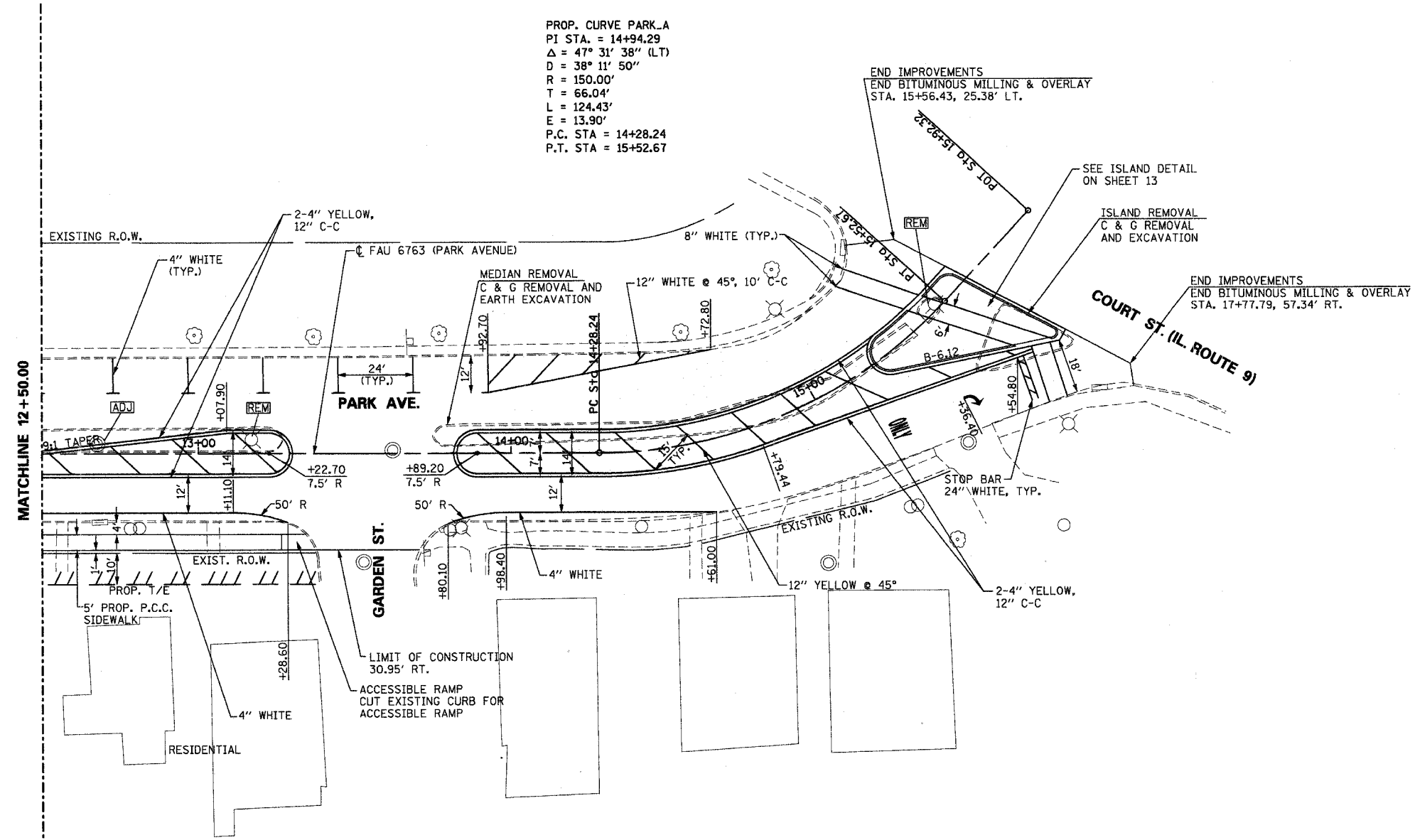

HORIZONTAL CONTROL POINTS (THIS SHEET)		
POINT	NORTHING	EASTING
PC STA. 14+28.24	10,266.962	20,460.518
PI STA. 14+94.29	10,264.485	20,526.515
PT STA. 15+52.67	10,311.492	20,572.906

CITY OF PEKIN, IL
INTERSECTION RECONSTRUCTION
14TH ST. & PARK AVE.
PARK AVENUE
STA. 12+50.00 TO STA. 15+71.95

© Copyright CMT, Inc.
CMT
CRAWFORD, MURPHY & TILLY, INC.
CONSULTING ENGINEERS
License No. 184-000613

DESIGN BY: R.M.M.
DRAWN BY: N.D.S.
CHECKED BY: E.J.H.
APPROVED BY:
DATE: 10/12/05
JOB No: 05069-02-00

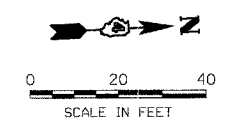

F.A. RTE. 6708
SECTION 03-00170-00-TL
COUNTY: TAZEWELL
CONTRACT NO. 89353
CAT NO. 032923-00

REVISIONS		
NUMBER	BY	DATE

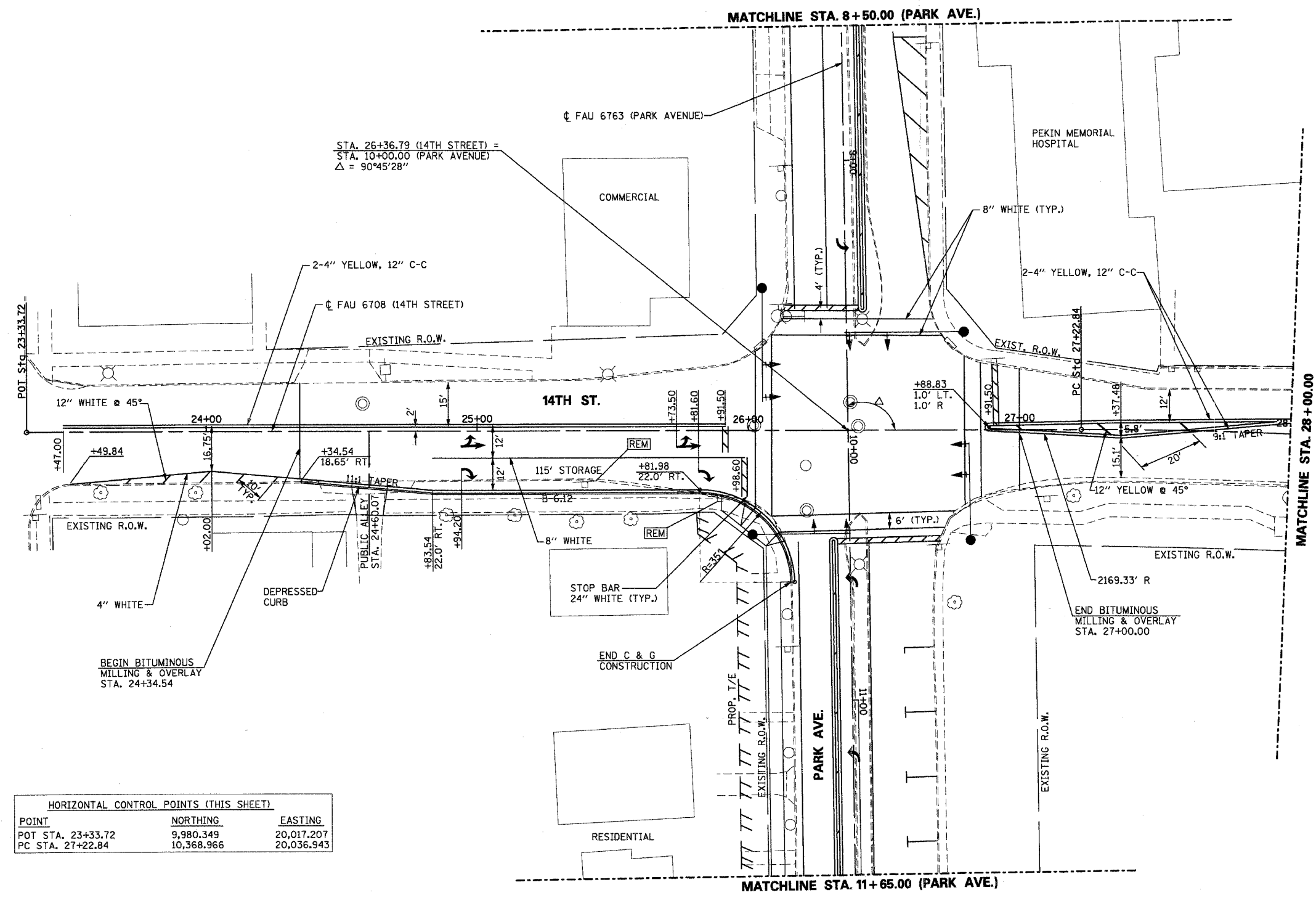
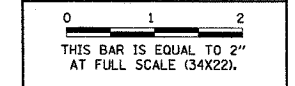

HORIZONTAL CONTROL POINTS (THIS SHEET)		
POINT	NORTHING	EASTING
POT STA. 23+33.72	9,980.349	20,017.207
PC STA. 27+22.84	10,368.966	20,036.943

CITY OF PEKIN, IL
INTERSECTION RECONSTRUCTION
14TH ST. & PARK AVE.

14TH STREET
STA. 24+34.54 TO STA. 28+00.00

Copyright CMT, Inc.
CMT
CRAWFORD, MURPHY & TILLY, INC.
CONSULTING ENGINEERS
License No. 184-000613

DESIGN BY:	R.M.M.
DRAWN BY:	N.D.S.
CHECKED BY:	E.J.H.
APPROVED BY:	
DATE:	10/12/05
JOB No:	05069-02-00
SHEET 10 OF 17 SHEET	

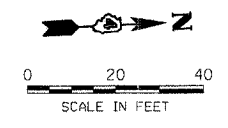

F.A. RTE. 6708
SECTION 03-00170-00-TL
COUNTY: TAZEWELL
CONTRACT NO. 89353
CAT NO. 032923-00

REVISIONS		
NUMBER	BY	DATE

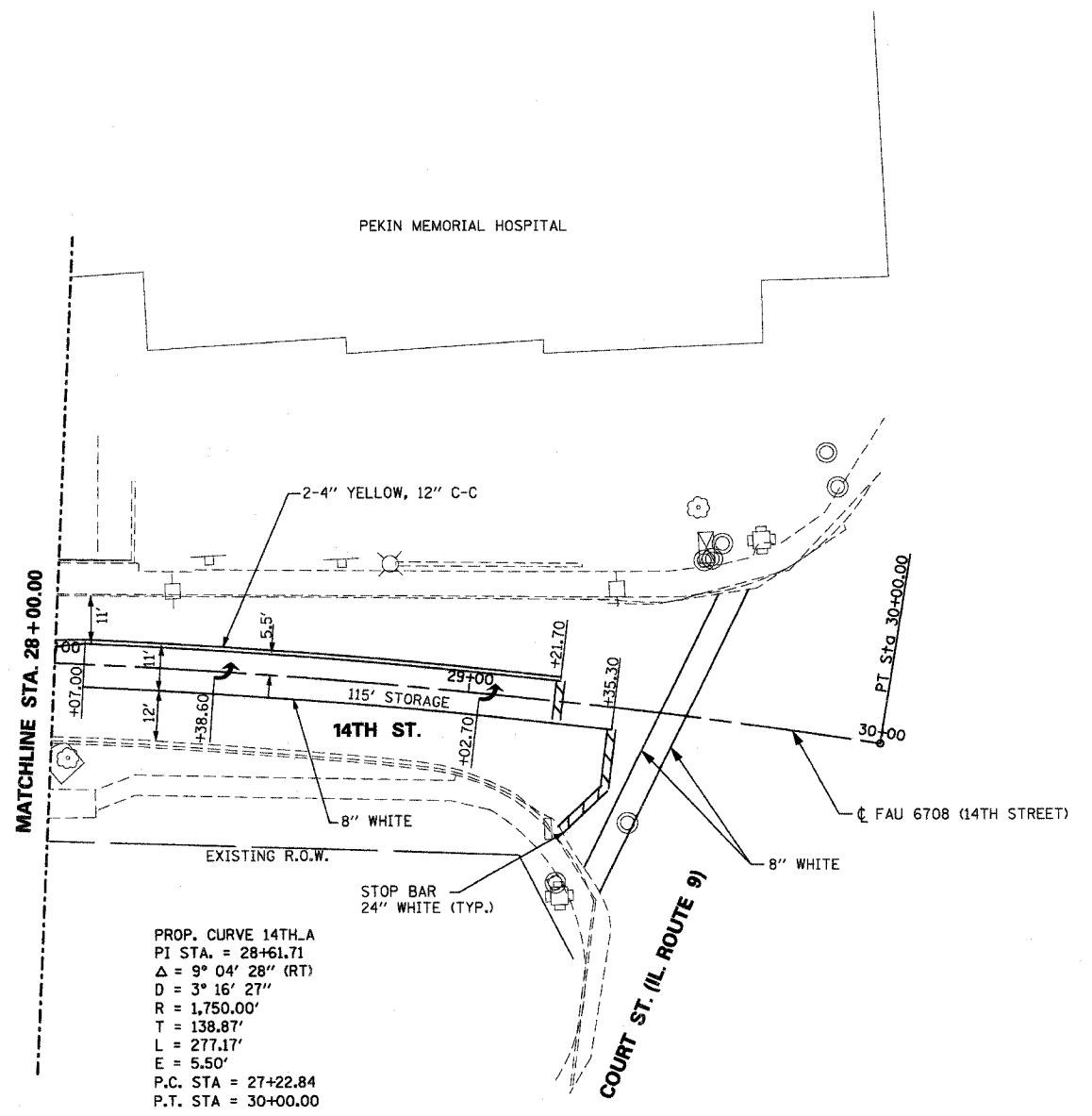
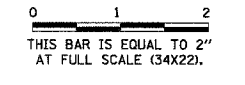

PROP. CURVE 14TH_A
PI STA. = 28+61.71
 $\Delta = 9^\circ 04' 28''$ (RT)
D = 3° 16' 27"
R = 1,750.00'
T = 138.87'
L = 277.17'
E = 5.50'
P.C. STA = 27+22.84
P.T. STA = 30+00.00

HORIZONTAL CONTROL POINTS (THIS SHEET)		
POINT	NORTHING	EASTING
PT STA. 30+00.00	10,643.507	20,072.817
PI STA. 28+61.71	10,507.660	20,043.987

**CITY OF PEKIN, IL
INTERSECTION RECONSTRUCTION
14TH ST. & PARK AVE.**

**14TH STREET
STA. 28+00.00 TO STA. 29+50.00**

©Copyright CMT, Inc.
CMT
CRAWFORD, MURPHY & TILLY, INC.
CONSULTING ENGINEERS
License No. 084-000613

DESIGN BY:	R.M.M.
DRAWN BY:	N.D.S.
CHECKED BY:	E.J.H.
APPROVED BY:	
DATE:	10/12/05
JOB No:	05069-02-00
SHEET 11 OF 17 SHEET	

F.A. RTE. 6708
SECTION 03-0070-00-TL
COUNTY: TAZEWELL
CONTRACT NO. 89353
CAT NO. 032923-00

- NOTES:**
1. ALL ELEVATIONS ARE ASSUMED DATUM
 2. ROTO-MILL EXISTING PAVEMENT AND PLACE BITUMINOUS OVERLAY SUCH THAT OVERLAY THICKNESS IS NOT LESS THAN 1 INCH AND RUNOFF DRAINS FROM PAVEMENT TO CURB AND GUTTER.

REVISIONS		
NUMBER	BY	DATE

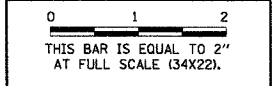

**CITY OF PEKIN, IL
INTERSECTION RECONSTRUCTION
14TH ST. & PARK AVE.
14TH STREET & PARK AVENUE
INTERSECTION DETAIL**

Copyright © 2005, Inc.
CMT
CRAWFORD, MURPHY & TILLY, INC.
CONSULTING ENGINEERS
License No. 084-000613

DESIGN BY:	R.M.M.
DRAWN BY:	R.M.M.
CHECKED BY:	E.J.H.
APPROVED BY:	
DATE:	10/12/05
JOB No:	05069-02-00
SHEET 12 OF 17 SHEET	

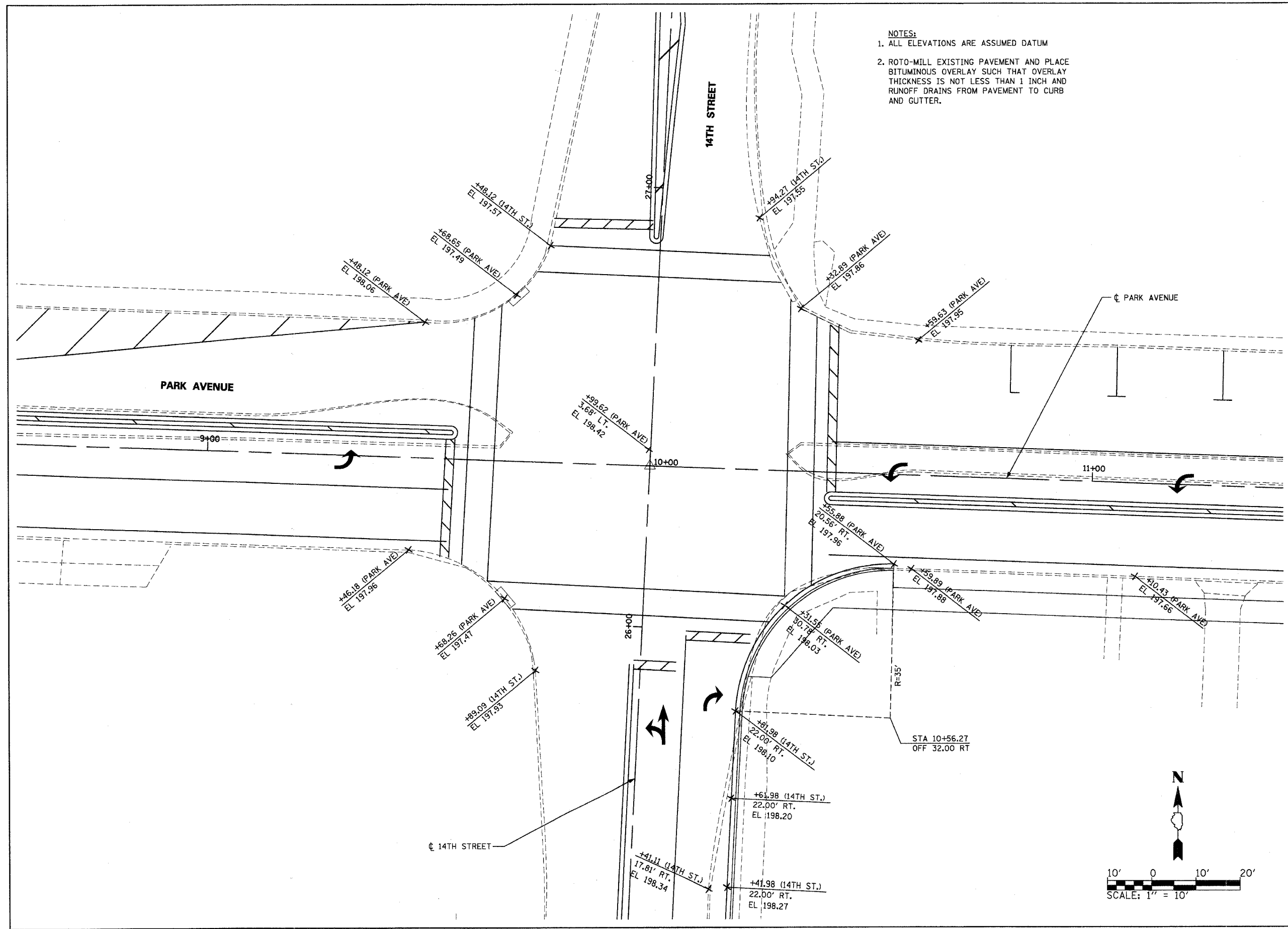

F.A. RTE. 6708
 SECTION 03-00170-00-TL
 COUNTY: TAZEWELL
 CONTRACT NO. 89353
 CAT NO. 032923-00

REVISIONS		
NUMBER	BY	DATE

0 1 2
 THIS BAR IS EQUAL TO 2"
 AT FULL SCALE (34x22).

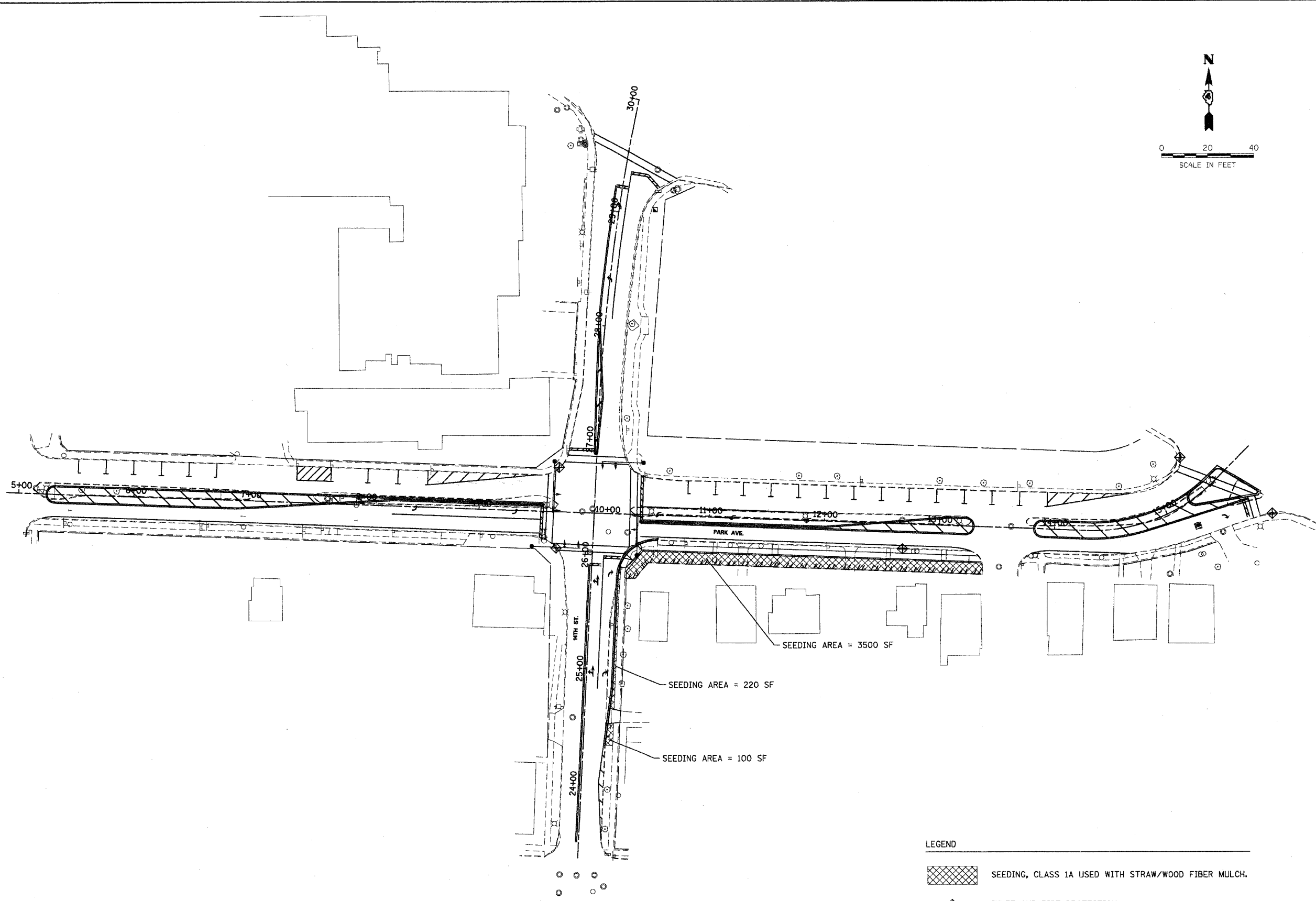
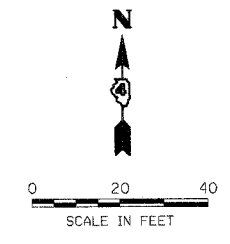

LEGEND

	SEEDING, CLASS 1A USED WITH STRAW/WOOD FIBER MULCH.
	INLET AND PIPE PROTECTION

CITY OF PEKIN, IL
 INTERSECTION RECONSTRUCTION
 14TH ST. & PARK AVE.
 EROSION CONTROL PLAN

Copyright: CMT, Inc.
CMT
 CRAWFORD, MURPHY & TILLY, INC.
 CONSULTING ENGINEERS
 License No. 184-000613

DESIGN BY:	R.M.M.
DRAWN BY:	N.D.S.
CHECKED BY:	E.J.H.
APPROVED BY:	
DATE:	10/12/05
JOB No:	05069-02-00

F.A. RTE. 6708
SECTION 03-0010-00-TL
COUNTY: TAZEWELL
CONTRACT NO. 89353
CAT NO. 032923-00

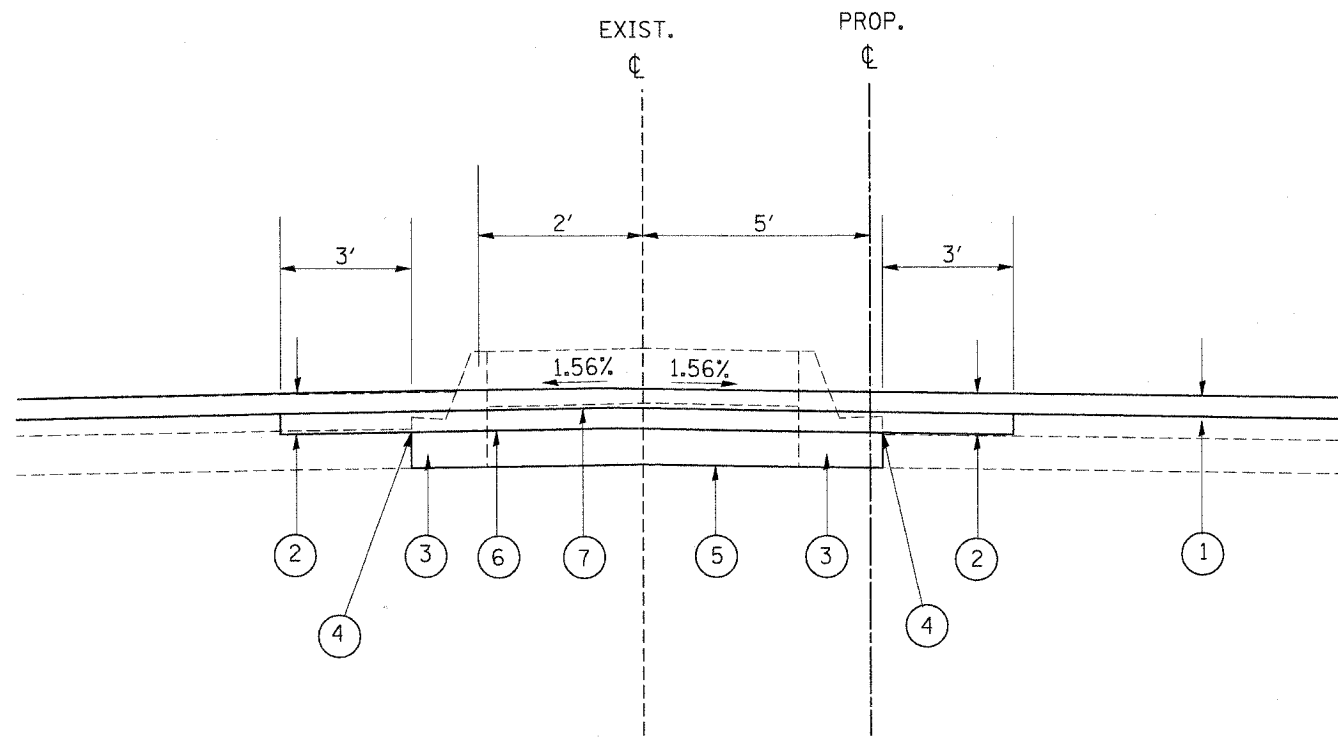

PARK AVENUE
MEDIAN REMOVAL DETAIL

PROPOSED

- ① BITUMINOUS SURFACE REMOVAL, 1-1/2"
- ② BITUMINOUS SURFACE REMOVAL, 3-3/4"
- ③ COMBINATION CURB & GUTTER REMOVAL
- ④ STRIP REFLECTIVE CRACK CONTROL, 2'
- ⑤ PCC BASE COURSE, 6"
- ⑥ BITUMINOUS CONCRETE BINDER COURSE, SUPERPAVE, IL-19.0, N70, 2-1/4"
- ⑦ BITUMINOUS CONCRETE SURFACE COURSE, SUPERPAVE, MIX "E", N70, 1-1/2"

REVISIONS		
NUMBER	BY	DATE

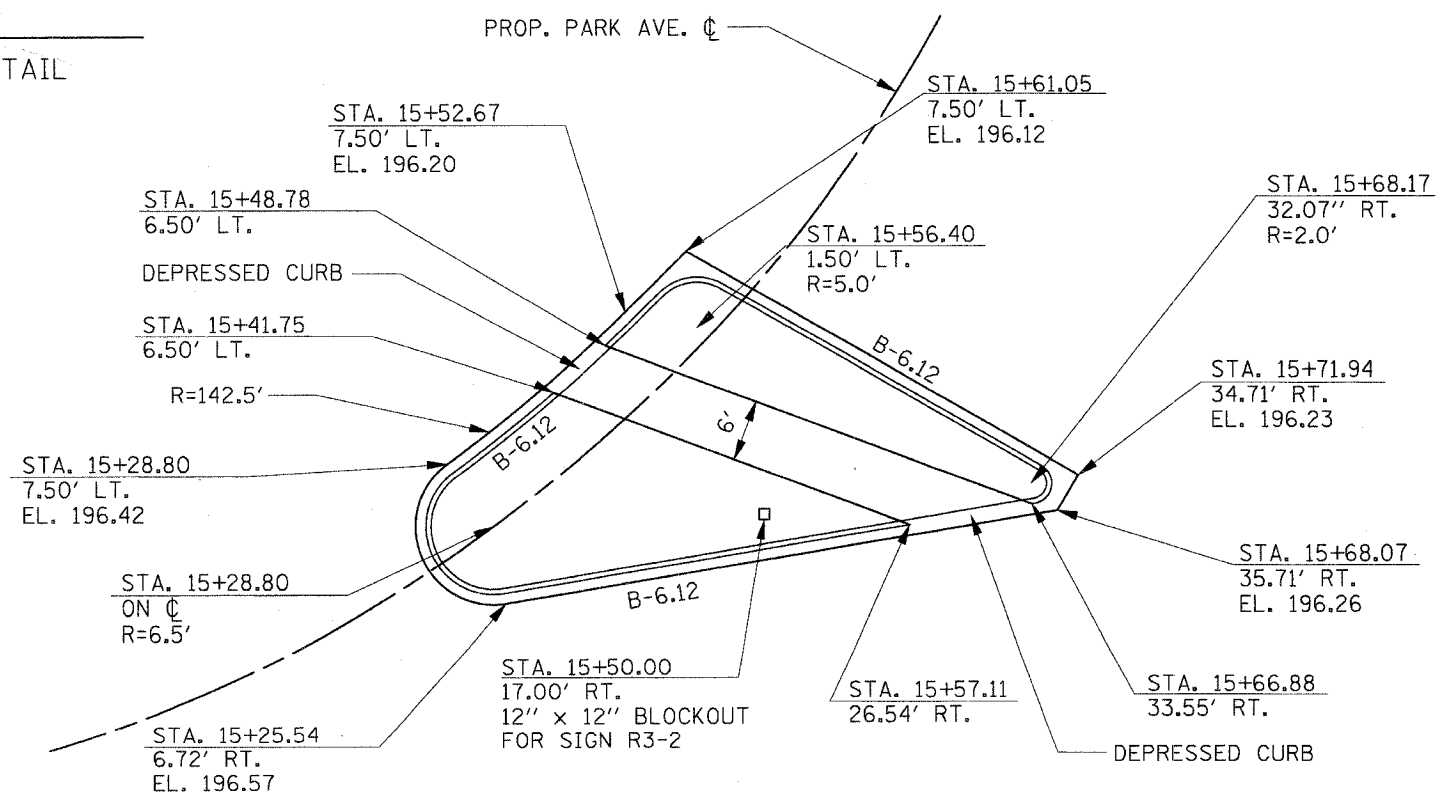
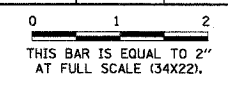

ISLAND DETAIL (N.T.S.)

CITY OF PEKIN, IL
INTERSECTION RECONSTRUCTION
14TH ST. & PARK AVE.

CONSTRUCTION DETAILS

Copyright CMT, Inc.
CMT
CRAWFORD, MURPHY & TILLY, INC.
CONSULTING ENGINEERS
License No. IB4-000613

DESIGN BY:	R.M.M.
DRAWN BY:	R.M.M.
CHECKED BY:	E.J.H.
APPROVED BY:	
DATE:	10/12/05
JOB No:	05069-02-00

F.A. RTE. 6708
SECTION 03-0070-00-TL
COUNTY: TAZEWELL
CONTRACT NO. 89353
CAT NO. 032923-00

TRAFFIC SIGNAL LEGEND

PROPOSED	EXISTING	
		CONTROLLER
		SERVICE INSTALLATION
		SIGNAL HEAD
		SIGNAL HEAD WITH BACKPLATE
		SIGNAL HEAD PEDESTRIAN
		SIGNAL POST
		MAST ARM ASSEMBLY AND POLE, STEEL
		HANDHOLE
		DOUBLE HANDHOLE
		G.S. CONDUIT IN TRENCH OR PUSHED
		LENGTH-CONSTRUCTION SIZE-TYPE
		PEDESTRIAN PUSH BUTTON DETECTOR
		VIDEO DETECTION CAMERA
		EMERGENCY VEHICLE DETECTOR AND BEACON
		LUMINAIRE

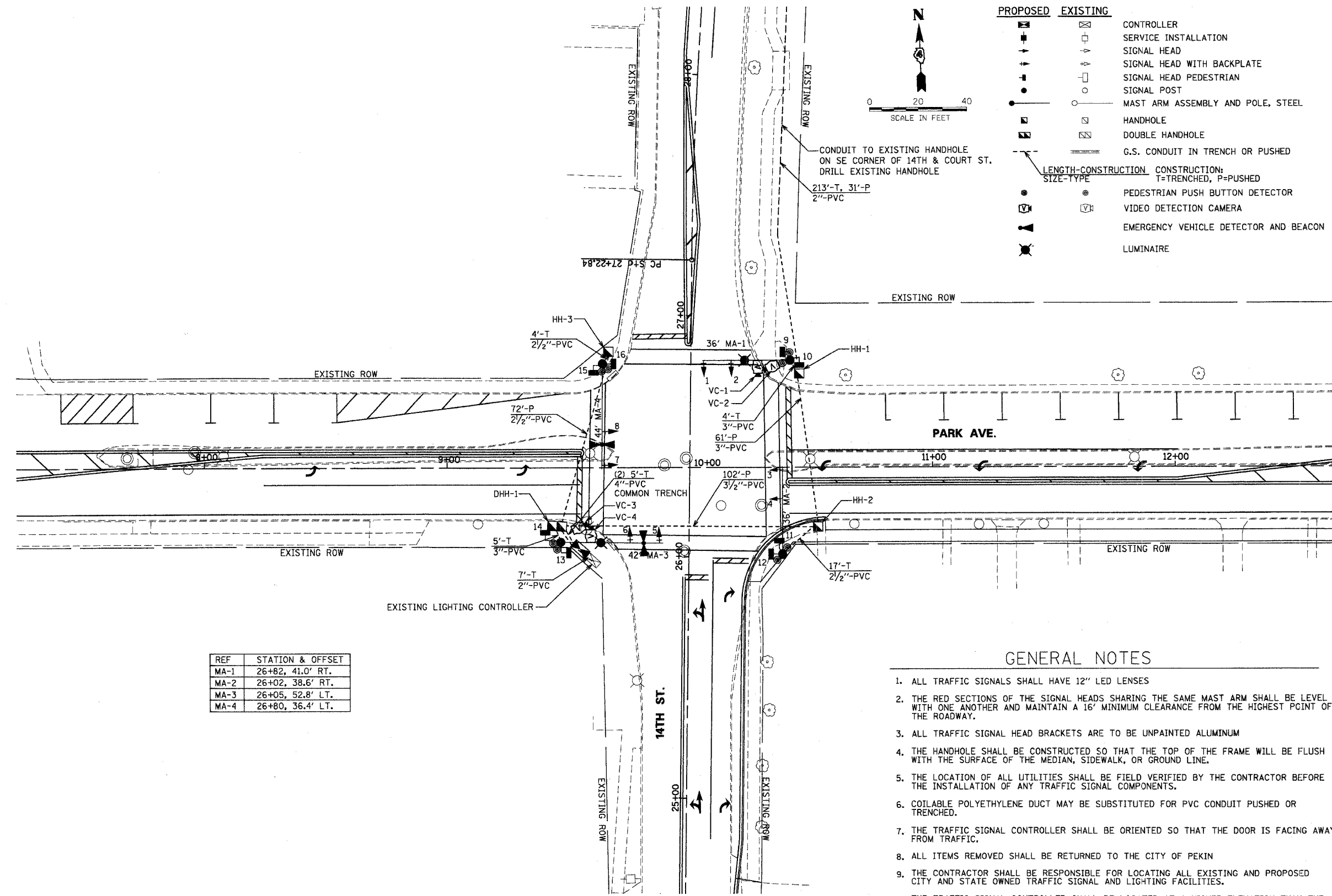
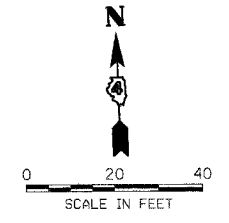

REVISIONS

NUMBER	BY	DATE

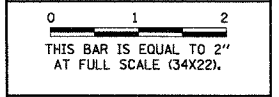

CITY OF PEKIN, IL
INTERSECTION RECONSTRUCTION
14TH ST. & PARK AVE.

TRAFFIC SIGNAL PLAN

REF	STATION & OFFSET
MA-1	26+82, 41.0' RT.
MA-2	26+02, 38.6' RT.
MA-3	26+05, 52.8' LT.
MA-4	26+80, 36.4' LT.

GENERAL NOTES

- ALL TRAFFIC SIGNALS SHALL HAVE 12" LED LENSES
- THE RED SECTIONS OF THE SIGNAL HEADS SHARING THE SAME MAST ARM SHALL BE LEVEL WITH ONE ANOTHER AND MAINTAIN A 16' MINIMUM CLEARANCE FROM THE HIGHEST POINT OF THE ROADWAY.
- ALL TRAFFIC SIGNAL HEAD BRACKETS ARE TO BE UNPAINTED ALUMINUM
- THE HANDHOLE SHALL BE CONSTRUCTED SO THAT THE TOP OF THE FRAME WILL BE FLUSH WITH THE SURFACE OF THE MEDIAN, SIDEWALK, OR GROUND LINE.
- THE LOCATION OF ALL UTILITIES SHALL BE FIELD VERIFIED BY THE CONTRACTOR BEFORE THE INSTALLATION OF ANY TRAFFIC SIGNAL COMPONENTS.
- COILABLE POLYETHYLENE DUCT MAY BE SUBSTITUTED FOR PVC CONDUIT PUSHED OR TRENCHED.
- THE TRAFFIC SIGNAL CONTROLLER SHALL BE ORIENTED SO THAT THE DOOR IS FACING AWAY FROM TRAFFIC.
- ALL ITEMS REMOVED SHALL BE RETURNED TO THE CITY OF PEKIN
- THE CONTRACTOR SHALL BE RESPONSIBLE FOR LOCATING ALL EXISTING AND PROPOSED CITY AND STATE OWNED TRAFFIC SIGNAL AND LIGHTING FACILITIES.
- THE TRAFFIC SIGNAL CONTROLLER SHALL BE LOCATED AT A HIGHER ELEVATION THAN THE HANDHOLE TO PREVENT WATER INTRUSION.
- ALL TRAFFIC SIGNAL HARDWARE SHALL BE GROUNDED IN ACCORDANCE WITH NEC REQUIREMENTS (MAST ARMS, HANDHOLE LIDS AND RINGS, TRAFFIC SIGNAL POSTS).

© Copyright CMT, Inc.

CMT
CRAWFORD, MURPHY & TILLY, INC.
CONSULTING ENGINEERS
License No. 084-000613

DESIGN BY:	R.M.M.
DRAWN BY:	R.S.S.
CHECKED BY:	E.J.H.
APPROVED BY:	
DATE:	10/12/05
JOB No:	05069-02-00

SHEET 15 OF 17 SHEET

F.A. RTE. 6708
SECTION 03-0010-00-TL
COUNTY: TAZEWELL
CONTRACT NO. 89353
CAT NO. 032923-00

REVISIONS		
NUMBER	BY	DATE

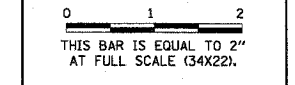

**CITY OF PEKIN, IL
INTERSECTION RECONSTRUCTION
14TH ST. & PARK AVE.
TRAFFIC SIGNAL CABLE PLAN**

©Copyright CMT, Inc.
CMT
CRAWFORD, MURPHY & TILLY, INC.
CONSULTING ENGINEERS
License No. 184-000613

DESIGN BY:	R.M.M.
DRAWN BY:	R.D.S.
CHECKED BY:	E.J.H.
APPROVED BY:	
DATE:	10/12/05
JOB No:	05069-02-00
SHEET 16 OF 17 SHEET	

LEGEND

- (S) SERVICE CABLE (#6 1/C x 3)
- (V) VIDEO CABLE (#14 3/C AND COAXIAL CABLE)
- (E) EMERGENCY VEHICLE DETECTOR CABLE (1 #14 3/C, SIGNAL & 1 NO. 20 3C)
- (L) LIGHTING CABLE (#6 1/C x 3)
- (I) INTERCONNECT CABLE (LEAD IN, NO. 18, 3 PAIR)
- PEDESTRIAN PUSHBUTTON DETECTOR
- TRAFFIC SIGNAL HEAD WITH BACKPLATE
- PEDESTRIAN SIGNAL HEAD
- LUMINAIRE
- VIDEO DETECTION CAMERA
- EMERGENCY VEHICLE DETECTOR WITH BEACON
- GROUND (#6 1/C CABLE)

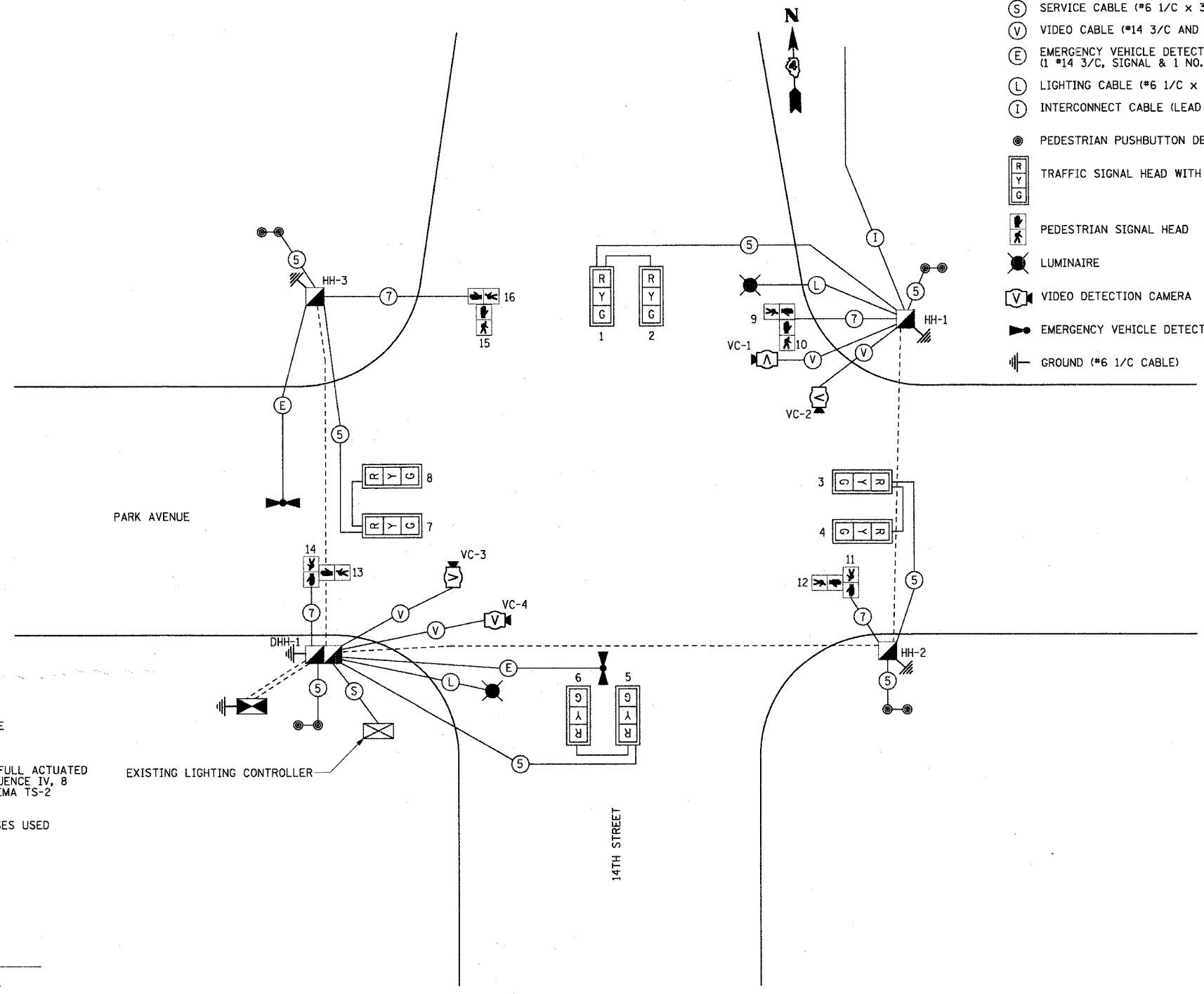

NAME OF INTERSECTION: 14TH STREET & PARK AVENUE
PEKIN, IL

CONTROLLER SPECIFIED: EAGLE EPAC 3608M42 TS-2 FULL ACTUATED
CONTROLLER, STANDARD SEQUENCE IV, 8
PHASE, TYPE IV CABINET, NEMA TS-2
16 POSITION LOAD BAY

REFERRING TO STANDARD 857001, THE VEHICULAR PHASES USED
ARE DESIGNATED BELOW.

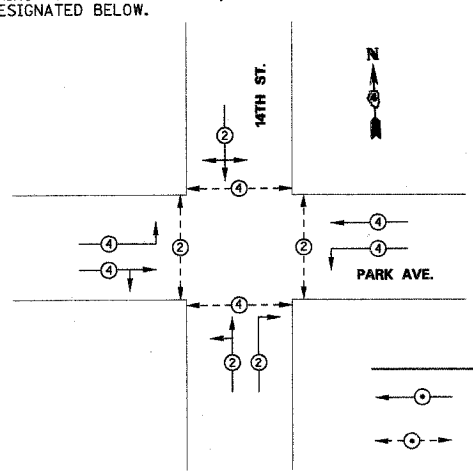

- LEGEND**
- VEHICLE PHASE
 - PEDESTRIAN PHASE

PHASE DESIGNATION DIAGRAM

CABLE PLAN

F.A. RTE. 6708
SECTION 05-0070-00-TL
COUNTY: TAZEWELL
CONTRACT NO. 89353
CAT NO. 032923-00

REVISIONS		
NUMBER	BY	DATE

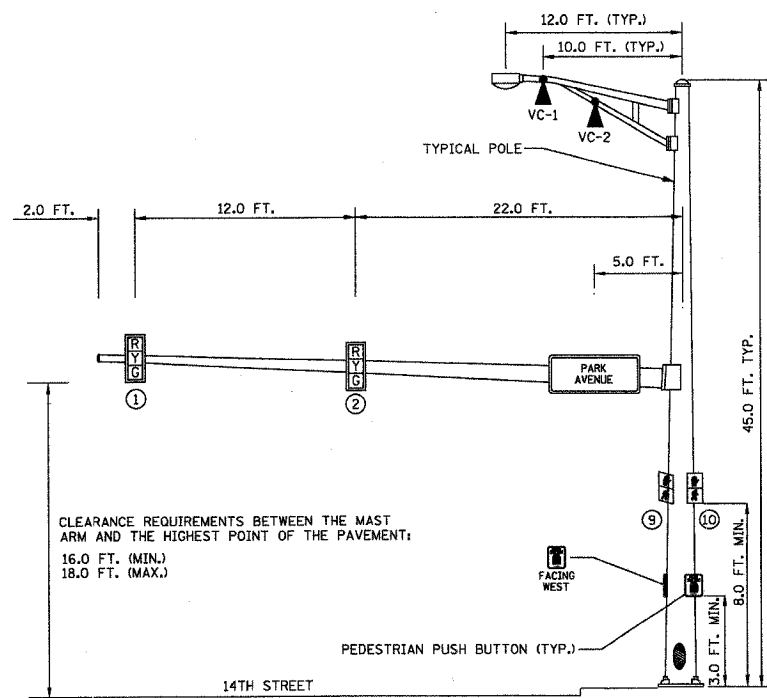
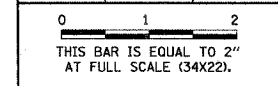

NORTHBOUND TRAFFIC SIGNAL
NORTHEAST CORNER OF 14TH ST. & PARK AVE.

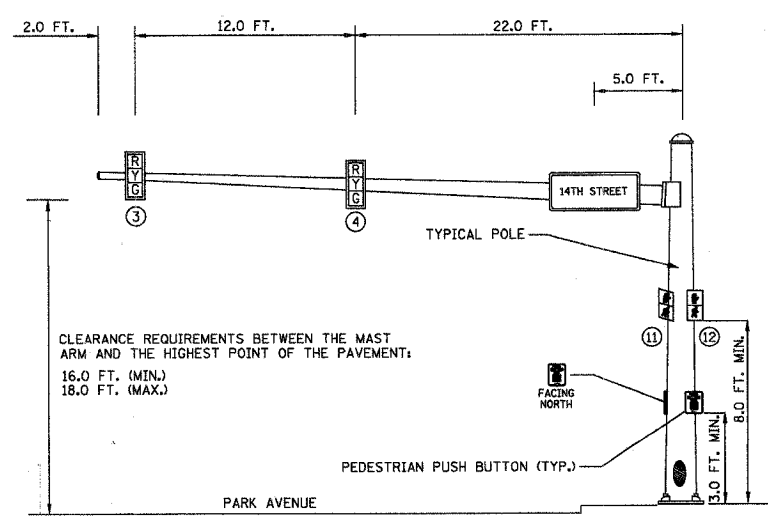

EASTBOUND TRAFFIC SIGNAL
SOUTHEAST CORNER OF 14TH ST. & PARK AVE.

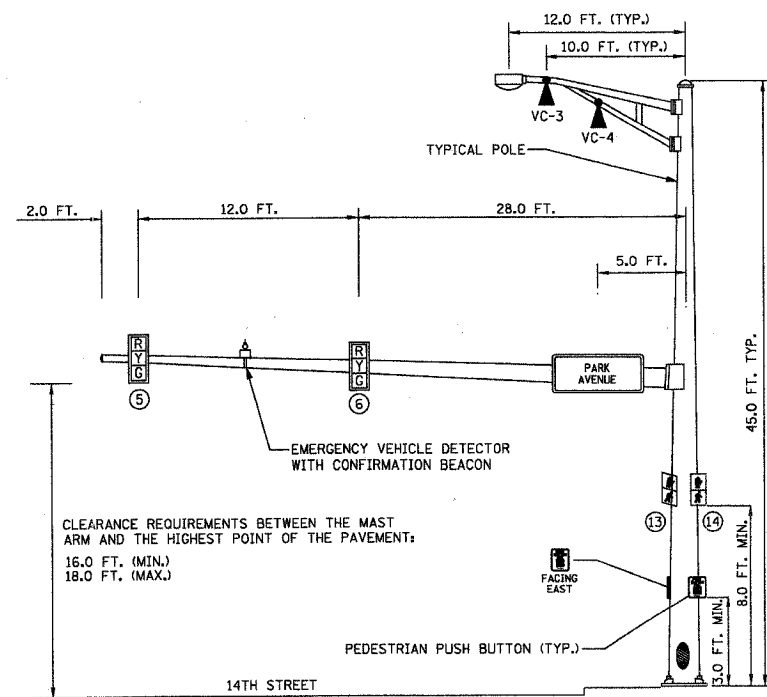

SOUTHBOUND TRAFFIC SIGNAL
SOUTHWEST CORNER OF 14TH ST. & PARK AVE.

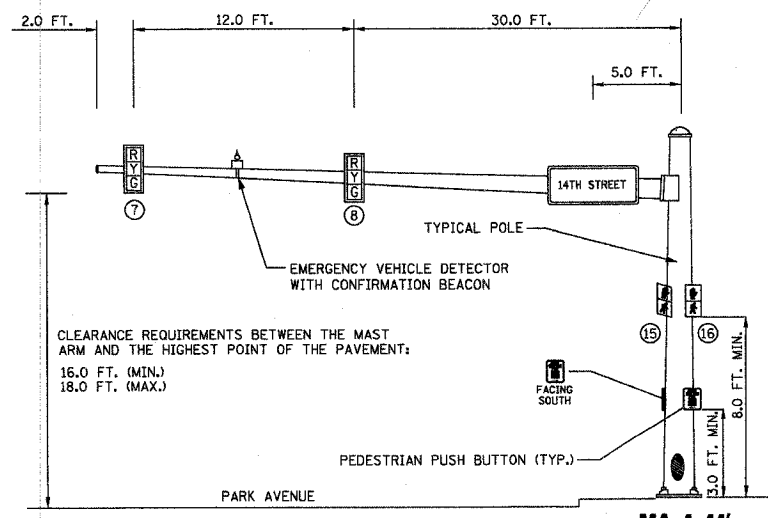

WESTBOUND TRAFFIC SIGNAL
NORTHWEST CORNER OF 14TH ST. & PARK AVE.

SUMMARY OF QUANTITIES

ITEM	UNIT	QUANTITY
CONDUIT IN TRENCH, 2" DIA., PVC	FOOT	220
CONDUIT IN TRENCH, 2 1/2" DIA., PVC	FOOT	21
CONDUIT IN TRENCH, 3" DIA., PVC	FOOT	9
CONDUIT IN TRENCH, 4" DIA., PVC	FOOT	10
CONDUIT PUSHED, 2" DIA., PVC	FOOT	31
CONDUIT PUSHED, 2 1/2" DIA., PVC	FOOT	72
CONDUIT PUSHED, 3" DIA., PVC	FOOT	61
CONDUIT PUSHED, 3 1/2" DIA., PVC	FOOT	102
CONCRETE HANDHOLE	EACH	3
CONCRETE DOUBLE HANDHOLE	EACH	1
TRENCH AND BACKFILL FOR ELECTRICAL WORK	FOOT	255
ELECTRIC CABLE IN CONDUIT, 600V (XLP-USE) 1/C NO. 6	FOOT	843.5
LUMINAIRE, SODIUM VAPOR, HORIZONTAL MOUNT, 400 WATT	EACH	2
REMOVAL OF EXISTING LIGHTING UNIT, SALVAGE	EACH	7
FULL-ACTUATED CONTROLLER AND TYPE IV CABINET, SPECIAL	EACH	1
TRANSCEIVER	EACH	1
ELECTRIC CABLE IN CONDUIT, SIGNAL, NO. 14 3C	FOOT	249.5
ELECTRIC CABLE IN CONDUIT, SIGNAL, NO. 14 5C	FOOT	1288
ELECTRIC CABLE IN CONDUIT, SIGNAL, NO. 14 7C	FOOT	541
ELECTRIC CABLE IN CONDUIT, LEAD-IN, NO. 18 3 PAIR	FOOT	555
STEEL MAST ARM ASSEMBLY AND POLE, 36 FT.	EACH	1
STEEL MAST ARM ASSEMBLY AND POLE, 44 FT.	EACH	1
STEEL COMBINATION MAST ARM ASSEMBLY AND POLE 36 FT.	EACH	1
STEEL COMBINATION MAST ARM ASSEMBLY AND POLE 42 FT.	EACH	1
CONCRETE FOUNDATION, TYPE D	FOOT	3.5
CONCRETE FOUNDATION, TYPE E 36-INCH DIAMETER	FOOT	48
DRILL EXISTING HANDHOLE	EACH	1
TRAFFIC SIGNAL BACKPLATE, LOUVERED, PLASTIC	EACH	8
LIGHT DETECTOR	EACH	2
LIGHT DETECTOR AMPLIFIER	EACH	1
PEDESTRIAN PUSH-BUTTON	EACH	8
VIDEO VEHICLE DETECTION, 4 CAMERAS	EACH	1
SIGNAL HEAD, LED, 1-FACE, 3-SECTION, MAST-ARM MOUNTED	EACH	8
PEDESTRIAN SIGNAL HEAD, LED, 2-FACE, BRACKET MOUNTED	EACH	4
ELECTRIC CABLE IN CONDUIT, COMMUNICATION, NO. 20 3/C	FOOT	249.5
30 AMP, 1 POLE CIRCUIT BREAKER	EACH	1

CITY OF PEKIN, IL
INTERSECTION RECONSTRUCTION
14TH ST. & PARK AVE.
MAST ARM DETAILS &
SCHEDULE OF QUANTITIES

© 2007/08/09 CMT, Inc.
CMT
 CRAWFORD, MURPHY & TILLY, INC.
 CONSULTING ENGINEERS
 License No. 184-00065

DESIGN BY:	R.M.M.
DRAWN BY:	R.D.S.L.
CHECKED BY:	E.J.H.
APPROVED BY:	
DATE:	10/12/05
JOB No:	05069-02-00