

ROUTE NO. C.H. 18	SECTION x	COUNTY COLES	TOTAL SHEETS 229	SHEET NO. 121
FEE. ROAD DIST. NO. 7		ILLINOIS	FEED. AND PROJECT	

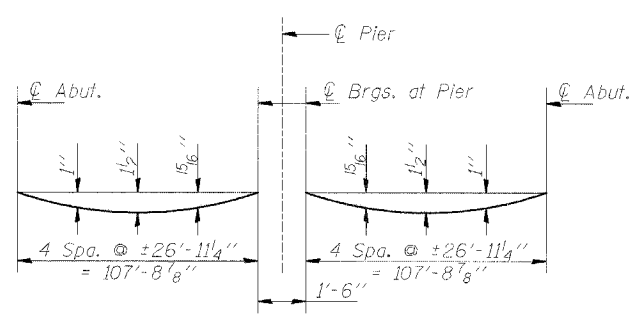

DEAD LOAD DEFLECTION DIAGRAM
(Includes weight of concrete, excluding beams).

Note: The above deflections are not to be used in the field if the engineer is working from the grade elevations adjusted for dead load deflections as shown on sheets 4 & 5 of 17.

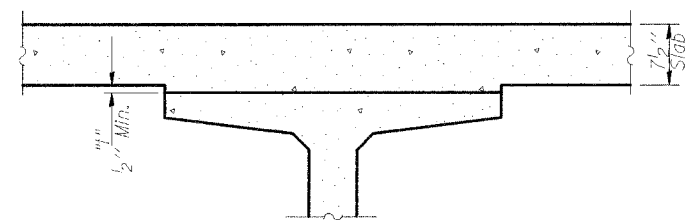

To determine "t": After all precast prestressed beams have been erected, elevations of the top flanges of the beams shall be taken at intervals on the diagrammatic plan. These elevations subtracted from the "Theoretical Grade Elevations Adjusted for Dead Load Deflections" minus slab thickness, equals the fillet heights "t" above top flanges of beams.

FILLET HEIGHTS

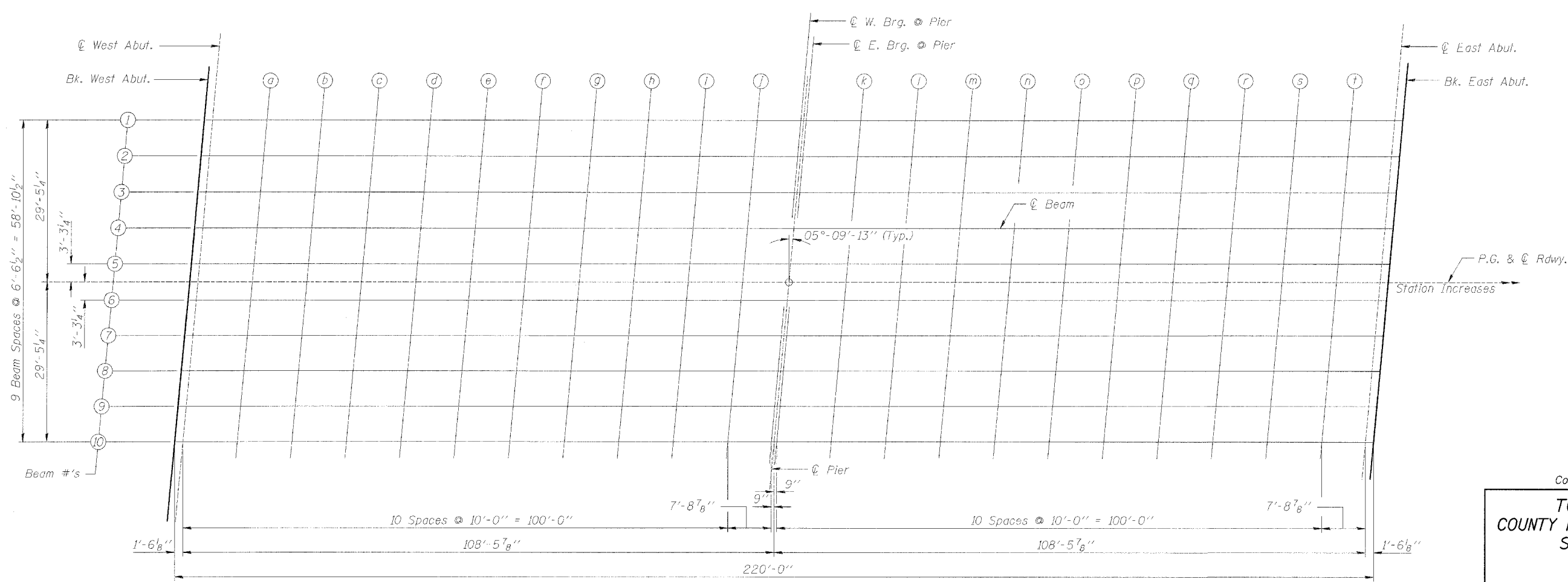

DIAGRAMMATIC PLAN

Corporate License Number 184-001-084
TOP OF SLAB ELEVATIONS
 COUNTY HIGHWAY 18 OVER F.A.I. RTE. 57
 SECTION 99-00124-02-PV
 COLES COUNTY
 STATION 249+25.29
 STRUCTURE NUMBER 015-0073

© Copyright Hanson Professional Services Inc. 2005
HANSON
 97S2028B
 05/27/03

AS97-005597-202028B-Struct-57_BridgeCulv-1.dgn
 9/7/2005

LAYOUT	MJM	03/24/03
DRAWN	DAF	03/25/03
REVIEWED	JWM	05/12/03