

STATE OF ILLINOIS  
DEPARTMENT OF TRANSPORTATION

ROUTE NO.	SECTION	COUNTY	SHEET NO.	SHEET	SHEET NO. 5
FAP 855	IIB-1	WHITE	25	15	8 SHEETS
FED. ROAD DIST. NO. 7	ILLINOIS	FED. AID PROJECT-			

Contract #94771

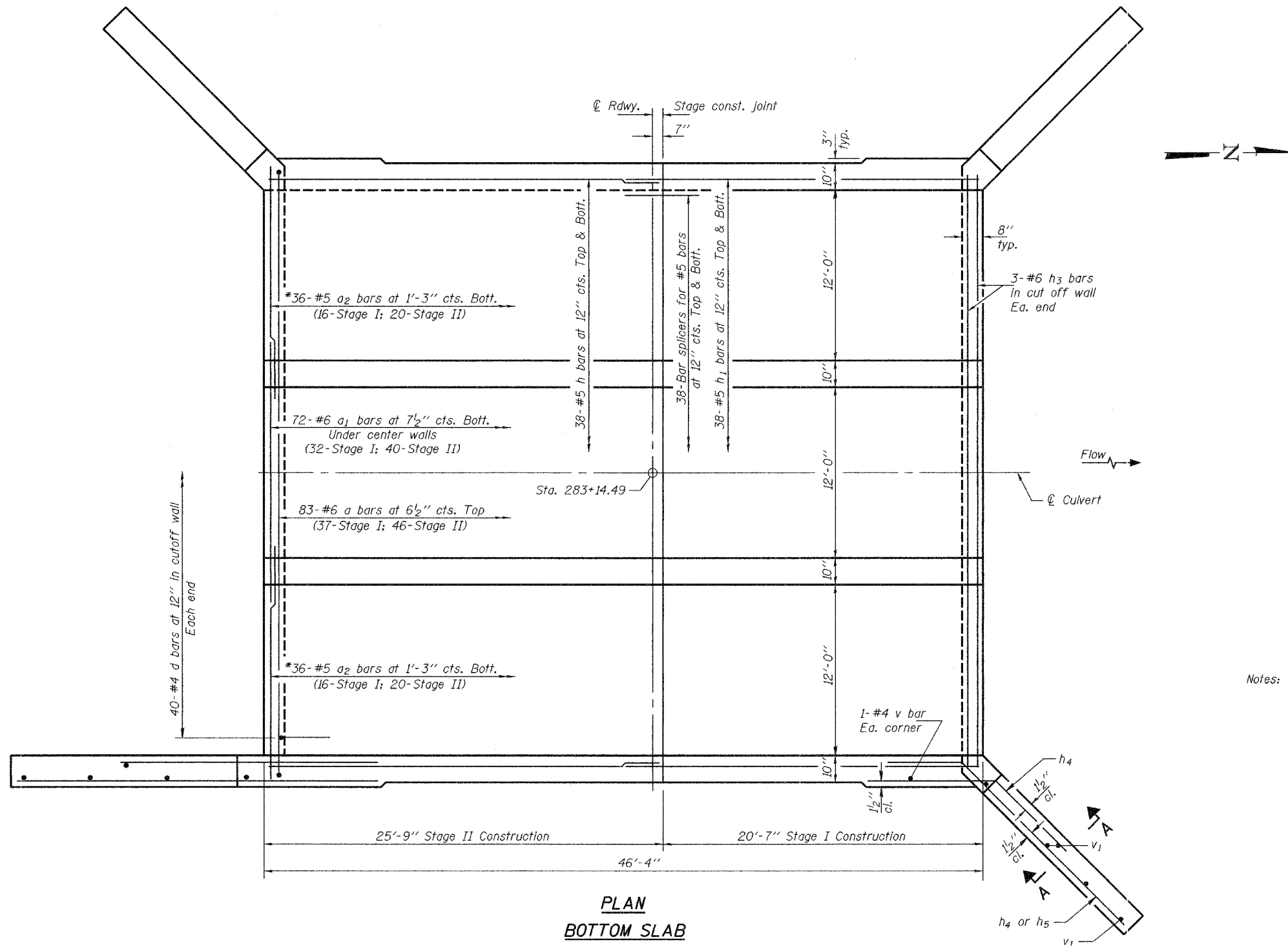

**PLAN**  
**BOTTOM SLAB**

\* Lap a<sub>2</sub> bars with alternate a<sub>1</sub> bars.

Notes: For Section A-A, see sheet 6 of 8.  
A distance of half the length of the wingwall but not less than six feet of the barrel shall be poured monolithically with the wingwalls.

DESIGNED	PMP
CHECKED	PRL
DRAWN	h.t. duong
CHECKED	PMP/PRL

November 16 2005  
EXAMINED *Thomas J. Damagala*  
PASSED *Ralph E. Anderson*  
ENGINEER OF BRIDGE DESIGN  
ENGINEER OF BRIDGES AND STRUCTURES

**CULVERT DETAILS**  
**F.A.P. RT. 855 SECTION IIB-1**  
**WHITE COUNTY**  
**STATION 283+14.49**  
**STRUCTURE NO. 097-2013**