

INDEX OF SHEETS

SHEET NO.	ITEM
1	COVER SHEET WITH LOCATION MAP INDEX OF SHEETS & STANDARD NUMBERS.
2	SUMMARY OF QUANTITIES & GENERAL NOTES.
3 & 4	ROADWAY TYPICAL SECTIONS & DETAILS
5 - 7	PLAN SHEETS

STANDARDS

- 442201-01
- 701301-02
- 701311-02
- 701501-03
- 702001-05
- 78CCC1-01

STATE OF ILLINOIS
DEPARTMENT OF TRANSPORTATION

PLANS FOR PROPOSED
FEDERAL AID HIGHWAY

F.A.U. 9164
(STATE STREET)
SECTION 05-00042-01-RS
PROJECT M-5011(191)
CITY OF O'FALLON, ILLINOIS
ST. CLAIR COUNTY
C-98-300-06

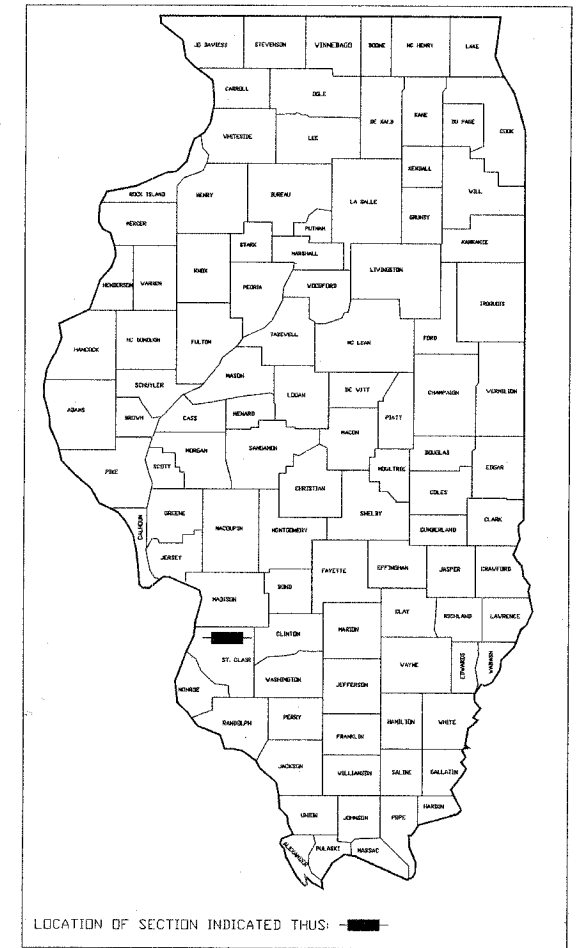

CONTRACT NO. 97258
Total Sheets 7
Sheet No. 1

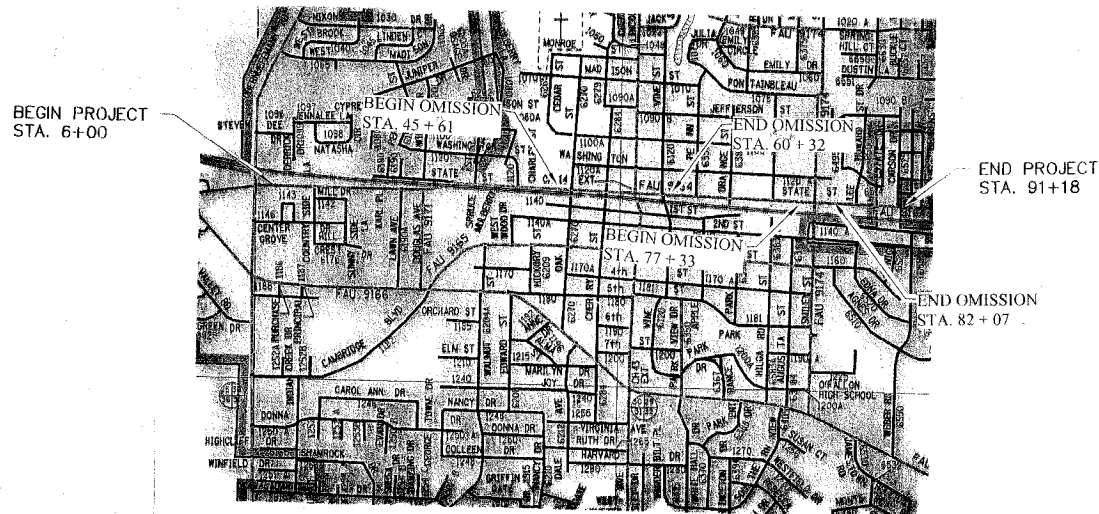

SCALE: N.T.S.

GROSS LENGTH OF PROJECT = 1.613 MILES
OMISSION LENGTH OF PROJECT = .368 MILES
NET LENGTH OF PROJECT = 1.245 MILES

FULL SIZE PLANS HAVE BEEN PREPARED USING STANDARD ENGINEERING SCALES. REDUCED SIZED PLANS WILL NOT CONFORM TO STANDARD SCALES.

JOINT UTILITY LOCATING INFORMATION FOR EXCAVATIONS PHONE: 800-892-0123

ROADWAY CLASSIFICATION = MINOR ARTERIAL
DESIGN SPEED = 40 mph
CURRENT TRAFFIC (2005) = 11,800
DESIGN YEAR (2025) = 17,320

EXPIRES 11/30/07

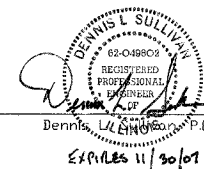

DATE: 11/17/05

APPROVED 11-17-2005
Amy L. Arshan
MAYOR OF O'FALLON

STATE OF ILLINOIS
DEPARTMENT OF TRANSPORTATION

PASSED 11-21-2005
Deanne Obermeyer
DISTRICT ENGINEER OF LOCAL ROADS AND STREETS

APPROVED 11-21-2005
Mary C. Lemme
DEPUTY DIRECTOR OF HIGHWAYS
REGION FIVE ENGINEER



F.A. RTE.	SECTION	COUNTY	TOTAL SHEETS	SHEET NO.
9164	05-00042-01-RS	ST. CLAIR	7	2
FED. ROAD DIST. NO.		ILLINOIS	FED. AID PROJECT	
CONTRACT NO. 97258				

GENERAL NOTES

- THE STANDARDS IN THE INDEX OF SHEETS SHALL APPLY TO THIS PROJECT.
- THE THICKNESS OF BITUMINOUS CONCRETE SHOWN ON THE PLANS IS THE NOMINAL THICKNESS.
- NO OVERNIGHT LANE CLOSURES WILL BE ALLOWED.
- EXISTING UNDERGROUND AND ABOVE-GRADE FACILITIES, STRUCTURES, AND UTILITIES HAVE BEEN PLOTTED ON THESE CONTRACT DOCUMENTS BASED ON THE INFORMATION AND SURVEYS AVAILABLE AT THE TIME OF DRAWING PREPARATION. THE LOCATIONS OF THESE FEATURES MUST THEREFORE BE CONSIDERED APPROXIMATE ONLY. IN ADDITION, THERE MAY BE OTHER FACILITIES, STRUCTURES, AND UTILITIES WHICH DID NOT EXIST (OR THE EXISTANCE OF WHICH WAS NOT KNOWN) AT THE TIME OF DRAWING PREPARATION. IT IS THE SOLE RESPONSIBILITY OF THE CONTRACTOR(S) TO HAVE ALL EXISTING FACILITIES, STRUCTURES, AND UTILITIES LOCATED IN THE FIELD PRIOR TO ANY EXCAVATION OR CONSTRUCTION ACTIVITY; AND TO PROTECT ALL SUCH EXISTING FEATURES (EXCEPT THOSE SPECIFICALLY NOTED REMOVAL OR DEMOLITION) DURING CONSTRUCTION.
- WHERE SECTION OR SUB-SECTION MONUMENTS ARE ENCOUNTERED, THE ENGINEER SHALL BE NOTIFIED BEFORE SUCH MONUMENTS ARE REMOVED. THE CONTRACTOR SHALL PROTECT AND CAREFULLY PRESERVE ALL PROPERTY MARKS AND MONUMENTS UNTILL THE OWNER, AN AUTHORIZED SURVEYOR, OR AGENT HAS WITNESSED, OR OTHERWISE REFERENCED THEIR LOCATION.
- ALL WARNING SIGNS SHALL BE 48" x 48" FLUORESCENT ORANGE.
- BUTT JOINT MILLING SHALL BE PAID FOR AS BITUMINOUS SURFACE REMOVAL VARIABLE DEPTH.
- PLAN QUANTITIES FOR THE FOLLOWING ITEMS ARE CALCULATED USING THE FOLLOWING UNIT WEIGHTS:

BITUMINOUS MATERIALS (PRIME COAT)	0.0003129 TONS/SQ. YD.
AGGREGATE (PRIME COAT)	3 LB./SQ. YD.
LEVELING BINDER (MACHINE METHOD) SUPERPAVE N70	112 LB./SQ. YD./IN THICK
BITUMINOUS CONC. SURFACE COURSE, SUPERPAVE, MIX "D" N70	112 LB./SQ. YD./IN THICK
BITUMINOUS SHOULDERS SUPERPAVE	112 LB./SQ. YD./IN THICK

SUMMARY OF QUANTITIES

CODE	ITEM DESCRIPTION	UNIT	QUANTITY
40600200	BITUMINOUS MATERIALS (PRIME COAT)	TON	8.5
40600300	AGGREGATE (PRIME COAT)	TON	35
X4066770	LEVELING BINDER (MACHINE METHOD) SUPERPAVE N70	TON	966
X4066426	BITUMINOUS CONC. SURFACE COURSE, SUPERPAVE, MIX "D" N70	TON	2254
40600990	TEMPORARY RAMP	SQ YD	254
44000030	BITUMINOUS SURFACE REMOVAL (VARIABLE DEPTH)	SQ YD	6459
44201765	CLASS D PATCH, TYPE II, 10 INCH	SQ YD	80
44201769	CLASS D PATCH, TYPE III, 10 INCH	SQ YD	18
44201771	CLASS D PATCH, TYPE IV, 10 INCH	SQ YD	108
44300200	STRIP REFLECTIVE CRACK CONTROL TREATMENT	FOOT	11090
48101200	AGGREGATE SHOULDERS, TYPE B	TON	103
48202000	BITUMINOUS SHOULDERS SUPERPAVE	TON	603
60255500	MANHOLES TO BE ADJUSTED	EACH	8
67100100	MOBILIZATION	L SUM	1
70103700	TRAFFIC CONTROL COMPLETE	L SUM	1
70300100	SHORT TERM PAVEMENT MARKING - LINE 4"	FOOT	598
70301000	WORK ZONE PAVEMENT MARKING REMOVAL	SQ FT	199
* 78000100	THERMOPLASTIC PAVEMENT MARKING - LETTERS & SYMBOLS	SQ FT	183.6
* 78000200	THERMOPLASTIC PAVEMENT MARKING - LINE 4"	FOOT	12008
* 78000400	THERMOPLASTIC PAVEMENT MARKING - LINE 6"	FOOT	636
* 78000600	THERMOPLASTIC PAVEMENT MARKING - LINE 12"	FOOT	298
* 78000650	THERMOPLASTIC PAVEMENT MARKING - LINE 24"	FOOT	72
Z0048665	RAILROAD PROTECTIVE LIABILITY INSURANCE	L SUM	1

*SPECIALTY ITEMS

STRUCTURAL DESIGN INFORMATION

STRUCTURAL DESIGN TRAFFIC PV = 15,167 SU = 479	YEAR 2014 MU = 319
ROAD/STREET CLASSIFICATION: MINOR ARTERIAL	
PERCENT OF STRUCTURAL DESIGN TRAFFIC IN DESIGN LANE: P = 50 S = 50 M = 50	
DESIGN ESALS = 1.79	
Ndesign = 70	
Ndesign = 30 (SHOULDER SURFACE COURSE)	

CLASS D PATCHING SCHEDULE

PATCH NO.	APPROX. STATION	SIZE	TYPE II (S.Y.)	TYPE III (S.Y.)	TYPE IV (S.Y.)
1	7+44	15x26			43
2	12+48	4x26	12		
3	13+56	6x26		18	
4	16+80	4x26	12		
5	21+58	10x26			29
6	36+20	4x32	14		
7	43+87	2x32	7		
8	76+37	2x32	7		
9	68+97	4x32	14		
10	85+77	4x32	14		
11	90+58	10x32			36
TOTALS			80	18	108

PAVEMENT MARKING SCHEDULE

LOCATION		SOLID 4" WHITE EDGE-LINE LT.	SOLID 4" WHITE EDGE-LINE RT.	SKIP DASH 4" YELLOW	SOLID 4" YELLOW	STOP BAR 12" WHITE	CROSSWALK 6" WHITE	RAILROAD 24" WHITE	RAILROAD LETTERS & SYMBOLS
STATION	STATION	FOOT							S.F.
6+00	30+24	2424	2424	606					
6+00	12+50								
30+24	45+61	1537		384					
60+32	64+00	368	368	92					
64+00	77+33	1333		333					
82+07	91+18	911		228					
12+50	14+00					24			
22+00	32+00				1000			72	183.6
23+50	24+30					12			
26+30	29+00					48			
29+00	30+25					24			
33+25	34+50					22	78		
34+50	39+10								
39+10	40+13					22	72		
60+32	77+33					98	334		
82+07	91+18					48	152		
TOTALS		6573	2792	1643	1000	298	636	72	183.6

THE FOLLOWING MIXTURE REQUIREMENTS ARE APPLICABLE FOR THIS PROJECT:

MIXTURE USE	SURFACE	SURFACE (SHOULDER)	LEV. BINDER	PATCHING
AC/PG	PG64-22	PG58-22	PG64-22	PG64-22
RAP % (MAX)	10%	30%	15%	15%
DESIGN AIR VOIDS	4% @ Ndes = 70	2% @ Ndes = 30	4% @ Ndes = 70	4% @ Ndes = 70
MIX COMPOSITION (GRADATION MIXTURE)	IL 12.5/9.5		IL 9.5	IL 19.0
FRICITION AGG	MIXTURE D	BAM	MIXTURE C	BINDER

NOTES:

1. DUE TO DIFFERENCE BETWEEN BITUMINOUS SURFACE REMOVAL AND BITUMINOUS SURFACING, A 1/4" LIP WILL BE PROVIDED ABOVE THE GUTTER ELEVATION.
2. THE AVERAGE DEPTH OF EXISTING PAVEMENT IS 10" AND NO ADDITIONAL COMPENSATION WILL BE ALLOWED DUE TO VARIATIONS.
3. PROPOSED PAVEMENT CROSS SLOPE SHALL EQUAL EXISTING PAVEMENT CROSS SLOPES.

F.A. RTE.	SECTION	COUNTY	TOTAL SHEETS	SHEET NO.
9164	05-00042-01-RS	ST. CLAIR	7	3
CONTRACT NO. 97258				

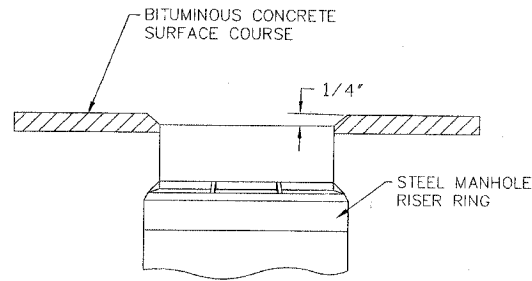

MANHOLE ADJUSTMENT
N.T.S.

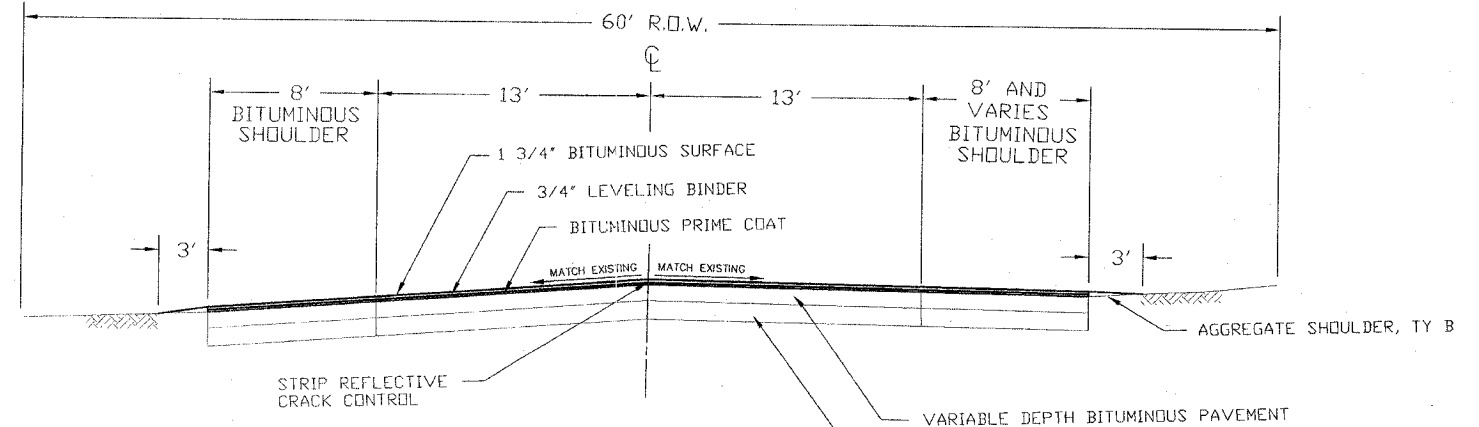

ROADWAY TYPICAL SECTION
N.T.S.
STA. 6+30 TO STA. 30+24

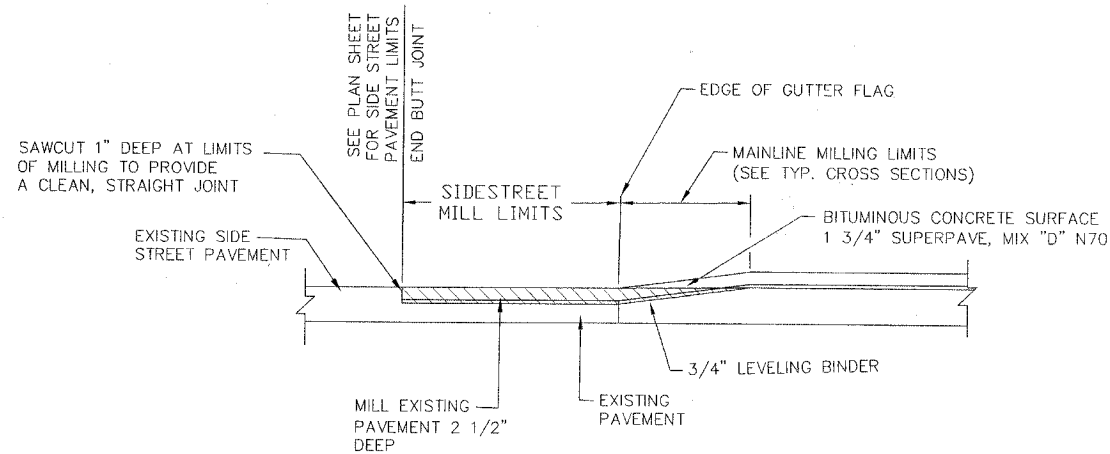

TYPICAL BUTT JOINT DETAIL
SIDE STREETS
STA. 28+94 TO 91+18
N.T.S.

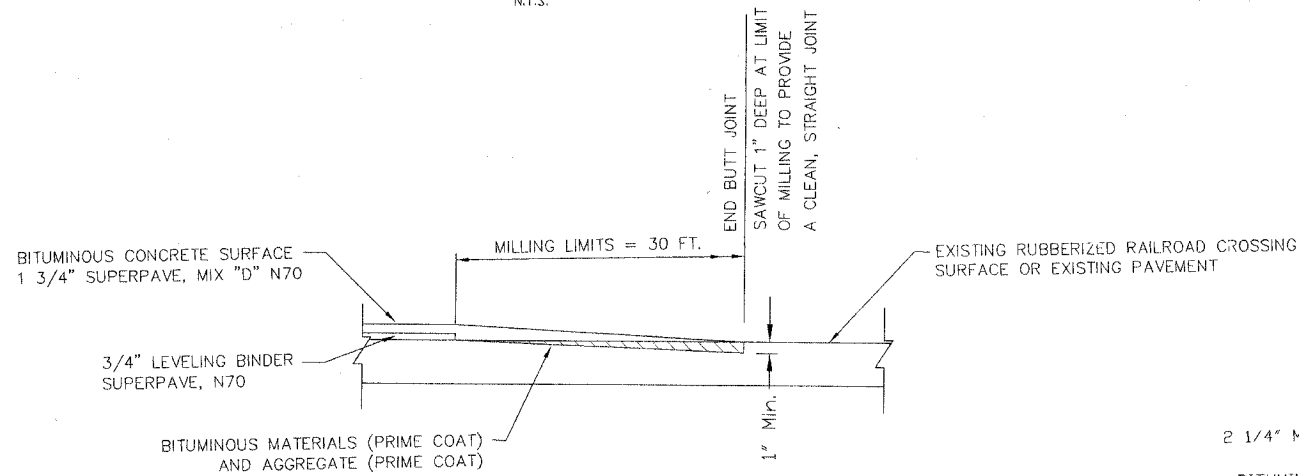

BUTT JOINT DETAIL FOR
SIDE STREETS STA. 6+00 TO 28+94 AND
RAILROAD CROSSING, MAINLINE PAVEMENT AT
THE FOLLOWING LOCATIONS:
N.T.S.

- | | |
|------------|------------|
| STA. 6+00 | STA. 60+32 |
| STA. 28+10 | STA. 77+33 |
| STA. 28+94 | STA. 82+07 |
| STA. 45+61 | STA. 91+18 |

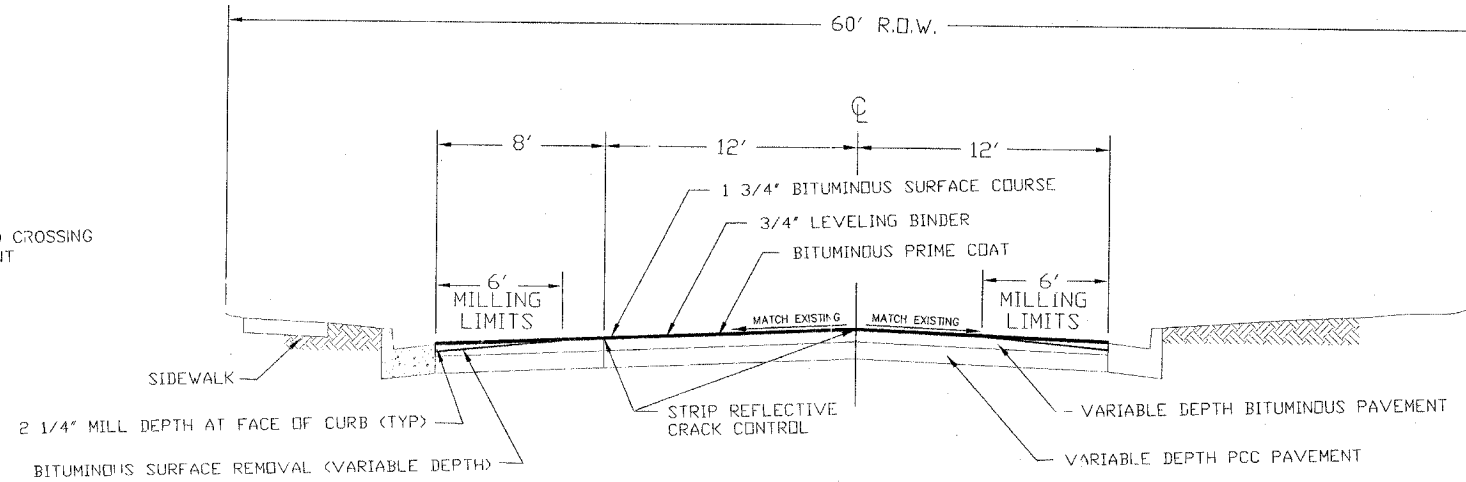

ROADWAY TYPICAL SECTION
N.T.S.
STA. 30+24 TO STA. 45+61
NOTE: STA. 45+61 TO 60+32
NOT IN CONTRACT.

F.A. R.T.E.	SECTION	COUNTY	TOTAL SHEETS	SHEET NO.
9164	05-00042-01-RS	ST. CLAIR	7	4
CONTRACT NO. 97258				

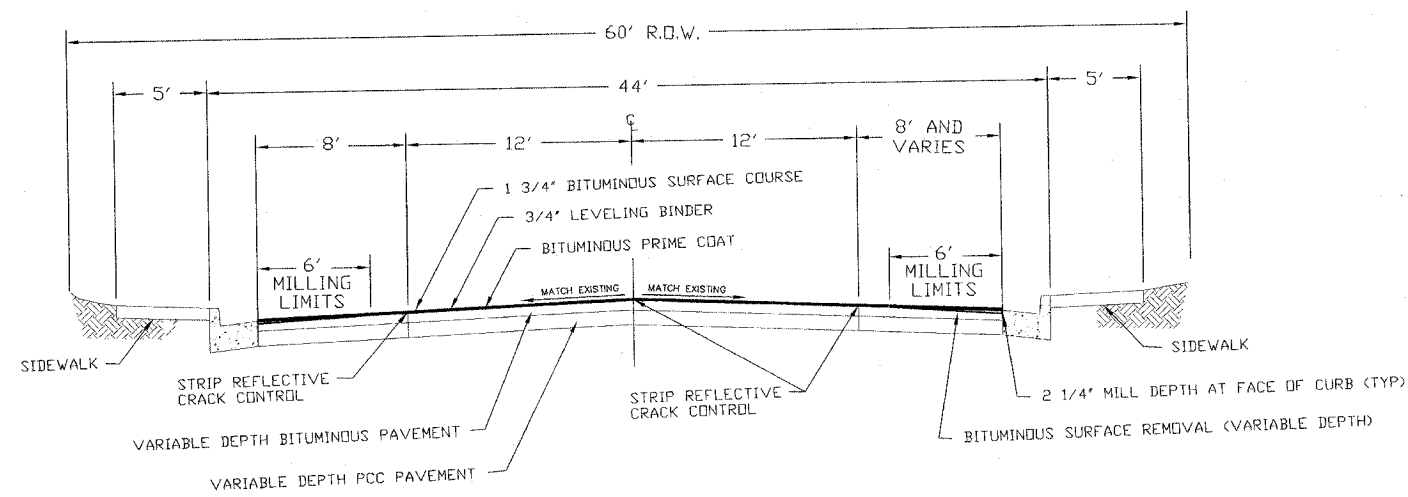

ROADWAY TYPICAL SECTION
N.T.S.
STA. 60+32 TO STA. 64+00

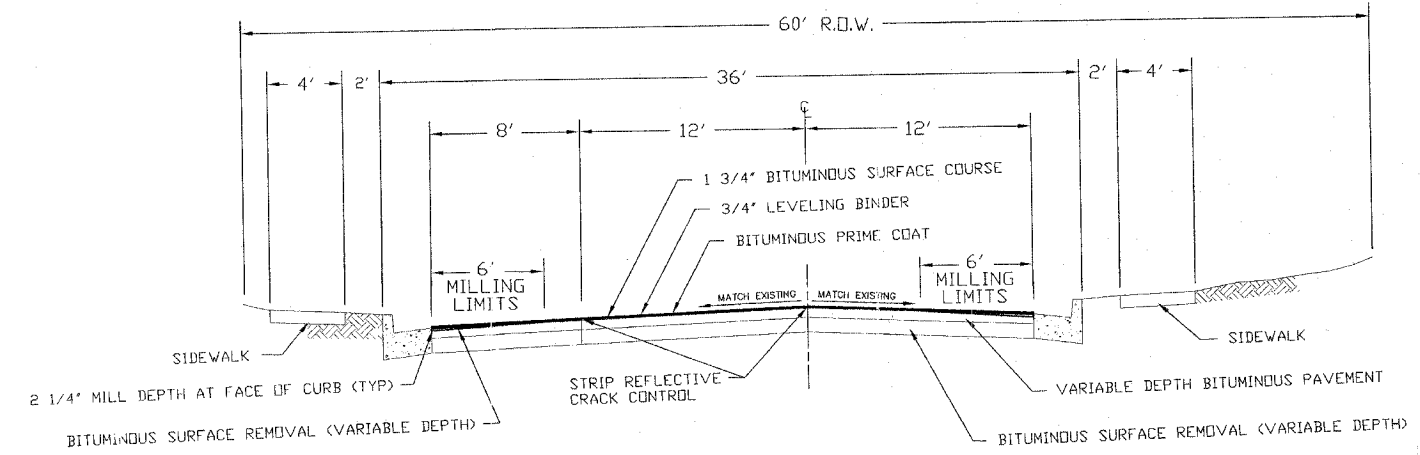

ROADWAY TYPICAL SECTION
N.T.S.
STA 82+07 TO STA. 91+18

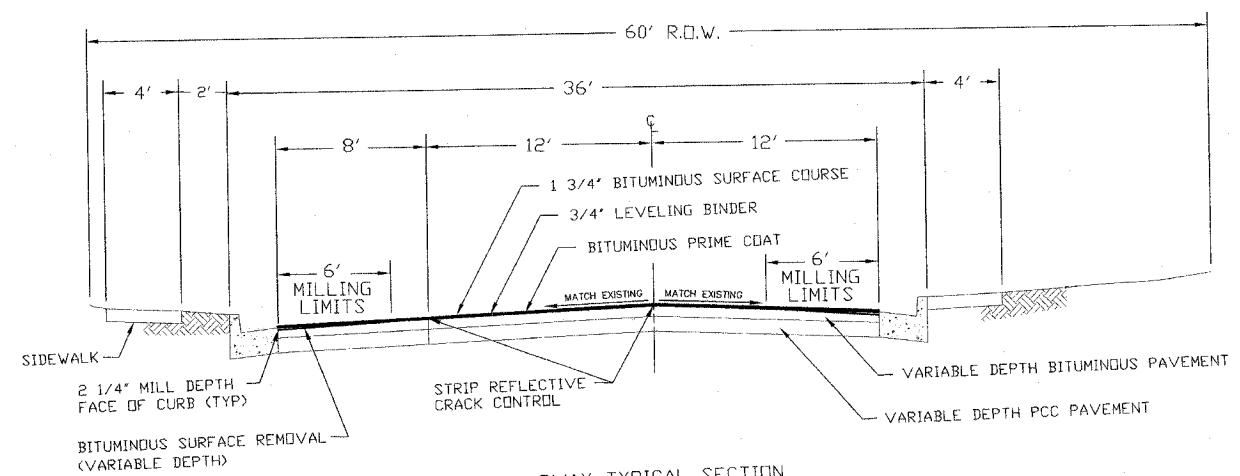

ROADWAY TYPICAL SECTION
N.T.S.
STA. 64+00 TO STA. 77+33
NOTE: STA. 77+33 TO 82+07
NOT IN CONTRACT

F.A. RT.	SECTION	COUNTY	TOTAL SHEETS	SHEET NO.
9164	05-00042-01-RS	ST. CLAIR	7	5
STA. 1+00 TO STA. 33+00				
CONTRACT NO. 97258				

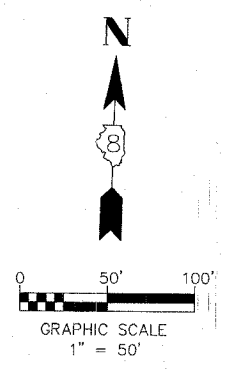
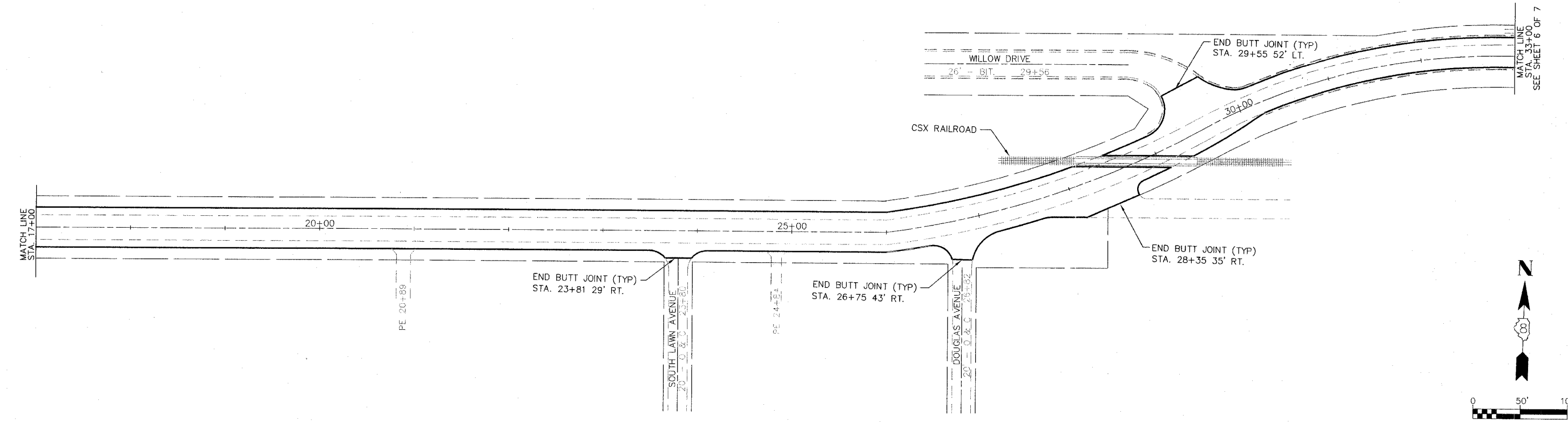
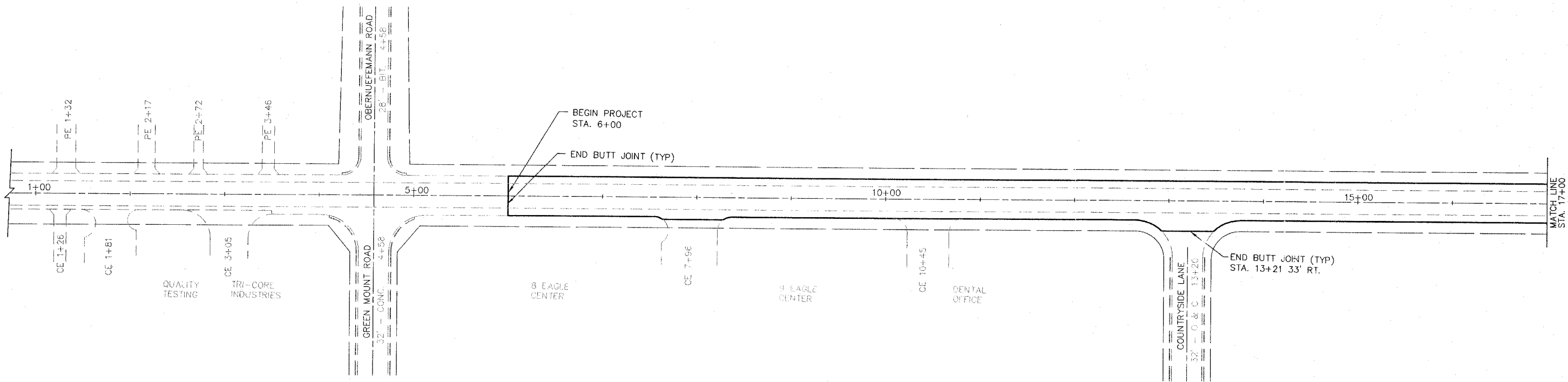

F.A. RTE.	SECTION	COUNTY	TOTAL SHEETS	SHEET NO.
9164	05-00042-01-RS	ST. CLAIR	7	6
STA. 33+00 TO STA. 65+00				
CONTRACT NO. 97258				

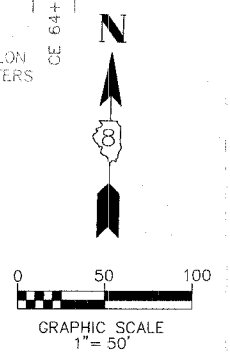
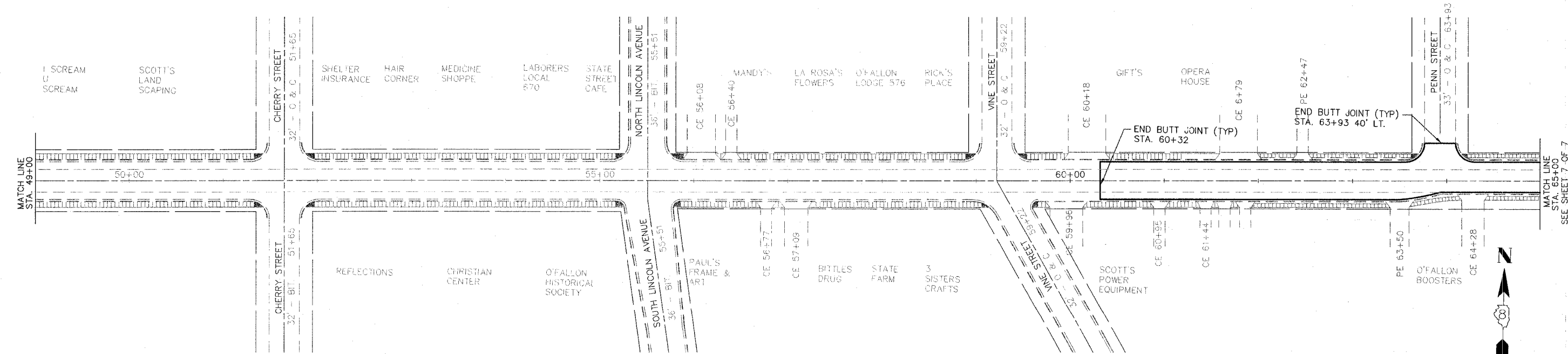
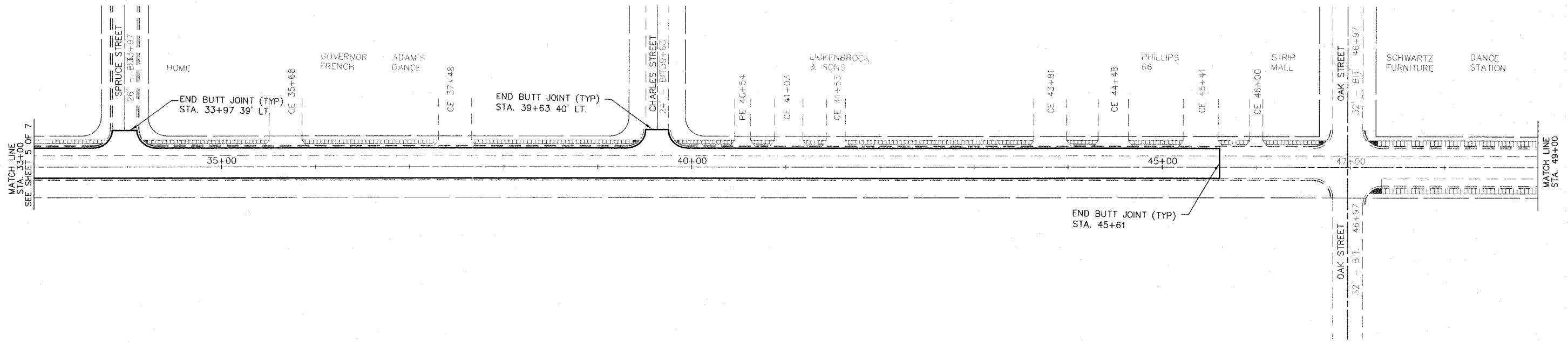

F.A. RIE.	SECTION	COUNTY	TOTAL SHEETS	SHEET NO.
9164	05-00042-01-RS	ST. CLAIR	7	7
STA. 65+00	TO STA. 91+18			
CONTRACT NO. 97258				

