

NOTE:

- SIGN WILL BE REMOVED AND RE-ERECTED AS PART OF ANOTHER CONTRACT.
- TEMPORARY FENCE PROTECTION SHALL BE USED ON TREES THAT MAY BE AFFECTED BY CONSTRUCTION ACTIVITIES.
- STREET PARKING WILL BE ELIMINATED.

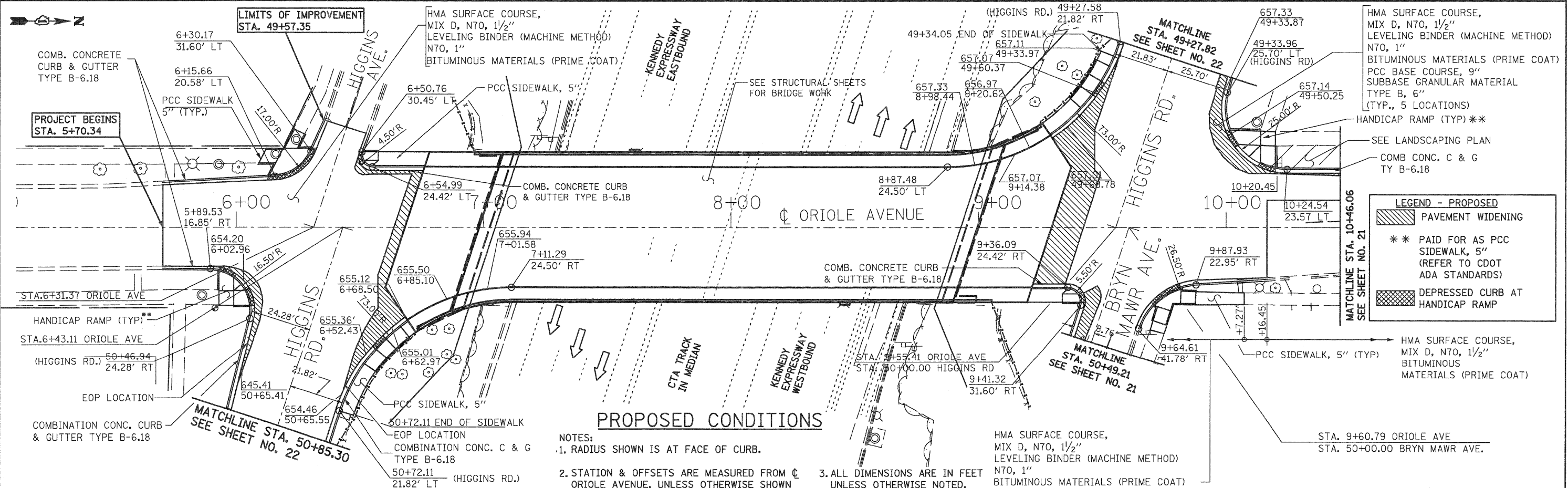

LEGEND - PROPOSED

- PAVEMENT WIDENING
- ** PAID FOR AS PCC SIDEWALK, 5" (REFER TO CDOT ADA STANDARDS)
- DEPRESSED CURB AT HANDICAP RAMP

NOTES:

- RADIUS SHOWN IS AT FACE OF CURB.
- STATION & OFFSETS ARE MEASURED FROM C ORIOLE AVENUE, UNLESS OTHERWISE SHOWN
- ALL DIMENSIONS ARE IN FEET UNLESS OTHERWISE NOTED.

ABNA
 9901 S. Western Ave.
 Chicago, IL 60643
 Ph. 773-881-4788
 9151.90.80DESIGN FIRM REG. 184.00211 F: 773.239.3728

DESIGNED	TS	REVISED	-
CHECKED	TPP	REVISED	-
DRAWN	JS	REVISED	-
CHECKED	TPP	REVISED	-

**STATE OF ILLINOIS
 DEPARTMENT OF TRANSPORTATION**

**ORIOLE AVENUE AT I-90
 STRUCTURE NO. 016-1101**

**ROADWAY PLAN ORIOLE AVE
 AT I-90**

SCALE: 1" = 20' SHEET NO. OF SHEETS STA. 5+70.34 TO STA. 10+46.06

F.A.I. RTE.	SECTION	COUNTY	TOTAL SHEETS	SHEET NO.
90	1515.1-B	COOK	101	20
CONTRACT NO. 60M79			ILLINOIS FED. AID PROJECT	