

H:\IDOT\2009-246 PTB 153 Item 2\016-1101\01ole_FinalEngineering\Plan Sheets\31-020cis0lv8.dgn 4:59:31 PM 11/3/2011

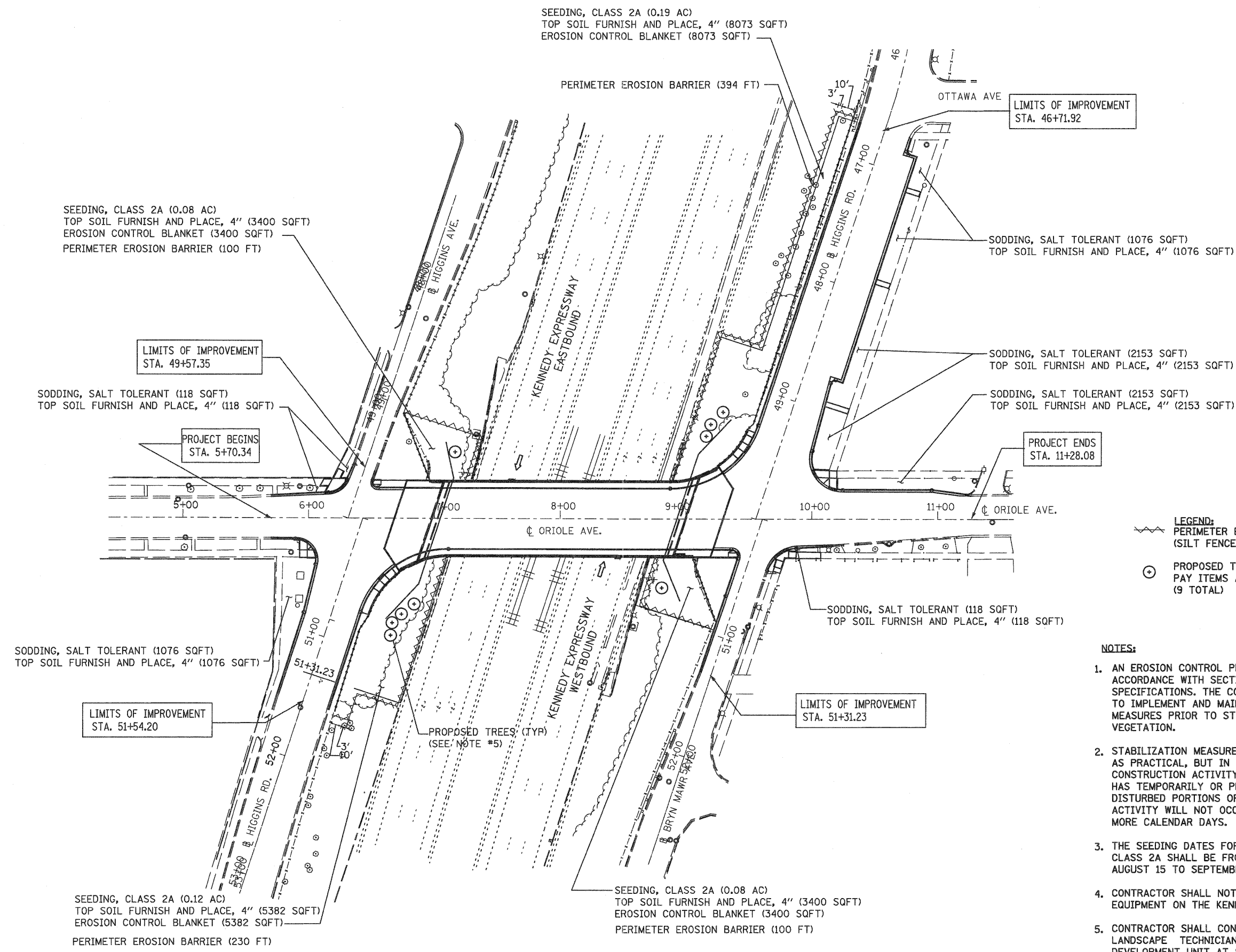

SEEDING, CLASS 2A (0.08 AC)
 TOP SOIL FURNISH AND PLACE, 4" (3400 SQFT)
 EROSION CONTROL BLANKET (3400 SQFT)
 PERIMETER EROSION BARRIER (100 FT)

SEEDING, CLASS 2A (0.19 AC)
 TOP SOIL FURNISH AND PLACE, 4" (8073 SQFT)
 EROSION CONTROL BLANKET (8073 SQFT)

SODDING, SALT TOLERANT (1076 SQFT)
 TOP SOIL FURNISH AND PLACE, 4" (1076 SQFT)

SODDING, SALT TOLERANT (2153 SQFT)
 TOP SOIL FURNISH AND PLACE, 4" (2153 SQFT)

SODDING, SALT TOLERANT (2153 SQFT)
 TOP SOIL FURNISH AND PLACE, 4" (2153 SQFT)

SODDING, SALT TOLERANT (118 SQFT)
 TOP SOIL FURNISH AND PLACE, 4" (118 SQFT)

SODDING, SALT TOLERANT (118 SQFT)
 TOP SOIL FURNISH AND PLACE, 4" (118 SQFT)

SODDING, SALT TOLERANT (1076 SQFT)
 TOP SOIL FURNISH AND PLACE, 4" (1076 SQFT)

SEEDING, CLASS 2A (0.08 AC)
 TOP SOIL FURNISH AND PLACE, 4" (3400 SQFT)
 EROSION CONTROL BLANKET (3400 SQFT)
 PERIMETER EROSION BARRIER (100 FT)

SEEDING, CLASS 2A (0.12 AC)
 TOP SOIL FURNISH AND PLACE, 4" (5382 SQFT)
 EROSION CONTROL BLANKET (5382 SQFT)
 PERIMETER EROSION BARRIER (230 FT)

LIMITS OF IMPROVEMENT
 STA. 46+71.92

LIMITS OF IMPROVEMENT
 STA. 49+57.35

PROJECT BEGINS
 STA. 5+70.34

PROJECT ENDS
 STA. 11+28.08

LIMITS OF IMPROVEMENT
 STA. 51+54.20

LIMITS OF IMPROVEMENT
 STA. 51+31.23

PROPOSED TREES (TYP)
 (SEE NOTE #5)

- LEGEND:**
- PERIMETER EROSION BARRIER (SILT FENCE, SEE STANDARD 280001-06)
 - ⊙ PROPOSED TREE
 PAY ITEMS A2002920, A2005032, AND A2008519 (9 TOTAL)

- NOTES:**
1. AN EROSION CONTROL PLAN SHALL BE PROPOSED IN ACCORDANCE WITH SECTION 280 OF THE STANDARD SPECIFICATIONS. THE CONTRACTOR WILL BE REQUIRED TO IMPLEMENT AND MAINTAIN EROSION CONTROL MEASURES PRIOR TO STRIPPING OF EXISTING VEGETATION.
 2. STABILIZATION MEASURES SHALL BE INITIATED AS SOON AS PRACTICAL, BUT IN NO CASE EXCEED 14 DAYS AFTER CONSTRUCTION ACTIVITY IN THAT PORTION OF THE SITE HAS TEMPORARILY OR PERMANENTLY CEASED ON ALL DISTURBED PORTIONS OF THE SITE WHERE CONSTRUCTION ACTIVITY WILL NOT OCCUR FOR A PERIOD OF 21 OR MORE CALENDAR DAYS.
 3. THE SEEDING DATES FOR BARE EARTH SEEDING OF MIXTURE CLASS 2A SHALL BE FROM APRIL 1 TO JUNE 1, AND FROM AUGUST 15 TO SEPTEMBER 30.
 4. CONTRACTOR SHALL NOT BE ALLOWED TO STORE MATERIALS OR EQUIPMENT ON THE KENNEDY EXPRESSWAY RIGHT-OF-WAY.
 5. CONTRACTOR SHALL CONTACT MELISSA DEL ROSARIO, LANDSCAPE TECHNICIAN AT THE IDOT ROADSIDE DEVELOPMENT UNIT AT 847-705-4391, 72 HOURS PRIOR TO PLANTING FOR LAYOUT OF TREES.



9901 S. Western Ave.
 Chicago, IL 60643
 Ph. 773-881-4788
 F: 773.239.3728

DESIGNED	TS	REVISED	-
CHECKED	TPP	REVISED	-
DRAWN	JS	REVISED	-
CHECKED	TPP	REVISED	-

**STATE OF ILLINOIS
 DEPARTMENT OF TRANSPORTATION**

**ORIOLE AVENUE AT I-90
 STRUCTURE NO. 016-1101**

**LANDSCAPING & EROSION CONTROL
 PLAN HIGGINS ROAD & ORIOLE AVE**

SCALE: 1" = 40' SHEET NO. X OF X SHEETS STA. TO STA.

F.A.I. RTE.	SECTION	COUNTY	TOTAL SHEETS	SHEET NO.
90	1515.1-B	COOK	101	31
CONTRACT NO. 60M79				
ILLINOIS FED. AID PROJECT				