

EXISTING CONDITIONS AND LIGHTING REMOVAL PLAN

NOTES:

1. REFER TO DWG. E-1 FOR NOTES, BILL OF MATERIALS AND SYMBOL LIST.
2. REFER TO DWG. E-2 FOR CONTINUATION OF STREET LIGHTING WIRING/CONDUIT ROUTING AND CONNECTIONS.
3. COORDINATE EXACT LOCATION OF EXISTING AND/OR RELOCATED LIGHTING STANDARDS WITH CIVIL DRAWINGS.
4. REFER TO DWG. E-12 FOR CITY OF CHICAGO EXISTING ELECTRICAL PLANS AND EDISON SERVICE ATLASES X-8 AND W-8 VERIFY AND COORDINATE ALL ELECTRICAL WORK FOR STREET LIGHTING, CONDUIT ROUTING AND CONNECTIONS WITH CITY OF CHICAGO (BUREAU OF ELECTRICITY), PRIOR TO ANY DISCONNECTING, REMOVAL, RELOCATION AND INSTALLATION WORK.
5. COORDINATE ALL ELECTRICAL WORK FOR NEW ELECTRICAL SERVICE, INSTALLATION AND CONNECTION WITH COMED.

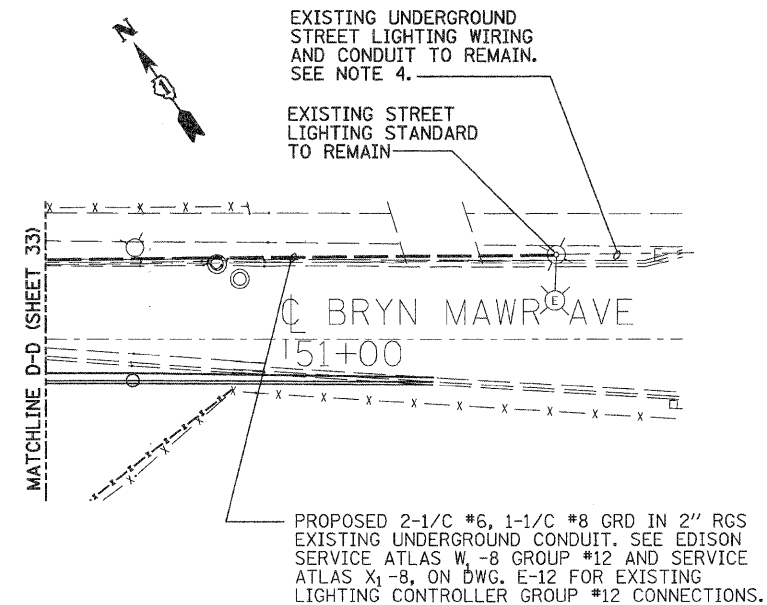
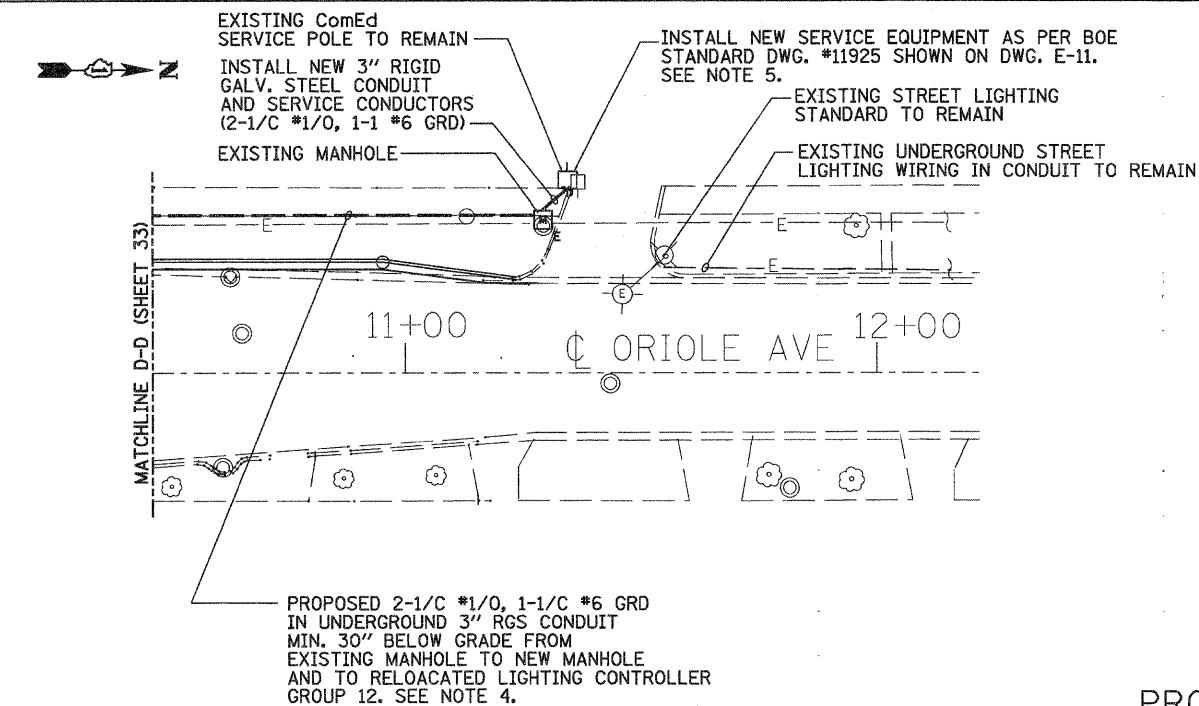

PROPOSED LIGHTING PLAN



9901 S. Western Ave.
Chicago, IL 60643
Ph. 773-881-4788
F: 773.239.3728

DESIGNED	TS	REVISED	-
CHECKED	TPP	REVISED	-
DRAWN	JS	REVISED	-
CHECKED	TPP	REVISED	-

**STATE OF ILLINOIS
DEPARTMENT OF TRANSPORTATION**

**ORIOLE AVENUE AT I-90
STRUCTURE NO. 016-1101**

**EXISTING CONDITIONS, REMOVAL
AND PROPOSED LIGHTING PLANS**

SCALE: 1" = 20' SHEET NO. E6 OF E14 SHEETS STA. TO STA.

F.A.I. RTE.	SECTION	COUNTY	TOTAL SHEETS	SHEET NO.
90	1515.1-B	COOK	101	35
				CONTRACT NO. 60M79
ILLINOIS FED. AID PROJECT				