

QUANTITY  
 4 (100) LINE = 64.1 ft. (19.7 m)  
 21.1 sq. ft. (1.97 sq. m)

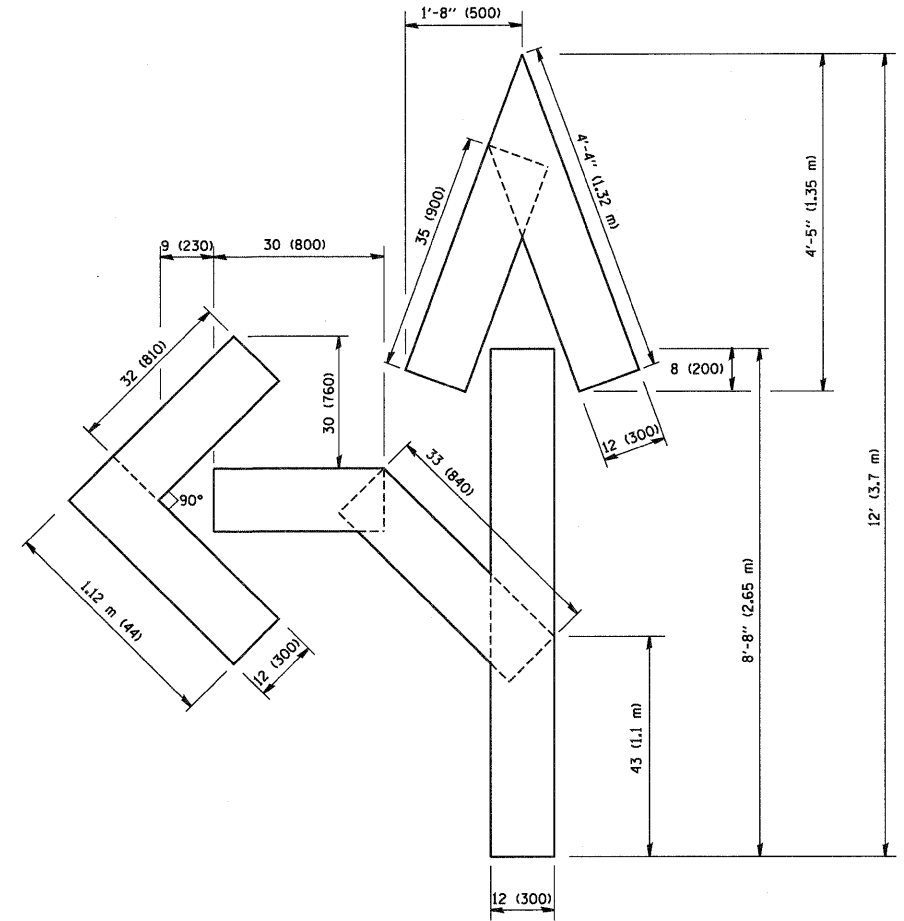

QUANTITY  
 4 (100) LINE = 82.5 ft. (25.3 m)  
 27.5 sq. ft. (2.53 sq. m)

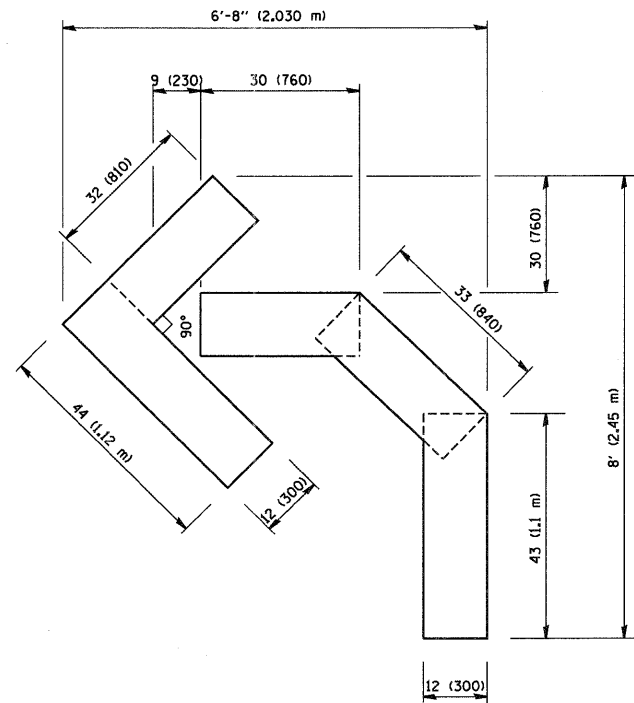

QUANTITY  
 4 (100) LINE = 45.5 ft. (13.9 m)  
 15.2 sq. ft. (1.39 sq. m)

All dimensions are in inches (millimeters) unless otherwise shown.

|  |                             |                       |  |
|--|-----------------------------|-----------------------|--|
| FILE NAME =<br>W:\diststd\22x34\to16.dgn | USER NAME = geglanoht       | DESIGNED -<br>DRAWN - | REVISED -T. RAMMACHER 06-05-96<br>REVISED -T. RAMMACHER 11-04-97 |
|  | PLOT SCALE = 50.0000" / IN. | CHECKED -             | REVISED -T. RAMMACHER 03-02-98                                   |
|  | PLOT DATE = 1/4/2008        | DATE - 09-18-94       | REVISED -E. GOMEZ 08-28-00                                       |

**STATE OF ILLINOIS  
 DEPARTMENT OF TRANSPORTATION**

**PAVEMENT MARKING LETTERS AND SYMBOLS  
 FOR TRAFFIC STAGING**

SCALE: NONE SHEET NO. 1 OF 1 SHEETS STA. TO STA.

|   |          |        |                    |              |
|---|----------|--------|--------------------|--------------|
| F.A.I.<br>RTE.                                  | SECTION  | COUNTY | TOTAL<br>SHEETS    | SHEET<br>NO. |
| 90  | 1515.1-B | COOK   | 101                | 90           |
| TC-16   |          |        | CONTRACT NO. 60M79 |              |
| FED. ROAD DIST. NO. 1 ILLINOIS FED. AID PROJECT |          |        |                    |              |