

ROUTE	SECTION	COUNTY	TOTAL SHEETS	SHEET NUMBER
VARIOUS	2011-050-1	COOK	69	25

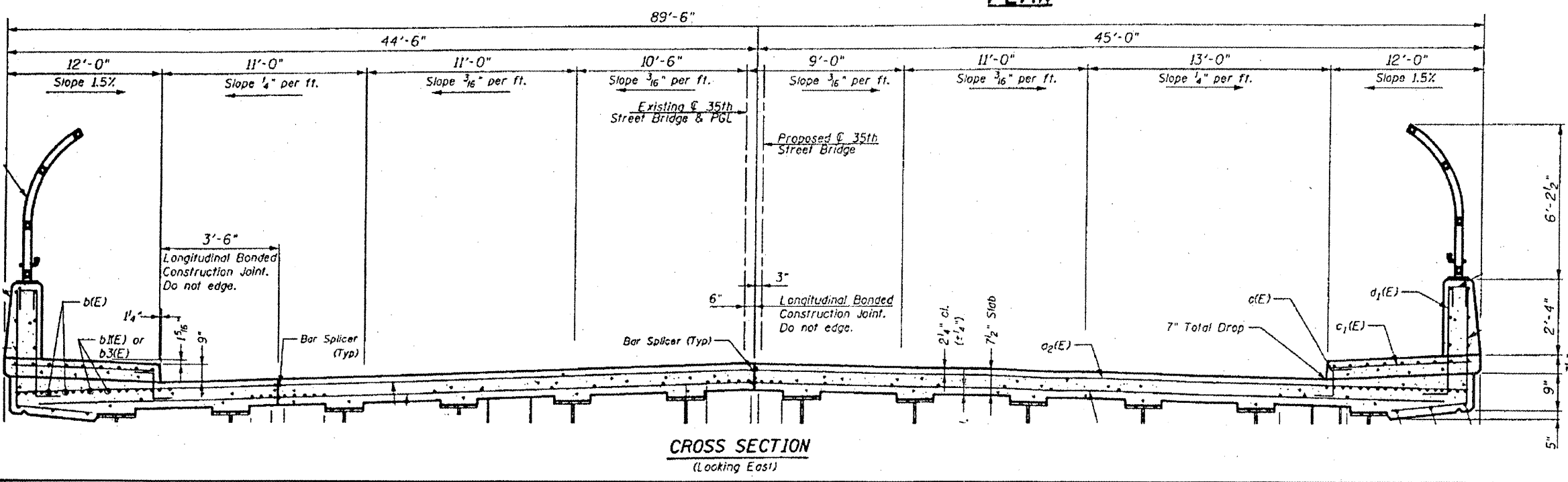
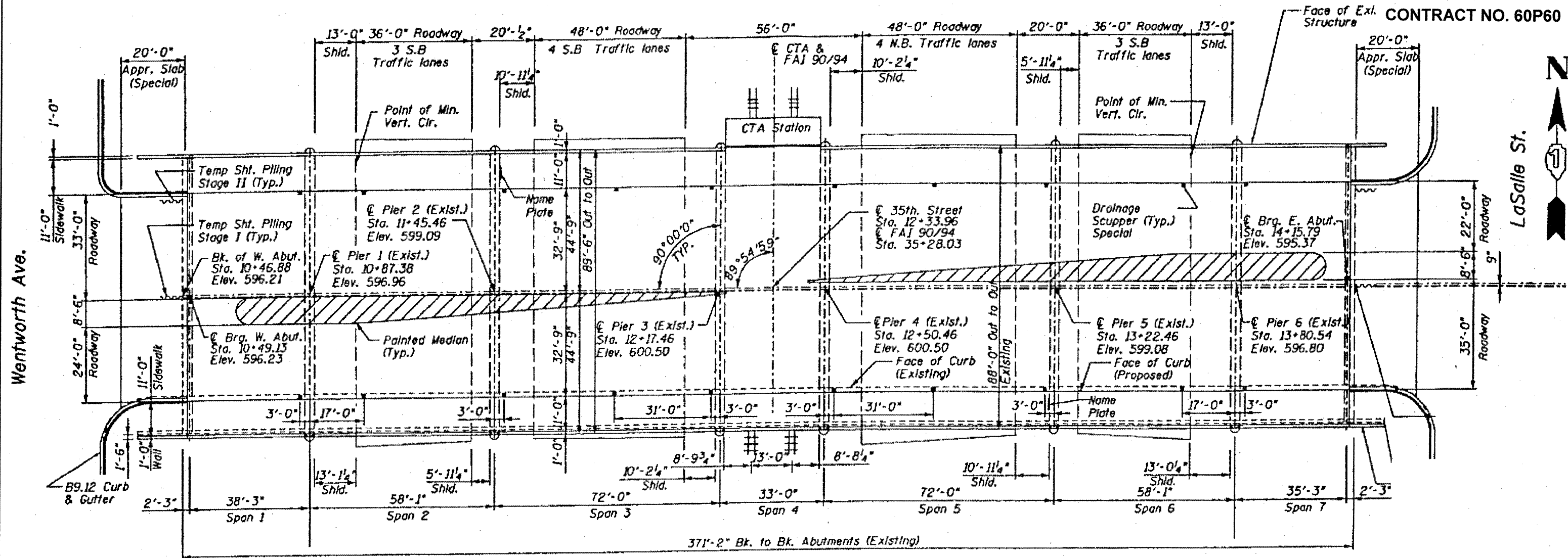

FOR INFORMATION ONLY

ILLINOIS DEPARTMENT OF TRANSPORTATION

EXISTING PLANS & CROSS SECTION
LOCATION 12 (SN 016-1160)
35TH ST OVER I-90/94
SHEET 1 OF 1