

FOR REFERENCE ONLY

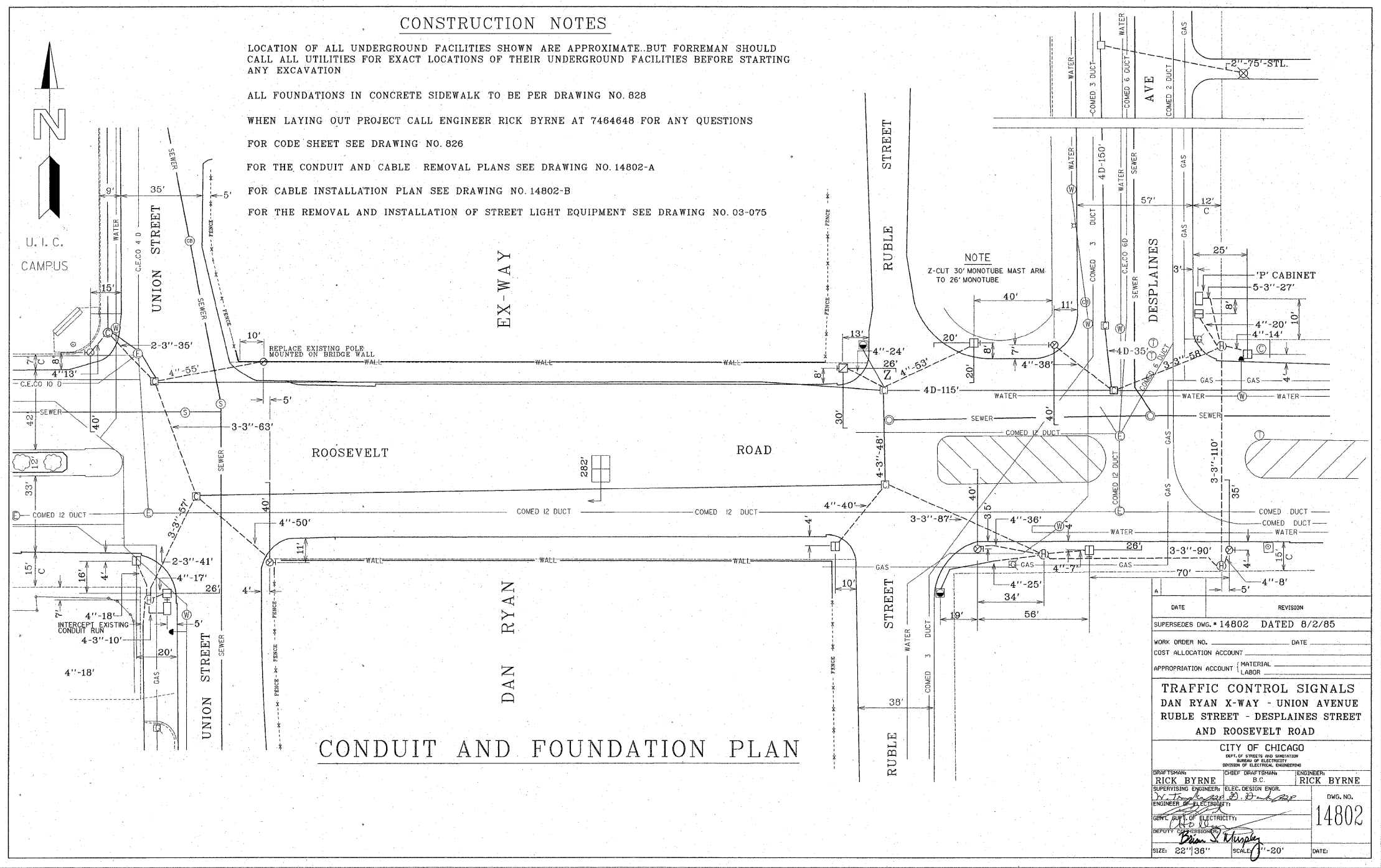

FILE NAME = J:\2010\CDN\CADD Sheets\0168099_155.dgn

SINGH
SINGH & ASSOCIATES, INC.
CONSULTING ENGINEERS

300 W. ADAMS ST.
CHICAGO, IL 60606
TEL: (312) 629-0240
FAX: (312) 629-8449

USER NAME = kproja@ets	DESIGNED - KP	REVISED -
PLOT SCALE = 5.0000' / in.	DRAWN - VP	REVISED -
PLOT DATE = 11/30/2011	CHECKED - IY	REVISED -
	DATE - 11/29/2011	REVISED -

STATE OF ILLINOIS
DEPARTMENT OF TRANSPORTATION

W. ROOSEVELT RD. OVER I-90/94 (DAN RYAN EXPY)
AS BUILT CONDUIT AND FOUNDATION PLAN
(FOR REFERENCE ONLY)

SCALE: N.T.S. SHEET NO. OF SHEETS STA. TO STA.

F.A.I. RTE.	SECTION	COUNTY	TOTAL SHEETS	SHEET NO.
90/94	2011-070-1	COOK	27	6E
CONTRACT NO. 60P89			ILLINOIS FED. AID PROJECT	