

F.A.P. RTE.	SECTION	COUNTY	TOTAL SHEETS	SHEET NO.
307	130 R-2	DUPAGE, KANE	647	27
STA.		TO STA.		
FED. ROAD DIST. NO.		ILLINOIS FED. AID PROJECT		
62410				

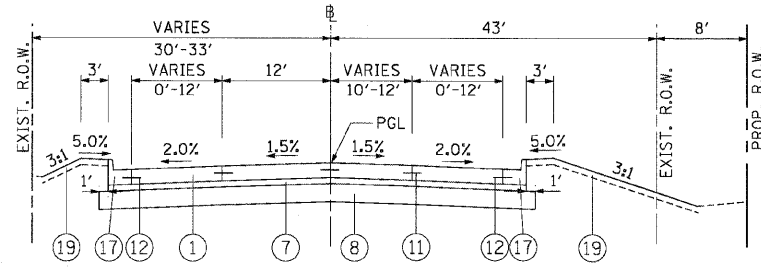

**PROPOSED TYPICAL SECTION  
 POWIS ROAD**  
 STA. 6579+61.51 TO STA. 6584+09.59

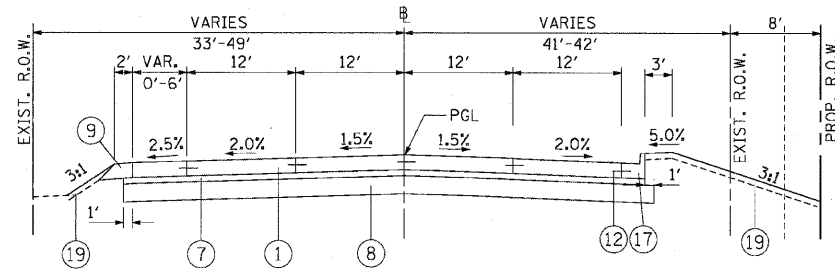

**PROPOSED TYPICAL SECTION  
 POWIS ROAD**  
 STA. 6584+09.59 TO STA. 6590+95.05

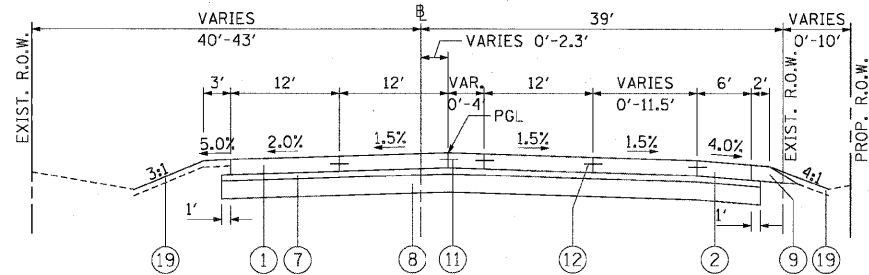

**PROPOSED TYPICAL SECTION  
 POWIS ROAD**  
 STA. 6592+62.46 TO STA. 6598+43.67

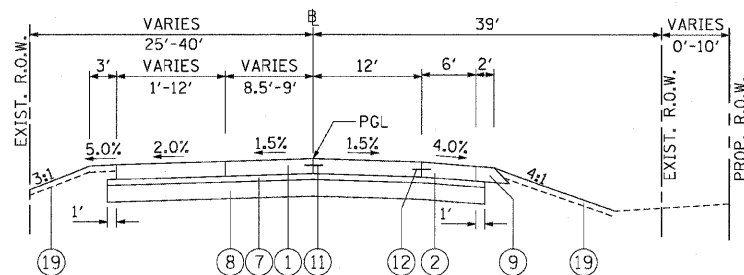

**PROPOSED TYPICAL SECTION  
 POWIS ROAD**  
 STA. 6598+43.67 TO STA. 6602+50.46

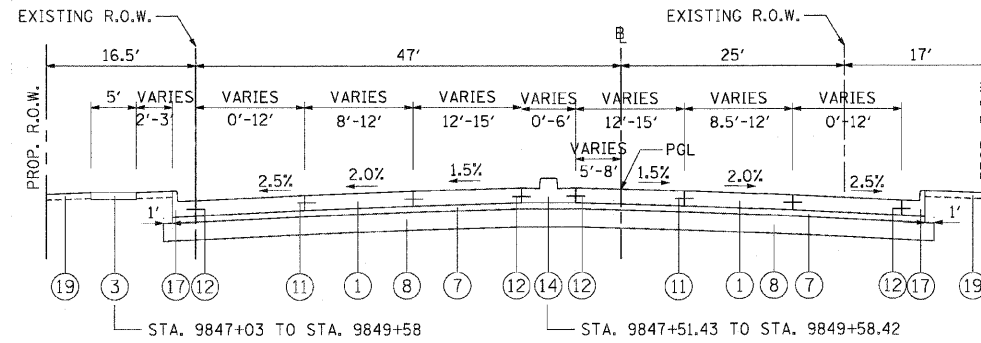

**PROPOSED TYPICAL SECTION  
 KAUTZ ROAD**  
 STA. 9841+67.29 TO STA. 9849+58.42

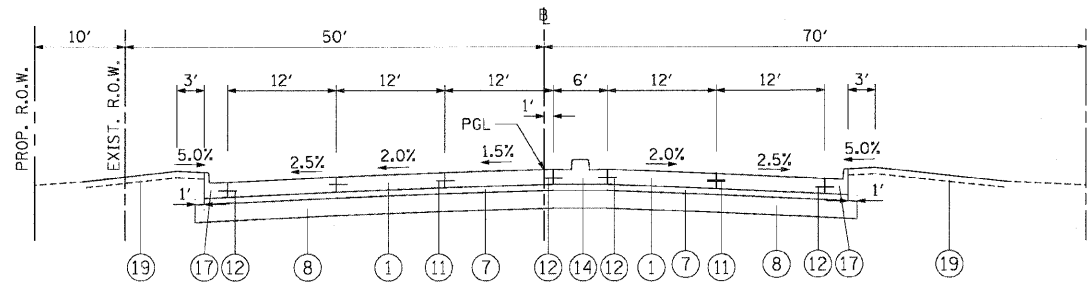

**PROPOSED TYPICAL SECTION  
 SMITH ROAD**  
 STA. 9851+19.21 TO STA. 9853+21.85

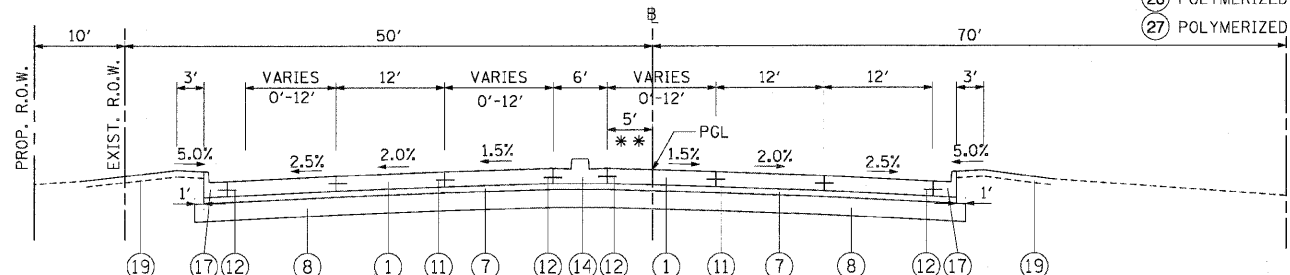

**PROPOSED TYPICAL SECTION  
 SMITH ROAD**  
 STA. 9853+21.85 TO STA. 9856+43.84

\* THIS DIMENSION VARIES FROM 7' RT TO 5' LT OF BASELINE FROM STA. 9853+36.65 TO STA. 9855+01.85

**PROPOSED LEGEND:**

- 1 PORTLAND CEMENT CONCRETE PAVEMENT 10" (JOINTED)
- 2 PORTLAND CEMENT CONCRETE SHOULDERS 10"
- 3 PORTLAND CEMENT CONCRETE SIDEWALK, 5"
- 4 HOT-MIX ASPHALT SURFACE COURSE, MIX "D", N50; 2"
- 5 HOT-MIX ASPHALT BINDER COURSE IL-19.0, N50; 2-1/4"
- 6 HOT-MIX ASPHALT BASE COURSE, 7"
- 7 STABILIZED SUB-BASE 4 1/2"
- 8 AGGREGATE SUBGRADE 12"
- 9 AGGREGATE SHOULDERS TYPE B, 10"
- 10 SUB-BASE GRANULAR MATERIAL, TYPE B 4"
- 11 #8 TIE BARS, 24" LONG AT 24" C-C  
(INCLUDED IN PRICE FOR BID FOR PCC PAVEMENT - JOINTED)
- 12 #6 TIE BARS, 24" LONG AT 24" C-C  
(INCLUDED IN PRICE FOR BID FOR CURB AND GUTTER OR PCC SHOULDER)
- 13 DRILL AND GROUT BARS (#8 TIE BARS, 24" LONG AT 24" C-C)  
(INCLUDED IN PRICE FOR BID FOR PCC PAVEMENT)
- 14 CONCRETE MEDIAN TYPE SB-6.24 (GUTTER SLOPE =6%)
- 15 CONCRETE MEDIAN SURFACE, 4 INCH
- 16 SUB-BASE GRANULAR MATERIAL, TYPE B
- 17 COMBINATION CONCRETE CURB AND GUTTER, TYPE B-6.24
- 18 COMBINATION CONCRETE CURB AND GUTTER, TYPE B-9.24
- 19 SEE LANDSCAPING SHEETS FOR MIX SEEDING
- 20 CONCRETE PARAPET
- 21 MSE RETAINING WALL
- 22 CONCRETE MEDIAN TYPE SB-9.24 (GUTTER SLOPE =6%)
- 23 POLYMERIZED HOT MIX ASPHALT SURFACE COURSE, MIX "F", N90; 1-3/4"
- 24 POLYMERIZED LEVELING BINDER (MACHINE METHOD), IL-4.75, N-50; 3/4"



PRTP-04

REVISIONS	
NAME	DATE

ILLINOIS DEPARTMENT OF TRANSPORTATION  
 F.A.P. ROUTE 307 (ILLINOIS ROUTE 64)

**PROPOSED TYPICAL SECTIONS**

SCALE: VERT: NONE  
 HORIZ: NONE  
 DATE: NOVEMBER 1, 2011  
 DRAWN BY: AFC  
 CHECKED BY: NJH