

F.A.P. RTE.	SECTION	COUNTY	TOTAL SHEETS	SHEET NO.
307	130 R-2	DUPAGE, KANE	647	56
STA. 3260+00 TO STA. 3273+00				
FED. ROAD DIST. NO.		ILLINOIS FED. AID PROJECT		

62410

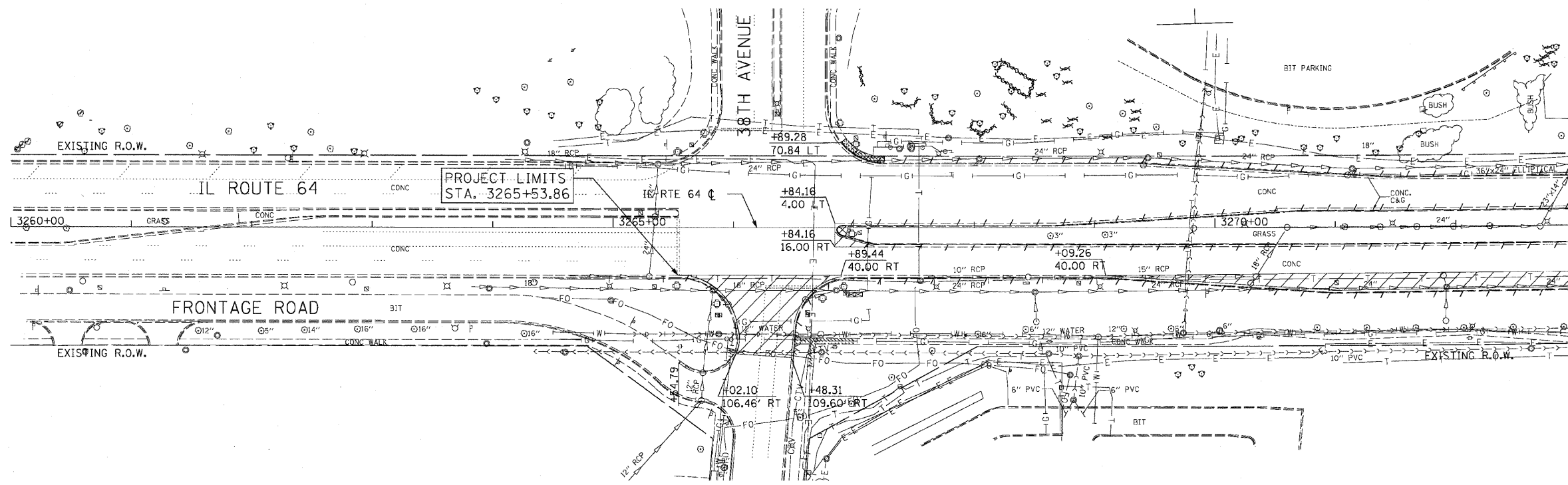

MATCH LINE STA 3273+00  
SEE SHEET RDWY-2

- REMOVAL LEGEND:**
- PAVEMENT REMOVAL
  - MEDIAN REMOVAL
  - DRIVEWAY PAVEMENT REMOVAL
  - PAVED SHOULDER REMOVAL
  - COMB CURB GUTTER REMOVAL
  - SIDEWALK REMOVAL
  - TREE REMOVAL
  - TREE REMOVAL, ACRES

EXISTING CONDITIONS AND REMOVALS

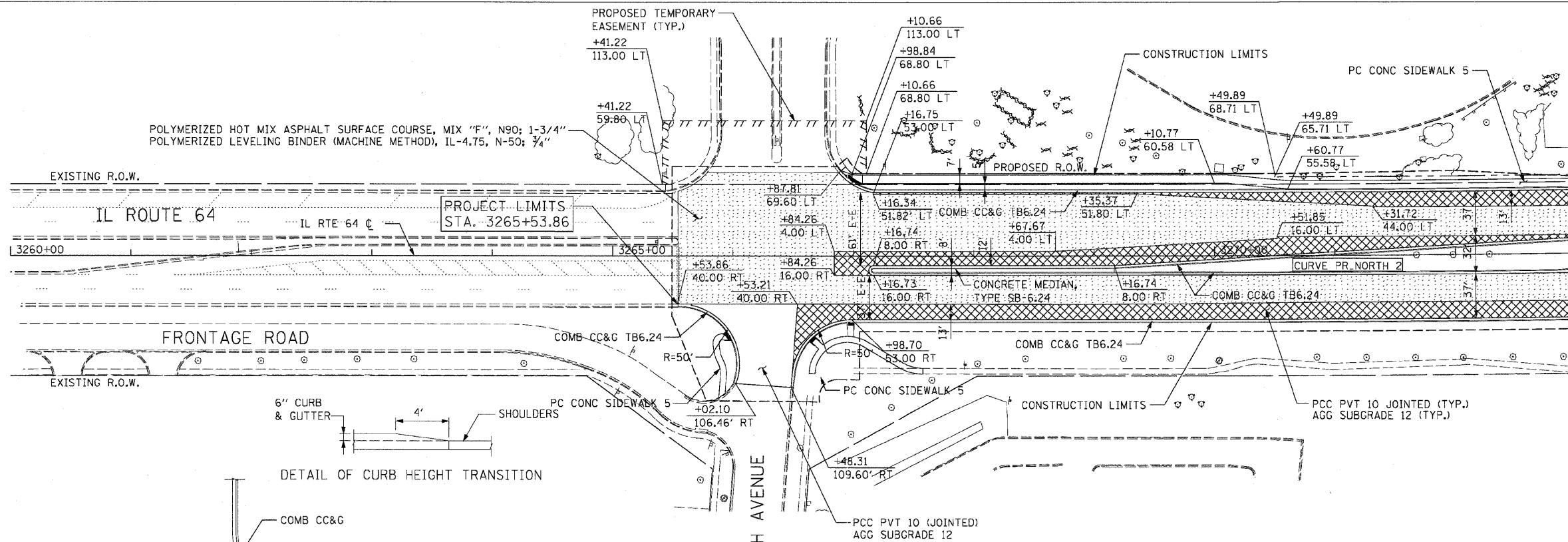

MATCH LINE STA 3273+00  
SEE SHEET RDWY-2

- NOTE:**
- SEE INTERSECTION DETAIL SHEETS FOR GEOMETRIC INFORMATION AT 38TH AVENUE AND IL ROUTE 64.

- PROPOSED LEGEND:**
- PAVEMENT WIDENING
  - HMA RESURFACING

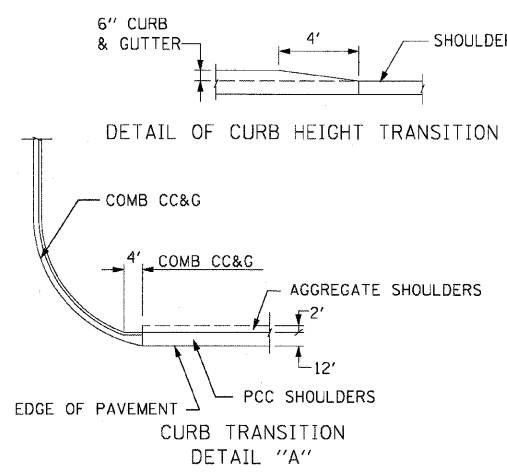

PROPOSED ROADWAY PLAN

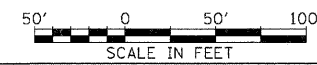

REVISIONS	
NAME	DATE

ILLINOIS DEPARTMENT OF TRANSPORTATION  
 F.A.P. ROUTE 307 (ILLINOIS ROUTE 64)

ROADWAY PLAN  
 IL ROUTE 64  
 STA. 3260+00 TO STA. 3273+00

SCALE: 1" = 50'  
 DATE: MAY 13, 2011  
 DRAWN BY: JWM  
 CHECKED BY: RMC

RDWY-1