

F.A.P. RTE.	SECTION	COUNTY	TOTAL SHEETS	SHEET NO.
307	130 R-2	DUPAGE, KANE	647	57
STA.	3273+00	TO STA.	3287+00	
FED. ROAD DIST. NO.	ILLINOIS FED. AID PROJECT			

62410

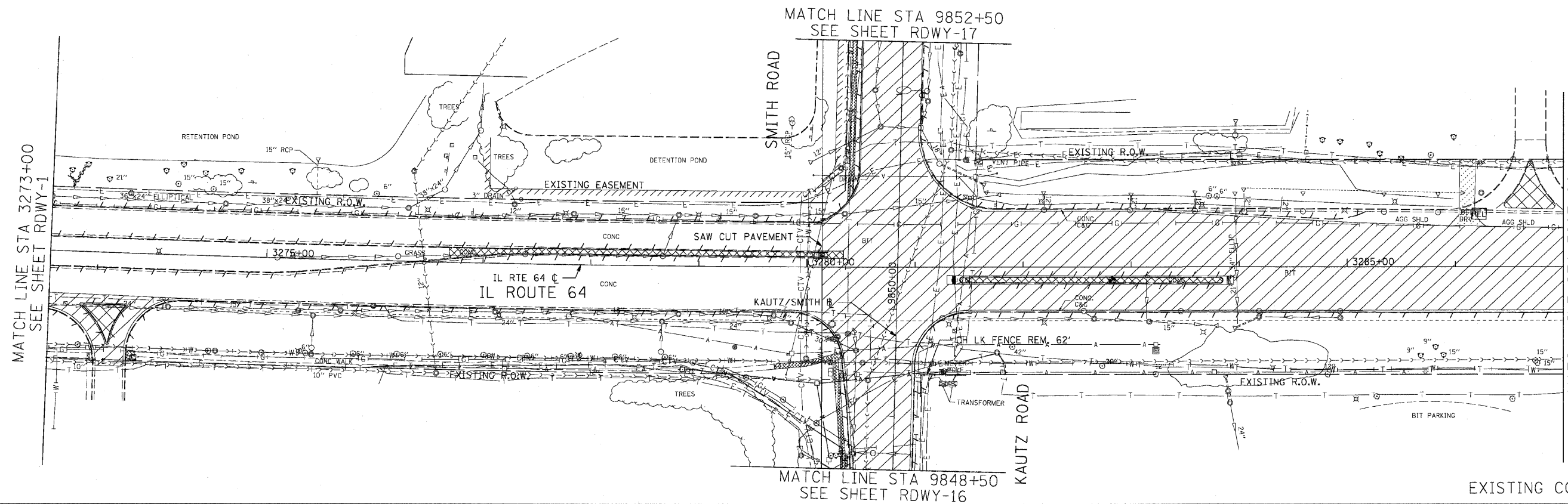

**REMOVAL LEGEND:**

	PAVEMENT REMOVAL
	MEDIAN REMOVAL
	DRIVEWAY PAVEMENT REMOVAL
	PAVED SHOULDER REMOVAL
	COMB CURB GUTTER REMOVAL
	SIDEWALK REMOVAL
	TREE REMOVAL
	TREE REMOVAL, ACRES

EXISTING CONDITIONS AND REMOVALS

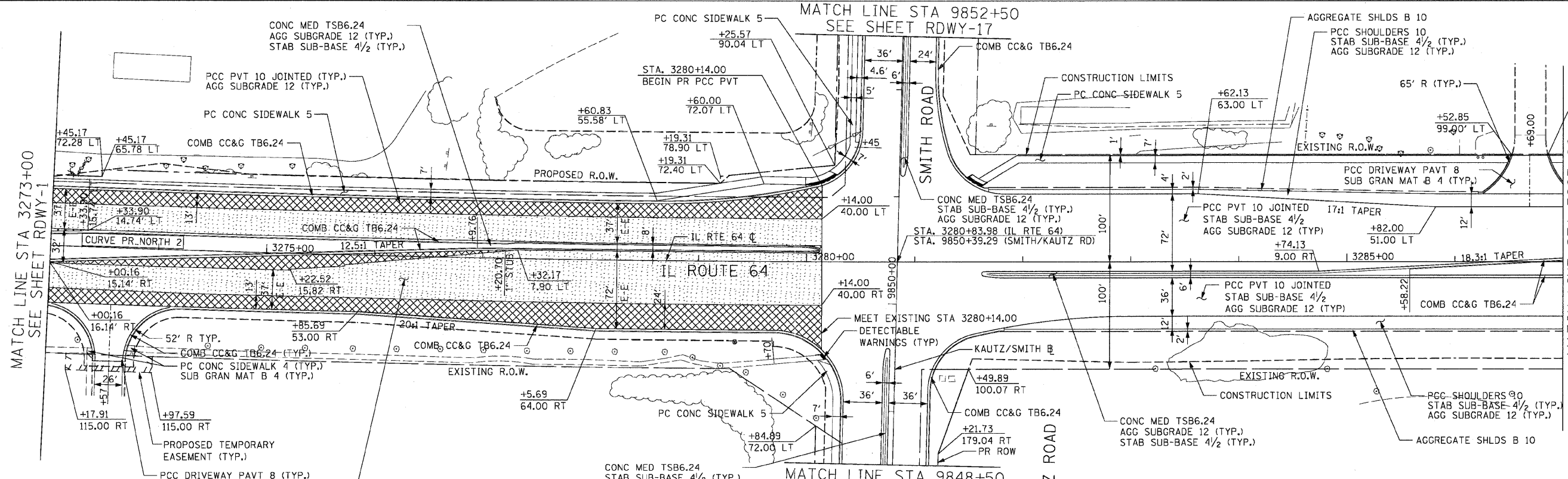

NOTE:

**PROPOSED LEGEND:**

	PAVEMENT WIDENING
	HMA RESURFACING

RDWY-2

REVISIONS	
NAME	DATE

ILLINOIS DEPARTMENT OF TRANSPORTATION  
 F.A.P. ROUTE 307 (ILLINOIS ROUTE 64)

**ROADWAY PLAN**  
 ILLINOIS ROUTE 64  
 STA. 3273+00 TO STA. 3287+00

SCALE: 1" = 50'  
 DATE: NOVEMBER 1, 2011  
 DRAWN BY: JWM  
 CHECKED BY: RMG



PROPOSED ROADWAY PLAN

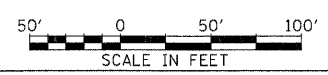

KANE COUNTY LIMIT      DUPAGE COUNTY LIMIT