

F.A.P. RTE.	SECTION	COUNTY	TOTAL SHEETS	SHEET NO.
307	130 R-2	DUPAGE, KANE	647	59
STA. 3299+00 TO STA. 3312+00		ILLINOIS FED. AID PROJECT		

62410

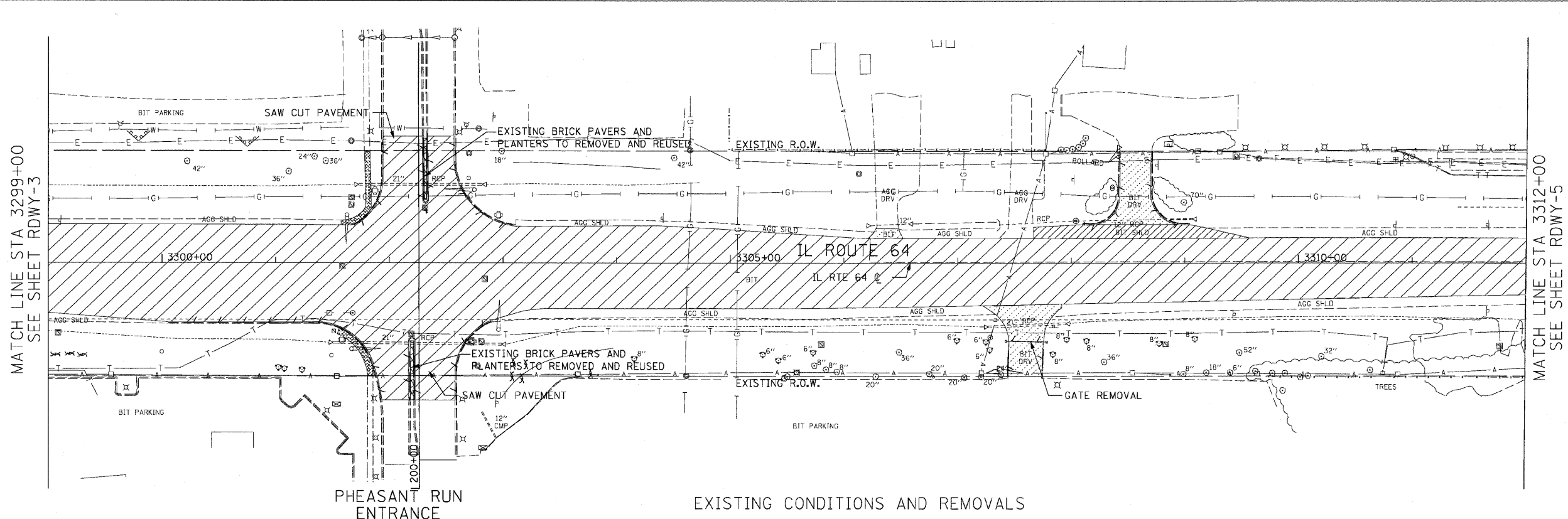

**REMOVAL LEGEND:**

	PAVEMENT REMOVAL
	MEDIAN REMOVAL
	DRIVEWAY PAVEMENT REMOVAL
	PAVED SHOULDER REMOVAL
	COMB CURB GUTTER REMOVAL
	SIDEWALK REMOVAL
	TREE REMOVAL
	TREE REMOVAL, ACRES



EXISTING CONDITIONS AND REMOVALS

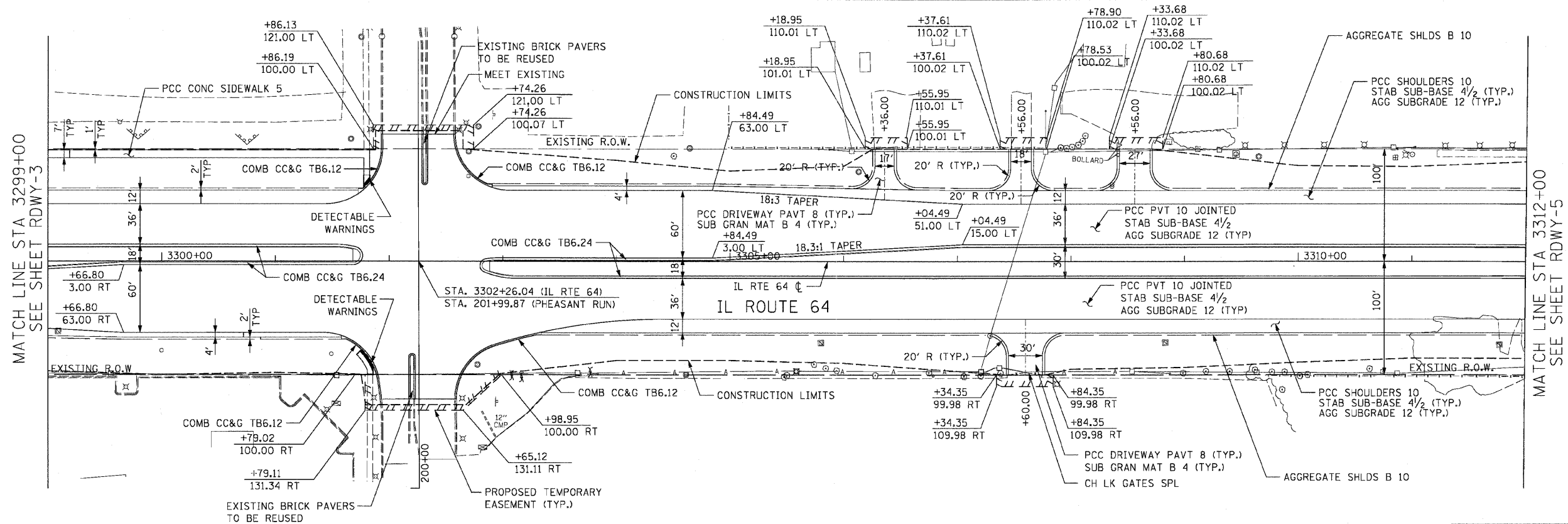

- NOTE:**
- SEE INTERSECTION DETAIL SHEETS FOR GEOMETRIC INFORMATION AT THE PHEASANT RUN ENTRANCE AND IL ROUTE 64.
  - FOR SHOULDER AND CURB AND GUTTER RADIUS RETURN TRANSITIONS - SEE SHEET RDWY-1, DETAIL "A".

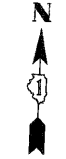

RDWY-4

PHEASANT RUN ENTRANCE

PROPOSED ROADWAY PLAN



REVISIONS	
NAME	DATE

ILLINOIS DEPARTMENT OF TRANSPORTATION  
 F.A.P. ROUTE 307 (ILLINOIS ROUTE 64)

**ROADWAY PLAN**  
 ILLINOIS ROUTE 64  
 STA. 3299+00 TO STA. 3312+00



SCALE: 1" = 50'  
 DATE: NOVEMBER 1, 2011  
 DRAWN BY: AFC  
 CHECKED BY: NJH