

F.A.P. RTE.	SECTION	COUNTY	TOTAL SHEETS	SHEET NO.
307	130 R-2	DUPAGE, KANE	647	69
STA.	6577+00	TO STA.	6590+00	
FED. ROAD DIST. NO.	ILLINOIS	FED. AID PROJECT		

62410

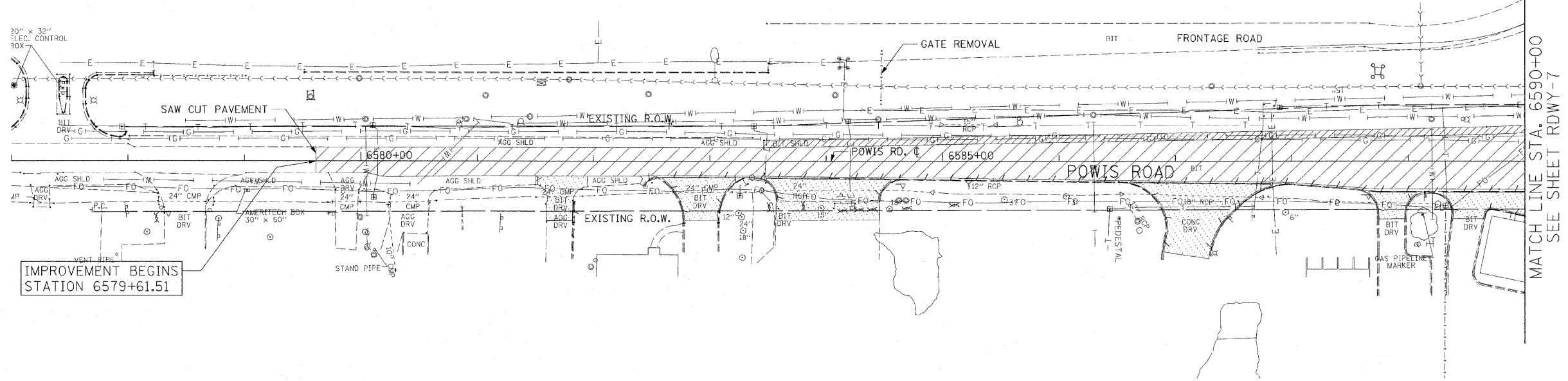

- REMOVAL LEGEND:**
- PAVEMENT REMOVAL
 - MEDIAN REMOVAL
 - DRIVEWAY PAVEMENT REMOVAL
 - PAVED SHOULDER REMOVAL
 - COMB CURB GUTTER REMOVAL
 - SIDEWALK REMOVAL
 - TREE REMOVAL
 - TREE REMOVAL, ACRES

EXISTING CONDITIONS AND REMOVALS

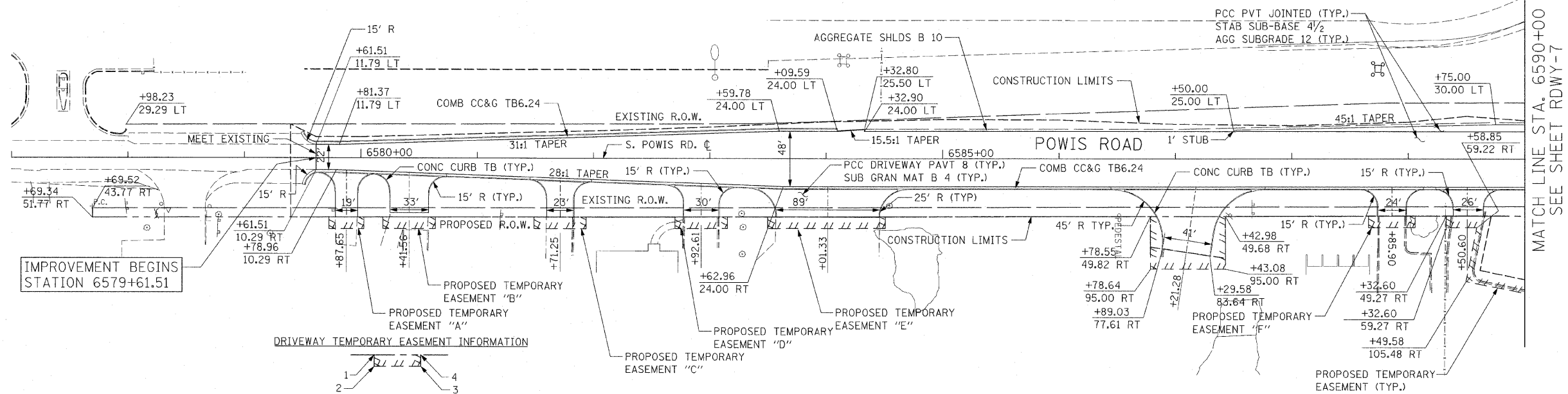

DRIVEWAY TEMPORARY EASEMENT INFORMATION

POINT	STATION	OFFSET	POINT	STATION	OFFSET
A1	6579+72.67	51.34 RT	D1	6582+70.11	50.70 RT
A2	6579+72.67	61.34 RT	D2	6582+70.11	60.70 RT
A3	6580+02.67	61.27 RT	D3	6583+15.11	60.60 RT
A4	6580+02.67	51.27 RT	D4	6583+15.11	50.60 RT
B1	6580+19.06	51.24 RT	E1	6583+49.81	50.53 RT
B2	6580+19.06	61.24 RT	E2	6583+49.81	60.53 RT
B3	6580+64.06	61.14 RT	E3	6584+50.75	60.31 RT
B4	6580+64.06	51.14 RT	E4	6584+50.75	50.31 RT
C1	6581+48.75	50.96 RT	F1	6588+65.90	49.42 RT
C2	6581+48.75	60.96 RT	F2	6588+65.90	59.42 RT
C3	6581+93.75	60.86 RT	F3	6589+05.90	59.33 RT
C4	6581+93.75	50.86 RT	F4	6589+05.90	49.33 RT

PROPOSED ROADWAY PLAN



REVISIONS	
NAME	DATE

ILLINOIS DEPARTMENT OF TRANSPORTATION
 F.A.P. ROUTE 307 (ILLINOIS ROUTE 64)

ROADWAY PLAN
 POWIS ROAD
 STA. 6577+00 TO STA. 6590+00

SCALE: 1" = 50'
 DATE: DECEMBER 2, 2011

DRAWN BY: AFC
 CHECKED BY: NJH

RDWY-14

