

F.A.P. RTE.	SECTION	COUNTY	TOTAL SHEETS	SHEET NO.
307	130 R-2	DUPAGE, KANE	647	107
STA.	TO STA.			
FED. ROAD DIST. NO.	ILLINOIS	FED. AID PROJECT		

62410

LEGEND:

- TEMPORARY PAVEMENT
- DIRECTION OF TRAFFIC
- TYPE I OR II BARRICADES
- TEMPORARY CONCRETE BARRIER
- IMPACT ATTENUATOR
- TYPE III BARRICADES
- 4" EDGE LINE
- 4" DOUBLE CENTER LINE - YELLOW
- 4" SKIP DASH LINE (30' SKIP/10' DASH) - WHITE
- 4" SKIP DASH LINE (6' SKIP/2' DASH) - WHITE
- 6" LANE LINE - WHITE
- 24" STOP BAR - WHITE
- LETTERS AND SYMBOLS

TEMPORARY INFORMATION SIGN LEGEND

- ROAD NARROWS - 2

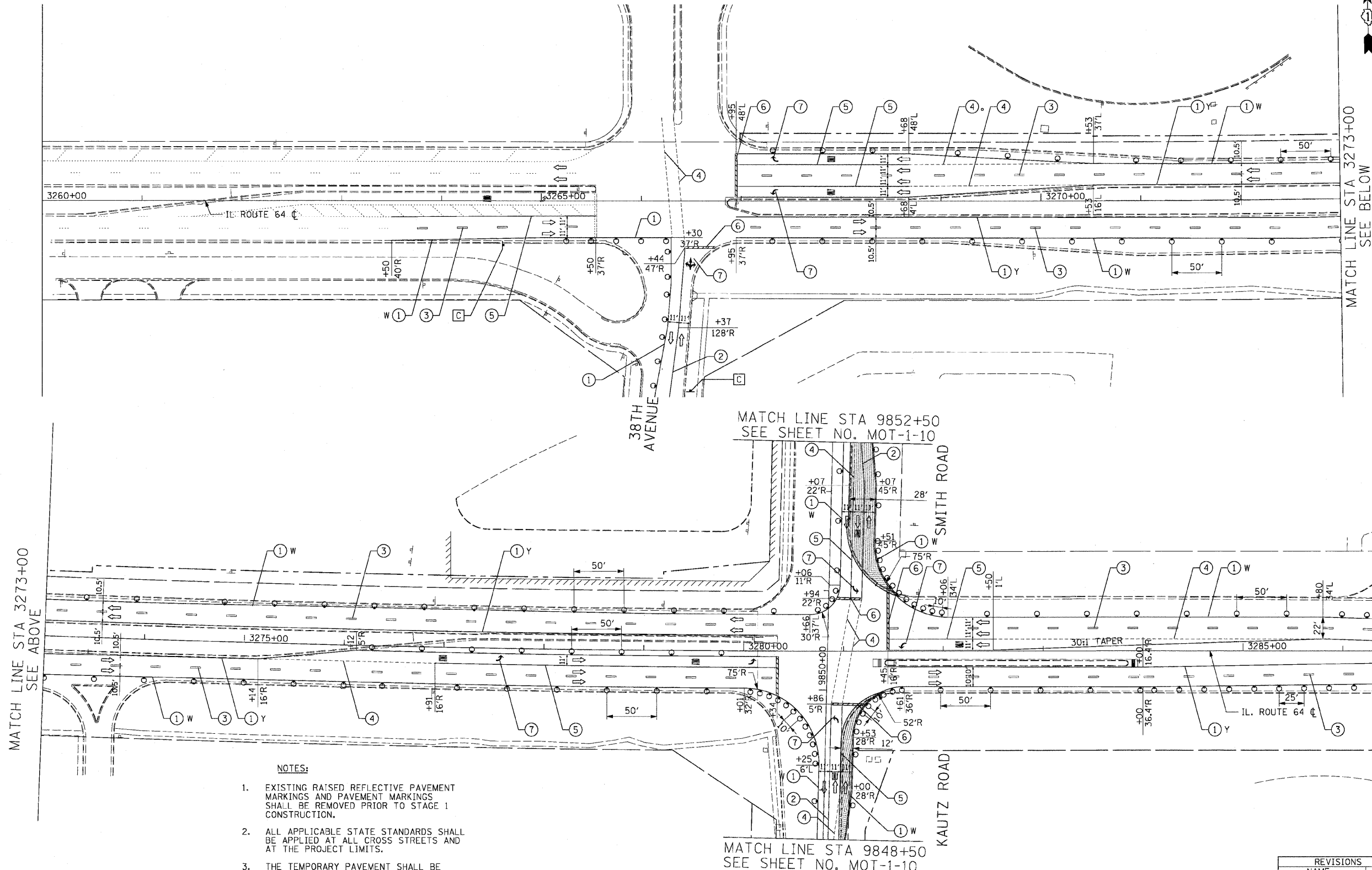

NOTES:

1. EXISTING RAISED REFLECTIVE PAVEMENT MARKINGS AND PAVEMENT MARKINGS SHALL BE REMOVED PRIOR TO STAGE 1 CONSTRUCTION.
2. ALL APPLICABLE STATE STANDARDS SHALL BE APPLIED AT ALL CROSS STREETS AND AT THE PROJECT LIMITS.
3. THE TEMPORARY PAVEMENT SHALL BE CONSTRUCTED PRIOR TO THE SETUP FOR STAGE 1.
4. DIMENSIONS SHOWN ALONG THE EAST SIDE OF SMITH ROAD AND KAUTZ ROAD ARE FOR THE TEMPORARY PAVEMENT. THE LANE LINE SHALL BE 1-FOOT OFFSET FROM THE PAVEMENT EDGE.
5. TEMPORARY ACCESS SHALL BE MAINTAINED TO PHEASANT RUN RESORT DURING STAGE 1.



MOT-1-01

REVISIONS	
NAME	DATE

ILLINOIS DEPARTMENT OF TRANSPORTATION
 F.A.P. ROUTE 307 (ILLINOIS ROUTE 64)
SUGGESTED STAGES OF CONSTRUCTION AND TRAFFIC CONTROL STAGE 1



SCALE: VERT: NONE
 HORIZ: 1"=50'
 DATE: MAY 13, 2011
 DRAWN BY: RMG
 CHECKED BY: JWM