

F.A.P. RTE.	SECTION	COUNTY	TOTAL SHEETS	SHEET NO.
307	130 R-2	DUPAGE, KANE	647	108
STA.	TO STA.			
FED. ROAD DIST. NO.	ILLINOIS		FED. AID PROJECT	

62410

LEGEND:

- TEMPORARY PAVEMENT
- DIRECTION OF TRAFFIC
- TYPE I OR II BARRICADES
- TEMPORARY CONCRETE BARRIER
- IMPACT ATTENUATOR
- TYPE III BARRICADES
- 4" EDGE LINE
- 4" DOUBLE CENTER LINE - YELLOW
- 4" SKIP DASH LINE (30' SKIP/10' DASH) - WHITE
- 4" SKIP DASH LINE (6' SKIP/2' DASH) - WHITE
- 6" LANE LINE - WHITE
- 24" STOP BAR - WHITE
- LETTERS AND SYMBOLS

TEMPORARY INFORMATION SIGN LEGEND

- DRIVEWAY ENTRANCE - 9
- TRI-TURN - 2

NOTES:

- EXISTING RAISED REFLECTIVE PAVEMENT MARKINGS AND PAVEMENT MARKINGS SHALL BE REMOVED PRIOR TO STAGE 1 CONSTRUCTION.
- ALL APPLICABLE STATE STANDARDS SHALL BE APPLIED AT ALL CROSS STREETS AND AT THE PROJECT LIMITS.

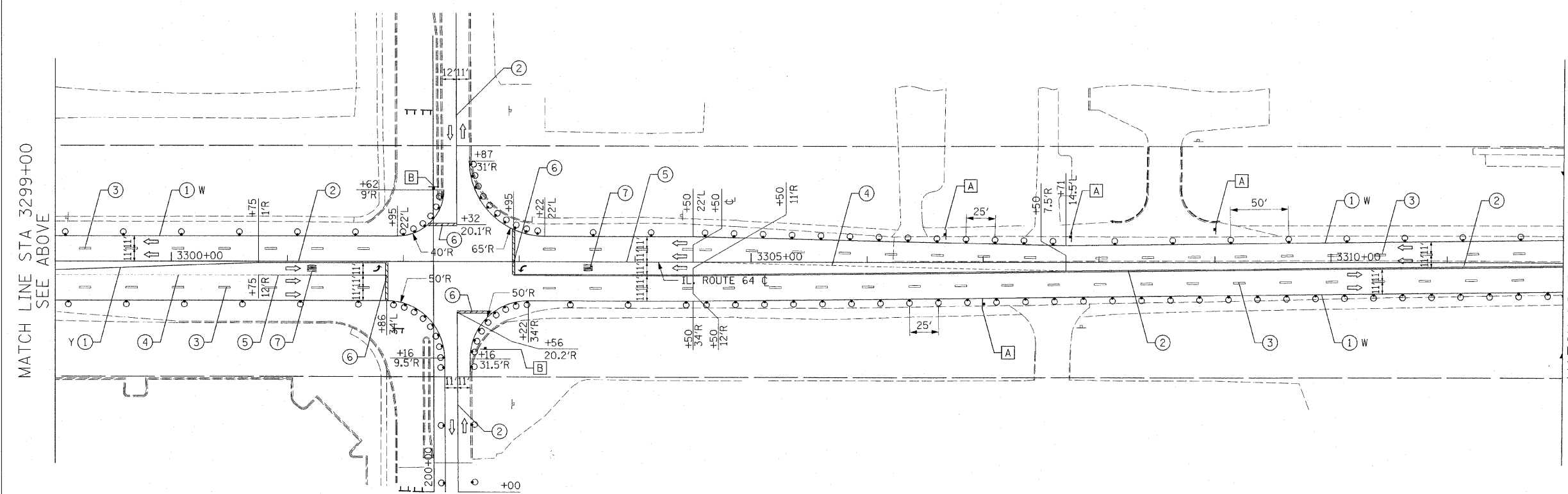
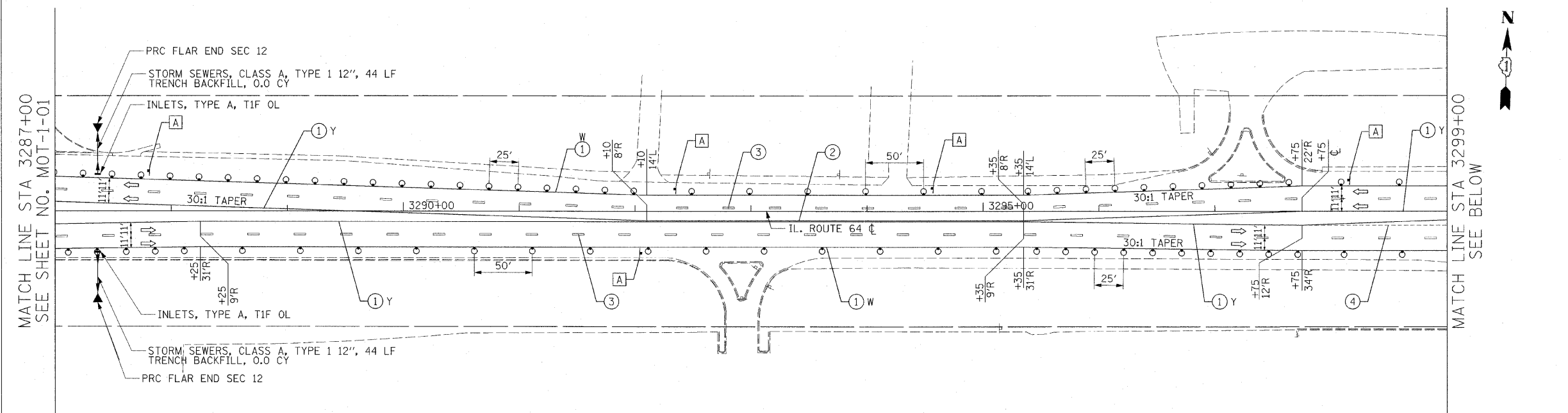

PHEASANT RUN ENTRANCE

REVISIONS	
NAME	DATE

ILLINOIS DEPARTMENT OF TRANSPORTATION  
 F.A.P. ROUTE 307 (ILLINOIS ROUTE 64)

SUGGESTED STAGES OF CONSTRUCTION AND TRAFFIC CONTROL  
 STAGE 1

SCALE: VERT: NONE  
 HORIZ: 1"=50'  
 DATE: DECEMBER 2, 2011  
 DRAWN BY: RMG  
 CHECKED BY: JWM

