

F.A.P. RTE.	SECTION	COUNTY	TOTAL SHEETS	SHEET NO.
307	130 R-2	DUPAGE, KANE	647	116
STA.	TO STA.			
FED. ROAD DIST. NO.	ILLINOIS	FED. AID PROJECT		

62410

LEGEND:

- TEMPORARY PAVEMENT
- DIRECTION OF TRAFFIC
- TYPE I OR II BARRICADES
- TEMPORARY CONCRETE BARRIER
- IMPACT ATTENUATOR
- TYPE III BARRICADES
- 4" EDGE LINE
- 4" DOUBLE CENTER LINE - YELLOW
- 4" SKIP DASH LINE (30' SKIP/10' DASH) - WHITE
- 4" SKIP DASH LINE (6' SKIP/2' DASH) - WHITE
- 6" LANE LINE - WHITE
- 24" STOP BAR - WHITE
- LETTERS AND SYMBOLS

TEMPORARY INFORMATION SIGN LEGEND

- DRIVEWAY ENTRANCE - 5

NOTES:

1. EXISTING RAISED REFLECTIVE PAVEMENT MARKINGS AND PAVEMENT MARKINGS SHALL BE REMOVED PRIOR TO STAGE 1 CONSTRUCTION.
2. ALL APPLICABLE STATE STANDARDS SHALL BE APPLIED AT ALL CROSS STREETS AND AT THE PROJECT LIMITS.
3. THE TEMPORARY PAVEMENT SHALL BE CONSTRUCTED PRIOR TO THE SETUP FOR STAGE 1.
4. DIMENSIONS SHOWN ARE FOR THE TEMPORARY PAVEMENT. THE LANE LINE SHALL BE 1-FOOT FROM THE PAVEMENT EDGE.
5. TEMPORARY ACCESS SHALL BE MAINTAINED TO PHEASANT RUN RESORT DURING STAGE 1.

MATCH LINE STA 9852+50
SEE SHEET NO. MOT-1-01

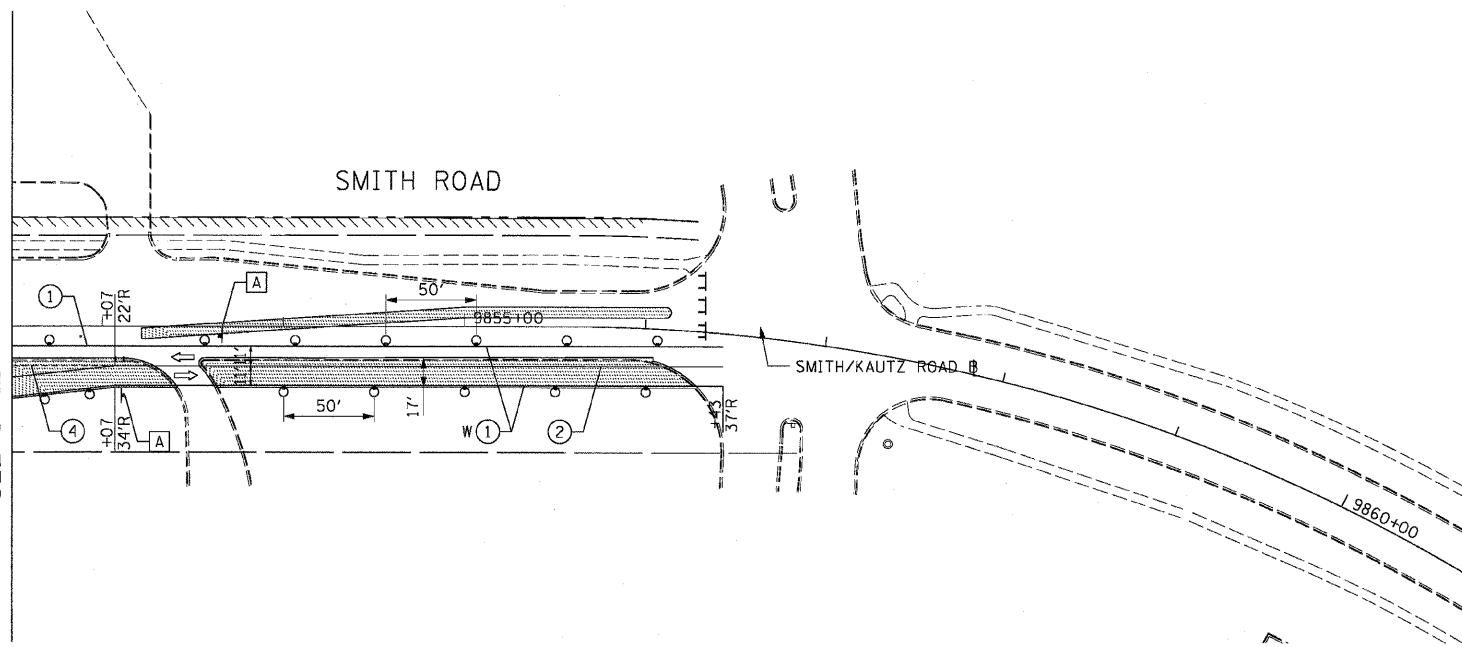

MATCH LINE STA 9848+50
SEE SHEET NO. MOT-1-01

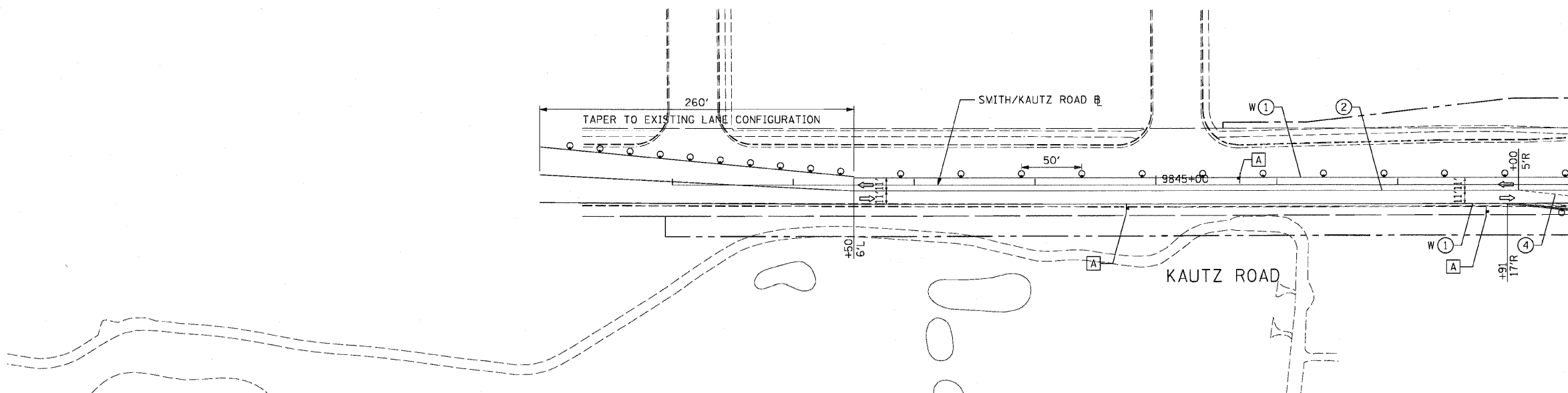

MOT-1-10



REVISIONS	
NAME	DATE

ILLINOIS DEPARTMENT OF TRANSPORTATION
 F.A.P. ROUTE 307 (ILLINOIS ROUTE 64)

SUGGESTED STAGES OF CONSTRUCTION AND TRAFFIC CONTROL STAGE 1

SCALE: VERT: NONE
 HORIZ: 1"=50'
 DATE: MAY 13, 2011

DRAWN BY: RMG
 CHECKED BY: JWM