

F.A.P. RTE.	SECTION	COUNTY	TOTAL SHEETS	SHEET NO.
307	130 R-2	DUPAGE,KANE	647	134
STA.		TO STA.		
FED. ROAD DIST. NO.		ILLINOIS FED. AID PROJECT		

62410

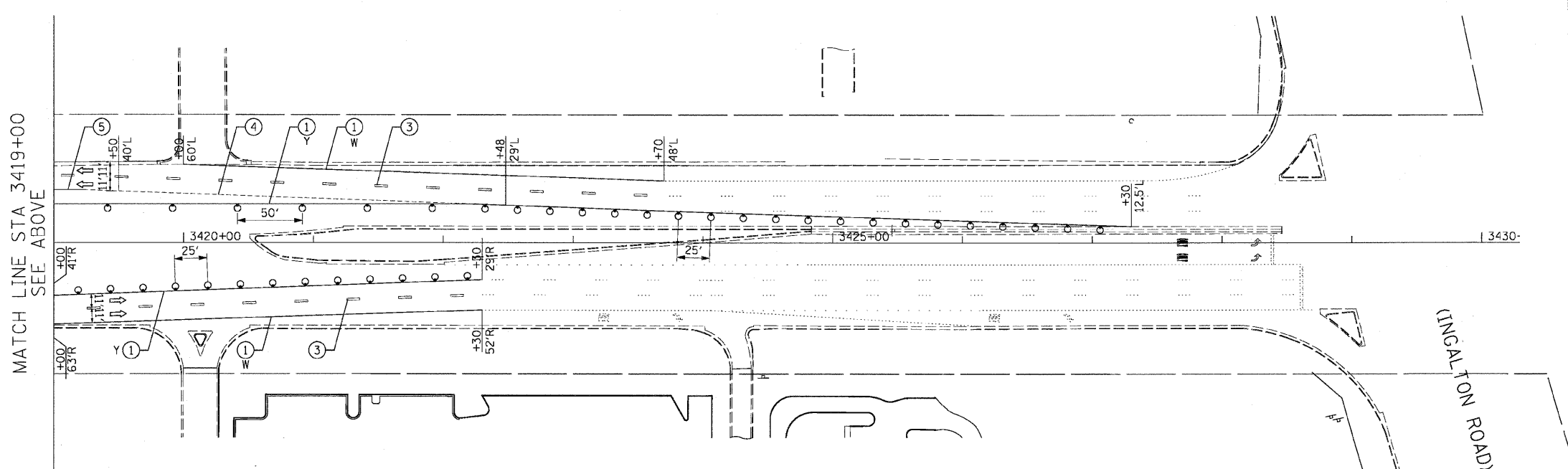
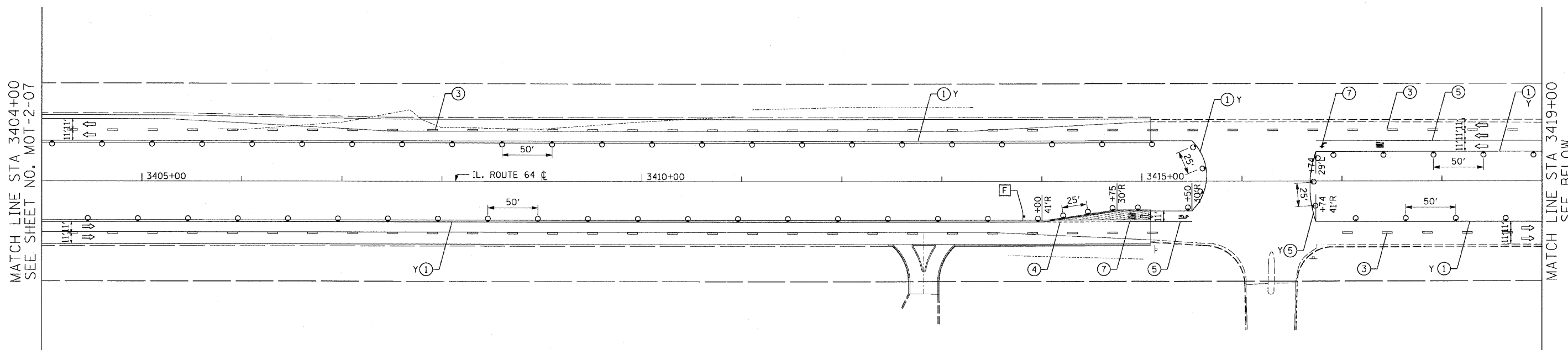

- LEGEND:**
- TEMPORARY PAVEMENT
  - DIRECTION OF TRAFFIC
  - TYPE I OR II BARRICADES
  - TEMPORARY CONCRETE BARRIER
  - IMPACT ATTENUATOR
  - TYPE III BARRICADES
  - 4" EDGE LINE
  - 4" DOUBLE CENTER LINE - YELLOW
  - 4" SKIP DASH LINE (30' SKIP/10' DASH) - WHITE
  - 4" SKIP DASH LINE (6' SKIP/2' DASH) - WHITE
  - 6" LANE LINE - WHITE
  - 24" STOP BAR - WHITE
  - LETTERS AND SYMBOLS

**TEMPORARY INFORMATION SIGN LEGEND**

- U-TURN PERMITTED - 1

**NOTES:**

1. TEMPORARY PAVEMENT MAKINGS SHALL MEET THE EXISTING PAVEMENT MARKINGS AT THE PROJECT LIMITS.
2. ALL APPLICABLE STATE STANDARDS SHALL BE APPLIED AT ALL CROSS STREETS AND AT THE PROJECT LIMITS.

MATCH LINE STA 3419+00  
SEE ABOVE

MATCH LINE STA 3404+00  
SEE SHEET NO. MOT-2-07

MATCH LINE STA 3419+00  
SEE BELOW

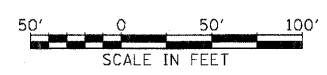

REVISIONS	
NAME	DATE

ILLINOIS DEPARTMENT OF TRANSPORTATION  
 F.A.P. ROUTE 307 (ILLINOIS ROUTE 64)

**SUGGESTED STAGES OF CONSTRUCTION AND TRAFFIC CONTROL**  
 STAGE 2

SCALE: VERT: NONE  
 HORIZ: 1"=50'  
 DATE: MAY 13, 2011

DRAWN BY: RMG  
 CHECKED BY: JWM

MOT-2-08