

|                     |          |                  |              |           |
|---------------------|----------|------------------|--------------|-----------|
| F.A.P. RTE.         | SECTION  | COUNTY           | TOTAL SHEETS | SHEET NO. |
| 64                  | 130R-2   | DU PAGE          | 16           | 206       |
| STA. 101+500        |          | TO STA. 101+850  |              |           |
| FED. ROAD DIST. NO. | ILLINOIS | FED. AID PROJECT |              |           |

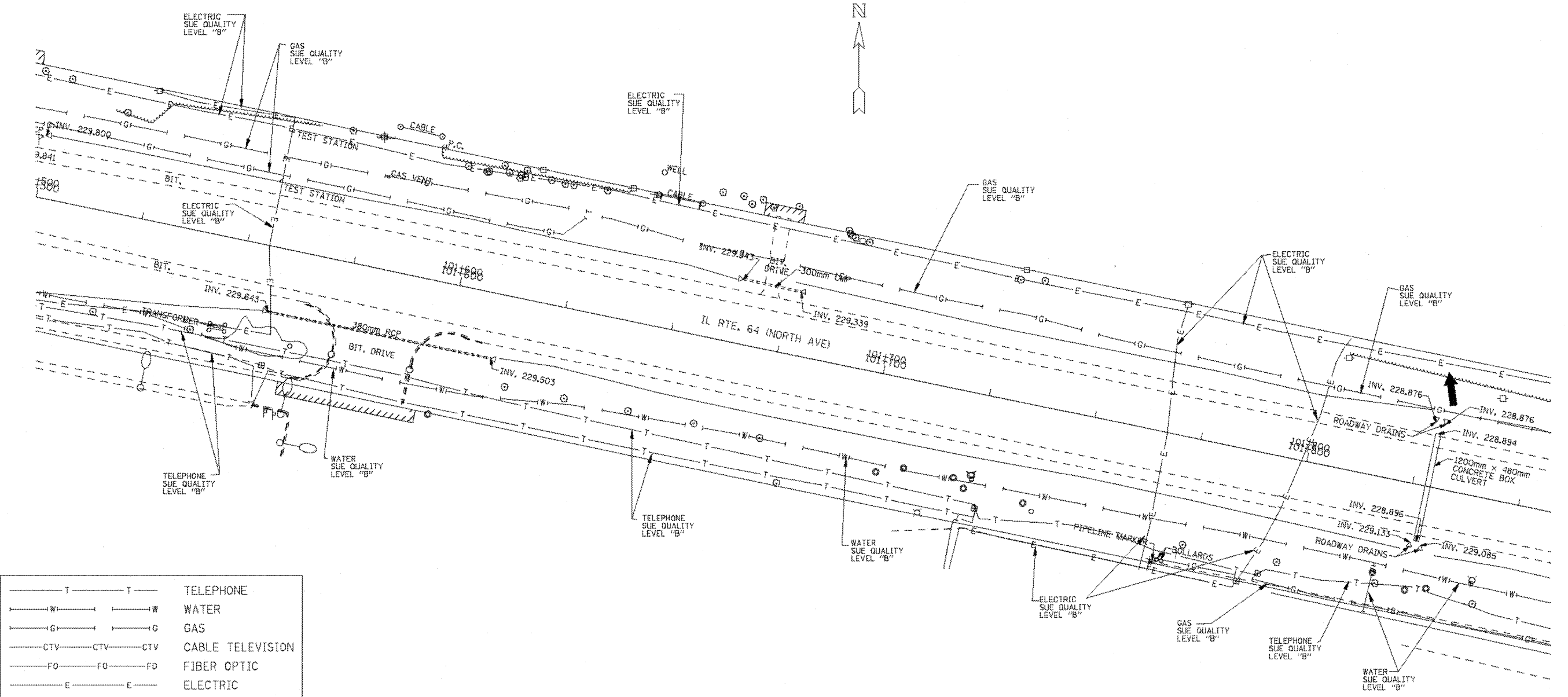

|         |         |                  |
|---------|---------|------------------|
| — T —   | — T —   | TELEPHONE        |
| — W —   | — W —   | WATER            |
| — G —   | — G —   | GAS              |
| — CTV — | — CTV — | CABLE TELEVISION |
| — FO —  | — FO —  | FIBER OPTIC      |
| — E —   | — E —   | ELECTRIC         |

**TBE GROUP, INC.**  
 CIVIL ENGINEERING \* TRANSPORTATION \* ENVIRONMENTAL  
 \* PLANNING \* UTILITY ENGINEERING/LOCATING  
 SOUTHERN REGION: FL, GA, SC, NC  
 NORTHERN REGION: IL, IN, MI, OH, MD, NJ, NY  
 PA, VA, CANADA  
 WESTERN REGION: AZ, NV, NM, TX, CA, OR, UT, WA

WO : IL09500128 & IL09500135  
 SUE Quality Level "A" : Test Holes  
 SUE Quality Level "B" : Designating



205 W. WACKER DRIVE  
 SUITE 1020  
 CHICAGO, IL 60606  
 (312) 704-1970

| REVISIONS             |      | ILLINOIS DEPARTMENT OF TRANSPORTATION                    |
|-----------------------|------|--|
| NAME                  | DATE |  |
|                       |      | IL RTE. 64 (NORTH AVE.)<br>WEST OF IL RT 59 TO KAUTZ RD. |
|                       |      |  |
|                       |      |  |
|                       |      |  |
|                       |      |  |
|                       |      |  |
| SCALE : 1:500         |      | DRAWN BY - JAC   |
| DATE - SOL "B" 7/5/02 |      | CHECKED BY - RLC   |