

F.A.P. RTE.	SECTION	COUNTY	TOTAL SHEETS	SHEET NO.
64	130R-2	DU PAGE	16	210
STA. 102+150		TO STA. 102+500		
FED. ROAD DIST. NO.		ILLINOIS FED. AID PROJECT		

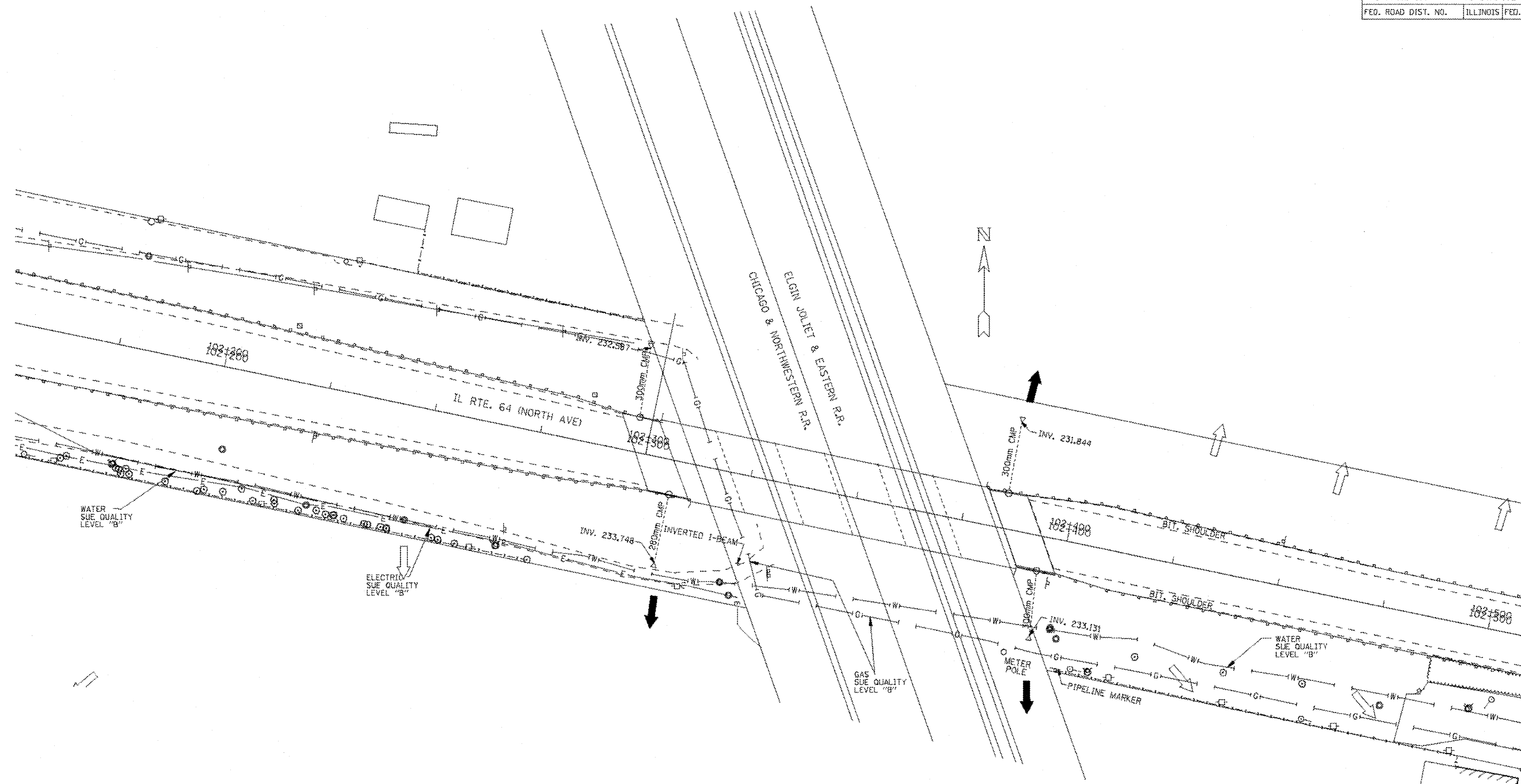

— T — T —	TELEPHONE
— W — W —	WATER
— G — G —	GAS
— CTV — CTV — CTV	CABLE TELEVISION
— FO — FO — FO	FIBER OPTIC
— E — E — E	ELECTRIC

**TBE GROUP, INC.**  
 CIVIL ENGINEERING \* TRANSPORTATION \* ENVIRONMENTAL  
 \* PLANNING \* UTILITY ENGINEERING/LOCATING  
 SOUTHERN REGION: FL, GA, SC, NC  
 NORTHERN REGION: IL, IN, MI, OH, MD, NJ, NY  
 PA, VA, CANADA  
 WESTERN REGION: AZ, NV, NM, TX, CA, OR, UT, WA

WO : IL09500128 & IL09500135  
 SUE Quality Level "A" : Test Holes  
 SUE Quality Level "B" : Designating



205 W. WACKER DRIVE  
 SUITE 1020  
 CHICAGO, IL 60606  
 (312) 704-1970

REVISIONS	
NAME	DATE

ILLINOIS DEPARTMENT OF TRANSPORTATION

IL RTE 64 (NORTH AVE.)  
 WEST OF IL RT 59 TO KAUTZ RD.

SCALE : 1:500  
 DATE - SOL "B" 7/5/02

DRAWN BY - JAC  
 CHECKED BY - RLC