

F.A.P. RTE.	SECTION	COUNTY	TOTAL SHEETS	SHEET NO.
307	130 R-2	DUPAGE, KANE	647	241
STA.	TO STA.			
FED. ROAD DIST. NO.	ILLINOIS FED. AID PROJECT			

62410

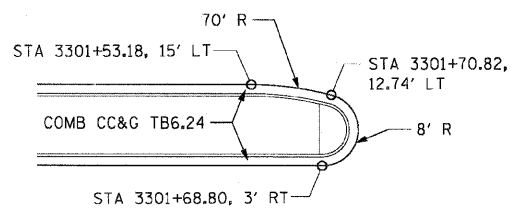

DETAIL A

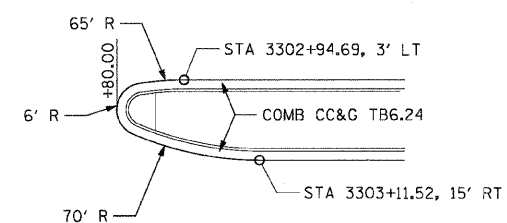

DETAIL B

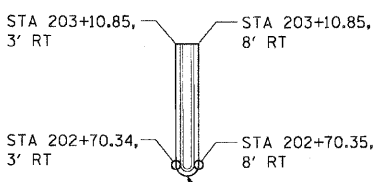
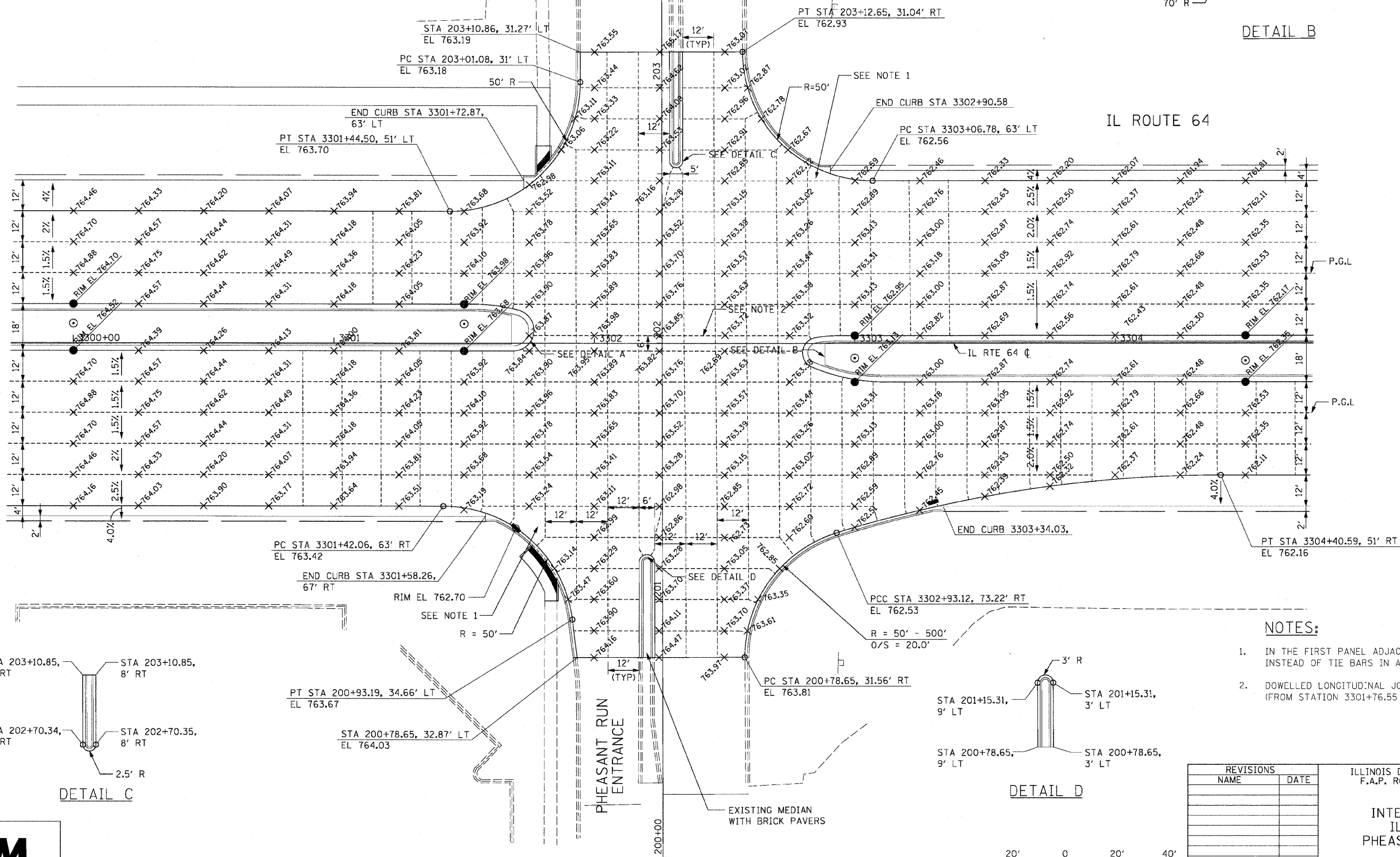

DETAIL C

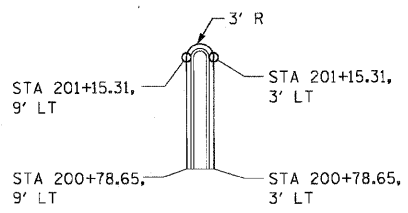

DETAIL D

NOTES:

1. IN THE FIRST PANEL ADJACENT TO MAINLINE, USE DOWEL BARS INSTEAD OF TIE BARS IN ACCORDANCE WITH DETAIL BD52.
2. DOWELLED LONGITUDINAL JOINT FROM MEDIAN TO MEDIAN (FROM STATION 3301+76.55 TO STATION 3302+83.16).

INT-03

REVISIONS	
NAME	DATE

ILLINOIS DEPARTMENT OF TRANSPORTATION  
 F.A.P. ROUTE 307 (ILLINOIS ROUTE 64)

INTERSECTION DETAILS  
 IL ROUTE 64 AND  
 PHEASANT RUN ENTRANCE

SCALE: VERT: NONE  
 HORIZ: 1"=20'  
 DATE: NOVEMBER 1, 2011  
 DRAWN BY: AFC  
 CHECKED BY: NJH

