

F.A.P. RTE.	SECTION	COUNTY	TOTAL SHEETS	SHEET NO.
307	130 R-2	DUPAGE, KANE	647	315
STA. 3377+00		TO STA. 3390+00		
FED. ROAD DIST. NO.		ILLINOIS FED. AID PROJECT		

62410

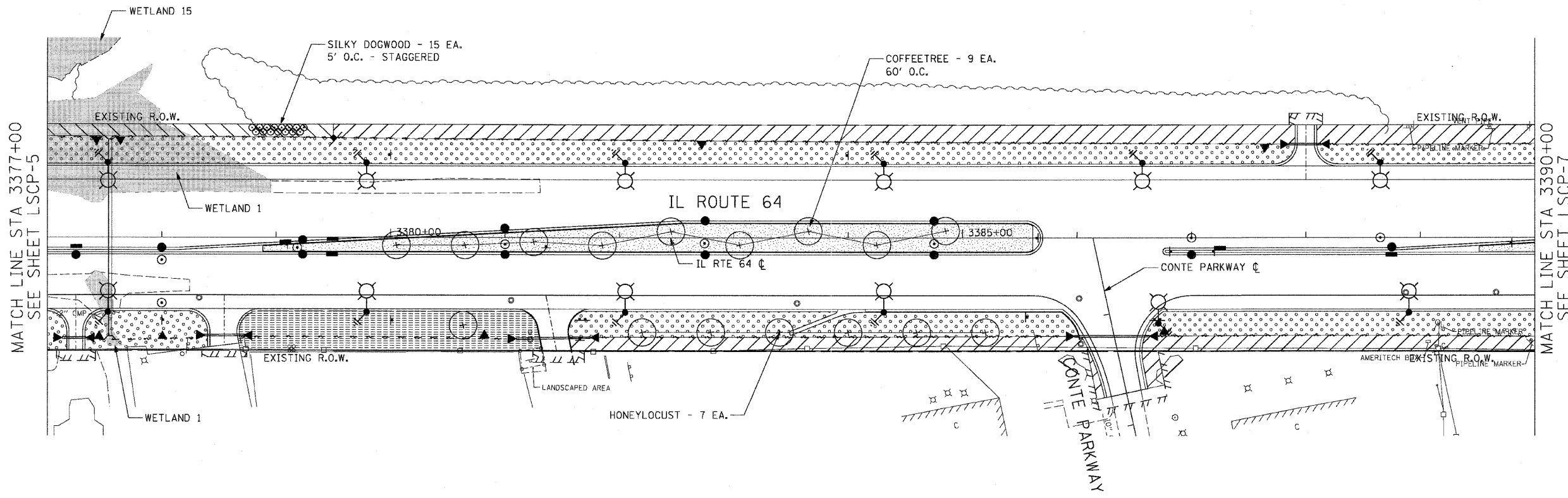

LEGEND:

- FURNISHING AND PLACING TOPSOIL, 4"
AND SEEDING CLASS 2A
EROSION CONTROL BLANKET
- FURNISHING AND PLACING TOPSOIL, 4"
AND SODDING, SALT TOLERANT
EROSION CONTROL BLANKET
- FURNISHING AND PLACING TOPSOIL, 24"
AND SEEDING CLASS 2A
EROSION CONTROL BLANKET
- COMPOST, 2"
SEEDING CLASS 4 (PRAIRIE GRASS)
EROSION CONTROL BLANKET
- COMPOST, 2"
SEEDING CLASS 4B (MODIFIED) WETLAND MIX
EROSION CONTROL BLANKET
- SELECTIVE MOWING STAKE
WITH SIGN

LSCP-6

REVISIONS		ILLINOIS DEPARTMENT OF TRANSPORTATION F.A.P. ROUTE 307 (ILLINOIS ROUTE 64)
NAME	DATE	
S. LIPKIE	06/11	<p style="text-align: center;">LANDSCAPING PLAN IL ROUTE 64 STA. 3377+00 TO STA. 3390+00</p> <p>SCALE: VERT: NONE HORIZ: 1"=50' DATE: MAY 13, 2011</p> <p style="text-align: right;">DRAWN BY: RMG CHECKED BY: JWM</p>

