

F.A.P. RTE.	SECTION	COUNTY	TOTAL SHEETS	SHEET NO.
307	130 R-2	DUPAGE, KANE	647	317
STA. 3404+00		TO STA. 3422+54		
FED. ROAD DIST. NO.		ILLINOIS FED. AID PROJECT		

62410

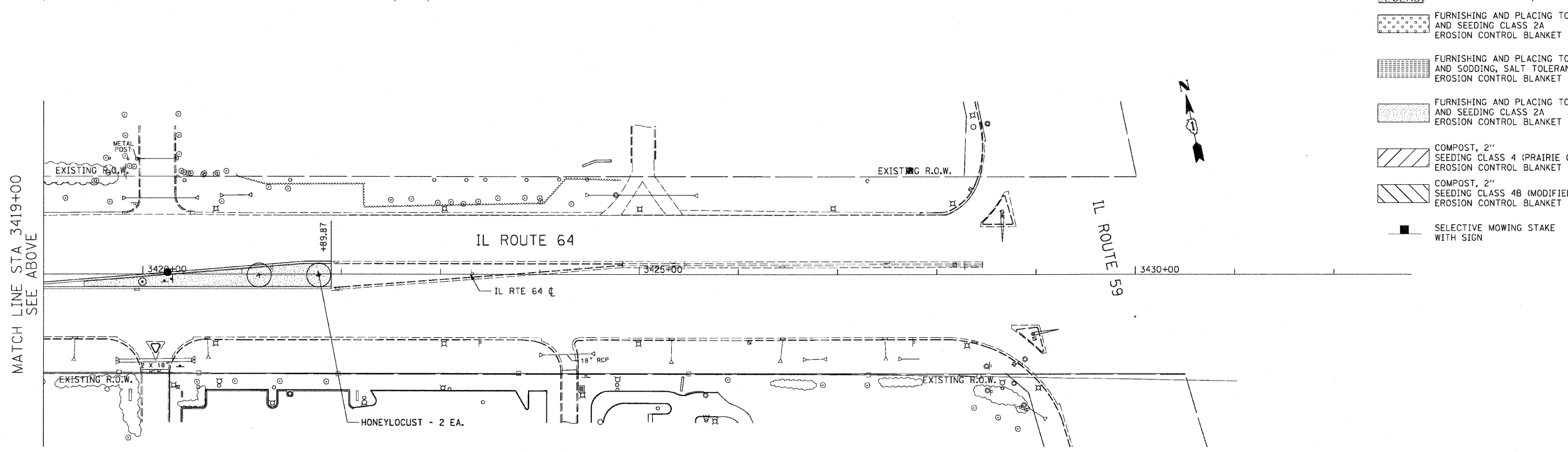
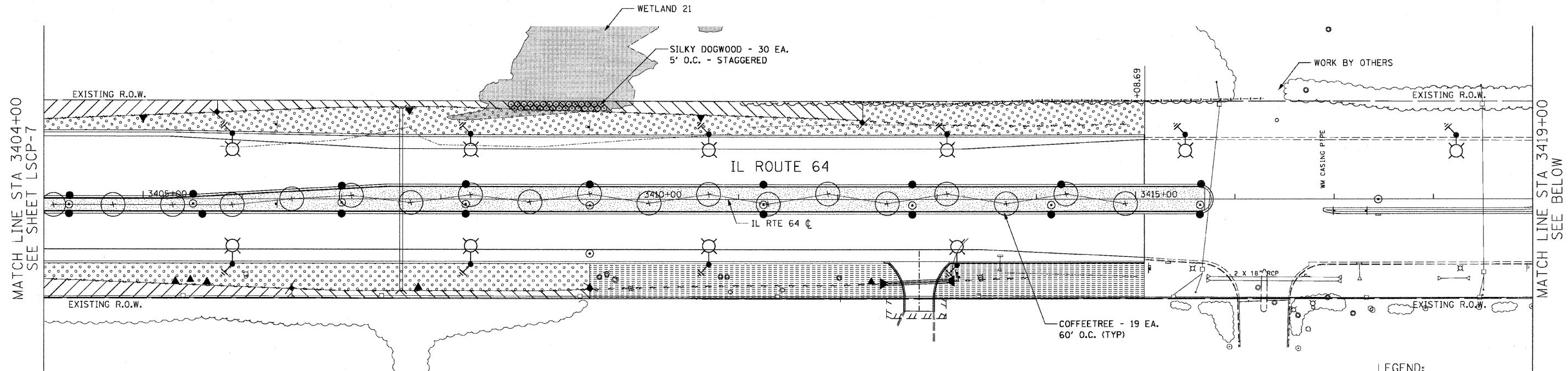

LEGEND:

- FURNISHING AND PLACING TOPSOIL, 4" AND SEEDING CLASS 2A EROSION CONTROL BLANKET
- FURNISHING AND PLACING TOPSOIL, 4" AND SODDING, SALT TOLERANT EROSION CONTROL BLANKET
- FURNISHING AND PLACING TOPSOIL, 24" AND SEEDING CLASS 2A EROSION CONTROL BLANKET
- COMPOST, 2" SEEDING CLASS 4 (PRAIRIE GRASS) EROSION CONTROL BLANKET
- COMPOST, 2" SEEDING CLASS 4B (MODIFIED) WETLAND MIX EROSION CONTROL BLANKET
- SELECTIVE MOWING STAKE WITH SIGN

MATCH LINE STA 3419+00 SEE ABOVE

MATCH LINE STA 3404+00 SEE SHEET LSCP-7

MATCH LINE STA 3419+00 SEE BELOW



REVISIONS	
NAME	DATE
S. LIPKIE	06/11

ILLINOIS DEPARTMENT OF TRANSPORTATION
 F.A.P. ROUTE 307 (ILLINOIS ROUTE 64)

LANDSCAPING PLAN
 IL ROUTE 64
 STA. 3404+00 TO STA. 3422+54

SCALE: VERT: NONE
 HORIZ: 1"=50'
 DATE: MAY 13, 2011
 DRAWN BY: RMG
 CHECKED BY: JWM

LSCP-8