

CIVIL ENGINEERING CONSULTANTS
RWIA
 Regina Webster & Associates, Inc.
 8619 W. Bryn Mawr Ave., Suite 602
 Chicago, IL 60631-3551
 773-283-2600 Fax: 773-283-2602
 www.RWIAengineers.com

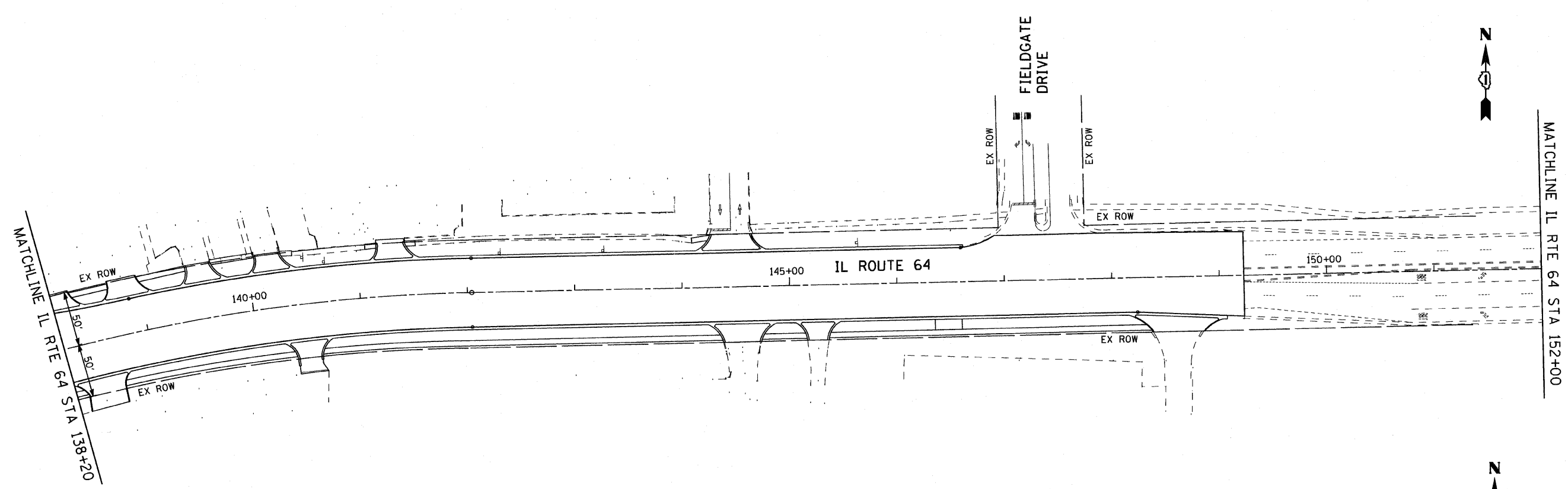

THE TRAFFIC SIGNAL CONTROL EQUIPMENT FOR THE TEMPORARY INTERCONNECT SHALL BE "ECONOLITE" TO MATCH THE EXISTING ADJACENT SYSTEM

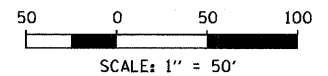
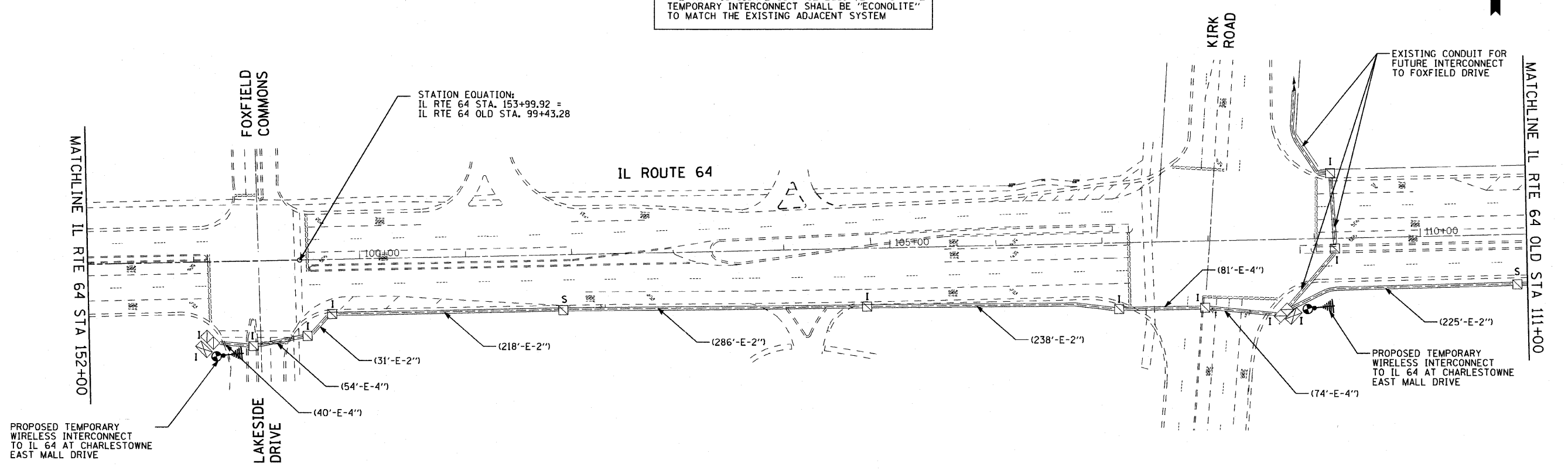

SHEET 2 OF 8

FILE NAME = #FILEL#	USER NAME = #USER#	DESIGNED - DW	REVISED -	STATE OF ILLINOIS DEPARTMENT OF TRANSPORTATION	TEMPORARY WIRELESS INTERCONNECT PLAN IL ROUTE 64 EAST OF DUNHAM ROAD TO WEST OF KIRK ROAD	F.A. RTE. 307	SECTION 130 R-2	COUNTY KANE	TOTAL SHEETS 647	SHEET NO. 386		
	PLOT SCALE = #SCALE#	DRAWN - DW	REVISED -			SCALE: 1"=50'-0"	SHEET NO. OF SHEETS STA. TO STA.	CONTRACT NO. 62410				
	PLOT DATE = #DATE#	CHECKED - JS	REVISED -			ILLINOIS FED. AID PROJECT						
		DATE -	REVISED -									