

F.A.P. RTE.	SECTION	COUNTY	TOTAL SHEETS	SHEET NO.
307	130 R-2	DUPAGE, KANE	647	390
STA. 3320+00		TO STA. 3344+00		
FED. ROAD DIST. NO.		ILLINOIS FED. AID PROJECT		
62410				

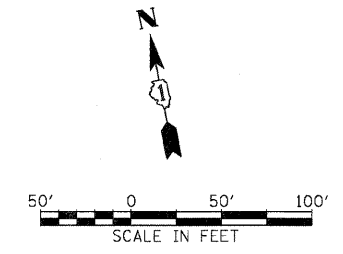

MATCH LINE STA. 3332+00
SEE ABOVE

MATCH LINE STA. 3344+00
SEE SHEET 4

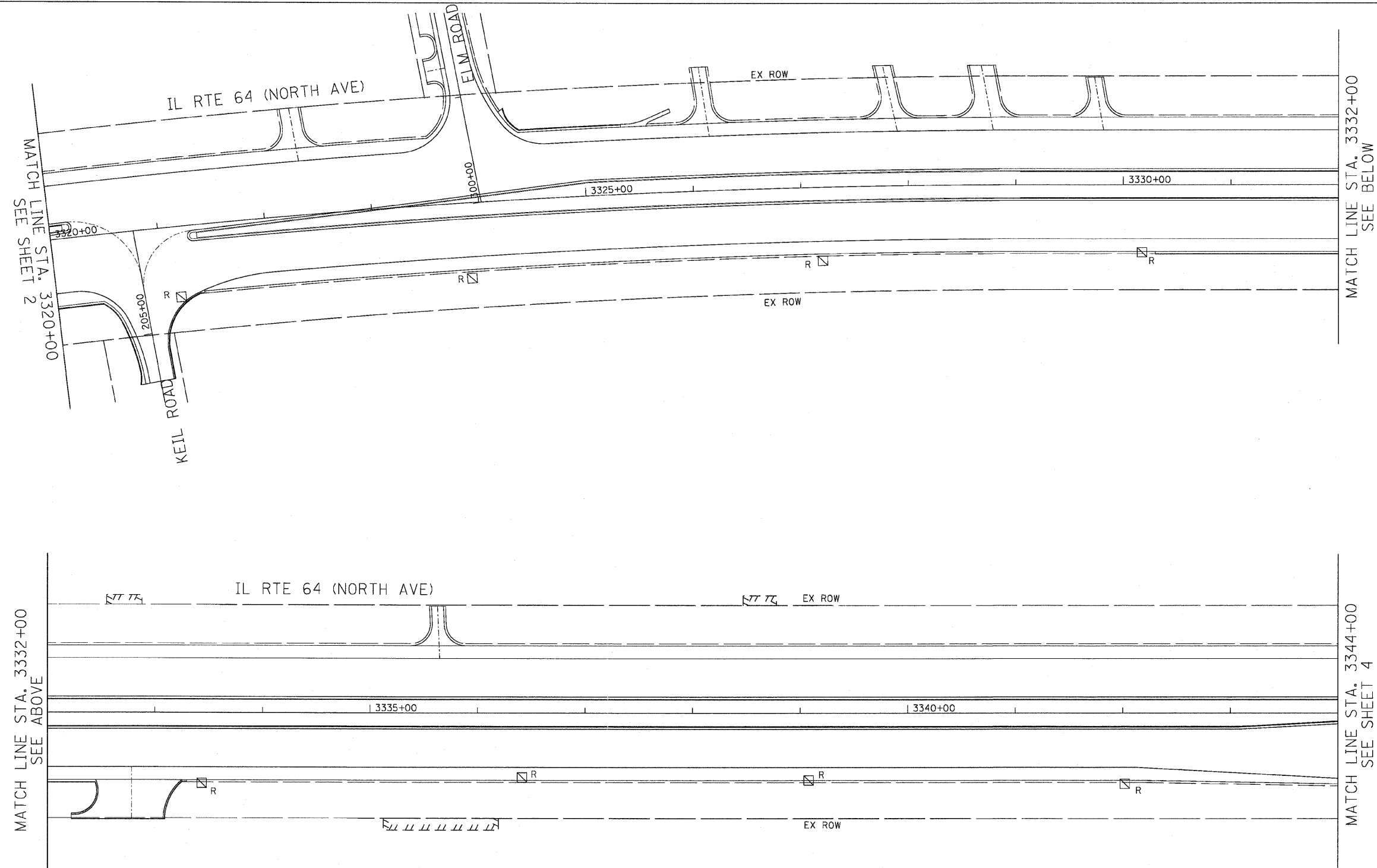

REVISIONS	
NAME	DATE

ILLINOIS DEPARTMENT OF TRANSPORTATION
 F.A.P. ROUTE 307 (ILLINOIS ROUTE 64)
 TEMPORARY INTERCONNECT PLAN
 AND INTERCONNECT REMOVAL PLAN
 IL ROUTE 64 (NORTH AVE)
 STA. 3320+00 TO STA. 3344+00