

F.A.P. RTE.	SECTION	COUNTY	TOTAL SHEETS	SHEET NO.
307	130 R-2	DUPAGE, KANE	647	421
STA.		TO STA.		
FED. ROAD DIST. NO.		ILLINOIS FED. AID PROJECT		

62410

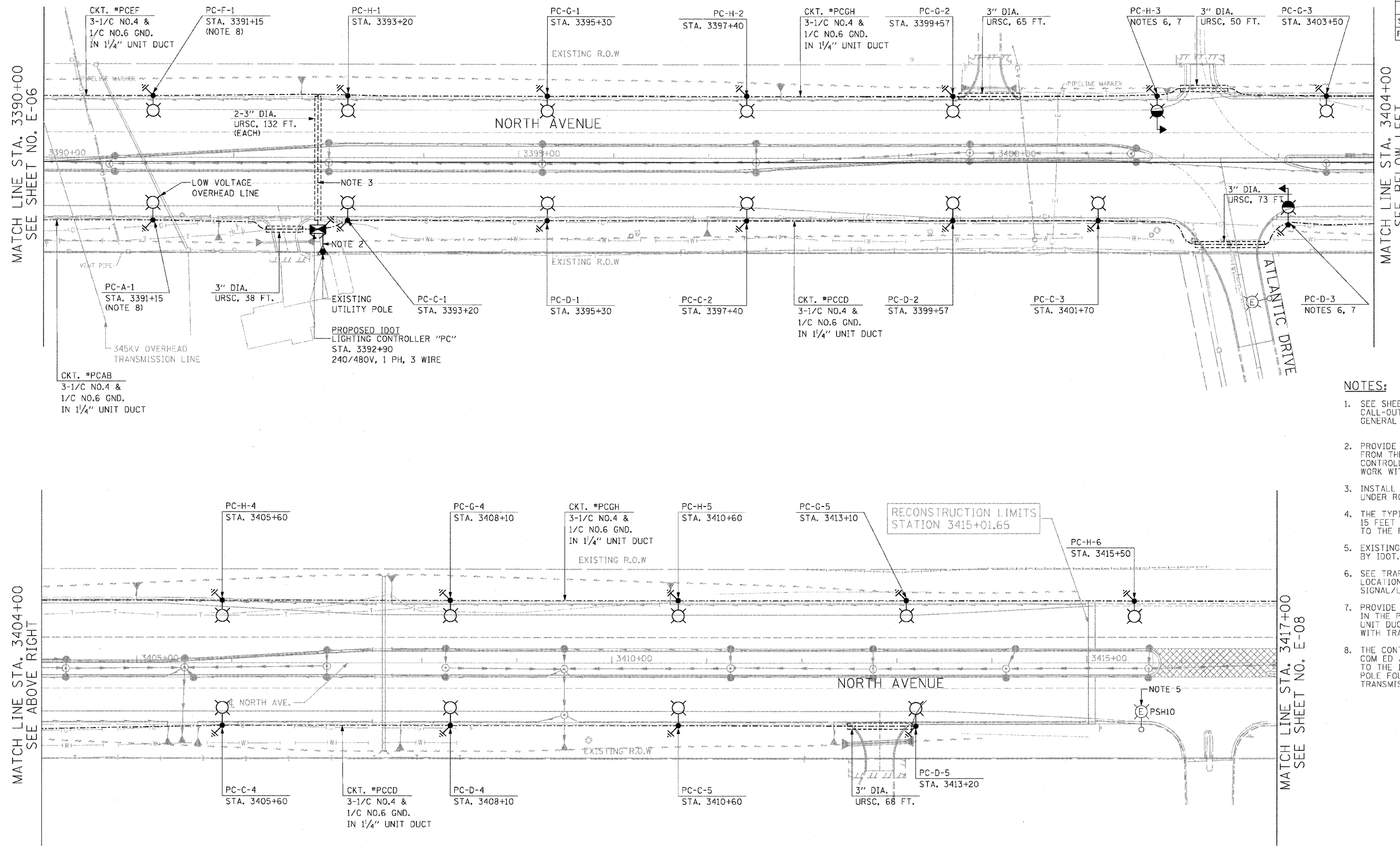

NOTES:

- SEE SHEET E-01 FOR ELECTRICAL SYMBOLS, CALL-OUT SAMPLES, ABBREVIATIONS AND GENERAL NOTES.
- PROVIDE 3# 350 KCMIL TYPE USE IN 4" URSC FROM THE UTILITY POLE TO THE LIGHTING CONTROLLER CABINET. COORDINATE ALL WORK WITH COMED.
- INSTALL ONE 1/4" UNIT DUCT PER URSC UNDER ROADWAY.
- THE TYPICAL LIGHT POLE SETBACK SHALL BE 15 FEET FROM THE EDGE OF THE PAVEMENT TO THE FACE OF LIGHT POLE.
- EXISTING LIGHTING UNIT OWNED AND OPERATED BY IDOT.
- SEE TRAFFIC SIGNAL PLANS FOR THE EXACT LOCATIONS OF COMBINATION TRAFFIC SIGNAL/LIGHT POLES.
- PROVIDE 2 - 3/2" PVC CONDUIT SLEEVES IN THE POLE FOUNDATION FOR LIGHTING UNIT DUCTS. COORDINATE ALL WORK WITH TRAFFIC SIGNAL INSTALLATION.
- THE CONTRACTOR SHALL CONTACT COM ED AND OBTAIN APPROVAL PRIOR TO THE INSTALLATION OF LIGHT POLE FOUNDATIONS NEAR THE TRANSMISSION LINES.

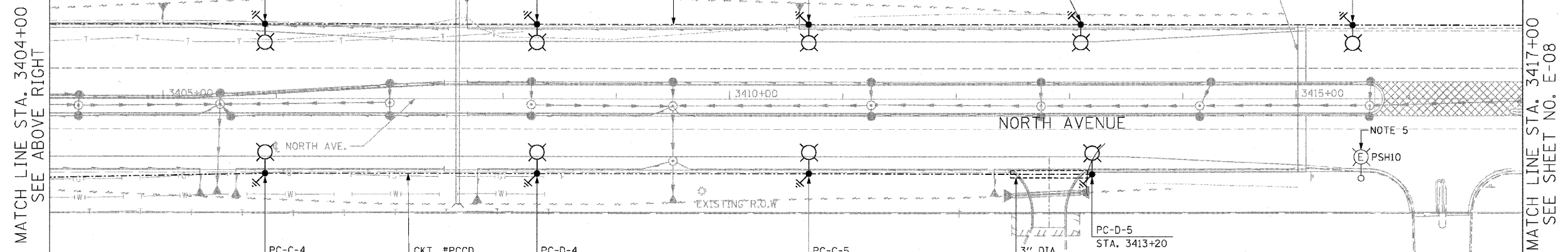

E-07

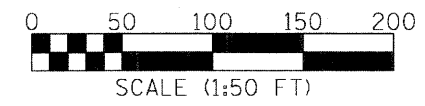

REVISIONS	
NAME	DATE

ILLINOIS DEPARTMENT OF TRANSPORTATION
 F.A.P. ROUTE 307 (ILLINOIS ROUTE 64)

ROADWAY LIGHTING PLAN
 STA. 3390+00 TO STA. 3417+00

SCALE: 1" = 50'
 DATE: MAY 13, 2011
 DRAWN BY: HR
 CHECKED BY: JPC