

F.A.P. RTE.	SECTION	COUNTY	TOTAL SHEETS	SHEET NO.
307	130 R-2	DUPAGE, KANE	647	422
STA.		TO STA.		
FED. ROAD DIST. NO.		ILLINOIS FED. AID PROJECT		
		62410		

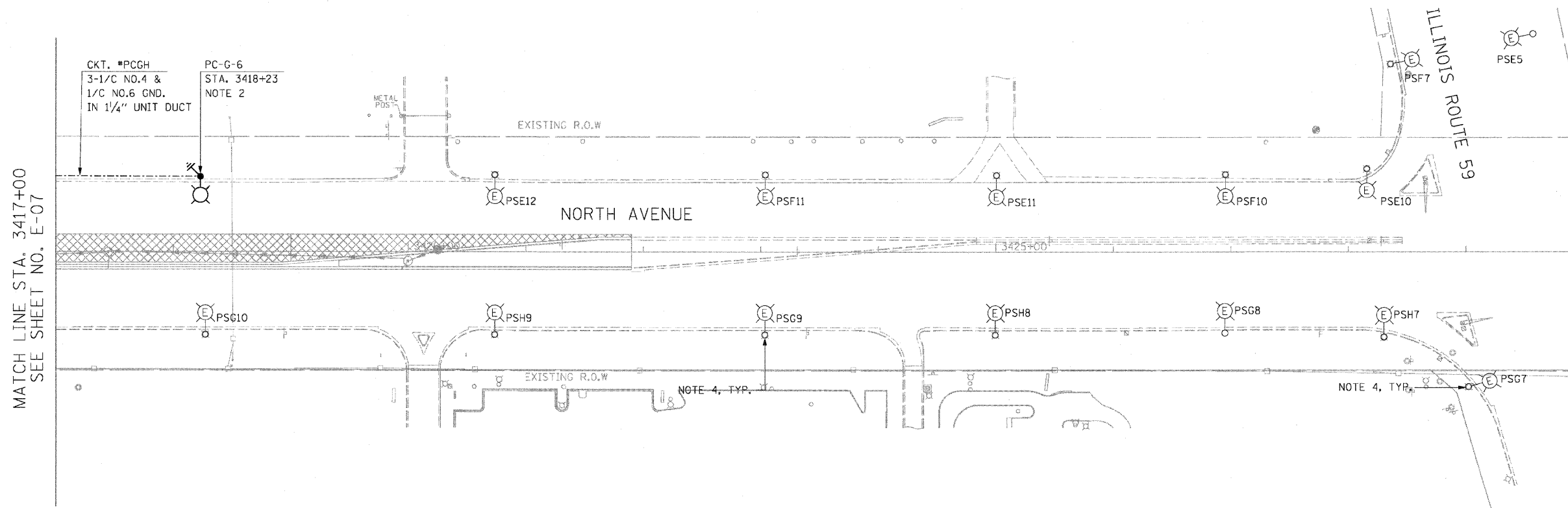

NOTES:

- SEE SHEET E-01 FOR ELECTRICAL SYMBOLS, CALL-OUT SAMPLES, ABBREVIATIONS AND GENERAL NOTES.
- OFFSET LIGHT POLE 15 FEET FROM EDGE OF PAVEMENT TO THE FACE OF LIGHT POLE.
- THE TYPICAL LIGHT POLE SETBACK SHALL BE 3 FEET FROM BACK OF CURB TO THE FACE OF LIGHT POLE.
- EXISTING LIGHTING UNIT OWNED AND OPERATED BY IDOT. INSTALLED IN CONTRACT 82634 IN 2002.
- EXISTING LIGHTING UNIT OWNED AND OPERATED BY CITY OF ST. CHARLES.
- PULL EXISTING LIGHTING CIRCUITS TO THE NEAREST EXISTING LIGHTING UNIT TO REMAIN. COORDINATE ALL WORK WITH CITY OF ST. CHARLES.

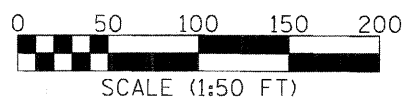
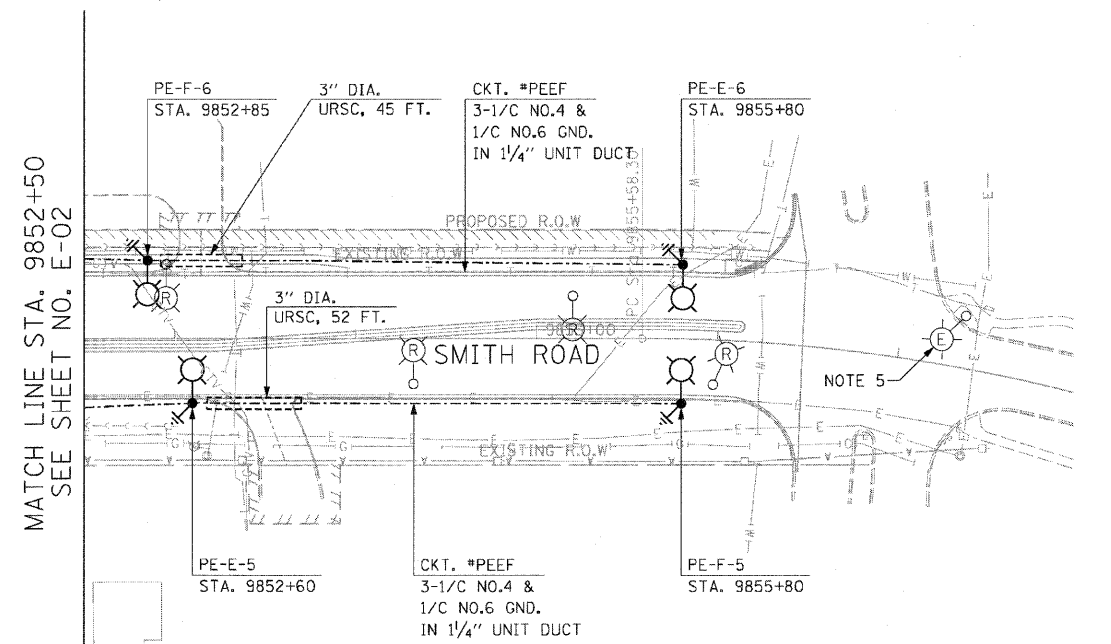
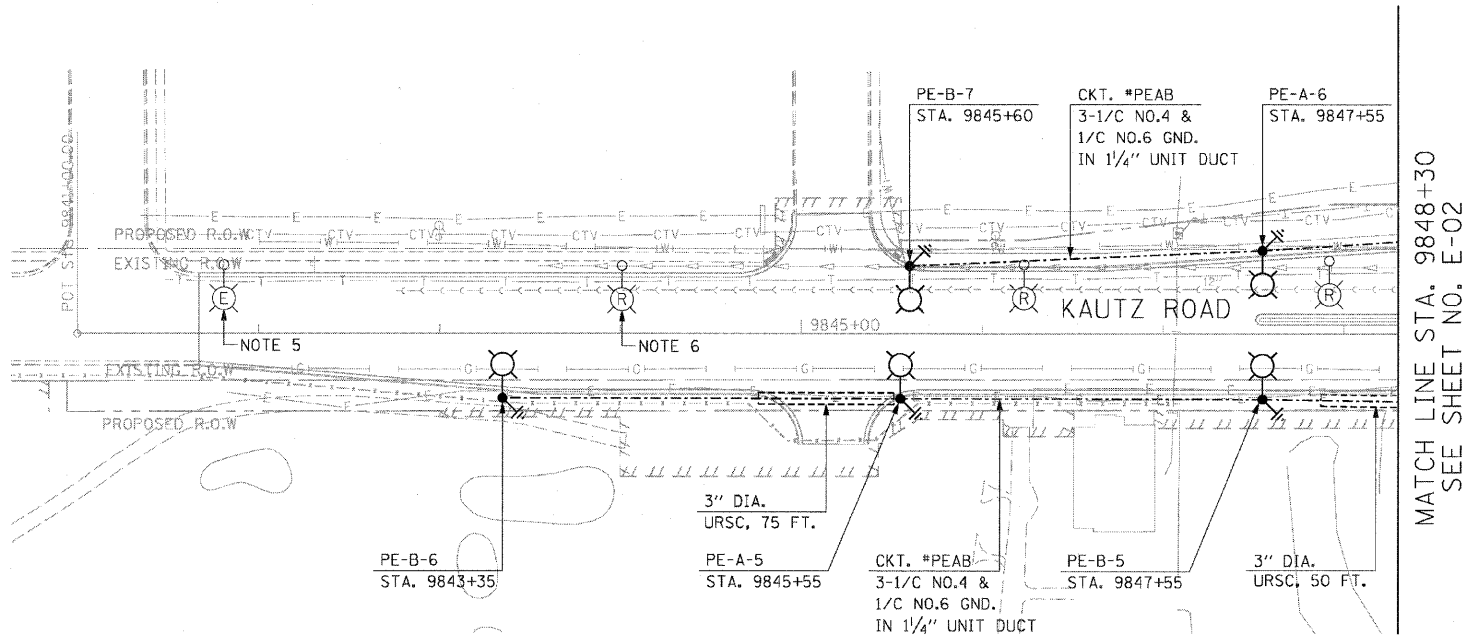

REVISIONS	
NAME	DATE

ILLINOIS DEPARTMENT OF TRANSPORTATION
 F.A.P. ROUTE 307 (ILLINOIS ROUTE 64)

ROADWAY LIGHTING PLANS
 STA. 3417+00 TO STA. 3425+00
 STA. 9842+50 TO STA. 9848+50
 STA. 9850+50 TO STA. 9856+83.72

SCALE: 1" = 50'
 DATE: MAY 13, 2011

DRAWN BY: HR
 CHECKED BY: JPC

E-08