

F.A.P. RTE.	SECTION	COUNTY	TOTAL SHEETS	SHEET NO.
307	130 R-2	DUPAGE, KANE	647	432
STA.	TO STA.			
FED. ROAD DIST. NO.	ILLINOIS FED. AID PROJECT		62410	

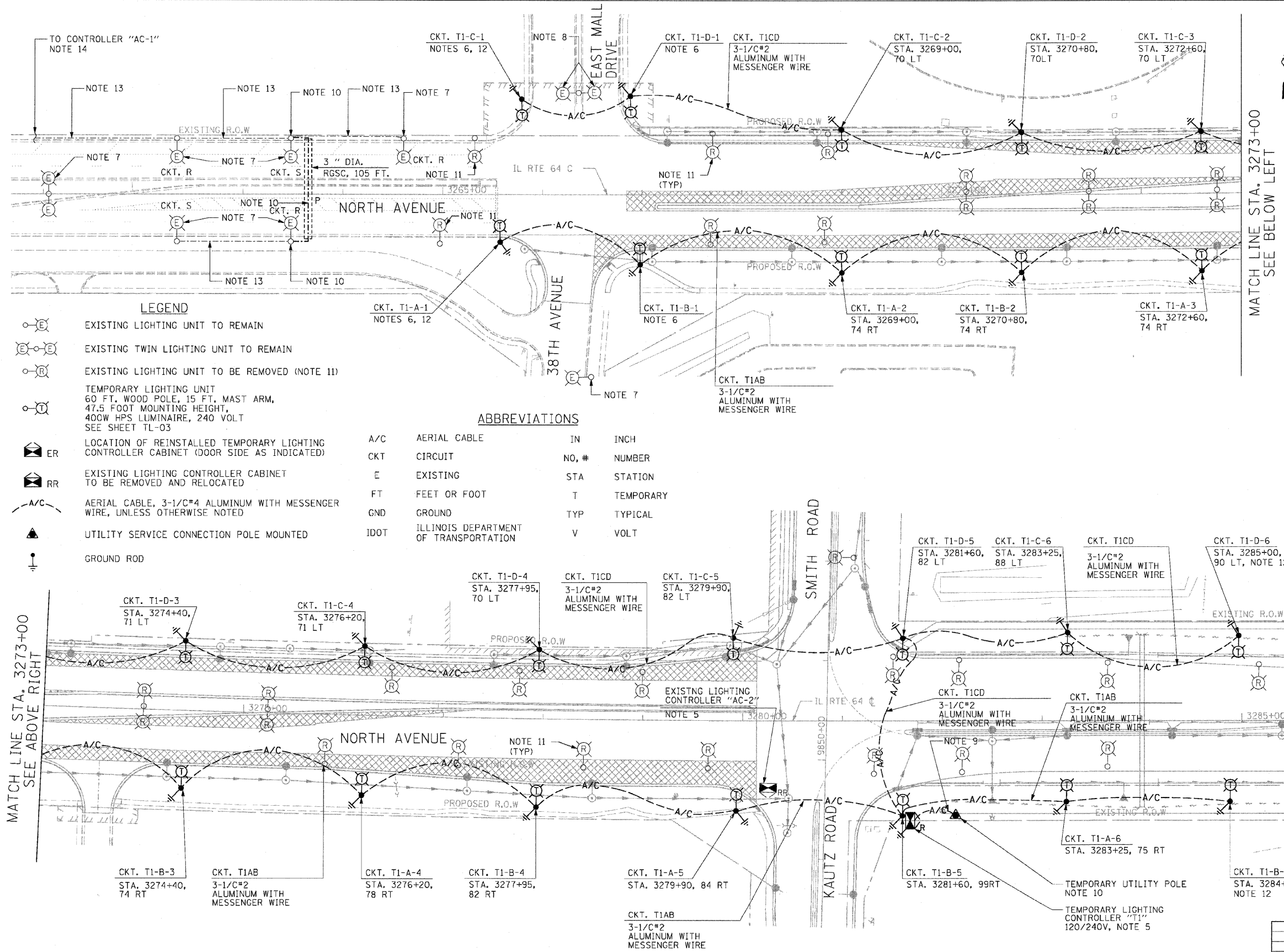

- NOTES:**
- CONTRACTOR SHALL ASSURE THAT ALL TRAVELED PAVEMENT IS LIGHTED DURING NORMAL NIGHTTIME HOURS. THE EXISTING LIGHTING SYSTEM SHALL REMAIN IN OPERATION UNTIL THE TEMPORARY LIGHTING SYSTEM HAS BEEN INSTALLED, ENERGIZED, TESTED, ADJUSTED, AND ACCEPTED BY IDOT.
 - PROVIDE 20 FEET OF SLACK CABLE AT EACH WOOD POLE TO ALLOW FOR THE RELOCATION/ADJUSTMENT OF THE LIGHTING UNITS AS REQUIRED DURING CONSTRUCTION. THE SLACK CABLE SHALL BE LOOPEL AND ANCHORED TO THE TOP OF EACH POLE. 20 FEET OF SLACK CABLE WILL BE MEASURED FOR PAYMENT AT EACH WOOD POLE.
 - CONTRACTOR SHALL BE RESPONSIBLE FOR IMMEDIATELY REPAIRING ANY DAMAGE THAT MAY OCCUR TO THE EXISTING LIGHTING SYSTEM DURING CONSTRUCTION. THE REPAIRS SHALL BE MADE TO THE SATISFACTION OF IDOT AND AT NO ADDITIONAL COST TO IDOT.
 - MINIMUM HEIGHT OF AERIAL CABLE ABOVE GROUND MUST COMPLY WITH NEC ARTICLE 225.18(4).
 - RELOCATE EXISTING LIGHTING CONTROLLER CABINET "AC-2" TO THE TEMPORARY LOCATION AND LABEL CABINET AS "T1". CONTRACTOR SHALL PROVIDE ALL LABOR AND EQUIPMENT NECESSARY TO MOUNT THE TEMPORARY LIGHTING CONTROLLER CABINET "T1" TO THE WOOD POLE. CONTRACTOR SHALL INSTALL THE TEMPORARY ELECTRICAL SERVICE IN ACCORDANCE WITH NEC AND IDOT REQUIREMENTS. SEE SHEET TL-02 FOR TEMPORARY LIGHTING CONTROLLER CABINET POWER FEED DETAILS. COORDINATE WORK WITH THE CITY OF ST. CHARLES.
 - MOUNT THE TEMPORARY LUMINAIRES AND MAST ARMS ON THE TEMPORARY TRAFFIC SIGNAL WOOD POLES. SEE TRAFFIC SIGNAL PLANS FOR LOCATIONS OF TEMPORARY TRAFFIC SIGNAL WOOD POLES. COORDINATE THE ELECTRICAL WORK WITH THE TEMPORARY TRAFFIC SIGNAL INSTALLATION.
 - EXISTING LIGHTING UNIT OWNED AND OPERATED BY CITY OF ST. CHARLES, TO REMAIN.
 - EXISTING PARKING LOT LIGHTING UNIT OWNED AND OPERATED BY CHARLESTOWNE MALL, TO REMAIN.
 - TEMPORARY ELECTRIC SERVICE, 100 AMPERE, 120/240V, 1 PHASE, 3 WIRE, 3-1/C *1/0 ALUMINUM WITH MESSENGER WIRE, GROUNDED UTILITY SERVICE.
 - INTERCEPT EXISTING LIGHTING CIRCUITS AND CONNECT TO THE EXISTING LIGHTING CIRCUITS ON OPPOSITE SIDE OF ROADWAY. PULL 4-1/C #6 & 1-1/C #6 GND, XLP, IN 3" RGSC. DISCONNECT CIRCUITS FROM THE EXISTING LIGHTING CONTROLLER "AC-2". THIS WORK SHALL BE PERFORMED BEFORE INSTALLATION OF THE TEMPORARY LIGHTING SYSTEM. COORDINATE ALL WORK WITH CITY OF ST. CHARLES.
 - CONTRACTOR SHALL REMOVE EXISTING LIGHTING UNITS AFTER INSTALLATION, OPERATION, AND SUCCESSFUL TESTING OF THE TEMPORARY LIGHTING SYSTEM. CONTRACTOR SHALL DELIVER THE EXISTING LIGHTING UNITS TO BE REMOVED TO THE CITY OF ST. CHARLES.
 - SEE SHEET TL-03 FOR TEMPORARY WOOD END POLE INSTALLATION DETAIL.
 - EXISTING UNIT DUCT, CIRCUITS R AND S, TO REMAIN.
 - THE EXISTING LIGHTING CONTROLLER "AC-1" THAT FEEDS CIRCUITS R AND S IS LOCATED AT THE NORTHWEST CORNER OF WEST MALL DRIVE AND ILLINOIS ROUTE 64. EXTEND LIGHTING CIRCUITS R AND S TO EXISTING LIGHTING UNITS AS SHOWN.

- LEGEND**
- EXISTING LIGHTING UNIT TO REMAIN
 - EXISTING TWIN LIGHTING UNIT TO REMAIN
 - EXISTING LIGHTING UNIT TO BE REMOVED (NOTE 11)
 - TEMPORARY LIGHTING UNIT
60 FT. WOOD POLE, 15 FT. MAST ARM,
47.5 FOOT MOUNTING HEIGHT,
400W HPS LUMINAIRE, 240 VOLT
SEE SHEET TL-03
 - LOCATION OF REINSTALLED TEMPORARY LIGHTING CONTROLLER CABINET (DOOR SIDE AS INDICATED)
 - EXISTING LIGHTING CONTROLLER CABINET TO BE REMOVED AND RELOCATED
 - AERIAL CABLE, 3-1/C*4 ALUMINUM WITH MESSENGER WIRE, UNLESS OTHERWISE NOTED
 - UTILITY SERVICE CONNECTION POLE MOUNTED
 - GROUND ROD

ABBREVIATIONS

A/C	AERIAL CABLE	IN	INCH
CKT	CIRCUIT	NO, #	NUMBER
E	EXISTING	STA	STATION
FT	FEET OR FOOT	T	TEMPORARY
GND	GROUND	TYP	TYPICAL
IDOT	ILLINOIS DEPARTMENT OF TRANSPORTATION	V	VOLT

MATCH LINE STA. 3273+00
SEE ABOVE RIGHT

MATCH LINE STA. 3273+00
SEE BELOW LEFT

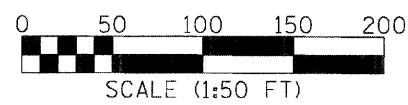

REVISIONS	
NAME	DATE

ILLINOIS DEPARTMENT OF TRANSPORTATION
 F.A.P. ROUTE 307 (ILLINOIS ROUTE 64)

TEMPORARY ROADWAY LIGHTING PLAN
 STA. 3262+00 TO STA. 3285+00

SCALE: 1" = 50'
 DATE: NOVEMBER 1, 2011

DRAWN BY: HR
 CHECKED BY: JPC

TL-01