

STATE OF ILLINOIS
 DEPARTMENT OF TRANSPORTATION

F.A.P. RTE.	SECTION	COUNTY	TOTAL SHEETS	SHEET NO.
307	130 R-2	DUPAGE, KANE	647	449
STA. 3356+37.74		TO STA. 3359+24.72		
ILLINOIS		FED. AID PROJECT		

62410

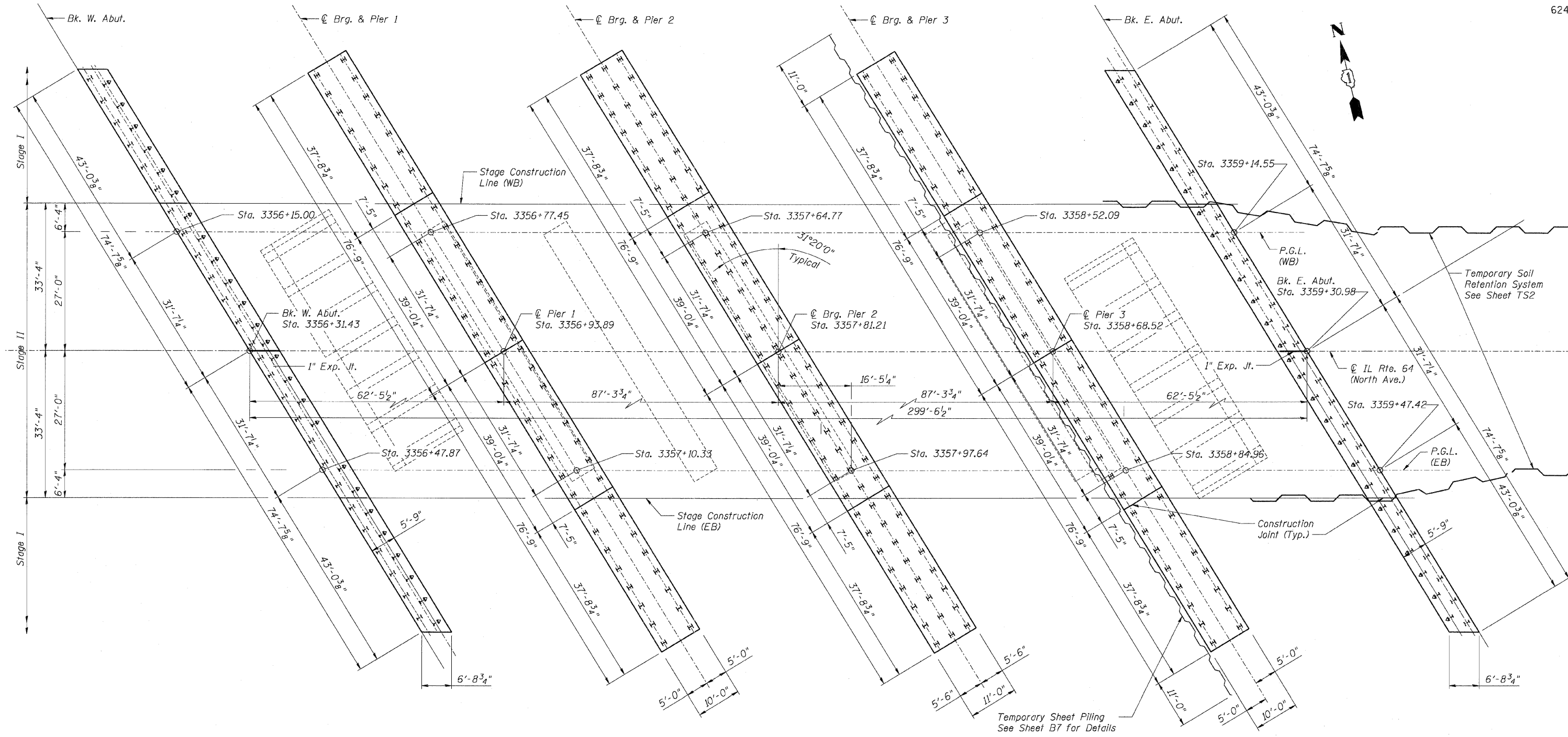

FOOTING LAYOUT

- NOTES:**
1. For General Plan and Elevation see Sheet B1.
 2. For Temporary Sheet Piling Details see Sheet B7.
 3. For Abutment Details see Sheets B37 thru B41.
 4. For Pier Details see Sheets B42 thru B50.

REVISIONS	
NAME	DATE

Sheet B6 of 56

F.A.P. ROUTE 307 ILLINOIS ROUTE 64
 (NORTH AVENUE)
 OVER E.J.&E. AND U.P. R.R.
 SUBSTRUCTURE LAYOUT

STRUCTURE NUMBER 022-0190
 FAP 307 SECTION 130 R-2
 DUPAGE COUNTY
 STA. 3357+81.21

SCALE: None
 DATE: MAY 13, 2011

DRAWN BY: CHD
 CHECKED BY: RDP

