

STATE OF ILLINOIS
 DEPARTMENT OF TRANSPORTATION

F.A.P. RTE.	SECTION	COUNTY	TOTAL SHEETS	SHEET NO.
307	130 R-2	DUPAGE, KANE	647	465
STA. 3356+37.74		TO STA. 3359+24.72		
FED. ROAD DIST. NO.		ILLINOIS FED. AID PROJECT		

62410

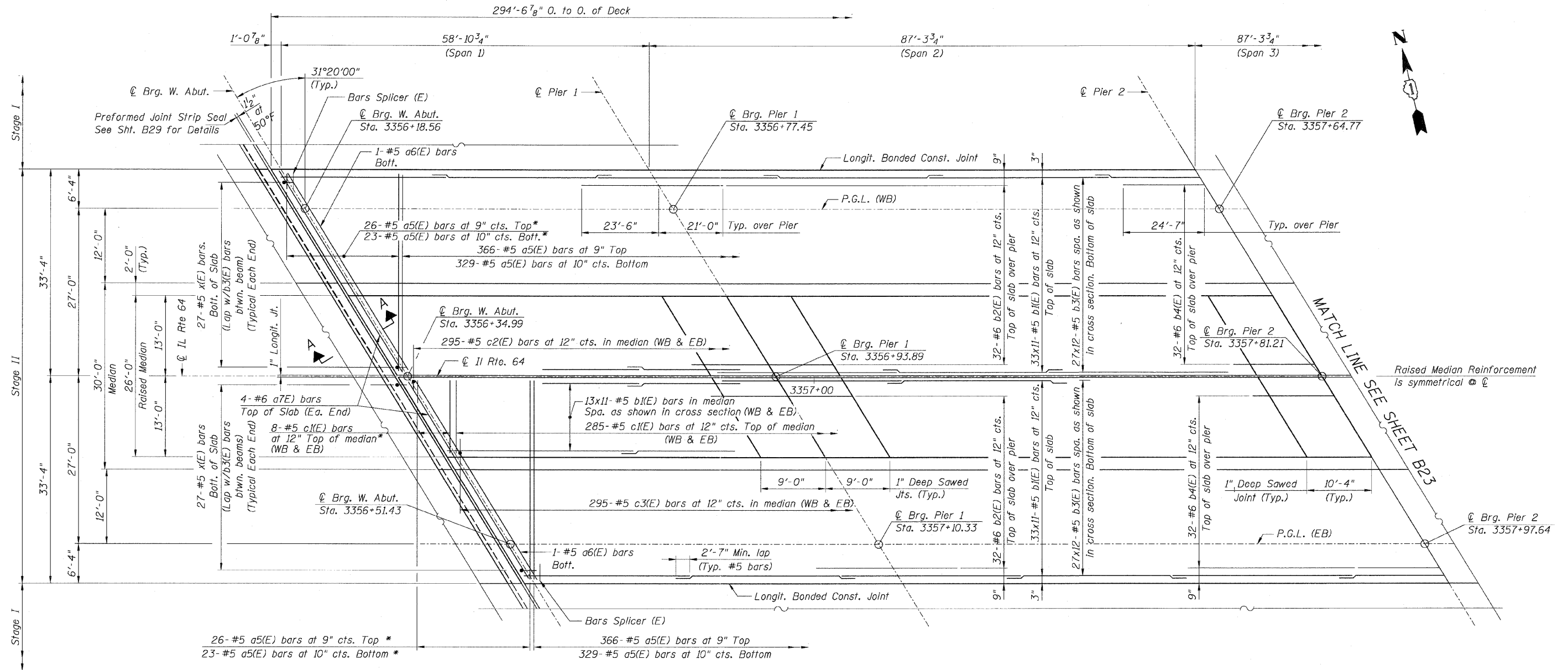

* Order a5(E) and c1(E) bars full length. Cut to fit skew and use remainder of bars in opposite end.

SPANS 1 & 2
 Stage II - EB & WB

NOTES:

1. Bars indicated thus 26x7-#5 etc. indicates 26 lines of bars with 7 lengths per line.
2. For Typical Sections, Details and Bill of Material, see Sheet B24.
3. For Section A-A see Sheet B25.
4. Dimensions are based on Rolled Rail Strip Seal Joint. If the Contractor elects to use the Welded Rail Strip Seal joint deck dimensions may require adjustment to satisfy the details on Base Sheet E-J-SSJ.

Sheet B22 of 56

REVISIONS	
NAME	DATE

F.A.P. ROUTE 307 ILLINOIS ROUTE 64
 (NORTH AVENUE)
 OVER E.J.&E. AND U.P. R.R.
 DECK PLAN
 SPANS 1 & 2 - STAGE II
 STRUCTURE NUMBER 022-0190
 FAP 307 SECTION 130 R-2
 DUPAGE COUNTY
 STA. 3357+81.21

SCALE: None
 DATE: MAY 13, 2011
 DRAWN BY: CHD
 CHECKED BY: RDP

