

STATE OF ILLINOIS  
 DEPARTMENT OF TRANSPORTATION

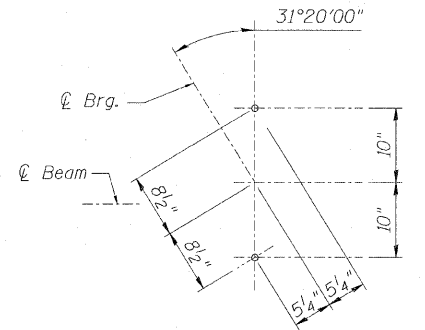

ANCHOR BOLT LOCATION

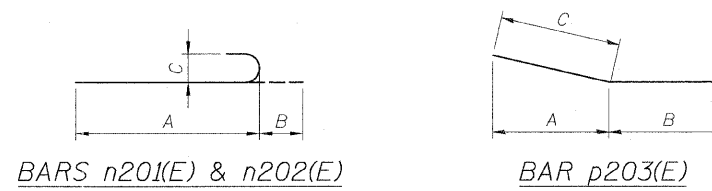

BARS n201(E) & n202(E)

BAR p203(E)

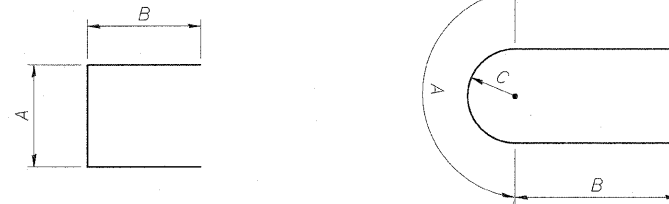

BARS s201(E), s202(E), s203(E)  
 u202(E), u203(E) & u205(E)

BARS u201(E) & u204(E)

A, B & C DIMENSIONS

Bar	A	B	C
n201(E)	9'-3"	11"	8"
p203(E)	4'-4 5/8"	4'-6"	4'-6"
s201(E)	2'-5"	2'-8"	-
s202(E)	3'-2"	2'-8"	-
s203(E)	3'-2"	7'-2"	-
u201(E)	4'-11 1/2"	3'-10"	1'-7"
u202(E)	3'-2"	3'-10"	-
u203(E)	3'-2"	1'-8"	-
u204(E)	4'-11 1/2"	3'-10"	1'-7"
u205(E)	3'-2"	3'-10"	-

WB PIER 2  
 BILL OF MATERIAL

Bar	No.	Size	Length	Shape
h201(E)	10	#6	30'-8"	—
h202(E)	4	#6	30'-8"	—
h203(E)	10	#6	38'-8"	—
h204(E)	4	#6	38'-8"	—
n201(E)	84	#8	10'-2"	C
n202(E)	3	#8	7'-11"	C
p201(E)	6	#10	34'-10"	—
p202(E)	6	#10	32'-1"	—
p203(E)	6	#10	9'-0"	—
p204(E)	8	#6	34'-10"	—
p205(E)	6	#6	18'-10"	—
p206(E)	12	#10	38'-8"	—
p207(E)	8	#6	38'-8"	—
p208(E)	6	#6	16'-4"	—
p209(E)	6	#6	24'-8"	—
s201(E)	616	#4	7'-9"	C
s202(E)	72	#6	8'-6"	C
s203(E)	72	#8	17'-6"	C
sp201(E)	6	#4	19'-6"	WWWWWWW
t201(E)	79	#6	9'-8"	—
t202(E)	93	#10	9'-8"	—
u201(E)	6	#6	12'-8"	C
u202(E)	7	#6	10'-10"	C
u203(E)	62	#5	6'-6"	C
u204(E)	5	#6	12'-8"	C
u205(E)	5	#6	10'-10"	C
v201(E)	84	#8	22'-3"	—
w201(E)	14	#6	37'-5"	—
w202(E)	14	#6	38'-8"	—
w203(E)	14	#10	37'-5"	—
w204(E)	14	#10	38'-8"	—
Item	Unit	Quantity		
Reinforcement Bars, Epoxy Coated	Pound	35,080		
Concrete Structures	Cu Yd	209.9		
Structure Excavation	Cu Yd	175		
Furnishing Steel Piles HP14x73	Foot	2,115		
Driving Piles	Foot	2,115		
Test Pile Steel HP14x73	Each	1		
Pile Shoes	Each	48		
Concrete Encasement	Cu Yd	25.4		

\* Length is height of spiral

F.A.P. RTE.	SECTION	COUNTY	TOTAL SHEETS	SHEET NO.
307	130 R-2	DUPAGE, KANE	647	490
STA. 3356+37.74		TO STA. 3359+24.72		
FED. ROAD DIST. NO.		ILLINOIS FED. AID PROJECT		

62410

EB PIER 2  
 BILL OF MATERIAL

Bar	No.	Size	Length	Shape
h201(E)	10	#6	30'-8"	—
h202(E)	4	#6	30'-8"	—
h203(E)	10	#6	38'-8"	—
h204(E)	4	#6	38'-8"	—
n201(E)	84	#8	10'-2"	C
n202(E)	3	#8	7'-11"	C
p201(E)	6	#10	34'-10"	—
p202(E)	6	#10	32'-1"	—
p203(E)	6	#10	9'-0"	—
p204(E)	8	#6	34'-10"	—
p205(E)	6	#6	18'-10"	—
p206(E)	12	#10	38'-8"	—
p207(E)	8	#6	38'-8"	—
p208(E)	6	#6	16'-4"	—
p209(E)	6	#6	24'-8"	—
s201(E)	616	#4	7'-9"	C
s202(E)	72	#6	8'-6"	C
s203(E)	72	#8	17'-6"	C
sp201(E)	6	#4	19'-6"	WWWWWWW
t201(E)	79	#6	9'-8"	—
t202(E)	93	#10	9'-8"	—
u201(E)	6	#6	12'-8"	C
u202(E)	7	#6	10'-10"	C
u203(E)	55	#5	6'-6"	C
u204(E)	5	#6	12'-8"	C
u205(E)	5	#6	10'-10"	C
v201(E)	84	#8	22'-3"	—
w201(E)	14	#6	37'-5"	—
w202(E)	14	#6	38'-8"	—
w203(E)	14	#10	37'-5"	—
w204(E)	14	#10	38'-8"	—
Item	Unit	Quantity		
Reinforcement Bars, Epoxy Coated	Pound	35,220		
Concrete Structures	Cu Yd	209.9		
Structure Excavation	Cu Yd	175		
Furnishing Steel Piles HP14x73	Foot	2,160		
Driving Piles	Foot	2,160		
Test Pile Steel HP14x73	Each	0		
Pile Shoes	Each	48		
Concrete Encasement	Cu Yd	25.4		

NOTES:

- Cast steps monolithically with cap.
- Space cap reinforcement to miss anchor bolts.
- Work sheets B45 thru B47 together.

Sheet B47 of 56

REVISIONS	
NAME	DATE

F.A.P. ROUTE 307 ILLINOIS ROUTE 64  
 (NORTH AVENUE)  
 OVER E.J.&E. AND U.P. R.R.  
 PIER 2  
 SECTIONS & DETAILS  
 STRUCTURE NUMBER 022-0190  
 FAP SECTION 130 R-2  
 DUPAGE COUNTY  
 STA. 3357+81.21

SCALE: None DRAWN BY: CHD  
 DATE: NOVEMBER 1, 2011 CHECKED BY: MJP

