

STATE OF ILLINOIS
 DEPARTMENT OF TRANSPORTATION

F.A.P. RTE.	SECTION	COUNTY	TOTAL SHEETS	SHEET NO.
307	130 R-2	DUPAGE, KANE	647	508
STA. 3356+37.74		TO STA. 3359+24.72		
FED. ROAD DIST. NO.		ILLINOIS FED. AID PROJECT		

62410

BILL OF MATERIAL

Bar	No.	Size	Length	Shape	
a1(E)	890	#5	8'-7"	[Shape]	
a2(E)	890	#5	7'-6"	[Shape]	
a3(E)	6	#6	4'-9"	[Shape]	
a4(E)	48	#5	4'-8"	[Shape]	
a5(E)	2	#5	6'-6"	[Shape]	
a6(E)	4	#5	6'-5"	[Shape]	
a7(E)	6	#6	7'-11"	[Shape]	
b1(E)	306	#5	33'-8"	[Shape]	
b2(E)	34	#5	32'-3"	[Shape]	
d1(E)	894	#5	5'-7"	[Shape]	
d2(E)	894	#5	6'-2"	[Shape]	
d3(E)	298	#6	2'-6"	[Shape]	
d4(E)	10	#6	8'-11"	[Shape]	
d5(E)	6	#6	4'-5"	[Shape]	
e1(E)	133	#4	29'-6"	[Shape]	
e2(E)	18	#4	32'-1"	[Shape]	
e3(E)	18	#8	34'-5"	[Shape]	
e5(E)	7	#4	22'-6"	[Shape]	
e6(E)	2	#4	28'-4"	[Shape]	
e7(E)	2	#8	30'-1"	[Shape]	
Item				Unit	Quantity
Reinforcement Bars, Epoxy Coated				Pound	44,420

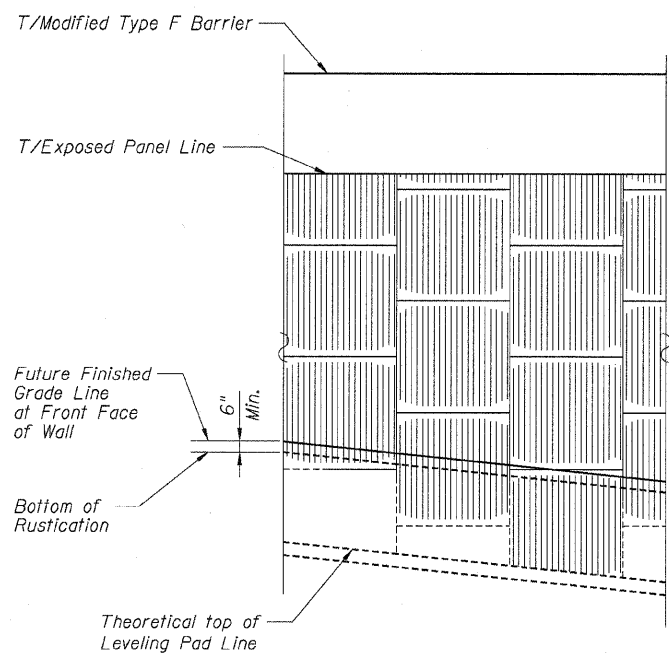

ELEVATION
 TYPICAL ARCHITECTURAL FINISH

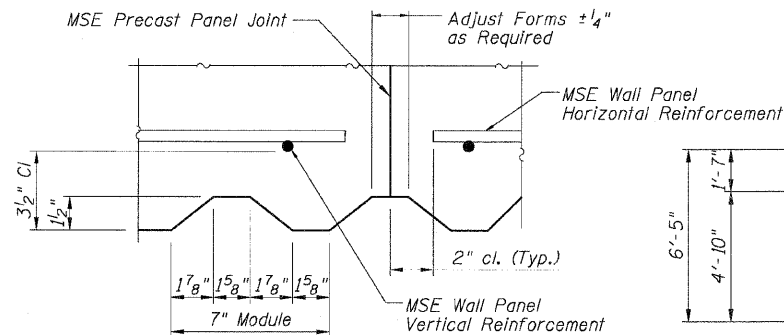

MSE WALL PANEL FLUTE DETAIL
 Full Height of Wall

CUTTING DIAGRAM
 BAR a6(E)

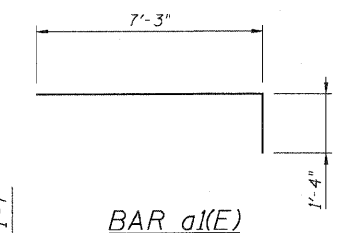

BAR a1(E)

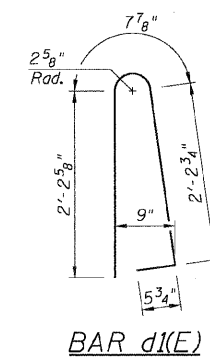

BAR d1(E)

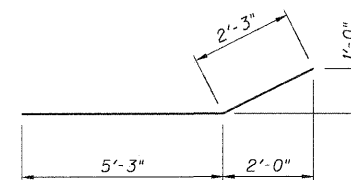

BAR a2(E)

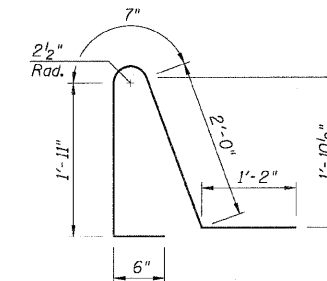

BAR d2(E)

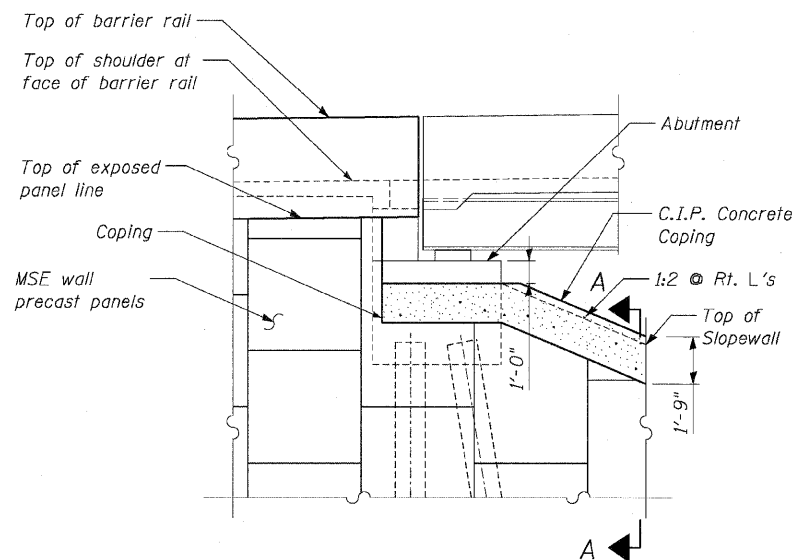

DETAIL 1
 (Looking North)

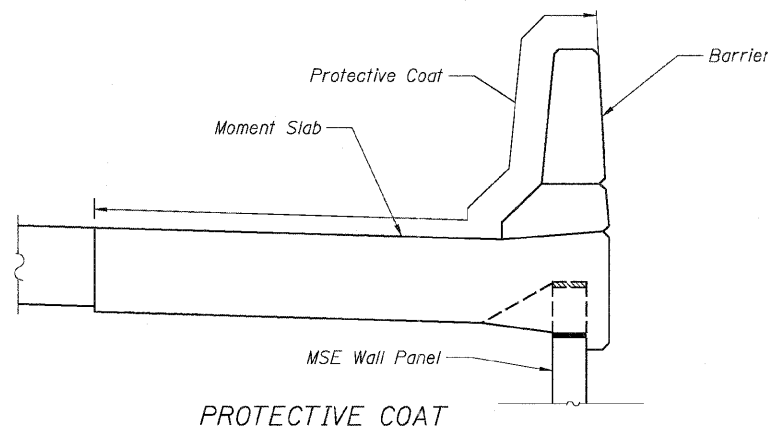

PROTECTIVE COAT

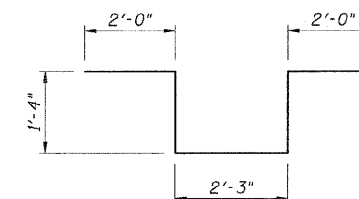

BAR d4(E)

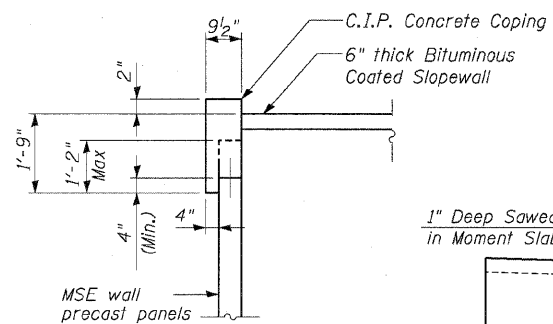

SECTION A-A

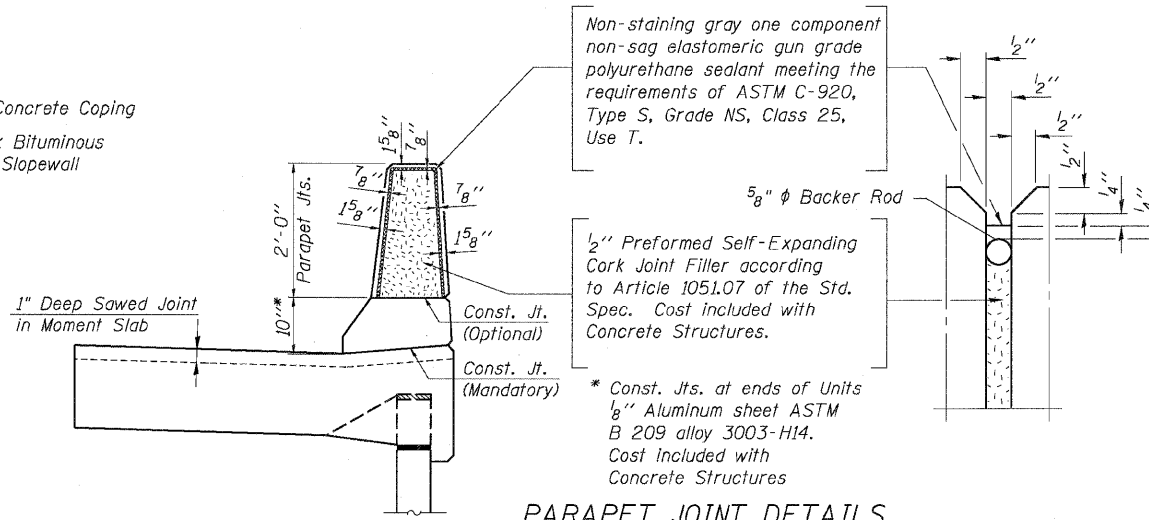

PARAPET JOINT DETAILS

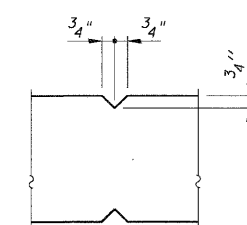

3/4" V-GROOVED JOINT DETAIL

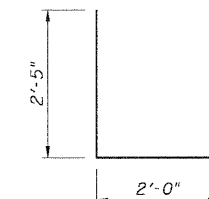

BAR d5(E)

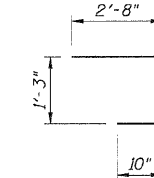

BAR a3(E)

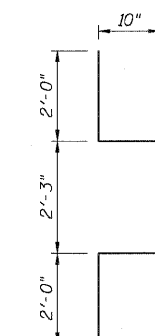

BAR a7(E)

NOTES:

1. For General Notes, see Sheet NW2.

REVISIONS	
NAME	DATE

F.A.P. ROUTE 307 ILLINOIS ROUTE 64
 (NORTH AVENUE)
 OVER E.J.&E. AND U.P. R.R.
 REINFORCEMENT DETAILS
 AND BILL OF MATERIAL
 STRUCTURE NUMBER 022-W027
 FAP 307 SECTION 130 R-2
 DUPAGE COUNTY
 STA. 3349+70.04 TO 3356+08.49
 SCALE: None
 DATE: MAY 13, 2011

Sheet NW9 of 9

DRAWN BY: MRK
 CHECKED BY: MJP

