

STATE OF ILLINOIS  
 DEPARTMENT OF TRANSPORTATION

F.A.P. RTE.	SECTION	COUNTY	TOTAL SHEETS	SHEET NO.
307	130 R-2	DUPAGE, KANE	647	517
STA. 3356+37.74		TO STA. 3359+24.72		
FED. ROAD DIST. NO. ILLINOIS FED. AID PROJECT				

62410

Benchmark: "C" Cut in SW Corner Concrete Base of Traffic Signal Box in NW Corner IL Rte. 64 & Powis Rd. Elev. 758.46

Existing Structure: None.

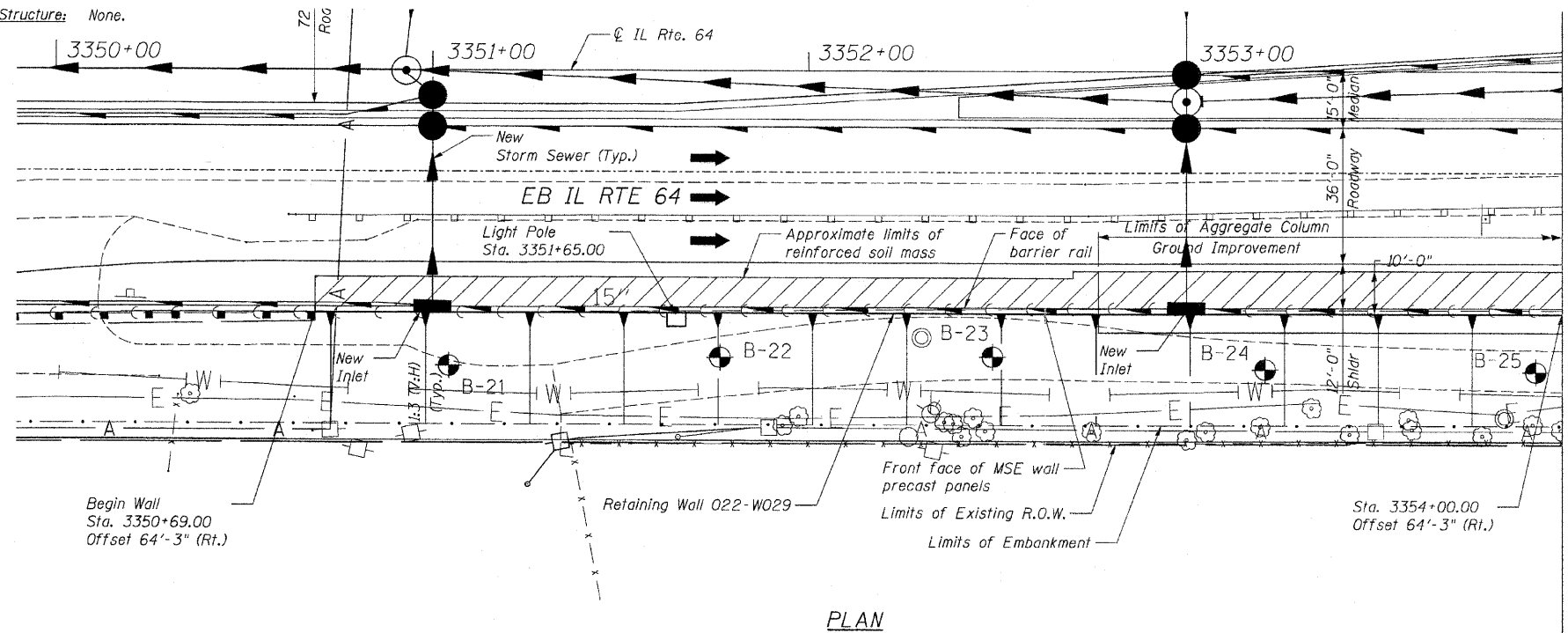

PLAN

Match Line Sta. 3354+00 See Sheet SW2

DESIGN SPECIFICATIONS

AASHTO Standard Specifications for Highway Bridges, 17th Edition-2002

DESIGN STRESSES

FIELD UNITS

f'c = 3,500 psi  
 fy = 60,000 psi (Reinforcement)

PRECAST UNITS

f'c = 4,500 psi (Precast Face Panels)

INDEX OF SHEETS:

- SW1 General Plan
- SW2 General Plan
- SW3 Typical Sections
- SW4 Typical Sections
- SW5 Moment Slab Details
- SW6 Moment Slab Details at Drainage Structure
- SW7 Coping Details
- SW8 Reinforcement Details and Bill of Material

NOTES:

1. For General Notes see Sheet SW2.
2. The face of abutment station is measured to an offset equal to 63'-9" (The assumed back face of the MSE wall panels).
3. The vertical scale of the Elevation view has been exaggerated to show detail.

APPROVED  
 FOR STRUCTURAL ADEQUACY ONLY  
*Matthew J. Pregmon*  
 ENGINEER OF BRIDGES AND STRUCTURES



*M. J. Pregmon*  
 EXPIRATION DATE: 11-30-2012

BILL OF MATERIAL

Item	Unit	Quantity
Structure Excavation	Cu Yd	47
Concrete Structures	Cu Yd	263.0
Protective Coat	Sq Yd	626
Reinforcement Bars, Epoxy Coated	Pound	42,720
Mechanically Stabilized Earth Retaining Wall	Sq Ft	5,201
Aggregate Column	L. Sum	0.25
Ground Improvement		
Conduit Embedded in Structure, 2" Dia., PVC	Foot	591

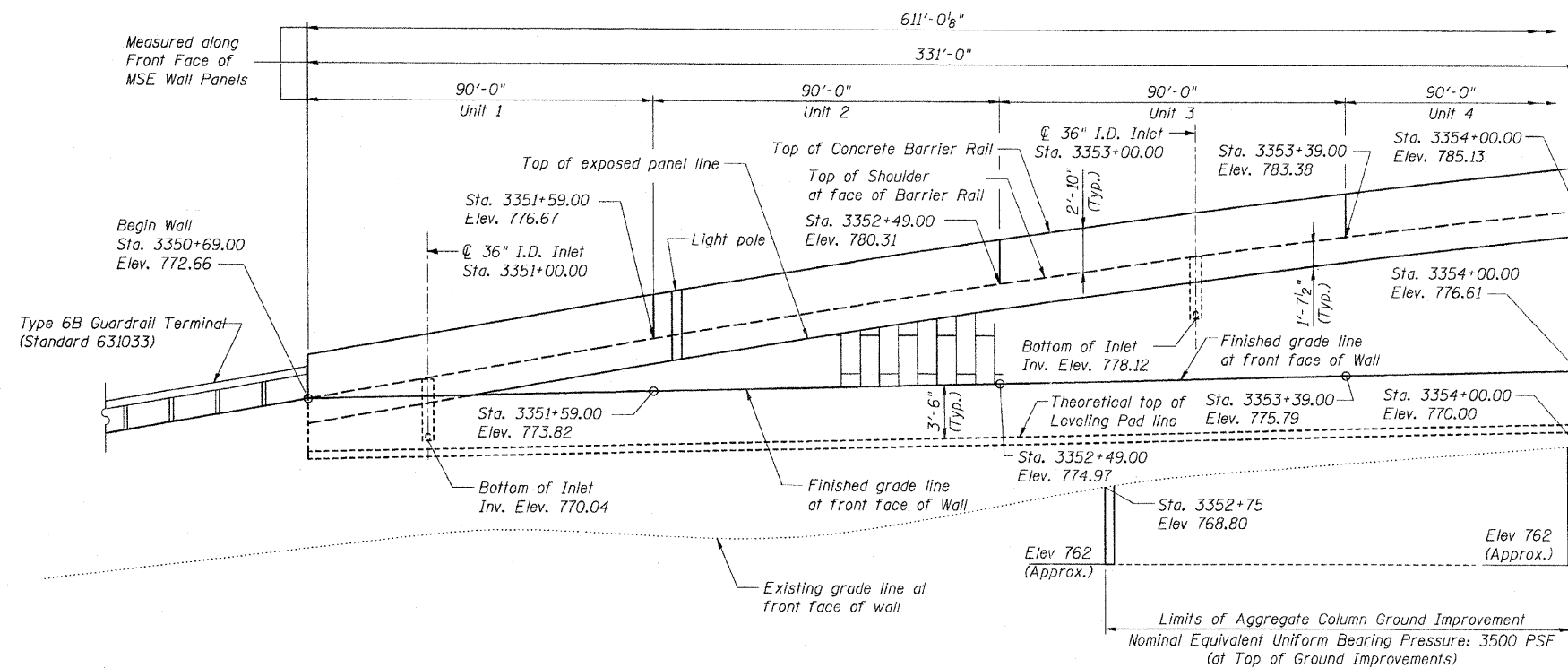

ELEVATION

(Looking North at front face of Wall)

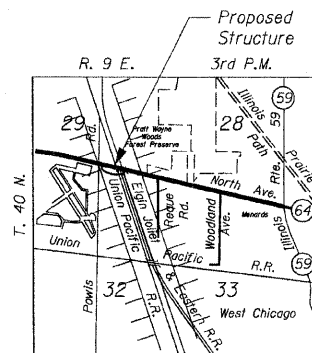

LOCATION SKETCH

Not to Scale Sheet SW1 of 8

REVISIONS	
NAME	DATE

F.A.P. ROUTE 307 ILLINOIS ROUTE 64 (NORTH AVENUE) OVER E.J.&E. AND U.P. R.R. GENERAL PLAN

STRUCTURE NUMBER O22-W029  
 FAP 307 SECTION 130 R-2  
 DUPAGE COUNTY  
 STA. 3350+69.00 TO 3356+80.01

SCALE: DRAWN BY: MRK  
 DATE: NOVEMBER 1, 2011 CHECKED BY: MJP

