

| F.A.P. RTE.         | SECTION | COUNTY                    | TOTAL SHEETS | SHEET NO. |
|---------------------|---------|---------------------------|--------------|-----------|
| 307                 | 130 R-2 | DUPAGE, KANE              | 647          | 644       |
| STA. 9847+00.00     |         | TO STA. 9849+00.00        |              |           |
| FED. ROAD DIST. NO. |         | ILLINOIS FED. AID PROJECT |              |           |

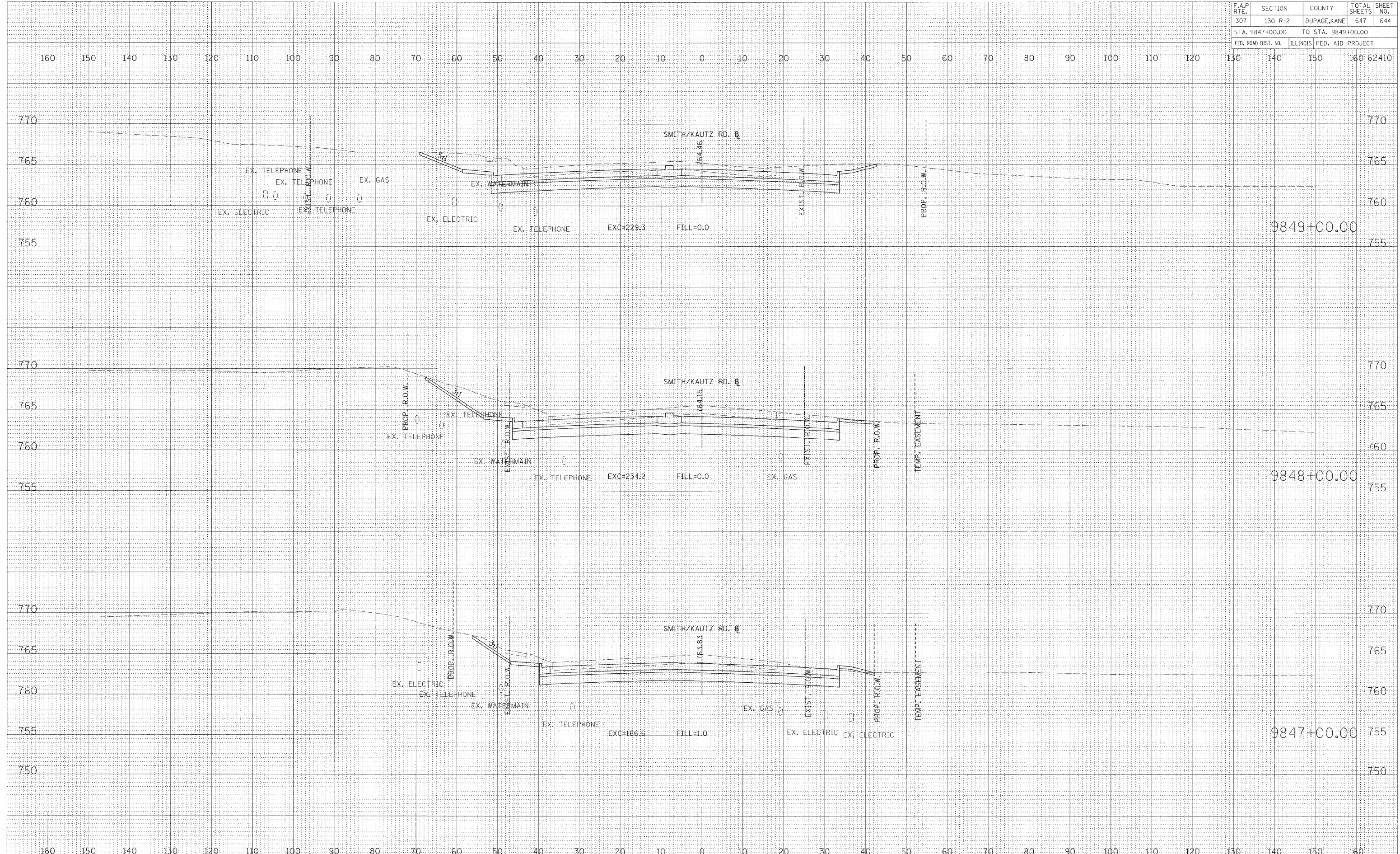

| DATE | BY |
|------|----|
|      |    |

SURVEYED  
 PLOTTED  
 NOTE BOOK  
 AREAS CHECKED

| DATE | BY |
|------|----|
|      |    |

ORIGINAL SURVEY  
 PLOTTED  
 NOTE BOOK  
 AREAS CHECKED

CROSS SECTIONS - SMITH AND KAUTZ ROAD