

F.A.P. RTE.	SECTION	COUNTY	TOTAL SHEETS	SHEET NO.
307	130 R-2	DUPAGE, KANE	647	645
STA. 9852+00.00		TO STA. 9853+15.00		
FED. ROAD DIST. NO.	ILLINOIS	FED. AID PROJECT		

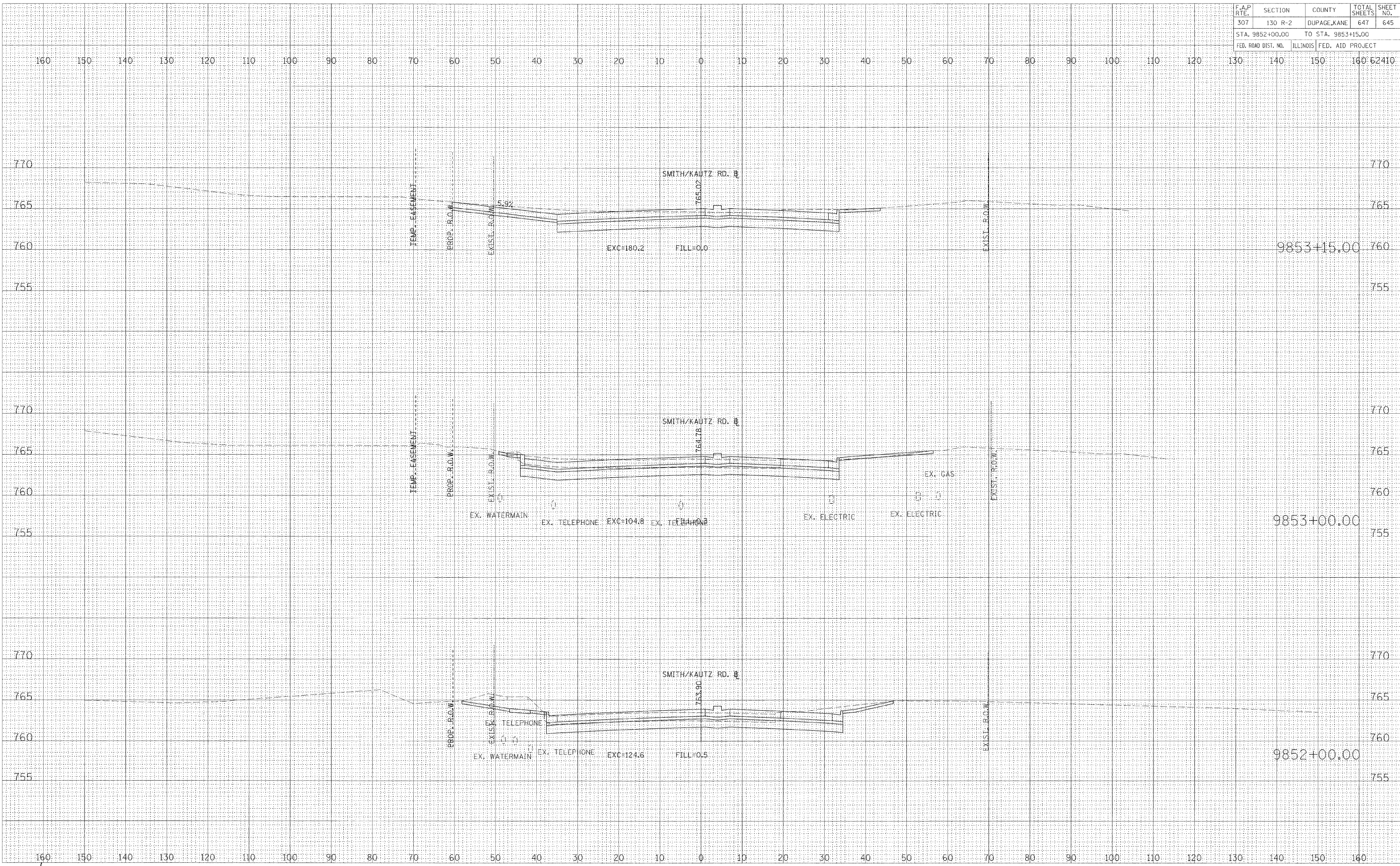

CROSS SECTIONS - SMITH AND KAUTZ ROAD

BY	DATE

FINAL SURVEY	SURVEYED
NO	NO
DATE	DATE
AREAS CHECKED	AREAS CHECKED

BY	DATE

ORIGINAL SURVEY	SURVEYED
NO	NO
DATE	DATE
AREAS CHECKED	AREAS CHECKED